

FED. AID DIST.	STATE	FED. AID PROJECT	FISCAL YEAR	1/3
10	OHIO	469-C	1930	

S.H. (I.C.H.) 15 SEC. H. 2 G
GEAUGA COUNTY

LENGTH OF PROJ. = 2.6 MILES
 60' R/W
 USR 322 NOV. 14 1934
 10.40
 SEC. H. - 1.48 MILES.
 SEC. G - 2.45 "

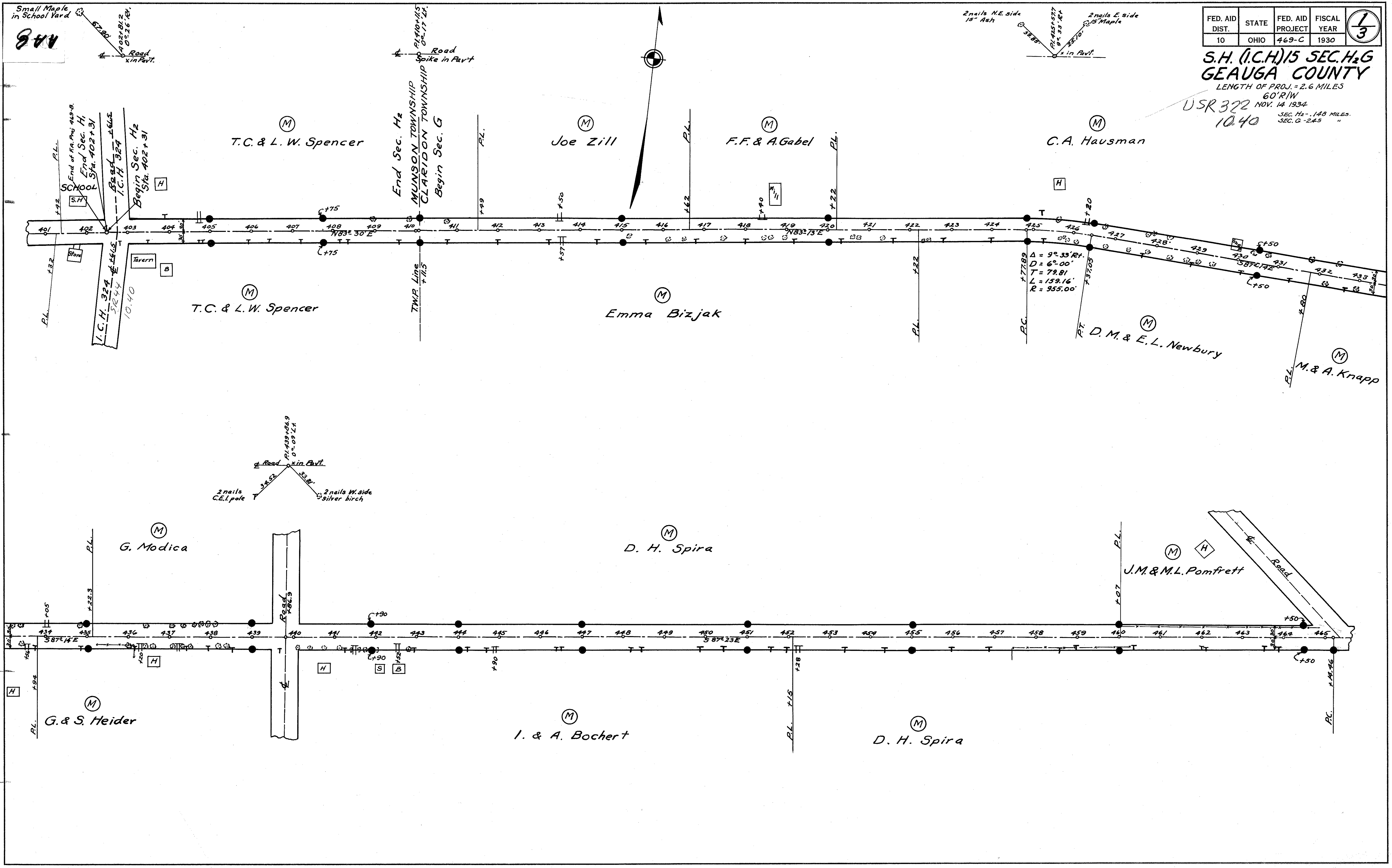

Small Maple, in School Yard
 844
 02+81.2
 0°26'48"
 Road Spike in Part

2 nails N.E. side
 15" Ash
 2 nails E. side
 15" Maple
 338.7
 02+95.17
 0°39'47"
 x in Part

2 nails
 C.E. pole
 34.52
 33.81
 01+49.92
 0°09'41"
 Road Spike in Part
 2 nails W. side
 silver birch

$\Delta = 9^\circ 35' 21''$
 $D = 6^\circ 00'$
 $T = 79.81'$
 $L = 139.16'$
 $R = 935.00'$

P.C.
 445.76