

I.C.H. 514 SEC. M.
GEAUGA COUNTY

USR 422
SLM 2.71

CFN 287000233
REPLACED IN 2004
UNDER GEA-700-0.00

CFN 287000254
SLM 2.54, 3'x3'
CIRCULAR RCP
NOT CONCRETE BOX
SEE SHEET 8

CFN 287000248
SLM 2.48, 15"
SEE SHEET 8

CLOSED DRAINAGE SYSTEM
IN PLACE ALONG USR 422 FROM
SR 700 TO THE WEST.

FINAL SURVEY	DATE
SURVEYED	BY
PLOTTED	BY
INSTRUMENTS	BY
AREAS CHECKED	BY
NO.	

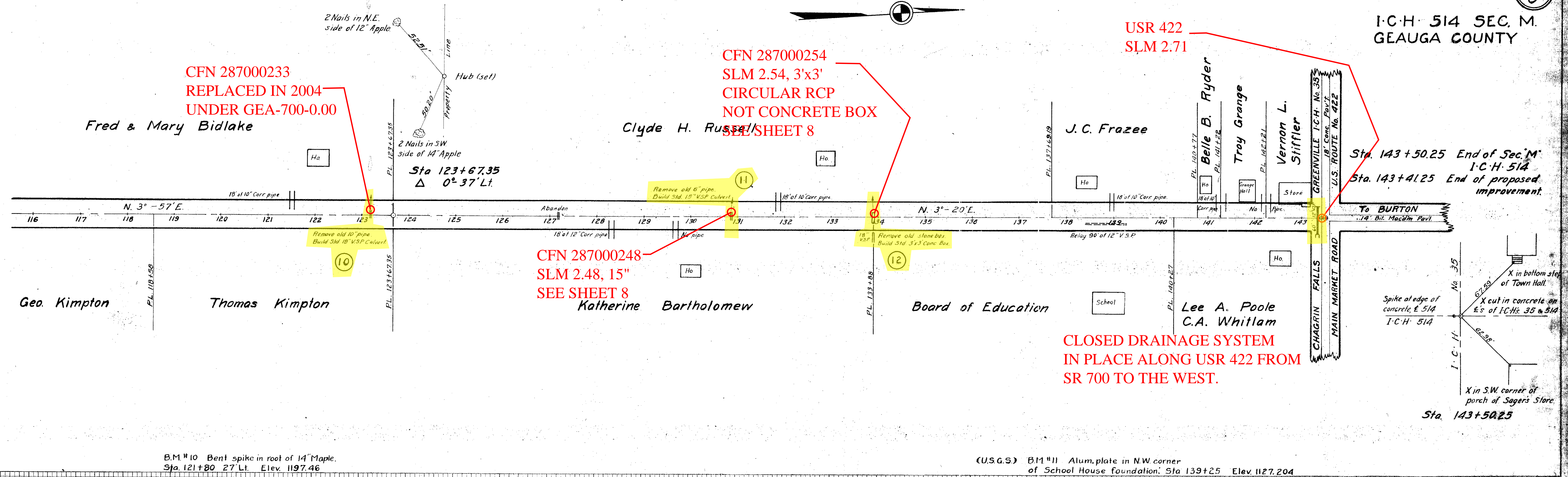

B.M. #10 Bent spike in root of 14' Maple.
Sta. 121+80 27' Lt. Elev. 1197.46

(U.S.G.S.) B.M. #11 Alum. plate in N.W. corner
of School House foundation. Sta. 139+25 Elev. 1127.204

Note: Profile grade line shown is the crown
of the graded roadway.

ORIGINAL SURVEY	DATE
SURVEYED	BY
PLOTTED	BY
INSTRUMENTS	BY
AREAS CHECKED	BY
NO.	

