

SEE 2001 CUY-71-0.00 PLANS FOR  
MODIFICATIONS TO STORM SEWERS

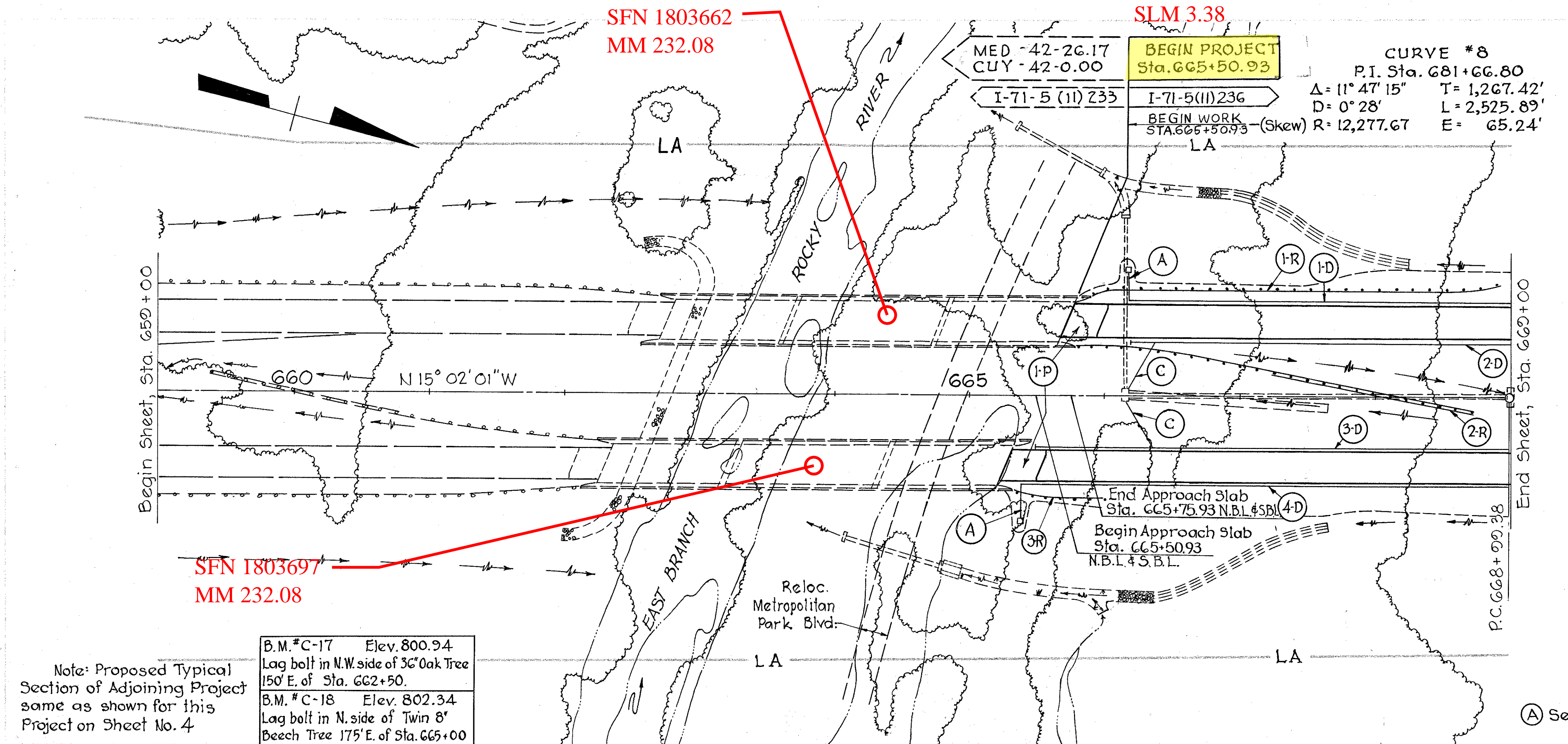

Note: Proposed Typical Section of Adjoining Project same as shown for this Project on Sheet No. 4

B.M. #C-17	Elev. 800.94
Lag bolt in N.W. side of 36" Oak Tree 150' E. of Sta. 662+50.	
B.M. #C-18	Elev. 802.34
Lag bolt in N. side of Twin 8" Beech Tree 175' E. of Sta. 665+00	

(A) See Sheet No. 156

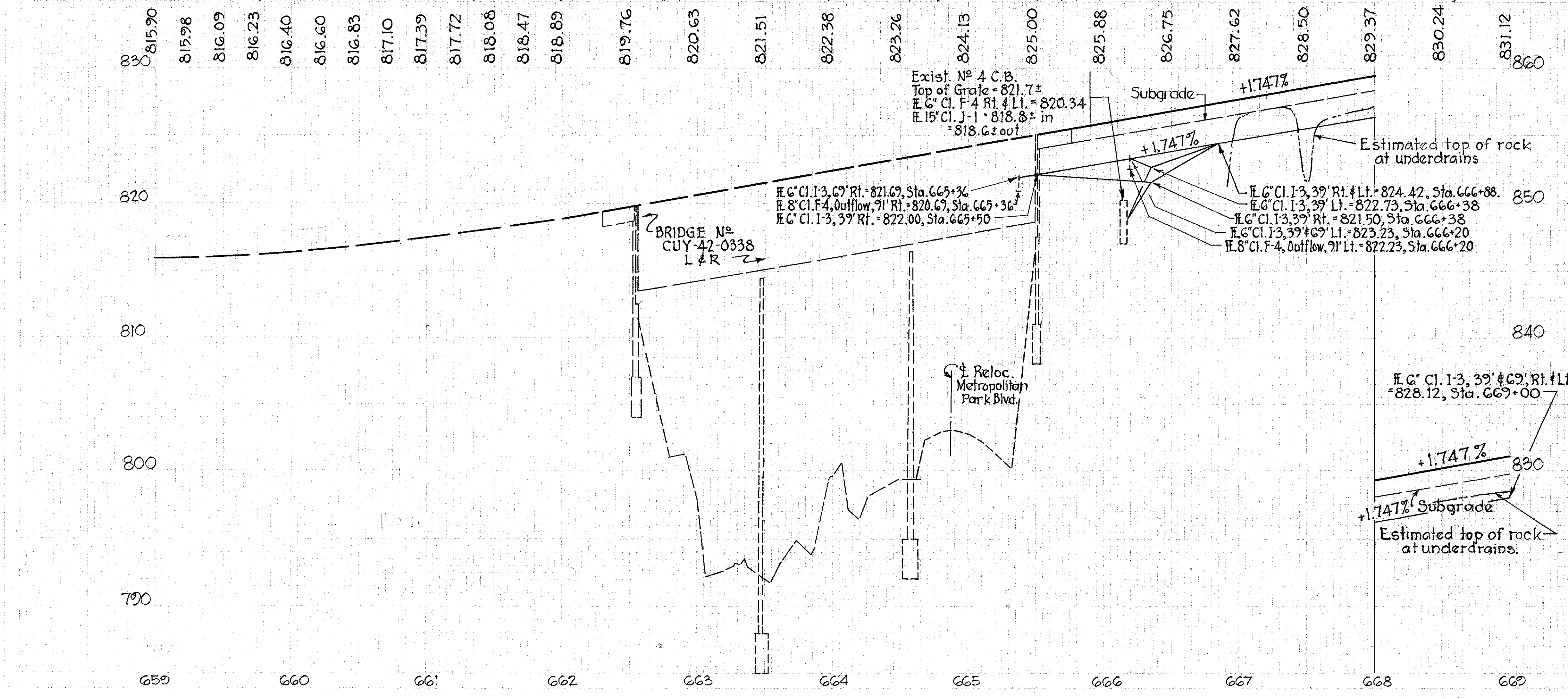

REF NO.	STATION TO STATION	SIDE	ESTIMATED QUANTITIES										TOTALS				
			Class F-4 Pipe	I-1	I-5	I-7	I-15	Reinf. Conc. Approach Slabs	Guard Rail	Barrier Rail	See Sheet No.						
			8"	6"	4"	3"	2"	1"	1"	1"	1"	1"	1"	1"	1"	1"	1"
1-D	666+20 to 669+00	Lt.	10	292	1												
2-D	666+20 to 669+00	Lt.	10	314													
3-D	665+50 to 669+00	Rt.	10	384													
4-D	665+36 to 669+00	Rt.	10	376													
1-R	665+94 to 668+94	Lt.															
2-R	665+79 to 668+79	Med.															
3-R	665+34 to 668+34	Rt.															
1-P	665+5093 to 665+75.93	Rt. Lt.															203
			20	20	1366	2	2	133.3	133.3	150	150	162.5					