

Note "H":
 6" Hydrant
 6" Flanged Connection
 6" Flanged Valve & Box
 Flanged x Plain End C.I. Pipe
 6" 1/4 Bend (Bell & Bell)

ESTIMATED QUANTITIES		
Item	Description	Quantity
Special	24" Prestressed Concrete Cylinder Pipe & Fittings C-301	1000 Lin. Ft.
Special	4" Drain with Vault, Complete	1 Each
Special	6" Valve and Box	4 Each
Special	6" Fire Hydrant	4 Each
Special	6" Water Main A.S.A. Class 25 C.I. Pipe (Cement Lined) and Fittings	24 Lin. Ft.

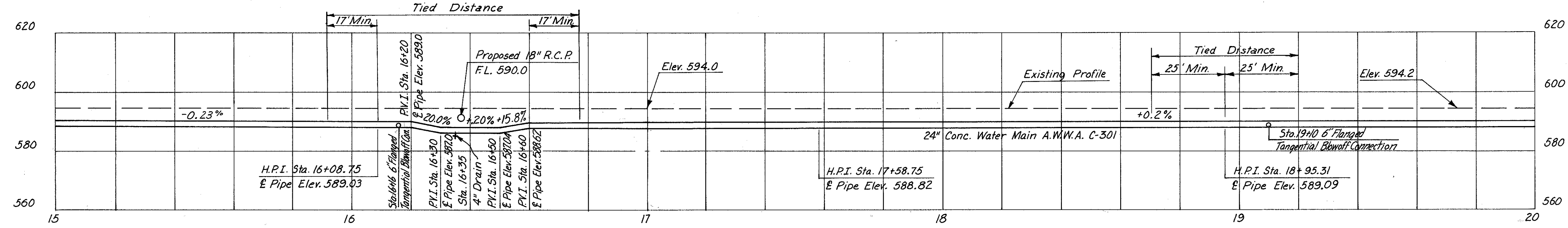
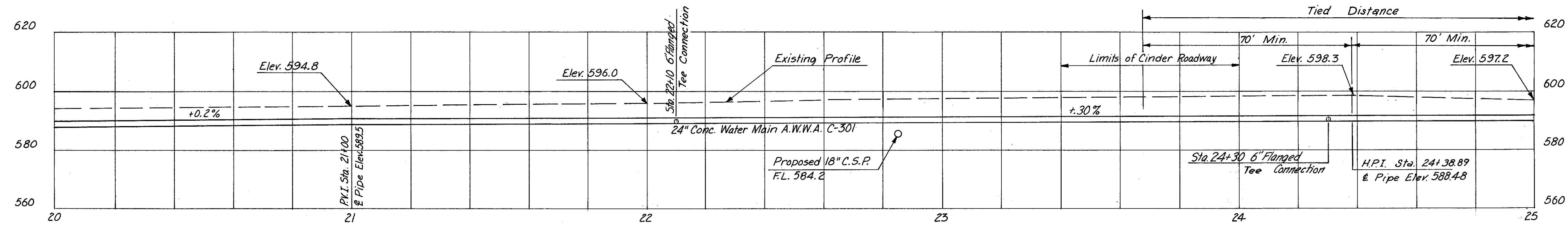
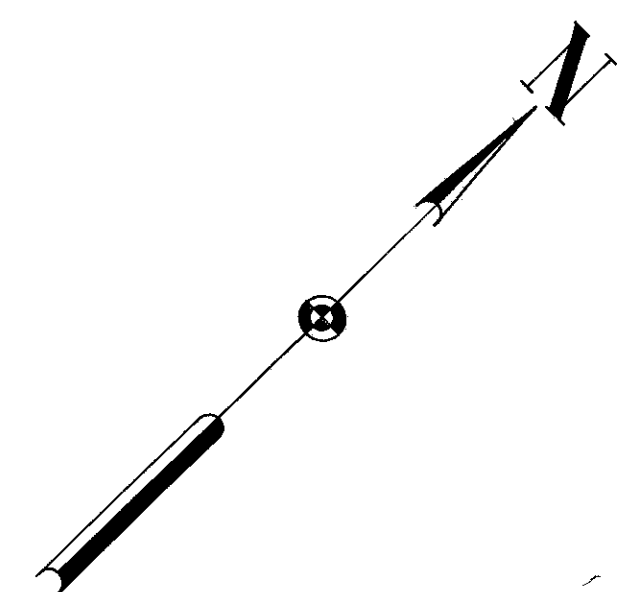

APPROVED
 DATE FEB. 4, 1965
 [Signature]
 DIRECTOR OF PUBLIC UTILITIES
 [Signature]
 COMMISSIONER OF WATER AND HEAT
 [Signature]
 COMMISSIONER DIVISION OF UTILITIES ENGINEERING
 [Signature]
 ENGINEER OF CONSTRUCTION AND SURVEYS
 [Signature]
 ENGINEER OF DESIGN

LOW SERVICE DISTRICT
 DEPARTMENT OF PUBLIC UTILITIES
 DIVISION OF WATER AND HEAT
 CLEVELAND, OHIO
 SUBJECT: 24" Reinforced Concrete Water Main From Jennings Road Near The J.B.L. Steel Corp. Entrance To Clark Avenue. **B-1951**

MADE: F.C.E. DATE: 11-12-64 TRACED: H1D DATE: 10-12-64
 CHECKED: DATE: SCALE: 1" = 20'

HOWARD, NEEDLES, TAMMEN & BERGENDOFF
 CONSULTING ENGINEERS
 KANSAS CITY CLEVELAND NEW YORK

Note: 1. Future Jones & Laughlin Corp. Elev. is 596.00.
 2. For Excavation and Backfill Detail For 24" Prestressed Concrete Cylinder Pipe see sheet 12.