

**CURVE DATA & RELOC. W. 17TH ST.**

PI = Sta. 06+47.40  
 $\Delta = 18^{\circ}08'01''$   
 $D = 08^{\circ}00'00''$   
 $R = 716.20'$   
 $T = 114.29'$   
 $L = 226.67'$   
 $E = 9.06'$

**CURVE DATA & RELOC. W. 17TH ST.**

PI = Sta. 08+44.60  
 $\Delta = 17^{\circ}40'05''$   
 $D = 10^{\circ}30'00''$   
 $R = 545.67'$   
 $T = 84.81'$   
 $L = 168.27'$   
 $E = 6.55'$

ESTIMATED QUANTITIES		
Item	Description	Quantity
Special	8" Water Main A.S.A. Class 25 C.I. Pipe (Cement Lined or Slip-on Joints) and Fittings	411 Lin. Ft.
Special	6" Water Main A.S.A. Class 25 C.I. Pipe, all Lead Joints and Fittings	8 Lin. Ft.
Special	Fire Hydrants Removed	1 Each
Special	6" Fire Hydrants	1 Each
Special	8" Valve and Box	2 Each
Special	12" Inserting Valve and Box	1 Each
Special	Abandon Existing Valve Box	7 Each
Special	Pipe Cuts	4 Each
Special	6" Valve and Box	1 Each
Special	Test Main	1 Each

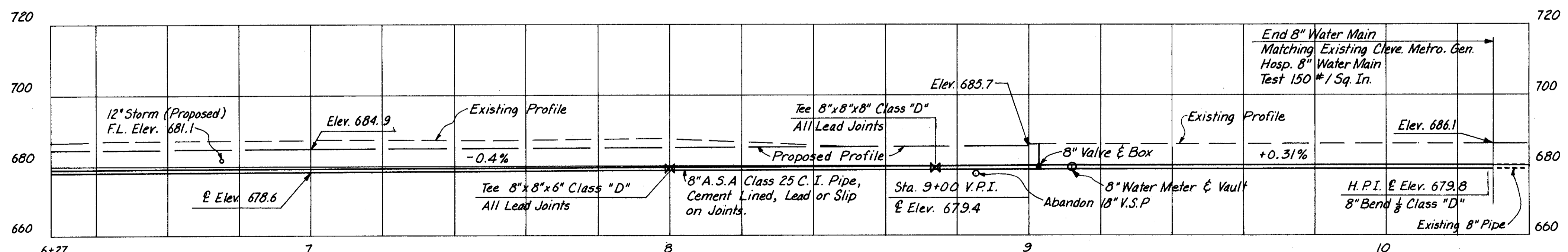

APPROVED  
 DATE FEB. 4, 1965

*James W. Miller*  
 DIRECTOR OF PUBLIC UTILITIES

*Arnold W. Miller*  
 COMMISSIONER OF WATER AND HEAT  
 COMMISSIONER DIVISION OF UTILITIES ENGINEERING

*J. A. Connor*  
 ENGINEER OF CONSTRUCTION AND SURVEYS

*William J. Sweeney*  
 ENGINEER OF DESIGN

**LOW SERVICE DISTRICT**  
 DEPARTMENT OF PUBLIC UTILITIES  
 DIVISION OF WATER AND HEAT  
 CLEVELAND, OHIO

SUBJECT 8" WATER MAIN RUNNING ALONG  
 RELOCATED WEST 17TH ST. CONNECTING  
 TITUS AVE., VIEW RD., EGLINDALE AVE.,  
 AIKEN AVE. AND CLEVE. METRO. GEN. HOSP.

**B-1956**