

CFN 1974731
SLM 20.67, 18"
SEE SHEET 182

old CFN 184802072
new CFN 1885411
SLM 20.72, 42"
SEE SHEET 120

SLM 20.69, 36"
SEE SHEET 120

SLM 20.72, 12"
SEE SHEET 120

SLM 20.72, 15"
SEE SHEET 120

old CFN 184802081
new CFN 1827233
SLM 20.81, 42"
SEE SHEET 116

FED. RD. DIVISION	STATE	PROJECT	94 478
2	OHIO		

CUYAHOGA COUNTY
CUY-480-19.43

QUANTITY CALCULATIONS
MADE BY R.S.W. DATE 7-20-72
CHECKED BY E.R.A. DATE 7-26-72

GRANGER ROAD (SR 17)
SLM 20.75=MM 22.92

BRIDGE
SFN 1802690
SEE SHEET 264
MM 22.99
SEE ROW SHEET 19
FOR CHANNEL
EASEMENTS

CFN 1974749
SLM 20.91, 24"
SEE SHEET 186

CFN 1974747
SLM 20.72, 15"
SEE SHEET 120

SLM 20.67, 12"
SEE SHEET 118

SLM 20.91, 21"
SEE SHEET 122

CFN 1974767
SLM 20.70, 15"
SEE SHEET 120

SLM 20.70, 15"
SEE SHEET 117

SLM 20.76, 18"
SEE SHEET 117

CFN 1974760
SLM 20.76, 15"
SEE SHEET 241

SLM 20.78, 24"
SEE SHEET 117

SLM 20.80, 24"
SEE SHEET 119

SLM 20.82, 27"
SEE SHEET 119

SLM 20.84, 27"
SEE SHEET 119

SLM 20.84, 12"
SEE SHEET 119

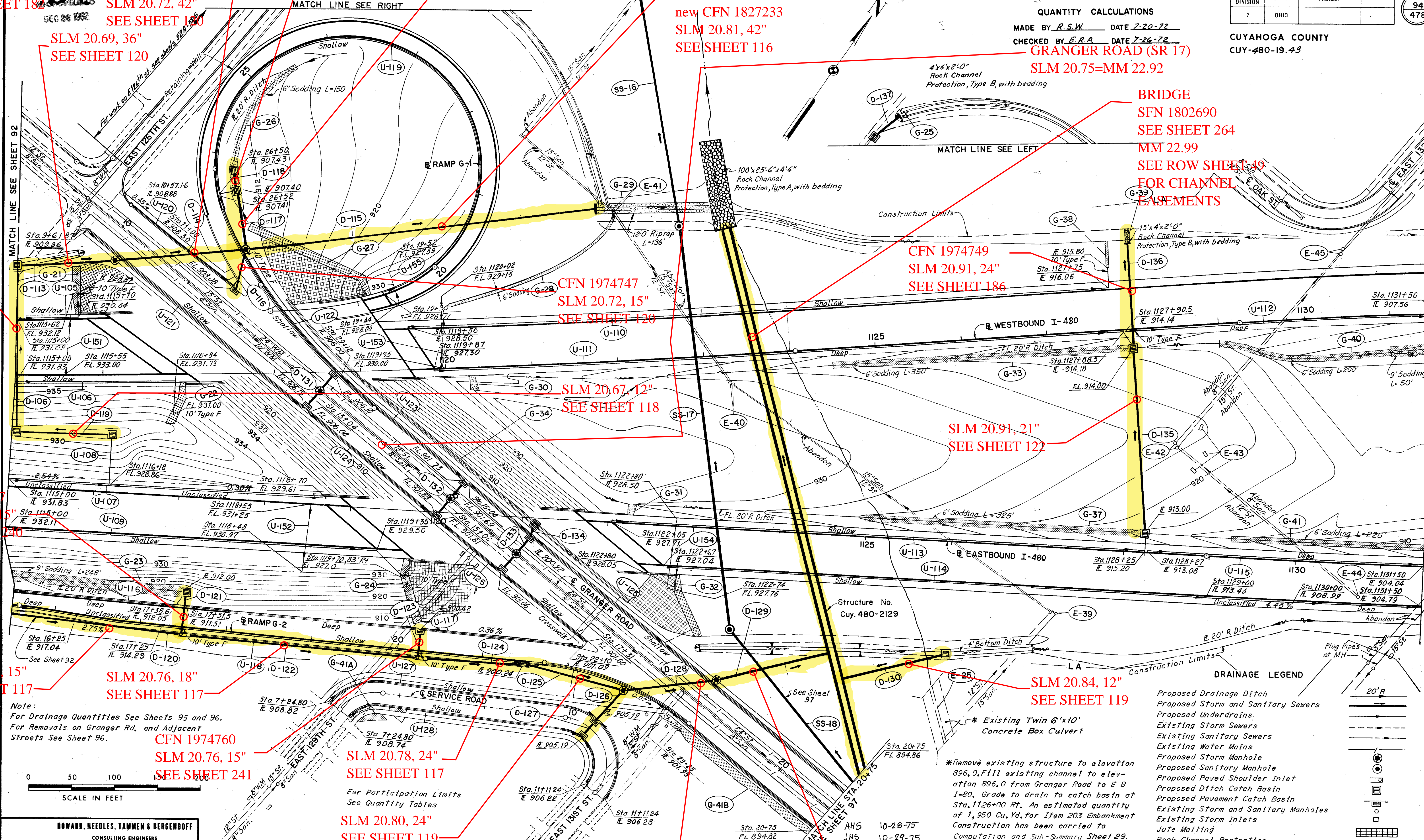

Note:
For Drainage Quantities See Sheets 95 and 96.
For Removals on Granger Rd. and Adjacent Streets See Sheet 96.

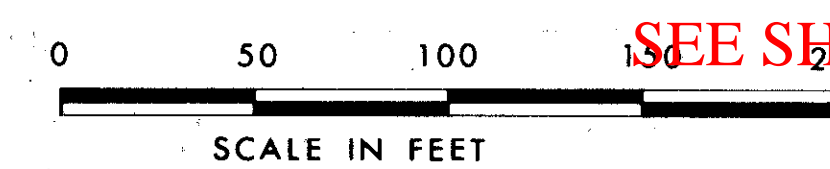

HOWARD, NEEDLES, TAMMEN & BERGENDOFF
CONSULTING ENGINEERS
KANSAS CITY CLEVELAND NEW YORK

*Remove existing structure to elevation 896.0. Fill existing channel to elevation 896.0 from Granger Road to E.B I-80. Grade to drain to catch basin at Sta. 1126+00 Rt. An estimated quantity of 1,950 Cu. Yd. for Item 203 Embankment Construction has been carried to Computation and Sub-Summary Sheet 29. The estimated amount of concrete to be removed is 65 Cu. Yds.

