

BM #108: "+" SET ON WEST ANCHOR BOLT OF HIGH TENSION POLE #5627, 1500' NORTH OF EMERY ROAD, EAST SIDE OF I-271 NORTHBOUND ELEV. 1153.87

CALC. BY: JJB  
DATE: 10/92  
CHKD. BY: ALM  
DATE: 5/93

CUY-271-6.41

OHIO  
FHWA REGION 5  
36  
145

ESTIMATED QUANTITIES

REF.	FROM	TO	SIDE	SPCL		202		603		604		660			
				L.F.	EA.	L.F.	EA.	L.F.	EA.	L.F.	EA.				
LOCATION															
				FILL AND PLUG EXISTING CONDUIT											
				PIPE REMOVED, 24" AND UNDER											
				CATCH BASIN REMOVED											
				CATCH BASIN ABANDONED											
				15" CONDUIT, TYPE B, 706.02											
				15" CONDUIT, TYPE C, 706.02											
				18" CONDUIT, TYPE B, 706.02											
				18" CONDUIT, TYPE B, 706.02											
				21" CONDUIT, TYPE B, 706.02											
				21" CONDUIT, TYPE B, 706.02											
				CATCH BASIN, NO. 4 WITH E. GRATE											
				INLET, NO. 3B50, A.P.P.											
				SODDING											
TOTALS				346	54	3	1	19	7	11	17	451	2	2	200

CONSTRUCTION CURVE No. 1  
D = 0'-28'-00"  
R = 12,277.67'  
L = 6,131.80'  
T = 3,131.26'  
P.I. = STA. 390+31.26  
Δ = 28°-36'-54"

226' - 21" Type B  
See Below

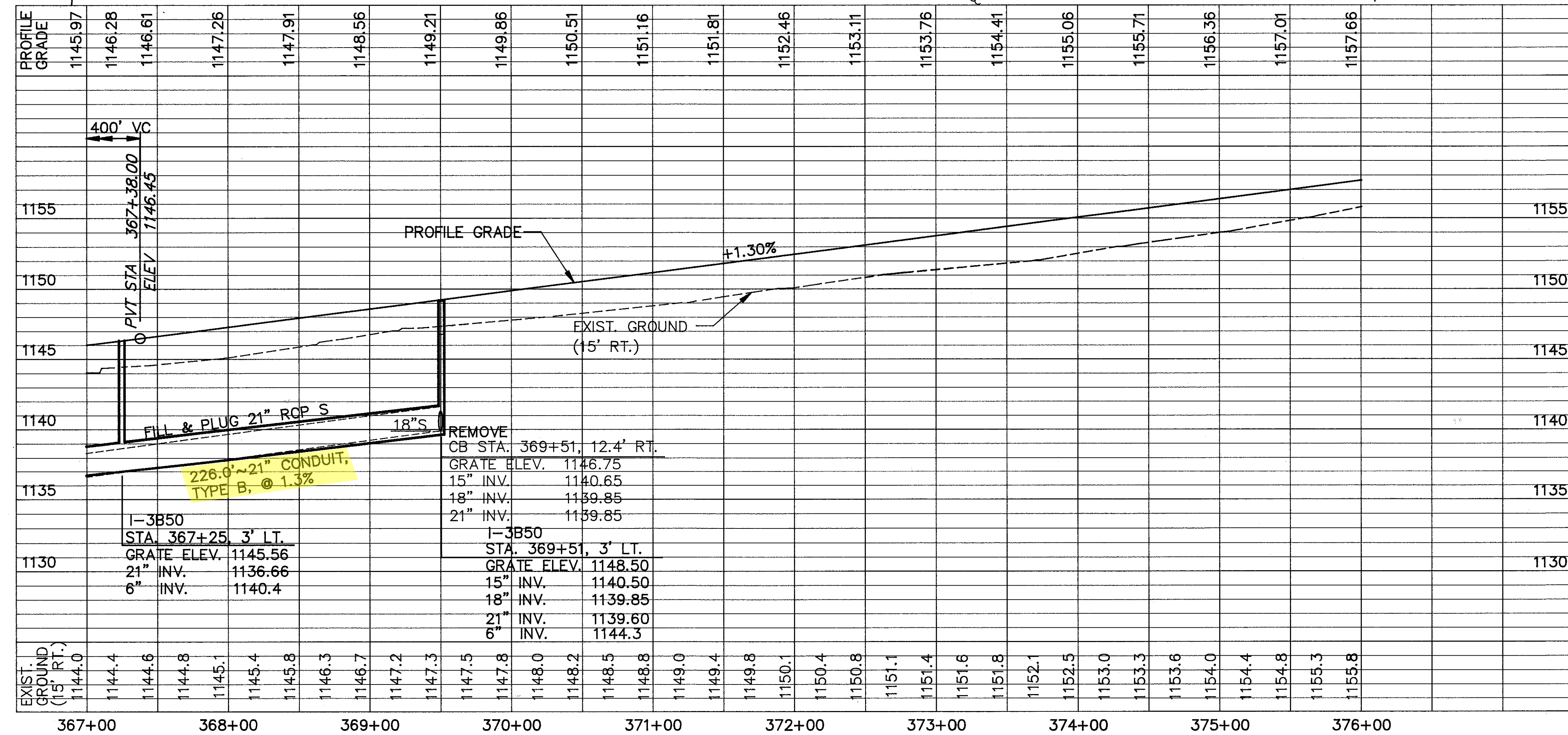
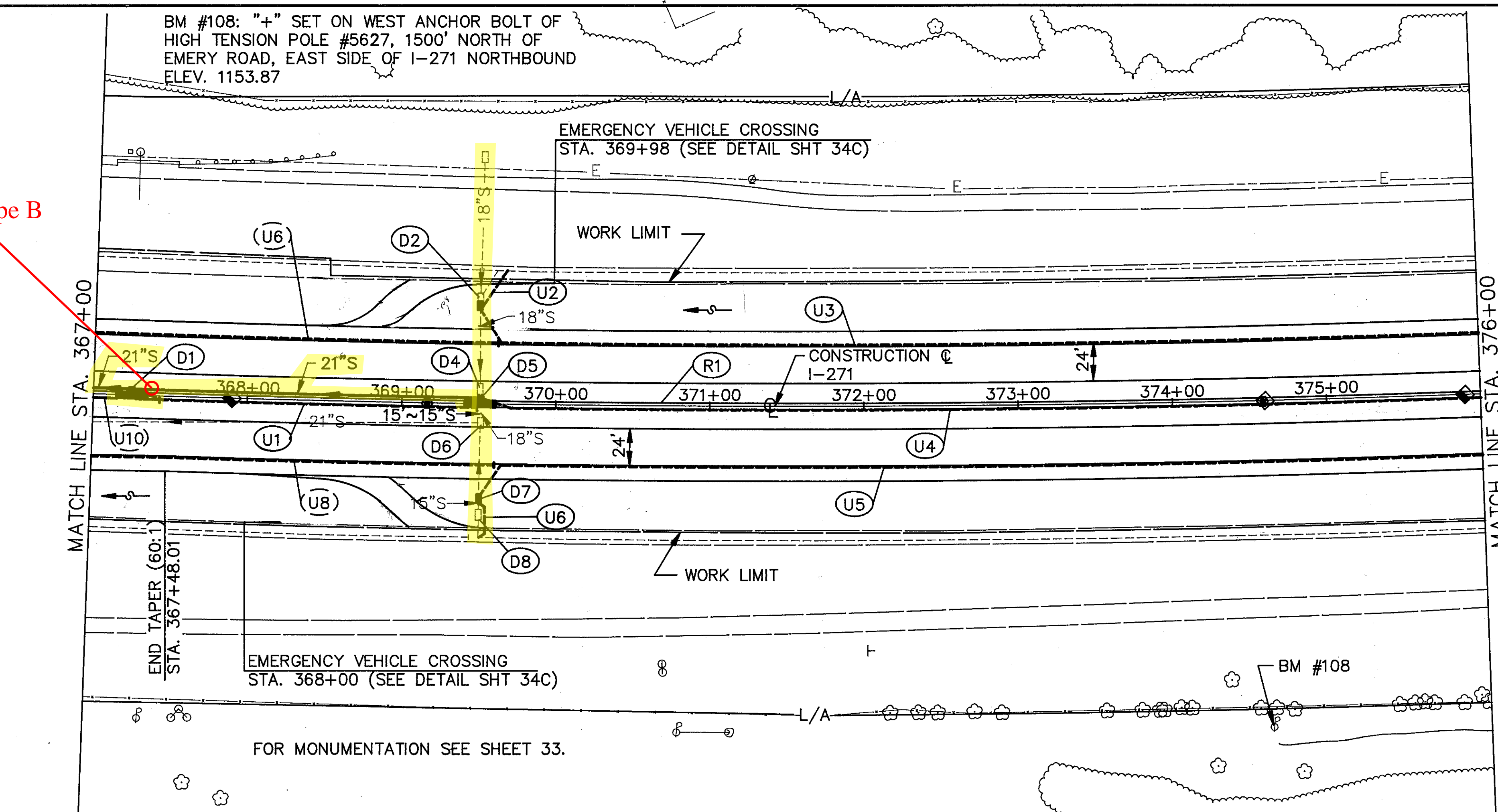

REFERENCE R# LOCATED ON ROADWAY SUB-SUMMARY, SHT 32.

REF.	FROM	TO	SIDE	603		605	
				L.F.	EA.	L.F.	EA.
LOCATION							
				6" CONDUIT, TYPE F			
				6" SHALLOW PIPE UNDERDRAIN			
				BEND			
				6" FITTINGS			
TOTALS				130	2231		