

SLM 3.53, 54"
SEE BELOW

SLM 3.58, 15"
SEE SHEET 144

old CFN 182710358 SLM 3.67, 18"
new CFN 1804578 SLM 3.58, 54"
SEE BELOW

SEE SHEET 144

old CFN 182710365
new CFN 1804579
SLM 3.67, 48"
SEE BELOW

SLM 3.67, 27"
SEE SHEET 145

SLM 3.67, 24"
SEE SHEET 145

SLM 3.66, 18"
SEE SHEET 145

Note:
For details of Water Main relocation, see sheets 59 & 60
For storm sewer profiles see sheets 144 & 145.
For sanitary sewer profiles see sheet 152.
For tabulation of sanitary sewer 5-2, see sheet 36.
For Referencing of Intersection with Columbus Rd. See sheet 59

FED. RD. DIVISION	STATE	PROJECT
2	OHIO	14-13-28

CUYAHOGA COUNTY
CUY-14-13.28

35
246

PLAN	SURVEYED	DATE
NO.	BY	
	PLOTTED	
	ALIGNED	
	CHECKED	
	BY	
	DATE	

PROFILE	SURV.	DATE
NO.	BY	
	PLOTTED	
	GRADES	
	CHECKED	
	BY	
	DATE	

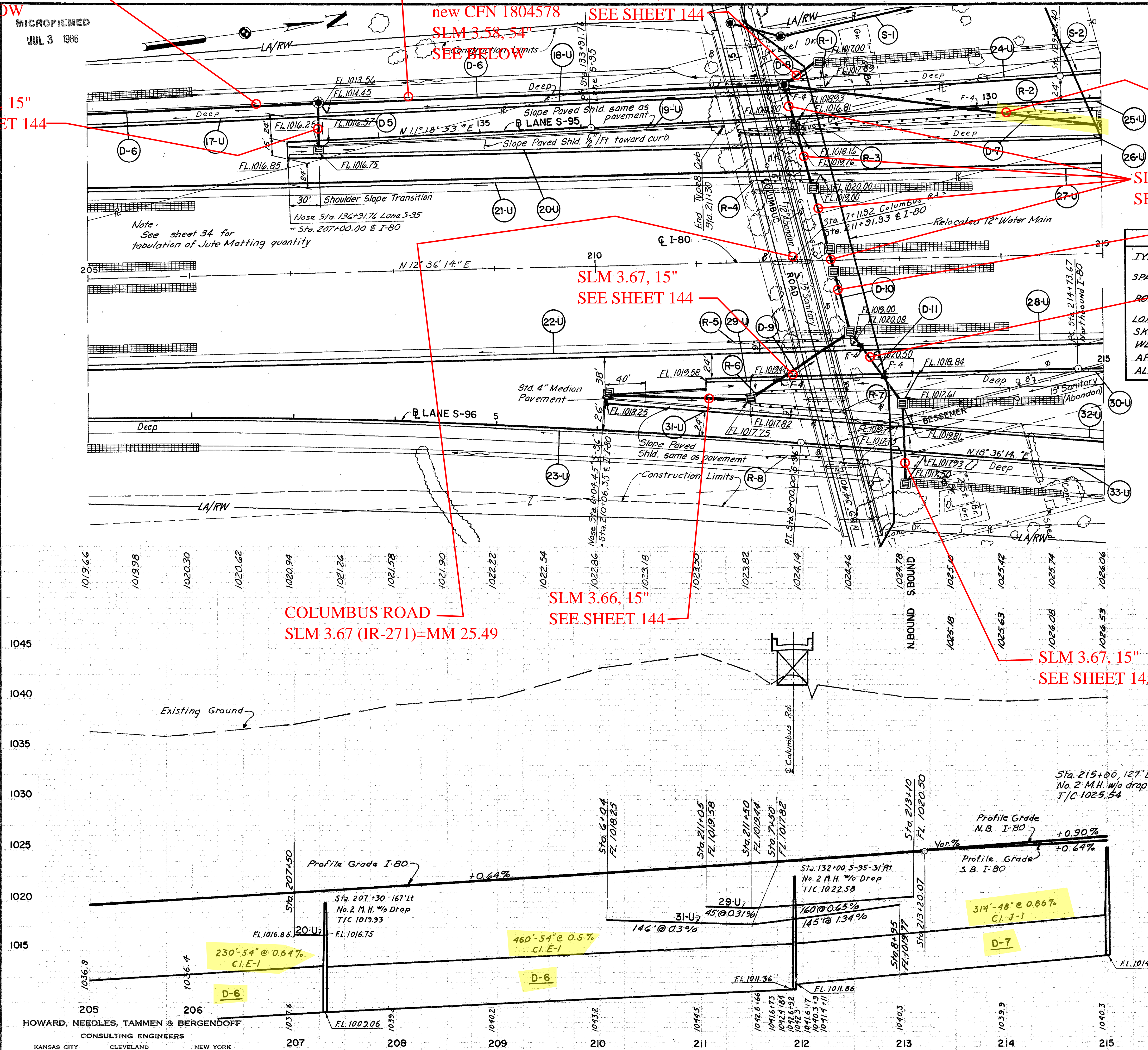

CURVE DATA

PI Sta.	4100.36	S.96'
Δ	6°00'00"	
D	0°45'00"	
R	7639.44'	
T	400.36'	
L	800.00'	
E	18.46'	

CURVE DATA

PI Sta.	126+44.57	S.95'
Δ	3°44'14"	
D	0°15'00"	
R	22,918.33'	
T	747.72'	

PROPOSED STRUCTURE CUY-14-1446

TYPE: Continuous steel beam with reinforced concrete deck and structure

SPANS: 36'-6"; 51'-6"; 66'-6"; 2 @ 73'-0"

ROADWAY: 28'-0" curb/curb with two 4'-2" sidewalks

LOAD FREQUENCY: CF 40Q(57)

SKEW: 13°-01'-34"

WEARING SURFACE: 1" Monolithic Concrete

APPROACH SLABS: AS-1: 54' (25' long)

ALIGNMENT: Tangent

BENCH MARK 107-A

Lag bolt & washer in W. root of 30" Silver Maple, 105' Left of Sta. 211+40 & 25' S of @ Columbus Rd. Elev. 1042.66

Ref No	Station	Side	From		To		Total
			From	To	From	To	
R-1	131+55		132+55	Rt.	100	1076.0	
R-2	128+91		132+67	Lt.	376		
R-3	211+47		212+47	Lt.	100		
R-4	211+58		212+58	Lt.	100		
R-5	211+50		212+50	Rt.	100		
R-6	211+46		212+46	Rt.	100		
R-7	7+48		8+48	Lt.	100		
R-8	7+67		8+67	Rt.	100		
						1076.0	

Ref No	Profile Sheet No. Ref.	Station	Side	From		To		Total
				From	To	From	To	
I-1		152		211+40	244+38	Lt.	190	
I-8								

Ref No	Station	Side	From		To		Total
			From	To	From	To	
I-1	17-U		205+00	207+25	Lt.	225	
I-1	18-U		131+65	136+60	Rt.	495	
I-1	19-U		131+95	136+60	Lt.	10	
I-1	20-U		207+00	212+00	Lt.	10	
I-1	21-U		205+00	212+10	Lt.	710	
I-1	22-U		205+00	212+45	Rt.	745	
I-1	23-U		1400	9+00	Rt.	10	
I-1	24-U		128+90	131+60	Rt.	20	
I-1	25-U		128+90	131+90	Lt.	20	
I-1	26-U		212+15	215+00	Lt.	10	
I-1	27-U		212+15	215+00	Rt.	20	
I-1	28-U		212+50	215+00	Rt.	20	
I-1	29-U		211+05	213+10	Rt.	30	
I-1	30-U		213+00	215+00	Rt.	10	
I-1	31-U		6+04	8+95	Lt.	10	
I-1	32-U		9+00	10+95	Lt.	10	
I-1	33-U		9+05	10+95	Rt.	10	
						180	391.9

Ref. No	Profile Sheet No. Ref.	Station	Side	From		To		Total
				From	To	From	To	
D-5	144	207+30	Lt.	205+00	211+90	Lt.	43'	
D-6		205+00		211+90	215+00	Lt.		
D-7		211+90		212+25	Lt.			
D-8	144	210+10		212+50	Rt.	258		
D-9	144	210+10		212+50	Lt.	78		
D-10	145	211+90		212+50	Lt.	78		
D-11		212+50		213+00	Rt.	379		

Excavation	291,677	Cu. Yds.
Embankment	0	Cu. Yds.
Embankment + 18%	0	Cu. Yds.