

NOTE:
 ① Scale: 1"=10' Vertical
 1"=20' Horizontal
 ② For Details of Junction Chamber See Sheet No. 90

CALC. BY EJK DATE 12-75
 CHKD. BY TRB DATE 12-75

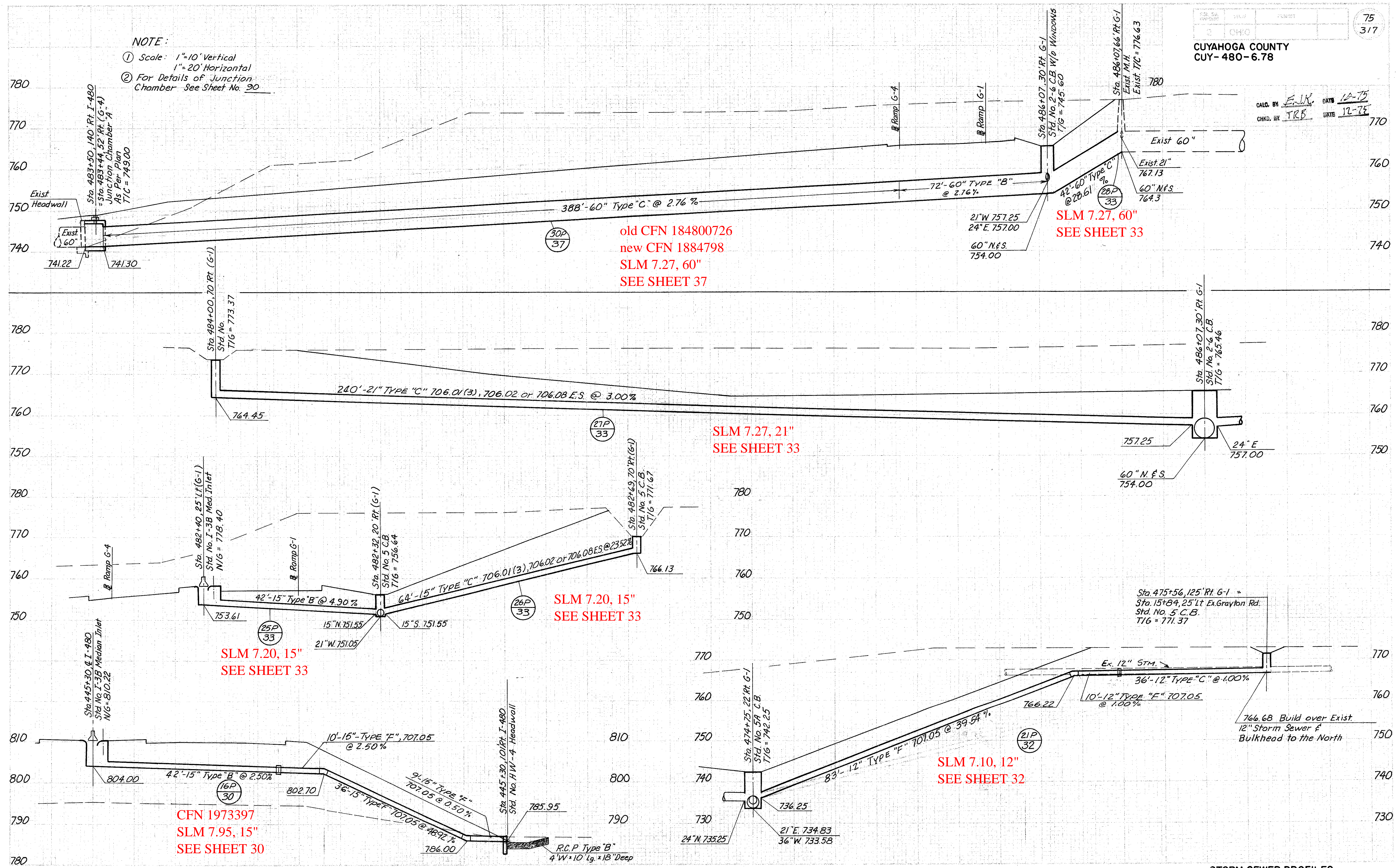

CFN 1973397
 SLM 7.95, 15"
 SEE SHEET 30

SLM 7.20, 15"
 SEE SHEET 33

SLM 7.27, 21"
 SEE SHEET 33

SLM 7.27, 60"
 SEE SHEET 33

old CFN 184800726
 new CFN 1884798
 SLM 7.27, 60"
 SEE SHEET 37