

MICROFILMED  
AUG 6 1992

CFN 1974253  
SLM 9.77, 15"  
SEE SHEET 100

old CFN 184800979  
new CFN 1849828  
SLM 9.78, 33"  
SEE SHEET 54  
75, AND 151

KEYSTONE PKWY  
SLM 9.79=MM 11.96

CFN 1974255  
SLM 9.89, 15"  
SEE SHEET 104

CROSS REFERENCE	
Sht. No.	Item
318	Structure
95-104	Cross Sections
20-21	Drainage Details

5 OHIO  
CUYAHOGA COUNTY  
CUY-480-8.54

ESTIMATED QUANTITIES		601	602	603	CONDUIT	667	603	605	605	604	606	660	606			
REF#	SIDE	LOCATION	Rock Chas. Prot. Type B w/ Bed	Concrete Masonry Type B	Type A D=2000 D=2000 D=2000	Type F	Type F	Seeding and Jute Matting	Bends & Branches	Bends & Branches	Shallow Underdrains	No. 1-3H Inlet	Guard Rail Type S	Reinforced Sodding	Bridge Terminal Assembly Type A	Storm Sewer Facilities
			C.Y.	C.Y.	L.F.	L.F.	L.F.	S.Y.	L.F.	L.F.	L.F.	L.F.	L.F.	S.Y.	S.Y.	S.Y.
1-D	L	542+25	3.3	0.27	78											100
2-D	L/R	542+79	56.4	71.3	564											75
3-D	L/R	As Indicated						625							141	
4-D	L	543+25	2.5	0.27	77											104
5-D	R	547+03	3.6	0.33												103
6-D	L/R	As Indicated						886								156
7-D	L/R	547+00														85
8-D	L/R	550+00														60
1-U	L	540+00 to 542+20				10										
2-U	Med	540+00 to 542+26				10				1	188					
3-U	R	540+00 to 542+26				10				1	200					
4-U	L	544+25 to 550+00				10					565					
5-U	Med	544+25 to 549+25				10					490					
6-U	Med	549+37 to 550+00				10					63					
7-U	R	544+25 to 550+00				10					575					
1-G	L	540+00 to 542+50										250				1
2-G	R	540+00 to 542+50										250				1
3-G	L	544+01 to 550+00										599				1
4-G	R	544+01 to 550+00										599				1
TOTALS TO GEN. SUM.			65.8	72.17	195	564	50	129	1511		2297	2	1698		442	4

BRIDGE  
SEE ROW SHEET 13  
FOR EASEMENT

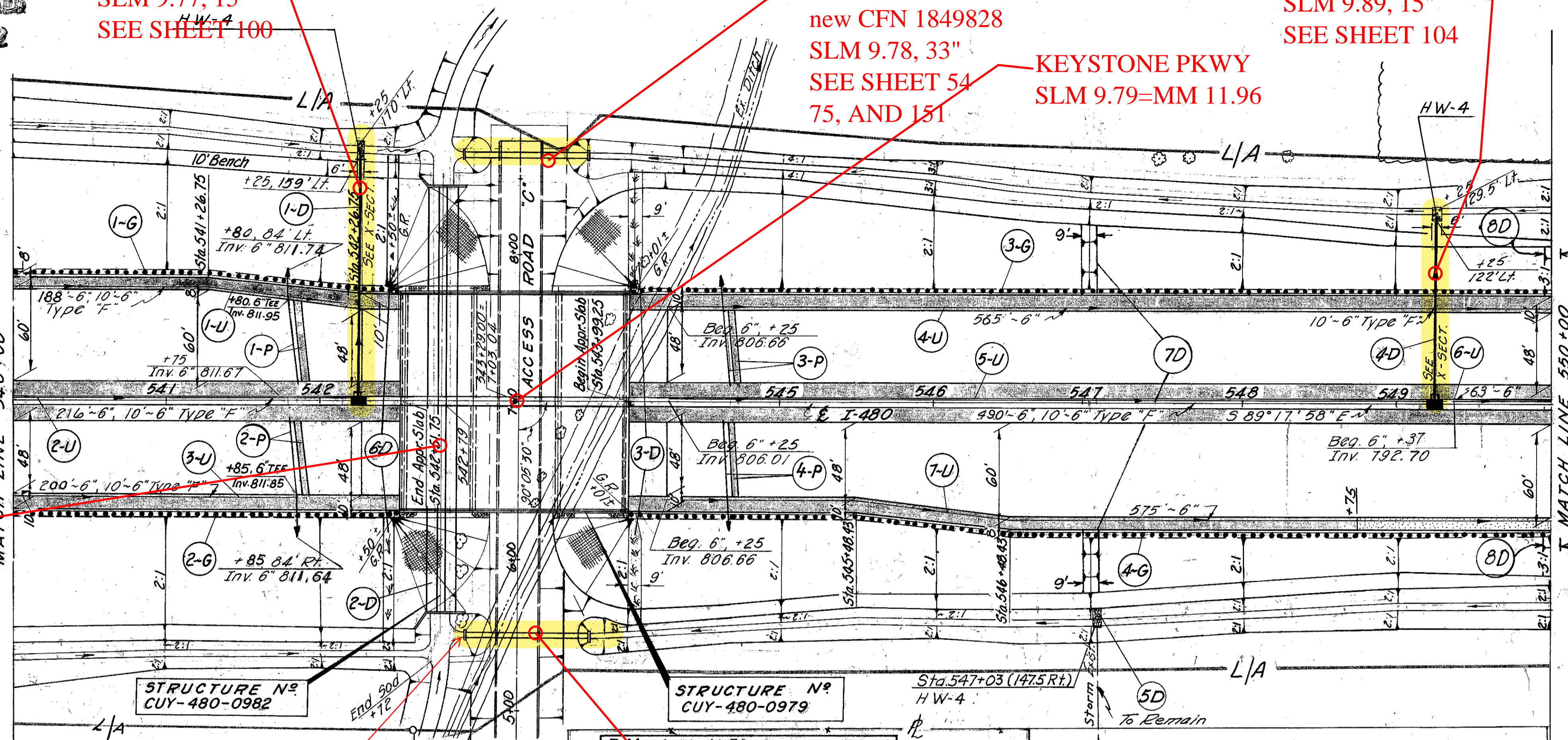

BM = O.M. 1051 Approx. 26 ft.  
N. E Brookpark Rd. 0.7 Mi. W.  
of W. 130th St. Elev. = 787.018

For all Culvert Details, See Sheet No. 75.  
For Access Road "C" Roadway Design  
Details, See Sheets No. 53 & 54.  
For Ditch Relocation Details, See Sheet  
No. 72.  
For I-80, Centerline Control Data, See  
Sheet No. 331.

Low Priority Outlet  
CUY14501R

old CFN 184800978  
CFN 1849827  
SLM 9.78, 42"  
SEE SHEET 54  
75, AND 150

TREE REMOVAL  
540+00 to 550+00  
SIZE No.

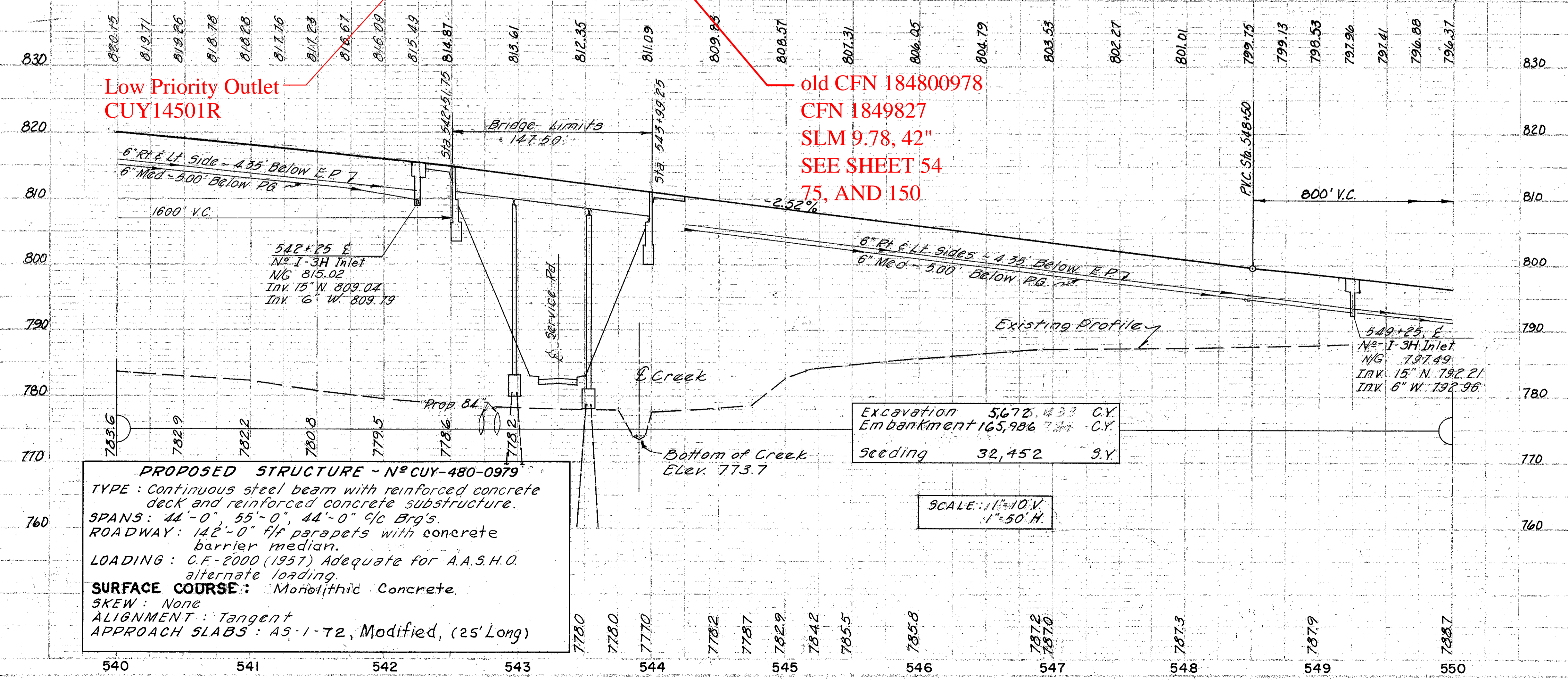

**PROPOSED STRUCTURE - No. CUY-480-0979**  
TYPE: Continuous steel beam with reinforced concrete deck and reinforced concrete substructure.  
SPANS: 44'-0", 55'-0", 44'-0" g/c Brg's.  
ROADWAY: 142'-0" flt parapets with concrete barrier median.  
LOADING: C.F. 2000 (1957) Adequate for A.A.S.H.O. alternate loading.  
SURFACE COURSE: Monolithic Concrete.  
SKEW: None  
ALIGNMENT: Tangent  
APPROACH SLABS: A3-1-72, Modified, (25' Long)

Excavation 56,725.433 C.Y.  
Embankment 165,986.734 C.Y.  
Seeding 32,452 S.Y.

SCALE: 1"=10' V.  
1"=50' H.

ESTIMATED QUANTITIES		SPEC. 605		
REF#	SIDE	LOCATION	Pressure Relief Joint, Type A	6" Shallow Underdrain
			L.F.	L.F.
1-P	Lt.	541+91	54	57
2-P	Rt.	541+85	49	52
3-P	Lt.	544+73	49	70
4-P	Rt.	544+68	49	70
TOTAL			201	249

Rev. 4-12-78