

Dashed Contours Indicate Grading Not In This Contract

Note: Gas Well to be abandoned and plugged by Others

CFN 1972223
SLM 4.42, 15"
SEE SHEET 153

CFN 1935332
SLM 4.44, 15"
SEE SHEET 53

SLM 4.53, 24"
SEE BELOW

CFN 1935334
SLM 4.44, 18"
SEE SHEET 53

SLM 4.58, 24"
SEE BELOW

CFN 1935339
SLM 4.56, 18"
SEE SHEET 55

CFN 1935343
SLM 4.50, 15"
SEE SHEET 54

SLM 4.56, 30"
SEE SHEET 55

CFN 1935337
SLM 4.56, 30"
SEE SHEET 55

CUYAHOGA COUNTY
CUY - 42 - 3.38

DATE	2	DATE	07/10/08	PROJECT	I-71-5(11) 236	25
BY	CHG	DATE		PROJECT		263

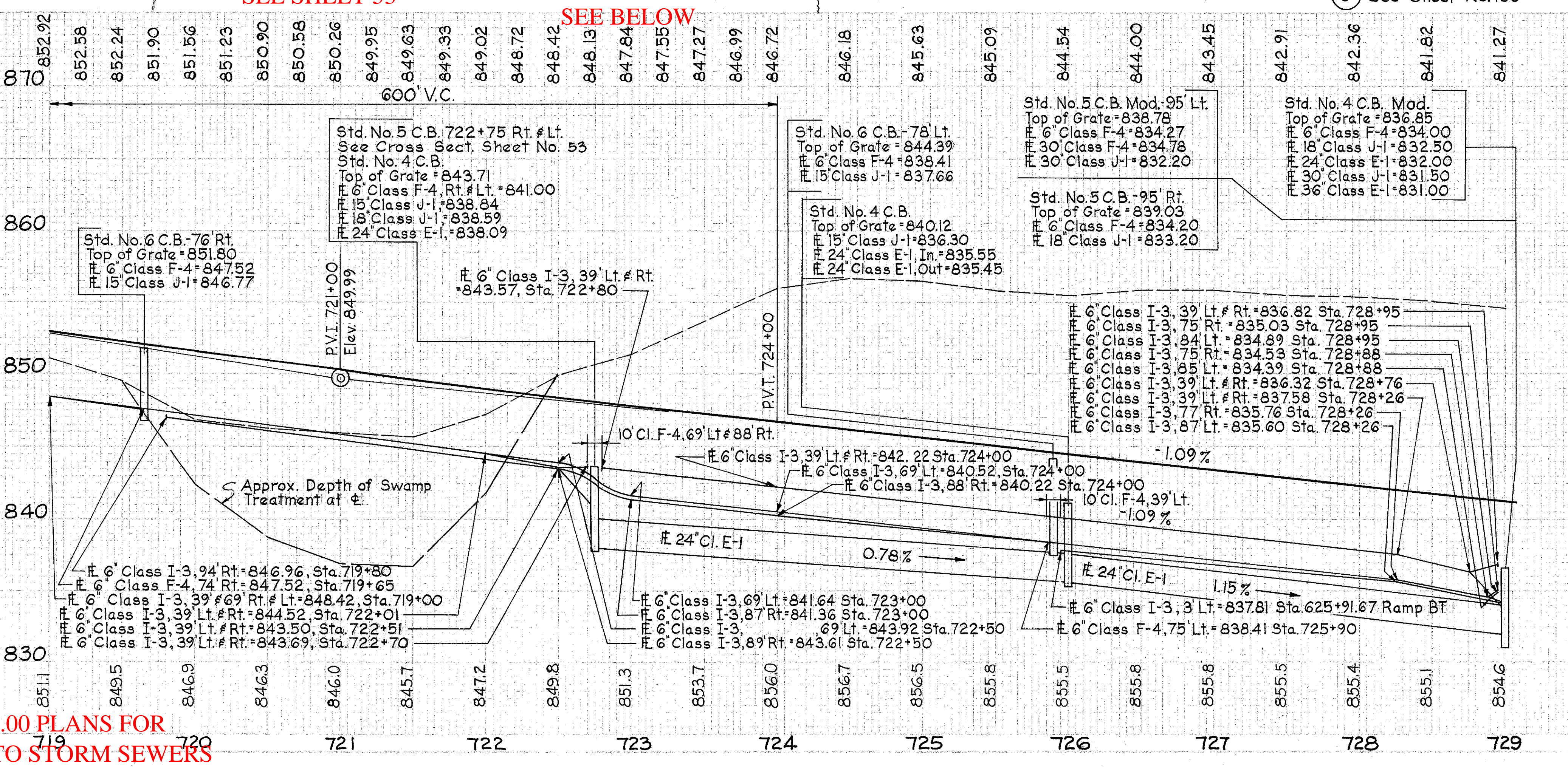

ESTIMATED QUANTITIES

REF. NO.	STATION TO STATION	SIDE	CLASS	SIZE	15'	18'	24'	30'	36'	42'	48'	54'	60'	66'	72'	78'	84'	90'	96'	102'	108'	114'	120'	I-15 Special Guard Rail	I-15 Special	I-8 No. 5 C.B. Mod.	I-8 No. 6 C.B. Mod.	I-10 Soding Matting	I-120 Jute No. 4.	I-6 Std. No. 4.	SEE SHEET NO.						
I-D	719+00 to 725+90	Lt.	Class I-3	39"	108	92	625																														
2-D	719+00 to 722+70	Lt.	Class F-4	74"	10	10	10	10																													
4-D	719+00 to 722+70	Rt.	Class I-3	39"	10	10	10	10																													
5-D	719+00 to 728+95	Rt.	Class I-3	39"	10	10	10	10																													
7-D	722+80 to 728+95	Lt.	Class I-3	39"	10	10	10	10																													
8-D	722+80 to 728+95	Lt.	Class I-3	39"	108	92	625																														
9-D	722+80 to 728+95	Lt.	Class I-3	39"	108	92	625																														
10-D	722+75 to 722+75	Med.	Class I-3	39"	108	92	625																														
11-D	722+75 to 729+00	Med.	Class I-3	39"	108	92	625																														
13-D	724+50 to 729+00	Med.	Class I-3	39"	108	92	625																														
14-D	727+50 to 729+00	Lt.	Class I-3	39"	108	92	625																														
15-D	727+50 to 729+00	Rt.	Class I-3	39"	108	92	625																														
16-D	727+50 to 729+00	Lt.	Class I-3	39"	108	92	625																														
I-R	727+04 to 727+54	Med.	Class I-3	39"	108	92	625																														
2-R	727+04 to 727+54	Lt.	Class I-3	39"	108	92	625																														
																TOTALS	194	200	102	625	110	46	2,785	1,399	0.5	0.5	6	2	2	3	1	1	1	100	3	799	1

SEE 2001 CUY-71-0.00 PLANS FOR MODIFICATIONS TO STORM SEWERS