

(D) DRAINAGE

REF. NO.	STATION		SIDE	I-1		I-2	I-3	I-4		I-5	F-10	L-10
	FROM	TO		15" PIPE CLASS J-1	15" PIPE CLASS F-4			30" PIPE CLASS A-1 SEC. M-6.6(b) M-6.8(b)	MASONRY			
				LIN. FT.	C.Y.	EA.	EA.	C.Y.	S.Y.			
D-1	980+30	DITCH	RT.	74	44		2			1	1.30	2
D-2	984+94	DITCH	RT.	110			.26			1	1.80	2
D-4	988+00				154	9.40		1				6
TOTAL				184	44	154	9.92	2	1	2	3.10	10

REF. NO.	STATION		SIDE	I-1		I-5	
	FROM	TO		6" PIPE CLASS I-3	6" PIPE CLASS F-4	8" PIPE CLASS F-4	6" 90° TEE
				LIN. FT.	EA.		
D-5	979+00	989+00	LT.	1012		10	1
D-6	979+00	989+00	M	946	30		
D-7	979+00	989+00		1028	10	20	1
TOTAL				2986	40	30	1

CFN 1972347
SLM 9.34, 15"
SEE SHEET 112

CFN 1972345
SLM 9.49, 30"
SEE SHEET 118

CFN 1972348
SLM 9.49, 30"
SEE SHEET 118

CFN 1972340
SLM 9.43, 15"
SEE SHEET 112

FOR PROFILE OF STORM SEWERS SEE SHEET 112
FOR DETAILS OF CULVERT D-4 SEE SHEET 118
FOR SIGN PLAN SEE SHEET NO. 137

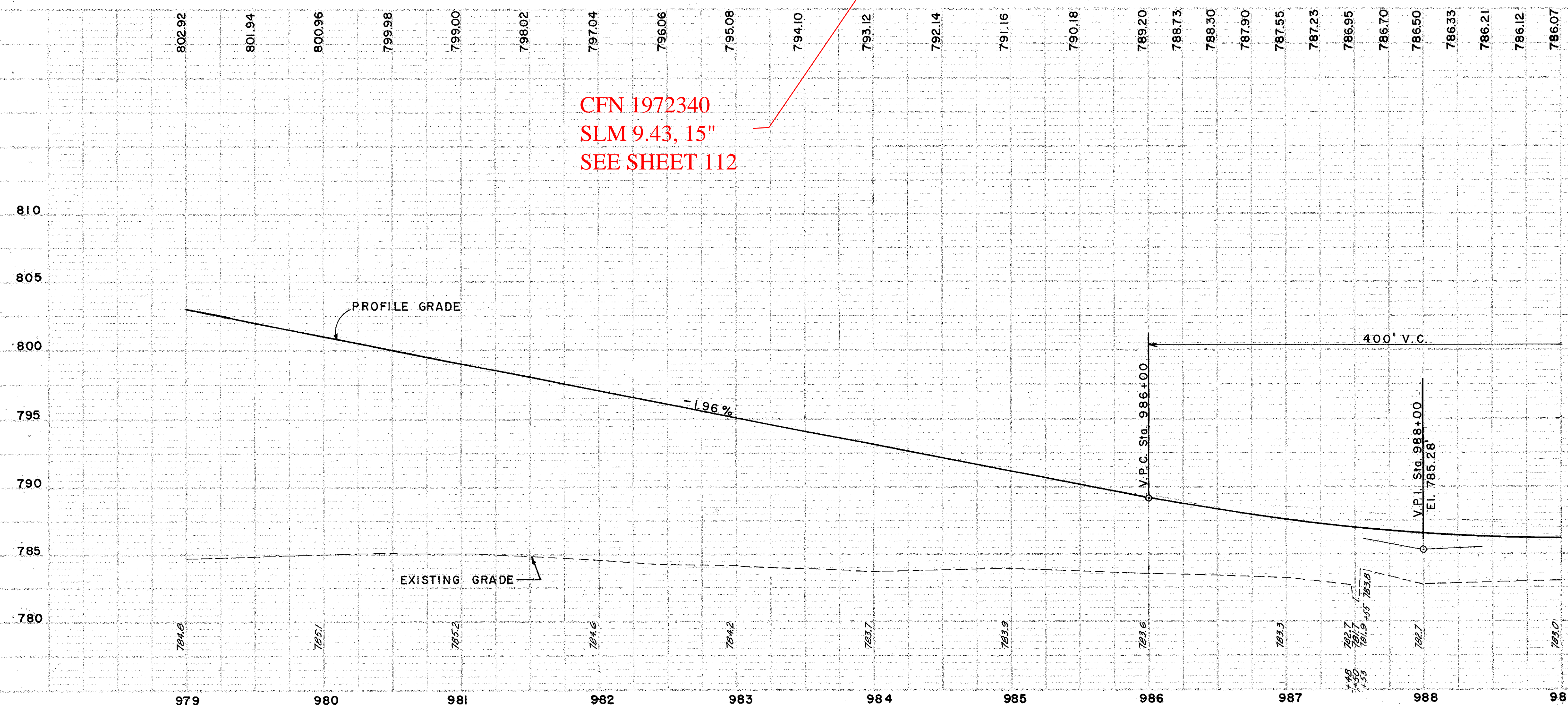

(R) ROADWAY

REF. NO.	STATION		SIDE	I-15	
	FROM	TO		GUARD RAIL	STEEL BEAM (DEEP)
				STANDARD	BARRIER
				LIN. FT.	
R-1	979+00	983+00	RT.	400	
R-2	979+00	989+00	C.		1000
R-3	979+00	984+00	LT.	500	
TOTAL				900	1000

PLAN & PROFILE - STA. 979+00 TO STA. 989+00