

old CFN 180711031
new CFN 1874373
SLM 10.31, 30"
SEE SHEET 48

CFN 1972367
SLM 10.43, 15"
SEE SHEET 47

CFN 1972363
SLM 10.44, 15"
SEE SHEET 47

CFN 1972361
SLM 10.44, 15"
SEE SHEET 47

old CFN 180711030
new CFN 1874372
SLM 10.31, 30"
SEE SHEET 48

SLM 10.25, 12"
SEE SHEET 47

SLM 10.31, 24"
SEE SHEET 47

SLM 10.32, 24"
SEE SHEET 47

CULVERT No
CUY-71-1031
SEE SHT. No 48

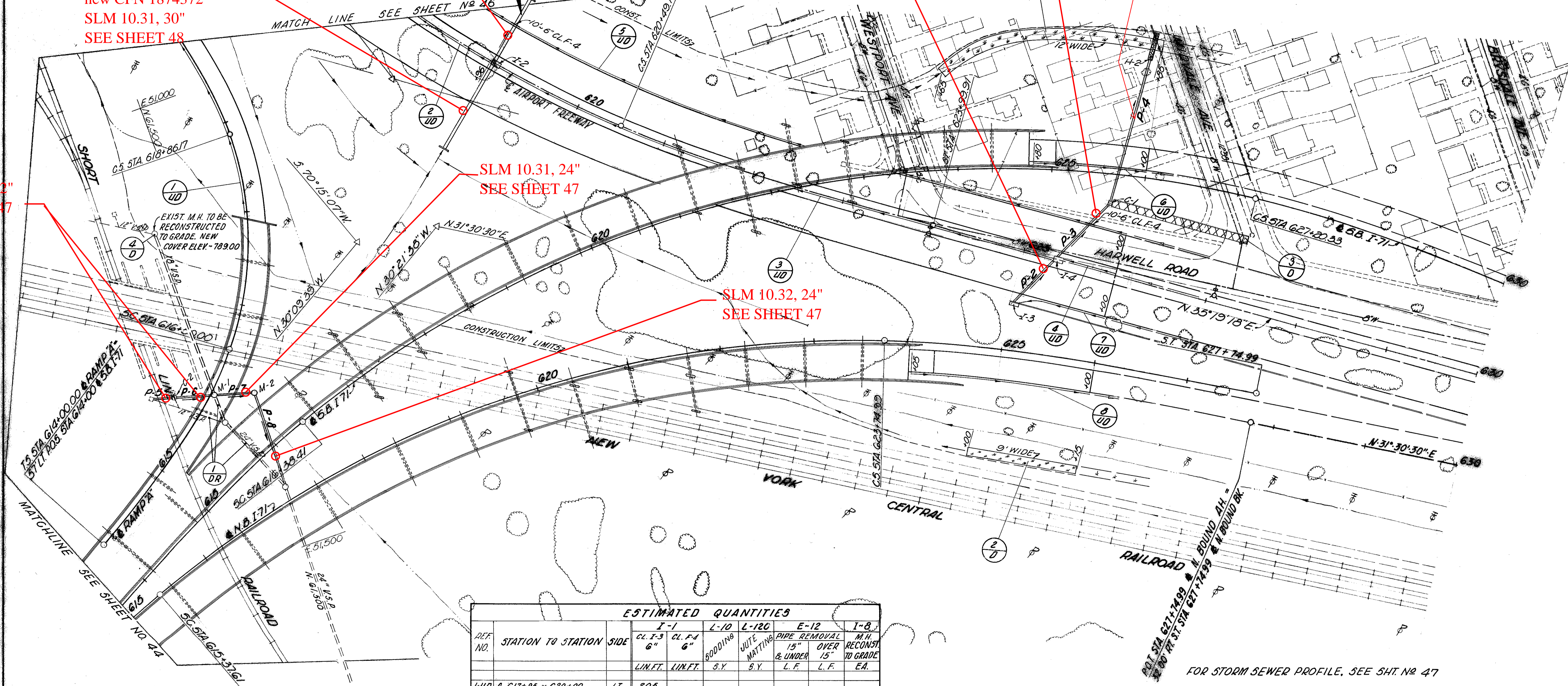

ESTIMATED QUANTITIES

REF. NO.	STATION TO STATION	SIDE	I-1		L-10	L-120	E-12		I-8
			CL. F-3 6"	CL. F-4 6"			PIPE REMOVAL 15" & UNDER	M.H. RECONSTR. TO GRADE	
			LIN.FT.	LIN.FT.	S.Y.	S.Y.	L.F.	L.F.	EA.
1-UD	A 617+95 ~ 620+00	LT.	205						
2-UD	618+10 ~ 618+96	E.	86						
3-UD	619+00 ~ 625+30	E.	620	10					
4-UD	625+35 ~ 626+00	E.	55	10					
5-UD	618+60 ~ 626+00	LT.	720	20					
6-UD	S.B. 624+60 ~ 626+00	RT.	120						
7-UD	625+00 ~ 626+00	RT.	30	10					
8-UD	N.B. 624+05 ~ 626+00	RT.	195						
4-D	617+90 RAMP "A"	LT.							1
1-D	623+65 ~ 625+85	LT.			320				
2-D	625+00 ~ 626+15	RT.			115				
3-D	625+70 ~ 627+20	LT.				125			
1-DR	615+40 ~ 615+80 S.B. L&R						95	125	
TOTALS			2091	50	435	125	95	125	1

XXXXXXXX JUTE MATTING
***** 50D

FOR STORM SEWER PROFILE, SEE SHT. No 47