

ESTIMATED QUANTITIES						
REF NO.	STATION TO STATION	SIDE	I-15		I-16	
			GUARD RAIL GUARD RAIL	STEEL BEAM STEEL BEAM	STEEL TYPE (12EET)	STEEL TYPE (12EET)
			LN FT	LN FT	EA	EA
1B	800+75 ~ 801+62.5	LT	187.5			
2B	797+00 ~ 800+25	E		32.5		
3B	800+25 ~ 802+75	E	50.0			
4B	802+75 ~ 805+00	E		22.5		
5B	798+55 ~ 800+03	RT	187.5			
6B	37+00 ~ 0+59 BELLAIRE		12.5			
10R	0+10 EMERY-HIRST CONN				1	
7G	35+92 ~ 36+80 RD 12	RT	87.5			
TOTAL			1077.5	550	1	

CURVE DATA
CURVE NO 6
 PI STA 797+37.47
 D = 04°17'40"LT
 D = 00°26'00"
 P = 12277.67'
 T = 460.55'
 L = 920.24'
 E = 8.65'

ABBREVIATIONS USED IN DRAINAGE PLAN AND PROFILE

- I- PROPOSED INLETS
- C- PROPOSED CATCH BASINS
- M- PROPOSED MANHOLES
- P- PROPOSED PIPES
- UD- UNDEDRAINS
- H- PROPOSED HEADWALLS
- D- DITCH PROTECTION
- 1-10, DUMPED ROCK CHANNEL PROTECTION
- L-10, SODDING
- L-120, JUTE MATTING

FOR DETAIL OF CUL-DE-SAC
 SEE SHEET NO. 135

FED. PROJ. DIVISION	STATE	PROJECT
2	OHIO	

CUYAHOGA COUNTY
 CUY-71-13.68

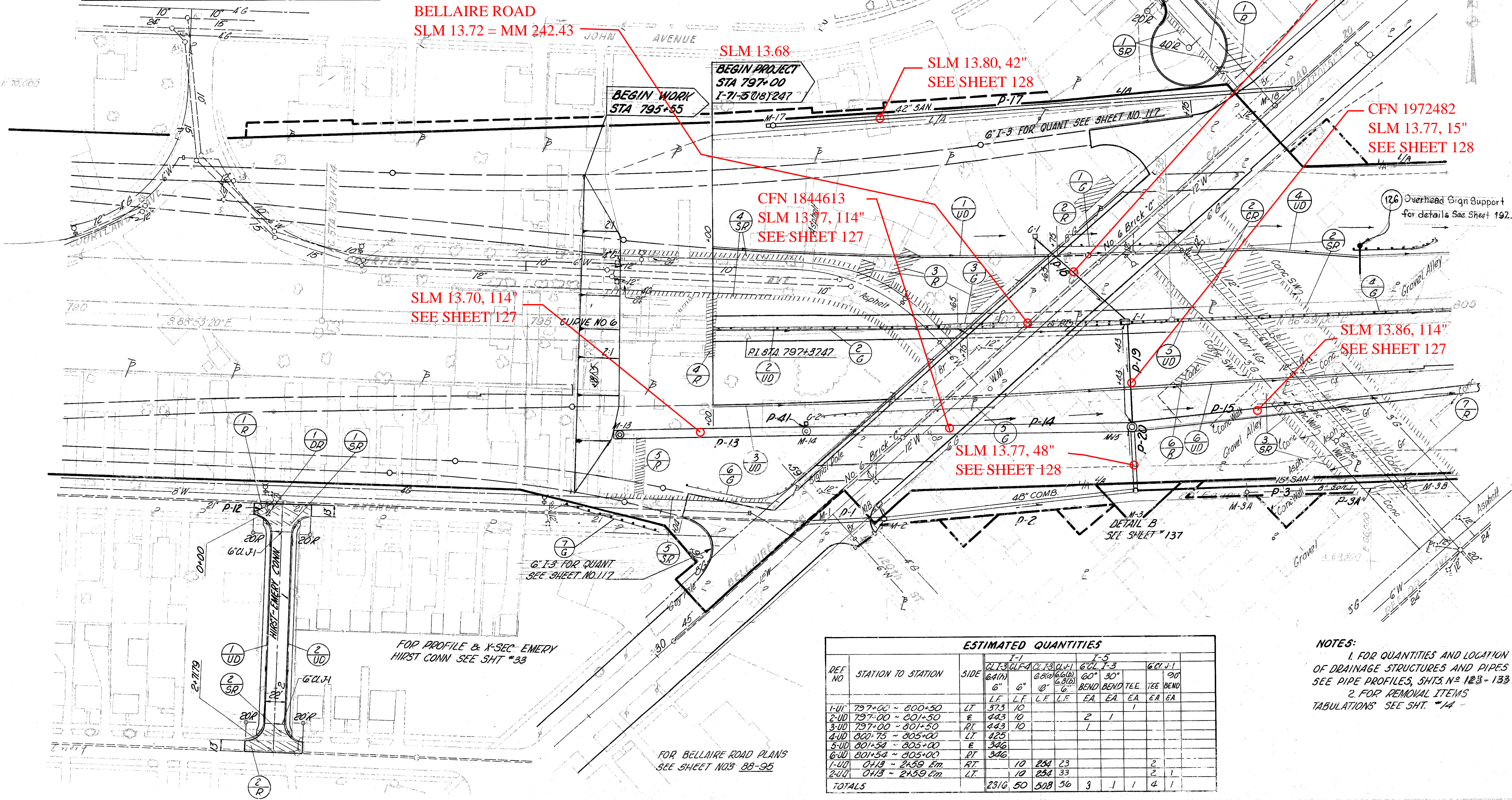

BELLAIRE ROAD
 SLM 13.72 = MM 242.43

SLM 13.68

SLM 13.80, 42"
 SEE SHEET 128

CFN 1972428
 SLM 13.77, 15"
 SEE SHEET 128

CFN 1972482
 SLM 13.77, 15"
 SEE SHEET 128

CFN 1844613
 SLM 13.77, 114"
 SEE SHEET 127

SLM 13.70, 114"
 SEE SHEET 127

SLM 13.86, 114"
 SEE SHEET 127

SLM 13.77, 48"
 SEE SHEET 128

FOR PROFILE & X-SEC- EMERY
 HIRST CONN SEE SHIT *33

FOR BELLAIRE ROAD PLANS
 SEE SHEET NOS 88-95

ESTIMATED QUANTITIES										
REF NO	STATION TO STATION	SIDE	I-1				I-3		I-5	
			6" (4.1h)	6" (6.6h)	8" (6.6h)	6" (6.6h)	BEND	BEND	TEE	TEE
			EA	EA	EA	EA	EA	EA	EA	
1-UI	797+00 ~ 800+50	LT	373	10						
2-UD	797+00 ~ 801+50	E	443	10						
3-UD	797+00 ~ 801+50	RT	443	10						
4-UD	800+75 ~ 805+00	LT	125							
5-UD	801+54 ~ 805+00	E	346							
6-UD	801+54 ~ 805+00	RT	346							
1-UD	0+13 ~ 2+59 Em.	RT		10	254	23			2	
2-UD	0+13 ~ 2+59 Em.	LT		10	254	33			2	
TOTALS			2316	50	508	56	3	1	1	4

NOTES:
 1. FOR QUANTITIES AND LOCATION OF DRAINAGE STRUCTURES AND PIPES SEE PIPE PROFILES, SHTS N^o 123-133
 2. FOR REMOVAL ITEMS TABULATIONS SEE SHT. *14

000 7-5-84