

CUYAHOGA COUNTY
CUY-71-13.68

ESTIMATED QUANTITIES					
REF NO.	STATION TO STATION	SIDE	I-15		E-8
			GUARDRAIL STANDARD TYPE (DEEP)	GUARDRAIL BARRIER TYPE DEEP	REMOVAL & DISPOSE OF EXISTING ASPHERUM SQ. YDS.
			LIN. FT.	LIN. FT.	SQ. YDS.
1G	807+95 ~ 809+45	LT	137.5		
2G	805+00 ~ 808+00	E		300	
3G	808+00 ~ 810+25	E	450		
4G	810+25 ~ 814+25	E		400	
5G	814+25 ~ 816+12.5	E	375		
6G	816+12.5 ~ 820+00	E		3875	
7G	808+69 ~ 810+19	RT	137.5		
8G	810+00 ~ 810+00	LT	25		
9G	806+00 ~ 806+00	RT	375		
10G	816+37 ~ 817+00	LT	75		
11G	814+74 ~ 814+74	RT	75		
12G	810+00 ~ 810+00	LT		27	
22R	806+00 ~ 806+00	RT		167	
TOTAL			1612.5	1187.5	194

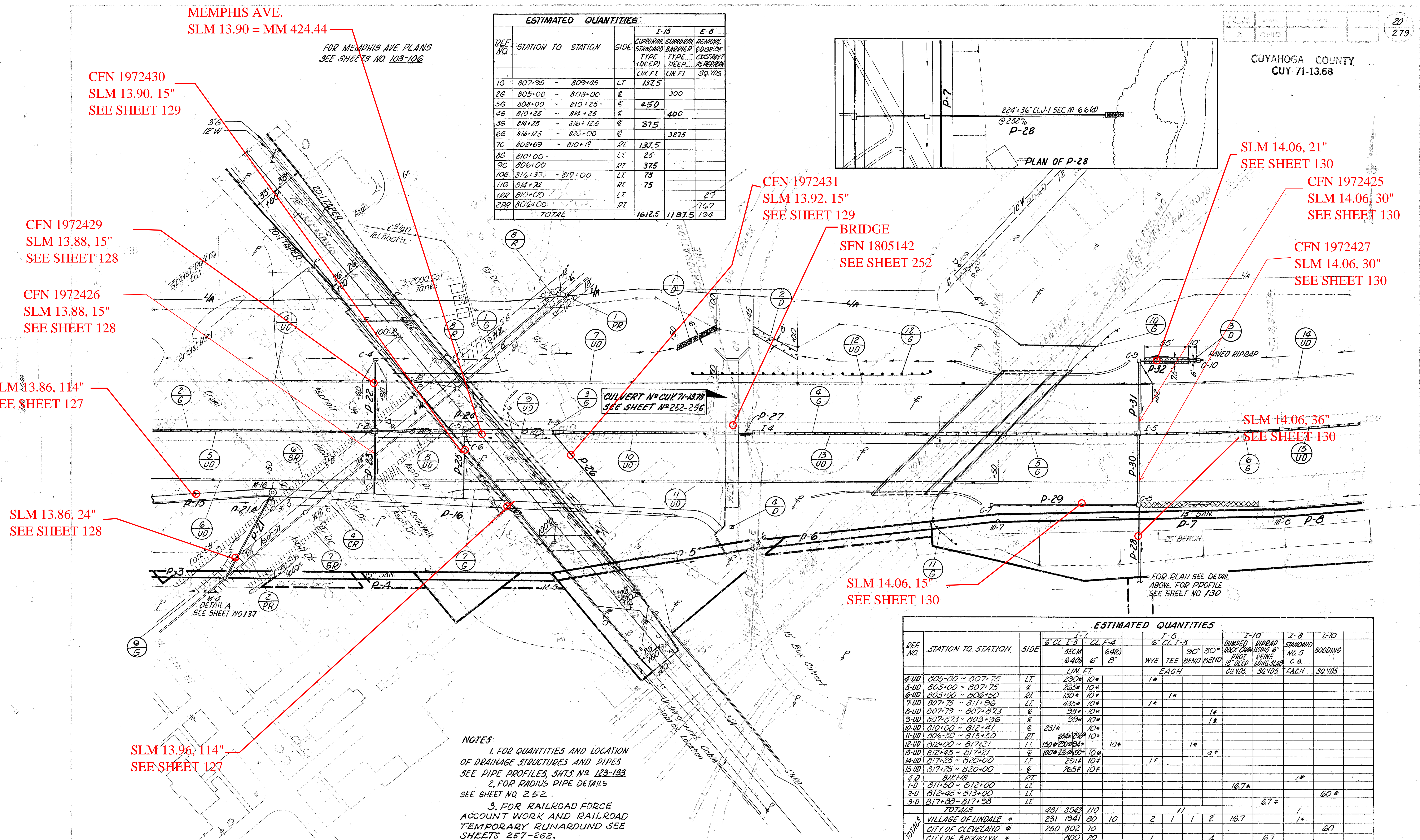
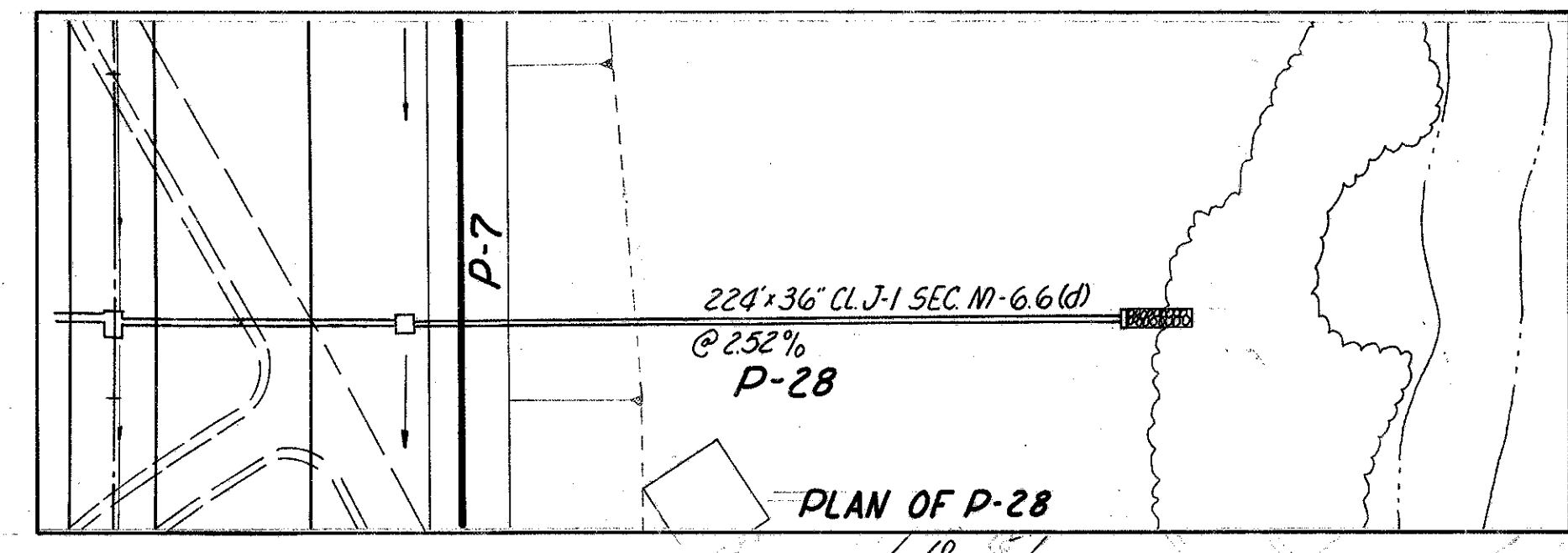

CFN 1972430
SLM 13.90, 15"
SEE SHEET 129

FOR MEMPHIS AVE. PLANS
SEE SHEETS NO. 103-106

CFN 1972429
SLM 13.88, 15"
SEE SHEET 128

CFN 1972426
SLM 13.88, 15"
SEE SHEET 128

SLM 13.86, 114"
SEE SHEET 127

SLM 13.86, 24"
SEE SHEET 128

SLM 13.96, 114"
SEE SHEET 127

CFN 1972431
SLM 13.92, 15"
SEE SHEET 129

BRIDGE
SFN 1805142
SEE SHEET 252

SLM 14.06, 21"
SEE SHEET 130

CFN 1972425
SLM 14.06, 30"
SEE SHEET 130

CFN 1972427
SLM 14.06, 30"
SEE SHEET 130

SLM 14.06, 36"
SEE SHEET 130

SLM 14.06, 15"
SEE SHEET 130

NOTES:
1. FOR QUANTITIES AND LOCATION OF DRAINAGE STRUCTURES AND PIPES SEE PIPE PROFILES, SHTS N° 123-133
2. FOR RADIUS PIPE DETAILS SEE SHEET NO. 252.
3. FOR RAILROAD FORCE ACCOUNT WORK AND RAILROAD TEMPORARY RUNAROUND SEE SHEETS 257-262.

ESTIMATED QUANTITIES											
REF NO.	STATION TO STATION	SIDE	I-1			I-5		I-10		I-8	I-10
			6" CL I-3	CL F-4	6" CL I-3	90°	30°	DUMPED RIPRAP	STANDARD	SODDING	
			SEC. M	6" 8"	WYE	TEE	BEND	BEND	NO. 5	SQ. YDS.	
			LIN. FT.		EACH	EACH	EACH	EACH	C.B.	SQ. YDS.	
4-UD	805+00 ~ 807+75	LT	290*	10*							
5-UD	805+00 ~ 807+75	E	265*	10*							
6-UD	805+00 ~ 806+30	RT	150*	10*	1*						
7-UD	807+75 ~ 811+96	LT	435*	10*	1*						
8-UD	807+75 ~ 807+87.3	E	38*	10*			1*				
9-UD	807+87.3 ~ 809+96	E	99*	10*			1*				
10-UD	810+00 ~ 812+41	E	231*	10*							
11-UD	806+50 ~ 815+50	RT	160*	10*							
12-UD	812+00 ~ 817+21	LT	150*	10*			1*				
13-UD	812+45 ~ 817+21	E	102*	10*				4*			
14-UD	817+25 ~ 820+00	LT	231*	10*	1*						
15-UD	817+75 ~ 820+00	E	265*	10*							
4-D	812+18	RT							1*		
1-D	811+50 ~ 812+00	LT								16.7*	
2-D	812+45 ~ 813+00	LT								60*	
3-D	817+88 ~ 817+98	LT								6.7*	
TOTALS			481	3543	110						
VILLAGE OF LINDALE *			231	1941	80	10					
CITY OF CLEVELAND *			250	802	10						
CITY OF BROOKLYN *				800	20						