

CURVE DATA

CURVE NO. 7	SPIRAL NO. 7
$\Delta = 26^{\circ}12'39" \text{ LT}$	$L_s = 350.00'$
$\Delta c = 19^{\circ}12'39" \text{ LT}$	$\theta = 03^{\circ}30'00"$
$D = 02^{\circ}00'00"$	$P = 1.78'$
$R = 2804.79'$	$K = 174.98'$
$T = 484.82'$	$LT = 233.38'$
$L = 960.54'$	$ST = 116.71'$
$E = 40.74'$	$T_s = 842.34'$
	$E_s = 78.44'$

ESTIMATED QUANTITIES

REF. NO.	STATION TO STATION	SIDE	I-15	
			STANDARD GUARD RAIL LIN. FT.	BARRIER GUARD RAIL LIN. FT.
1-G	829+00 ~ 830+25	LT	125	
2-G	820+00 ~ 835+00	R		1500
3-G	825+50 ~ 835+00	RT	950	
4-G	834+75 ~ 835+00		25	
TOTALS			1100	1500

CFN 1972466
 SLM 14.39, 15"
 SEE SHEET 129

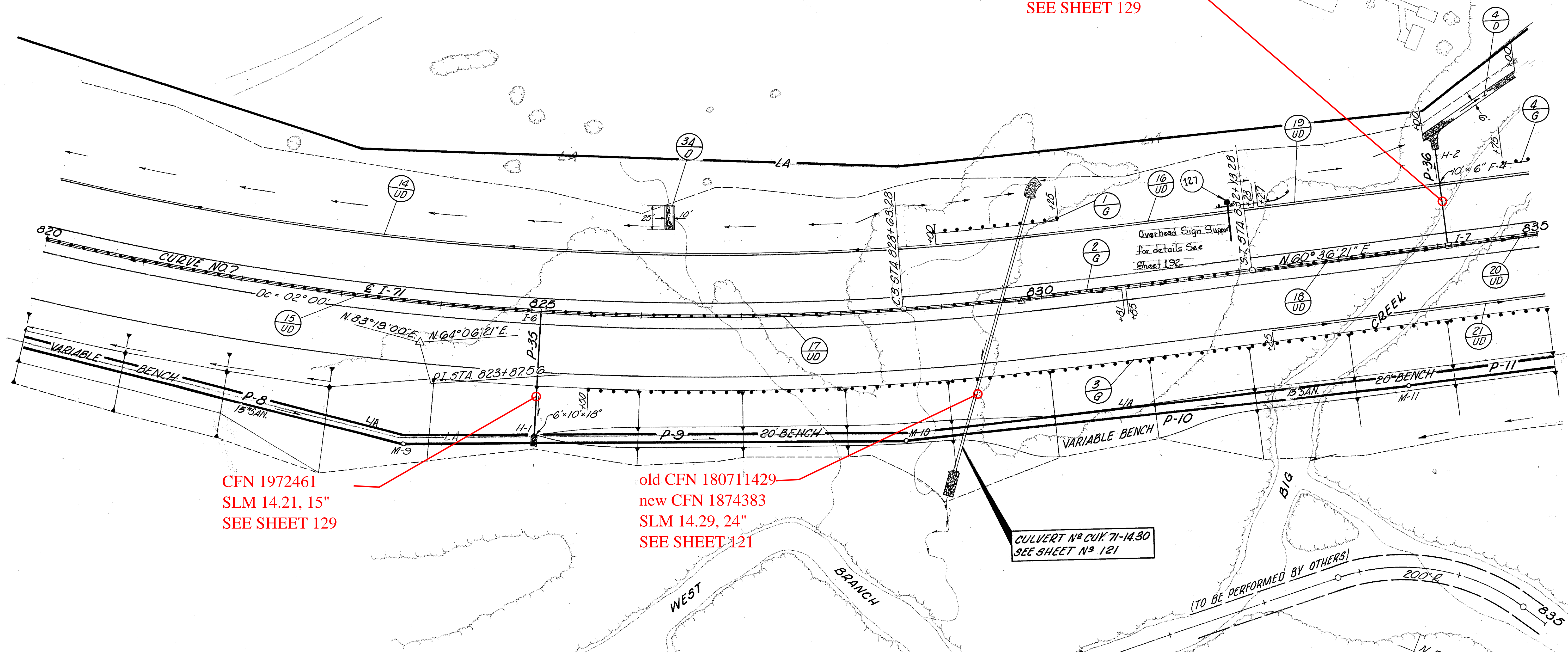

CFN 1972461
 SLM 14.21, 15"
 SEE SHEET 129

old CFN 180711429
 new CFN 1874383
 SLM 14.29, 24"
 SEE SHEET 121

ESTIMATED QUANTITIES

REF. NO.	STATION TO STATION	SIDE	I-1		I-5		I-10 DUMPED ROCK CHAN. PROT. 18" DEEP CULDS	
			6" CL I-3 SEG. M 64(h)	CL F-4 6" 8"	6" CL I-3 90° BEND EA.			
14-UD	820+00 ~ 828+96	LT	596	300				
15-UD	820+00 ~ 824+96	R	196	300				
16-UD	829+00 ~ 832+23	LT	333		10	1		
17-UD	825+00 ~ 830+81	R	571	10				
18-UD	830+85 ~ 834+10	R	315	10				
19-UD	832+27 ~ 835+00	LT	263	10				
20-UD	834+14 ~ 835+00	R	86					
21-UD	832+25 ~ 835+00	RT	275					
3A-D	826+20	LT					13.9	
4-D	834+00 ~ 835+00	LT					36.6	
TOTALS			2635	600	30	10	1	50.5

NOTES:
 1. FOR QUANTITIES AND LOCATION
 OF DRAINAGE STRUCTURES AND PIPES
 SEE PIPE PROFILES, SHTS. N° 123-133

DESCRIPTION
 PLOTTED
 INKED
 CHECKED
 DATE
 BY
 DATE
 BY
 DATE
 BY