

EST. ESTIMATED QUANTITIES

DEF. NO.	STATION TO STATION	SIDE	I-1		I-5				I-16		
			AS PER PLAN		30°		60°		WYE	TEE	ABAND.
			SHALLOW	DEEP	BEND	BEND	BEND	BEND			
			6"	6"	6"	6"	6"	6"	6"		
	LIN. FT.	LIN. FT.	LIN. FT.	EA.	EA.	EA.	EA.	EA.	M.H.		
1UD	941+23 ~ 946+00	LT		503	10						
2UD	941+70 ~ 946+00	RT	420		10						
3UD	942+00 ~ 946+08	RT		402	10			1			
4UD	946+02 ~ 950+92A	LT		506	10						
5UD	946+04 ~ 951+00	RT	492		10	4					
6UD	946+05 ~ 951+00	RT		491	10	5					
7UD	946+15 ~ 948+45E	RT		229	5				1		
8UD	948+62 ~ 951+18E	RT		248	10	1					
9UD	950+96 ~ 953+00A	LT		404							
10UD	951+20 ~ 955+00	LT		380							
11UD	951+04 ~ 955+00	RT	404								
12UD	951+04 ~ 955+00	RT		404							
13UD	951+38 ~ 955+00E	RT		364		2					
14UD	951+22 ~ 955+00E	RT		378	10						
1DR	951+06	RT								1	
2DR	952+16	LT								1	
	SUB-TOTAL										
	TOTAL		1316	4309	85	12	1	1	1	2	

CUYAHOGA COUNTY
CUY-71-15.06

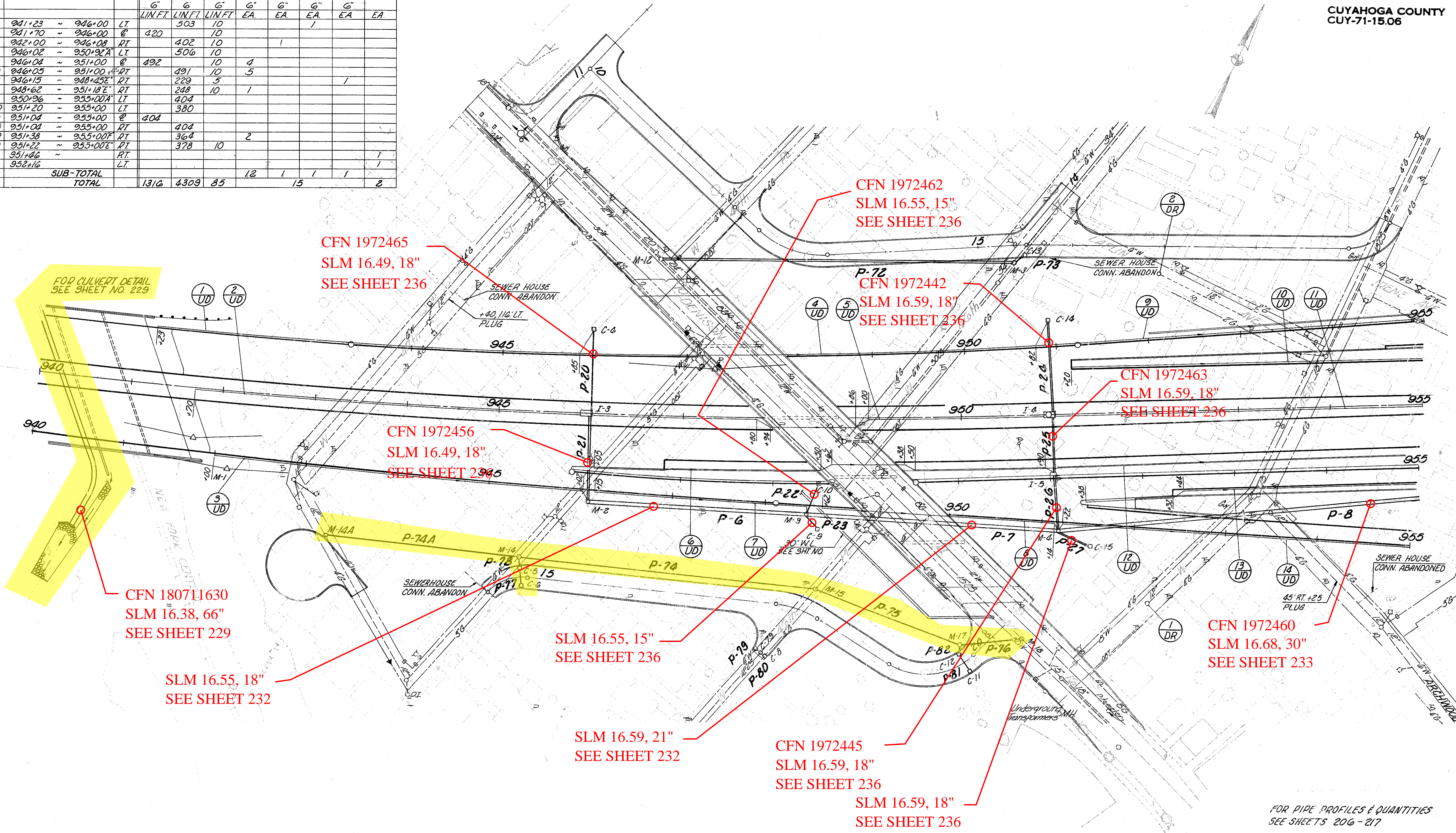

FOR PIPE PROFILES & QUANTITIES
SEE SHEETS 206-217