

SECTION OF SODDED DITCH D-9
D-7 Sta. 909+50 to 912+25 Rt. N.B. Medina

DRAINAGE QUANTITIES			
CODE	LOCATION	L-10	
		Sodding	I-14
DITCH PROTECTION		Sq. Yd.	Lin. Ft.
D-9	N.B. Medina Rt. 909+50 to 912+25	199	
D-10	S.B. Medina Rt. 910+00 to 913+50	58	350
Total		257	350

DRAINAGE QUANTITIES					
CODE	LOCATION	I-1			I-5
		Cl. I-3 Shallow	Cl. I-3 Deep	Cl. F4	Cl. I-3 60° Bend 6"
UNDERDRAINS		Lin. Ft.			
U-80	Ramp 14-M Rt. 16+90 to 19+15		220	5	1
U-81	Ramp 14-M Rt. 15+77 to 16+90		111	5	1
U-82	S.B. Medina Lt. 910+00 to 912+75		268	10	
U-83	S.B. Medina Lt. 912+75 to 913+50	68		10	
U-84	N.B. Medina Lt. 909+35 to 913+00	365			
Total		433	599	30	2

DRAINAGE LEGEND

- ⊕ PROPOSED STORM SEWER MANHOLE
- ⊙ PROPOSED SANITARY MANHOLE
- PROPOSED PAVED SHOULDER INLET
- ▣ PROPOSED DITCH CATCH BASIN
- ▤ PROPOSED PAVEMENT CATCH BASIN
- PROPOSED STORM OR SANITARY SEWER
- EXISTING MANHOLE
- EXISTING CATCH BASIN
- EXISTING STORM OR SANITARY SEWER
- ▨ JUTE MATTING
- ▩ SODDED DITCH

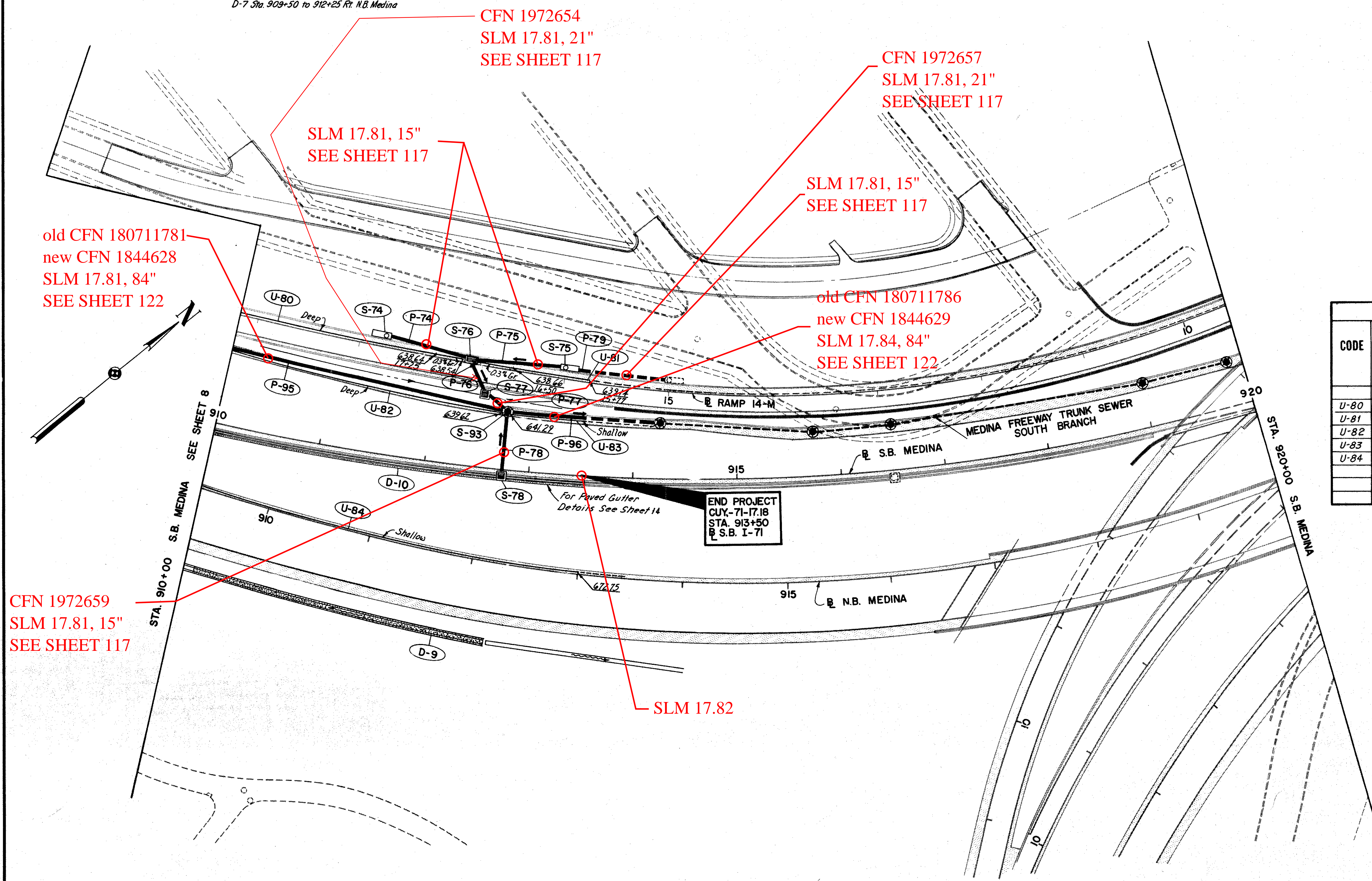

old CFN 180711781
new CFN 1844628
SLM 17.81, 84"
SEE SHEET 122

CFN 1972654
SLM 17.81, 21"
SEE SHEET 117

CFN 1972657
SLM 17.81, 21"
SEE SHEET 117

SLM 17.81, 15"
SEE SHEET 117

SLM 17.81, 15"
SEE SHEET 117

old CFN 180711786
new CFN 1844629
SLM 17.84, 84"
SEE SHEET 122

CFN 1972659
SLM 17.81, 15"
SEE SHEET 117

SLM 17.82

END PROJECT
CUY-71-17.18
STA. 913+50
S.B. I-71

SCALE _____ HOWARD, NEEDLES, TAMMEN & BERGENDOFF
MADE R.D. DATE 2-10-65 CONSULTING ENGINEERS
TRCD. DATE _____ KANSAS CITY CLEVELAND NEW YORK
CKD R.W.T. DATE 2-12-65

