

SLM 9.60 = MM 237.84

FOR PLAN & PROFILE RAMP "R" SEE SHEET 21822

FED. RD. DIVISION	STATE	PROJECT	FISCAL YEAR
2	OHIO		

17  
163

CUYAHOGA COUNTY  
CUY - 71-9.60

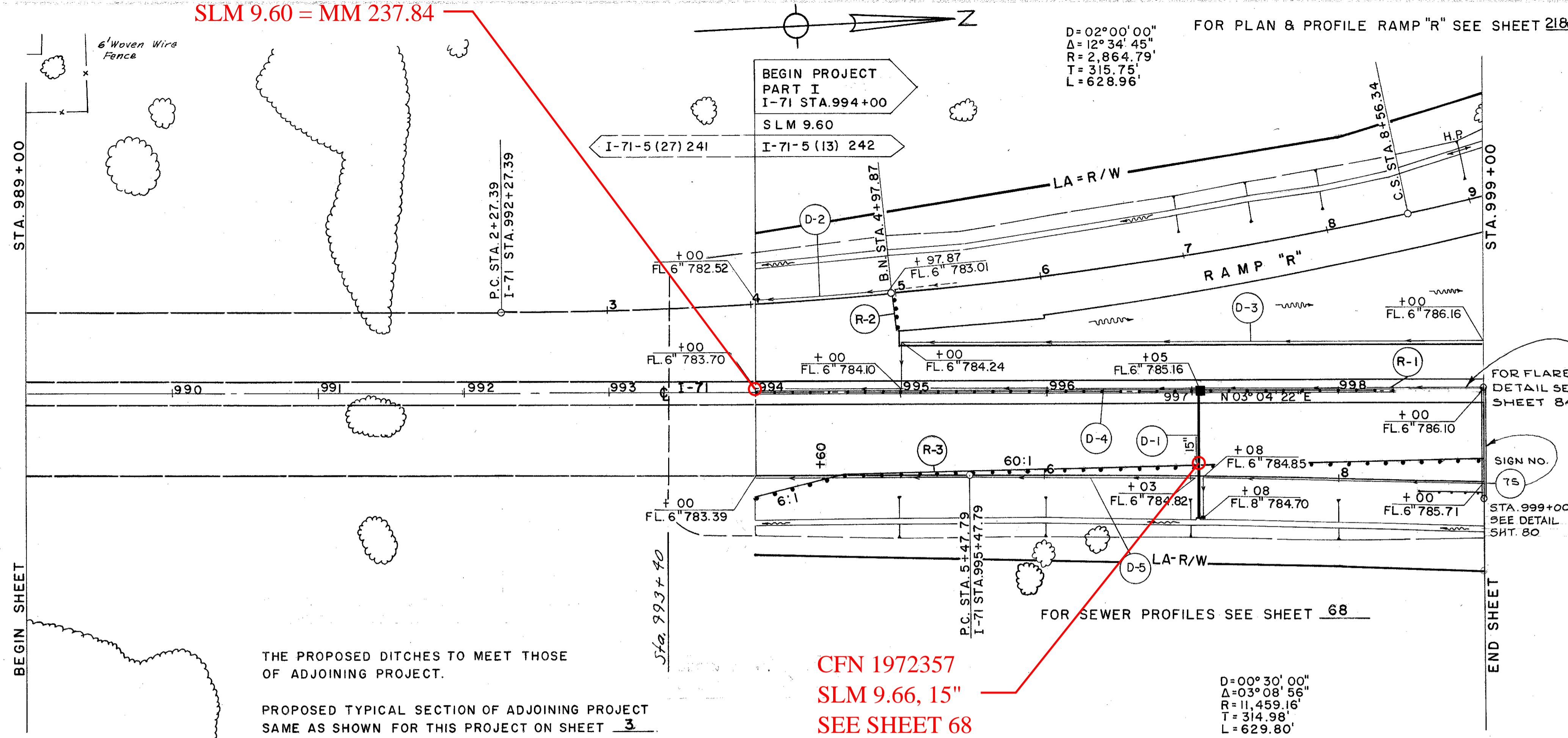

CFN 1972357  
SLM 9.66, 15"  
SEE SHEET 68

D=00°30'00"  
Δ=03°08'56"  
R=11,459.16'  
T=314.98'  
L=629.80'

Ⓓ DRAINAGE

REF. NO.	STATION		SIDE	PIPE						I-2 MASONRY	I-10 SODDING		
	FROM	TO		CLASS I-3	CLASS F-4	CLASS I-1	CLASS F-4	CLASS J-1	CLASS I-6			CLASS I-5	
				LIN. FT.			EACH		C.Y.	S.Y.			
D-1	997+05		RT.					88	1		0.26	2	
D-2	994+00	4+9787	LT.	93									
D-3	995+00	999+00	LT.	400	30				1				
D-4	994+00	999+00	LT.	490	10					1			
D-5	994+00	999+00	RT.	513		10			1				
TOTAL				1496	10	30	10	88	1	2	1	0.26	2

Ⓔ ROADWAY

R.F.M.R. NO.	STATION		SIDE	I-15	
	FROM	TO		GUARD RAIL STEEL BEAM (DEEP) BARRIER	TEMPORARY GUARD RAIL
				LIN. FT.	
R-1	994+00	998+37.5	LT.	437.5	
R-2	4+9787	RAMP "R"	RT.		25
R-3	994+00	999+00	RT.		500
TOTAL				437.5	525

