

CUYAHOGA COUNTY
SEC. CUY - 525-0.00, CUY-2-28.16
LAKE COUNTY
SEC. LAK - 525-0.00

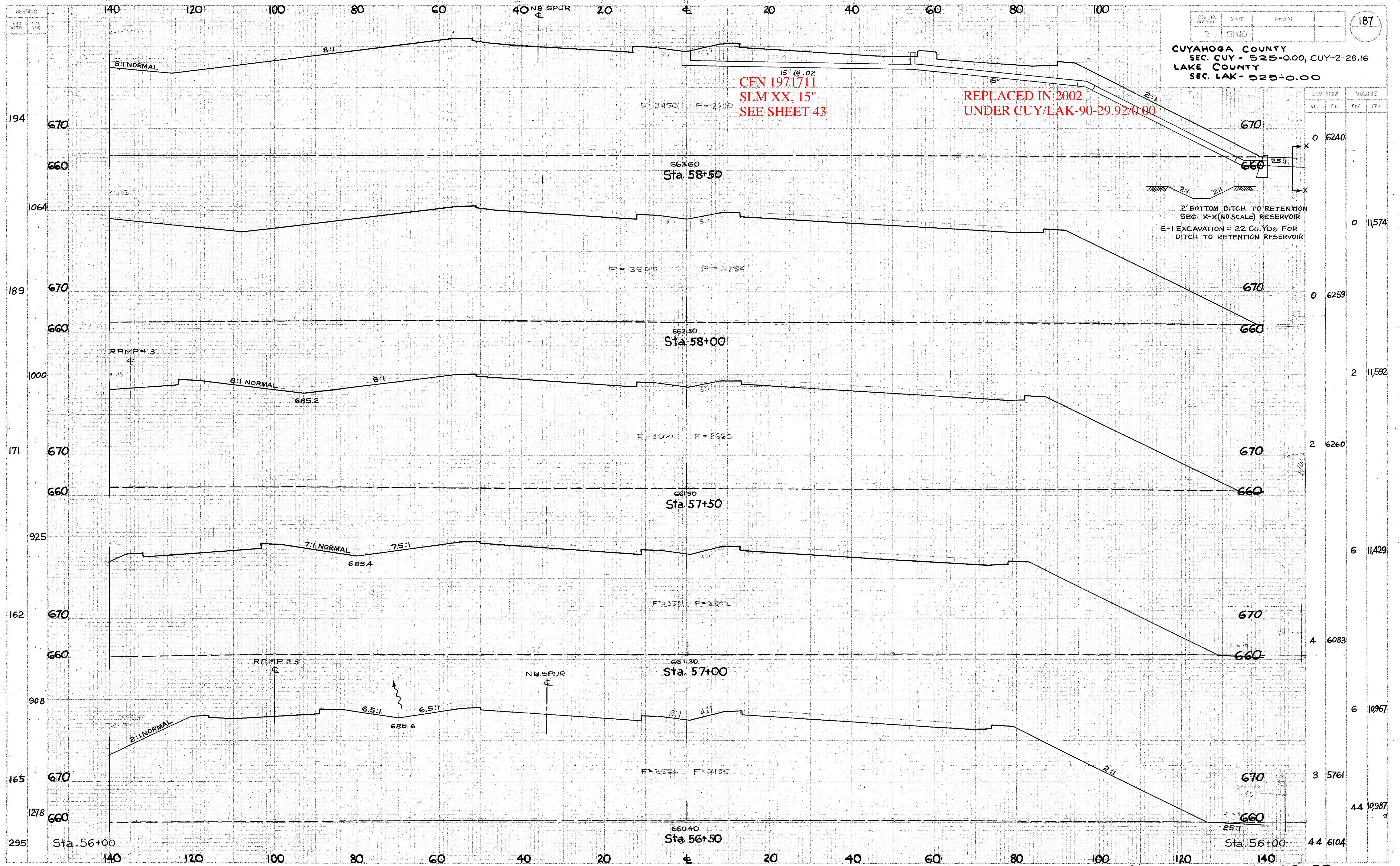

CFN 1971711
SLM XX, 15"
SEE SHEET 43

REPLACED IN 2002
UNDER CUY/LAK-90-29.92/0.00

2' BOTTOM DITCH TO RETENTION
SEC. X-X (NO SCALE) RESERVOIR
E-1 EXCAVATION = 22 Cu. Yds FOR
DITCH TO RETENTION RESERVOIR

END AREA	VOLUME	
	CUT	FILL
0 6240		
0 11574		
0 6259		
2 11592		
2 6260		
6 11429		
4 6083		
6 10967		
3 5761		
44 10987		
44 6104		

EUCLID SPUR X-SECTIONS STA. 56+50 TO STA. 58+50