

SEEDING
END 59
DATE 7/11

34
277

LAKE COUNTY
LAK-1-6.97

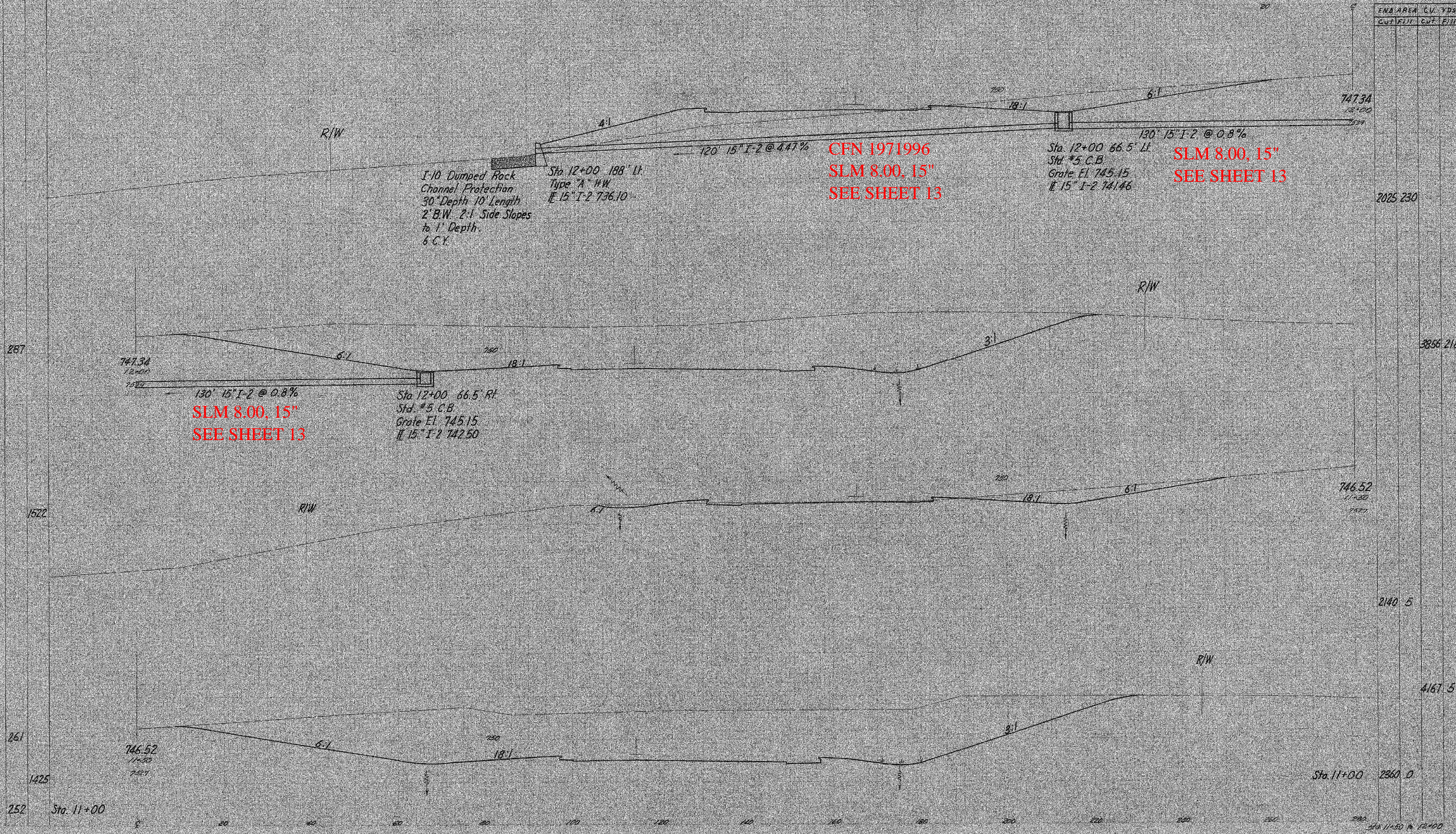

I-10 Dumped Rock
Channel Protection
30" Depth 10' Length
2' B.W. 2:1 Side Slopes
to 1' Depth.
6 C.Y.

Sta. 12+00 188' Lt.
Type "A" H.W.
15" I-2 736.10

CFN 1971996
SLM 8.00, 15"
SEE SHEET 13

Sta. 12+00 66.5' Lt.
Std. #5 C.B.
Grate El. 745.15
15" I-2 741.46

SLM 8.00, 15"
SEE SHEET 13

SLM 8.00, 15"
SEE SHEET 13

Sta. 12+00 66.5' Rt.
Std. #5 C.B.
Grate El. 745.15
15" I-2 742.50

Sta. 11+00 2860.0