

old CFN 180901811
new CFN 1882340
SLM 18.11, 60"
SEE BELOW

old CFN 180901809
new CFN 1882339
SLM 18.09, 60"
SEE BELOW

old CFN 18091827
new CFN 1882618
SLM 18.27, 72"
SEE BELOW

**CUYAHOGA COUNTY 124
CUY-42R-19.78**

N.Y.C.R.R.-INNERBELT PROPOSED STRUCTURE
TYPE: Steel girder bridge with reinf. conc. superstructure.
SPANS: Two @ 64'-0" clear (normal to E. highway.)
WIDTH: 8 Tracks @ 10' Roadway, 115' along E. highway.
CLEARANCE: 15'-0" minimum.
LOADING: Coopers E-72
SKEW: Varies

For I-4 Underdrain
Table See Sh #28

SLM 18.09, 18"
SLM 18.09, 18"
SLM 18.11, 12"
SLM 18.11, 12"

old CFN 180901815
new CFN 1882341
SLM 18.15, 60"
SEE BELOW

old CFN 180901818
new CFN 1882342
SLM 18.18, 60"
SEE BELOW

| Item No. | Station | Mon. Box Assembly Type A | Monument Box Type B |
|----------|----------|--------------------------|---------------------|
| 1-M | 73+45.03 | 1 | 1 |
| 2-M | 75+53.03 | 1 | 1 |
| 3-M | 79+25.47 | 1 | 1 |
| 4-M | 80+16.23 | 1 | 1 |
| Totals | | 2 | 2 |

| Ref. | Station | Side | I-4 Lin. Ft. |
|-------|---------|------|--------------|
| 1-P | 69+28 | To | 75 |
| 1-P | 70+03 | Lt. | 75 |
| TOTAL | | | 75 |

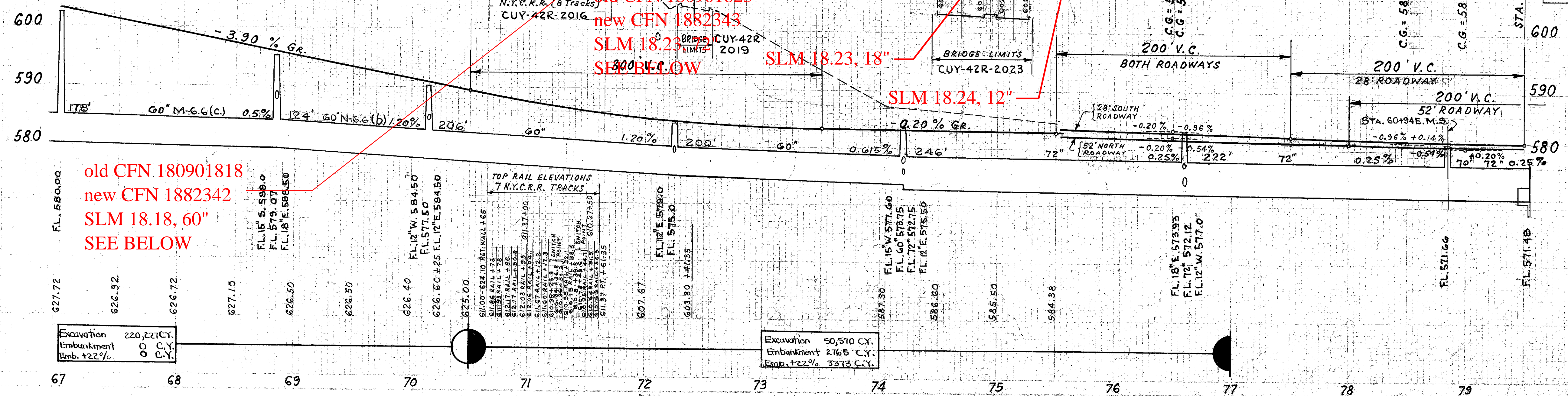

| Ref No | Station | Side or Lt. | 12" CL | | 15" CL | | 18" CL | | 24" CL | | TOTAL |
|--------|---------|-------------|--------|-----|--------|-----|--------|-----|--------|-----|-------|
| | | | A | B | A | B | A | B | A | B | |
| 1-5 | 67+0 | 68+88 | 18 | 64 | 18 | 64 | 18 | 64 | 18 | 64 | 178 |
| 2-5 | 68+85 | 70+15 | 54 | 54 | 54 | 54 | 54 | 54 | 54 | 206 | |
| 3-5 | 70+15 | 72+25 | 64 | 64 | 64 | 64 | 64 | 64 | 64 | 206 | |
| 4-5 | 72+25 | 74+20 | 74 | 74 | 74 | 74 | 74 | 74 | 74 | 222 | |
| 5-5 | 74+20 | 76+01.5 | 76 | 76 | 76 | 76 | 76 | 76 | 76 | 222 | |
| 6-5 | 76+01.5 | 77+25 | 42 | 42 | 42 | 42 | 42 | 42 | 42 | 178 | |
| 7-5 | 77+25 | 79+25 | 42 | 42 | 42 | 42 | 42 | 42 | 42 | 178 | |
| 8-5 | 79+25 | 80+16.23 | 55 | 55 | 55 | 55 | 55 | 55 | 55 | 178 | |
| TOTALS | 50 | 62 | 232 | 184 | 182 | 124 | 406 | 124 | 178 | 538 | 55 |

PLAN & PROFILE INNERBELT STA. 67+00 to STA. 79+25.47 INNERBELT EAST & STA. 80+16.23 INNERBELT SOUTH