

SNOW ROAD  
SLM 8.84 = MM 237.55

CFN 1972294  
SLM 8.88, 15"  
SEE SHEET 111

CFN 1972284  
SLM 8.77, 15"  
SEE SHEET 111

CFN 1972269  
SLM 8.84, 21"  
SEE SHEET 111

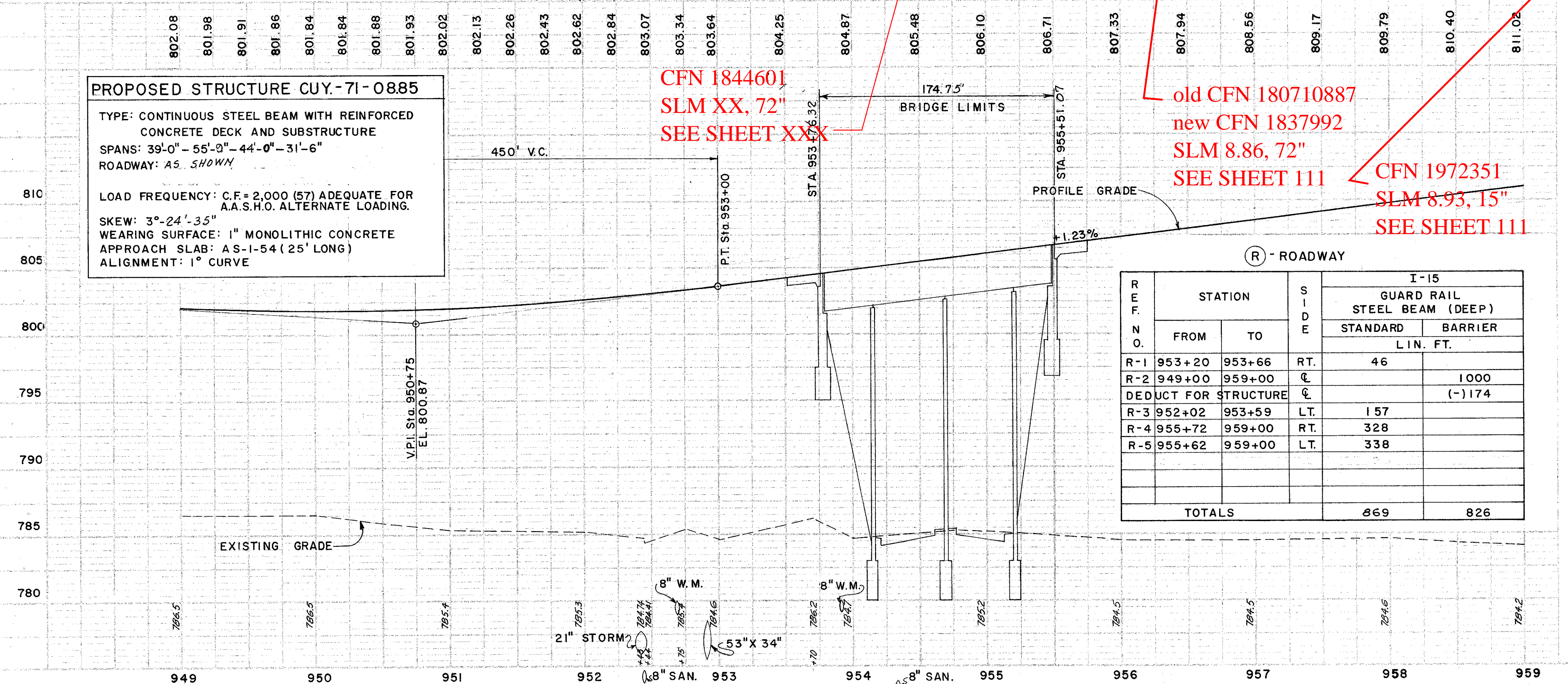
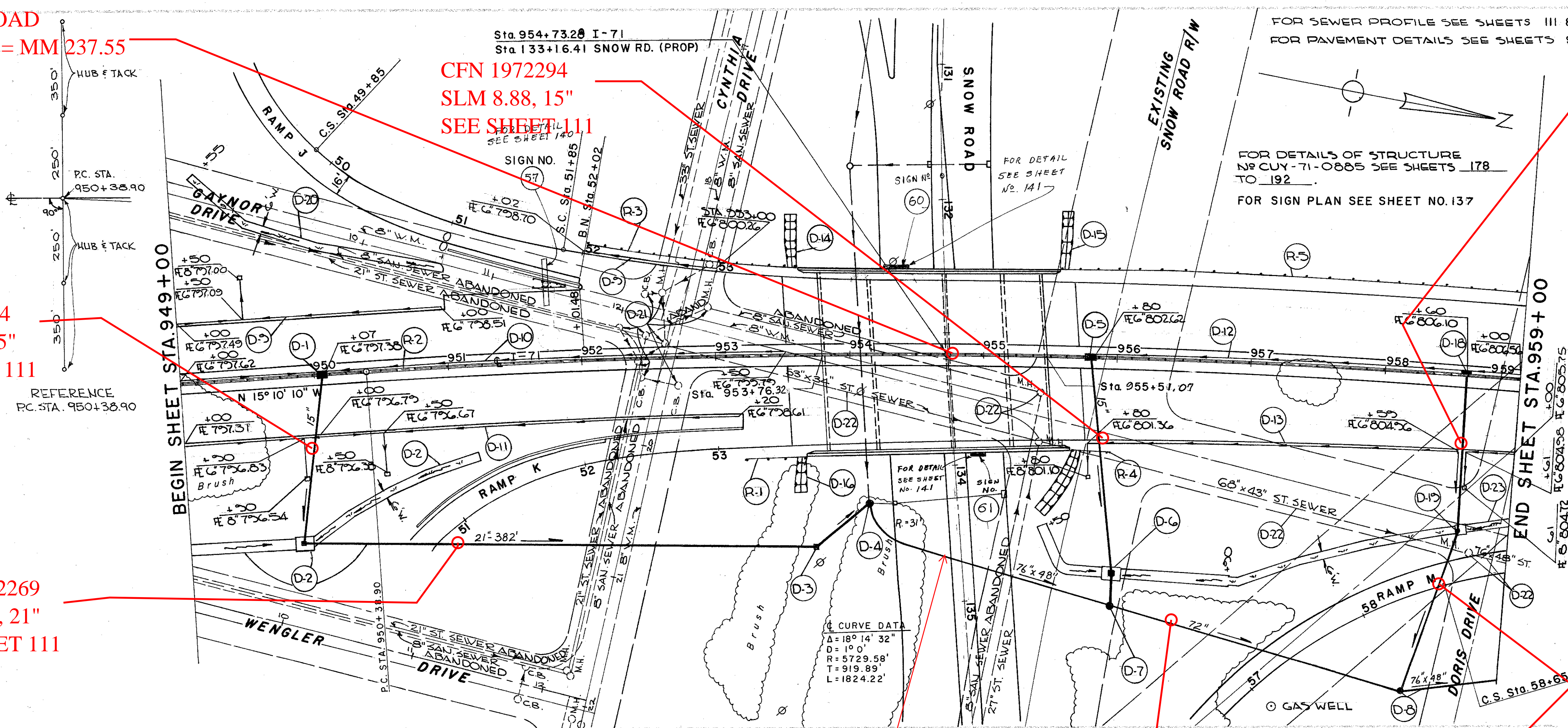

**PROPOSED STRUCTURE CUY.-71-0885**  
TYPE: CONTINUOUS STEEL BEAM WITH REINFORCED CONCRETE DECK AND SUBSTRUCTURE  
SPANS: 39'-0" - 55'-0" - 44'-0" - 31'-6"  
ROADWAY: AS SHOWN  
LOAD FREQUENCY: C.F.=2,000 (57) ADEQUATE FOR A.A.S.H.O. ALTERNATE LOADING.  
SKEW: 3°-24'-35"  
WEARING SURFACE: 1" MONOLITHIC CONCRETE  
APPROACH SLAB: AS-1-54 (25' LONG)  
ALIGNMENT: 1° CURVE

CFN 1844601  
SLM XX, 72"  
SEE SHEET XXX

old CFN 180710887  
new CFN 1837992  
SLM 8.86, 72"  
SEE SHEET 111

CFN 1972351  
SLM 8.93, 15"  
SEE SHEET 111

(R) - ROADWAY

REF. NO.	STATION		SIDE	I-15 GUARD RAIL STEEL BEAM (DEEP)	
	FROM	TO		STANDARD	BARRIER
R-1	953+20	953+66	RT.	46	
R-2	949+00	959+00	℄		1000
DEDUCT FOR STRUCTURE					(-) 174
R-3	952+02	953+59	LT.	157	
R-4	955+72	959+00	RT.	328	
R-5	955+62	959+00	LT.	338	
TOTALS				869	826

D - DRAINAGE QUANTITIES FOR SHEET NO. 21

REF. NO.	STATION	FROM	TO	SIDE	LIN. FT.	
					ST. Y.	EACH
E-12	PIPE REMOVAL & OVER					
I-16	ABANDONED C.B. M.H.					
L-10	SODDING - SPL BERM & SLOPE PROTECTION					
L-10	JUTE MATTING					
L-10	SODDING					
I-8	STD. NO. 2 W/O DROP					
I-8	STD. NO. 5 C.B.					
I-8	STD. 2-A-8 PVD. SHLDR. INLET					
I-8	MOD. 2-A-8 PVD. SHLDR. INLET					
I-8	MOD. 2-A-10 PVD. SHLDR. INLET					
I-5	15" BEND CLASS F-4					
I-5	15" X 10" BEND CLASS F-4					
I-5	6" TEE CLASS I-3					
I-5	6" X 90° BEND CLASS I-3					
I-5	76" X 48" R PIPE CLASS G-1 M-6.7 (b)					
I-5	76" X 48" PIPE CLASS G-1 M-6.7 (b)					
I-5	72" PIPE CLASS J-1 M-6.6 (c)					
I-5	24" PIPE CLASS E-1					
I-5	21" PIPE CLASS J-1 SEC. M-6.6 (c)					
I-5	15" PIPE CLASS F-4					
I-5	15" PIPE CLASS J-1					
I-5	15" PIPE CLASS E-1					
I-5	8" PIPE CLASS F-4 M-6.4 (c)					
I-5	6" PIPE CLASS F-4					
I-5	6" PIPE CLASS I-3					
TOTAL					1855	50

PLAN & PROFILE - STA. 949+00 TO STA. 959+00