

CUYAHOGA COUNTY
CUY. 480-21.40

DRAINAGE LEGEND

- Proposed Drainage Ditch 20'R
- Proposed Storm and Sanitary Sewers
- Proposed Underdrains
- Existing Storm Sewers
- Existing Sanitary Sewers
- Existing Water Mains
- Proposed Storm Manhole
- Proposed Sanitary Manhole
- Proposed Median Inlet
- Proposed Paved Shoulder Inlet
- Proposed Ditch Catch Basin
- Proposed Pavement Catch Basin
- Existing Storm and Sanitary Manholes
- Existing Storm Inlets
- Jute Matting
- Rock Channel Protection
- Sod
- Paved Gutter

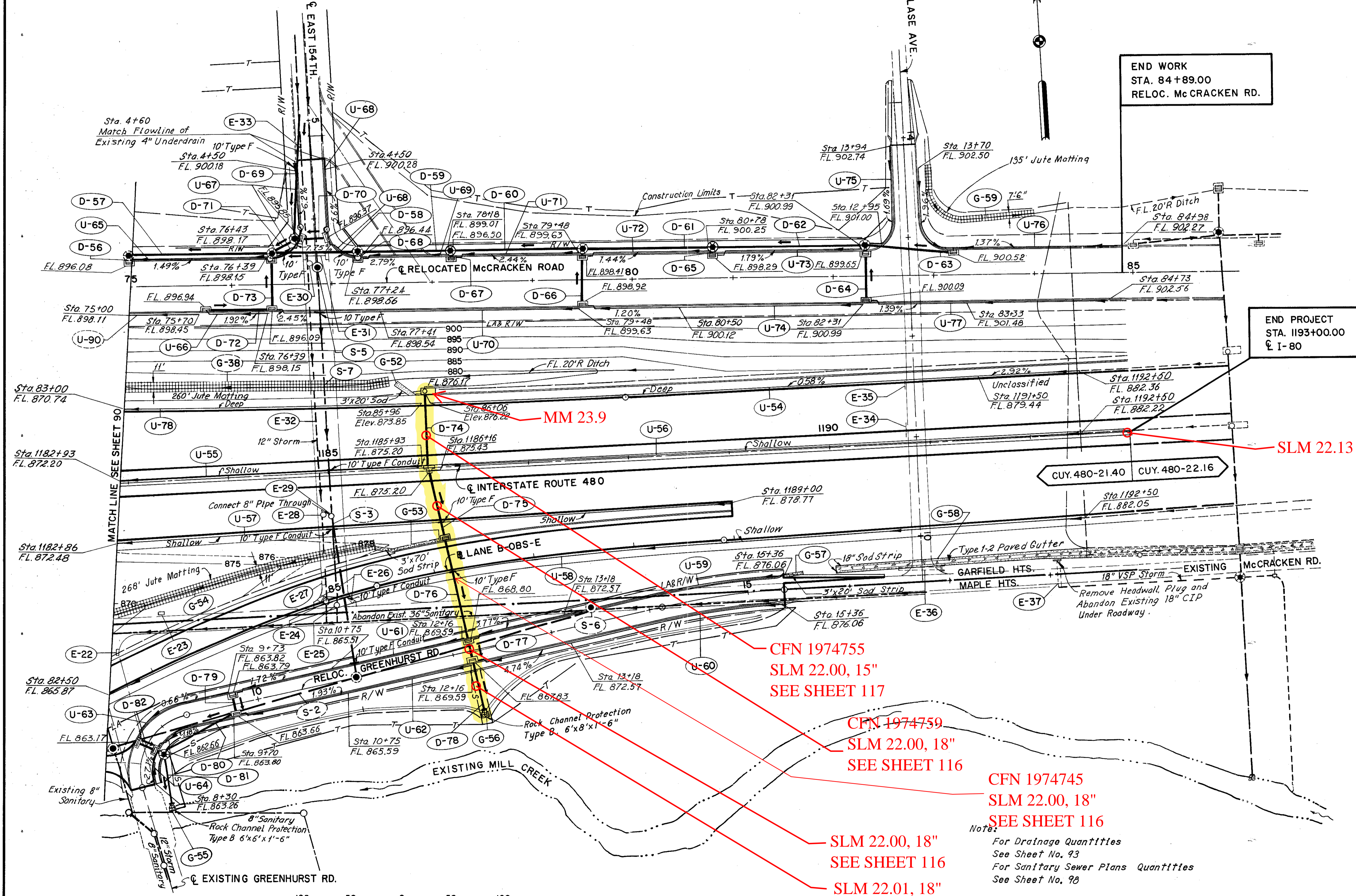

END WORK
STA. 84+89.00
RELOC. McCRACKEN RD.

END PROJECT
STA. 1193+00.00
I-80

MM 23.9

SLM 22.13

CFN 1974755
SLM 22.00, 15"
SEE SHEET 117

CFN 1974759
SLM 22.00, 18"
SEE SHEET 116

CFN 1974745
SLM 22.00, 18"
SEE SHEET 116

SLM 22.00, 18"
SEE SHEET 116

SLM 22.01, 18"
SEE SHEET 116
SEE ROW SHEET 25
FOR DOWNSTREAM
EASEMENT

Note:
For Drainage Quantities
See Sheet No. 93
For Sanitary Sewer Plans Quantities
See Sheet No. 90

DATE	
BY	
ALIGNMENT CHECKED	
GRADES	
STRUCTURE NOTATIONS	

DATE	
BY	
QUANTITIES FIGURED	
QUANTITIES CHECKED	

DATE	
BY	
DRAWN	
CHECKED	

SCALE 1"=50'
HOWARD, NEEDLES, TAMMEN & BERGENDOFF
MADE I.M. DATE 4-2-68
TRCD I.W. DATE 2-2-68
CKD E.R.A. DATE 4-10-68
CONSULTING ENGINEERS
KANSAS CITY CLEVELAND NEW YORK

