

Low Priority Outfall  
CUY14005L

SLM 9.30, 21"  
SEE SHEET 72

CFN XXXXXXX  
SLM 9.23, 18"  
SEE SHEET 8

CFN 1974213  
SLM 9.21, 15"  
SEE BELOW

CFN 1974224  
SLM 9.23, 18"  
SEE BELOW

BIG CREEK  
SFN 1814265  
SEE SHEET 250  
SLM 9.30-MM 11.47

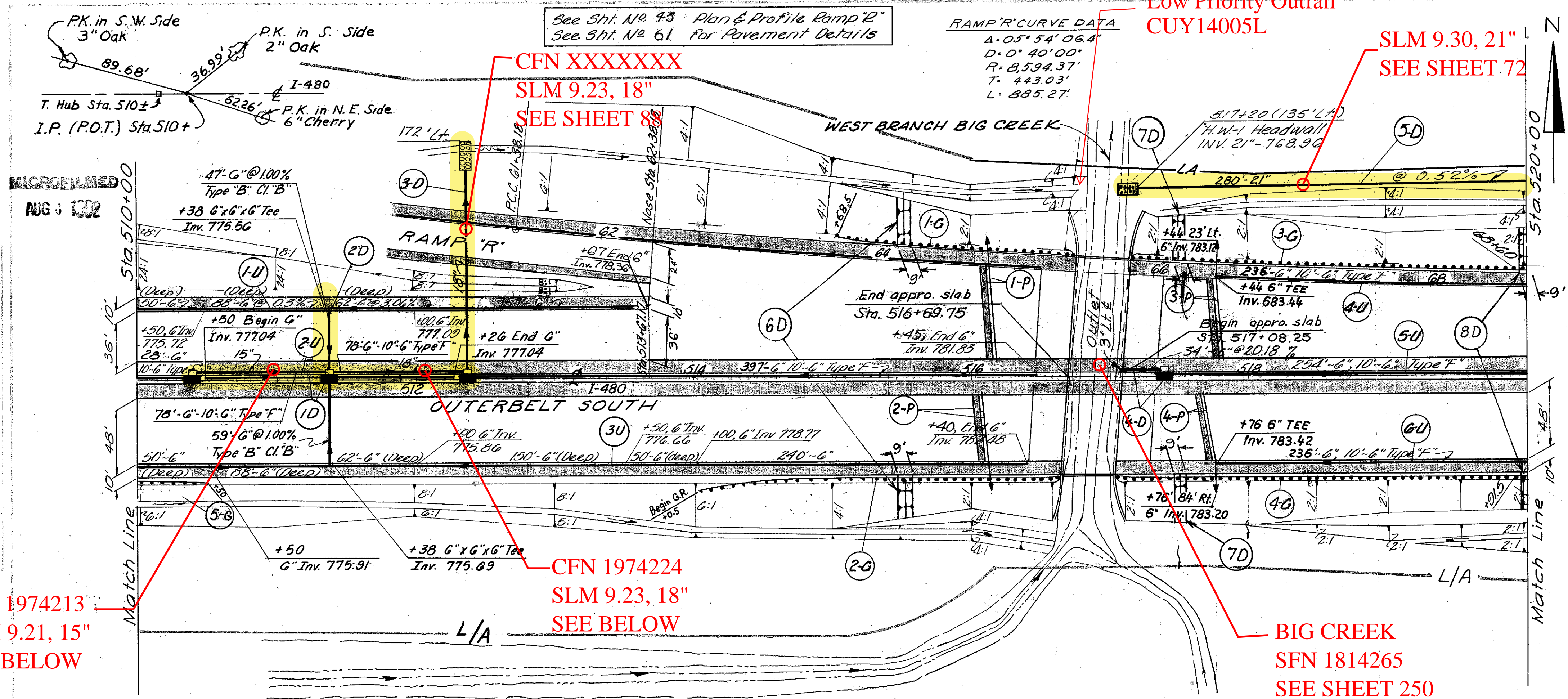

CROSS REFERENCE

Sht. No.	Item
250	Structure
87-90	Cross Sections
20-21	Drainage Details

TREE REMOVAL  
510+00 to 520+00

SIZE	N <sup>o</sup>
18"	8
30"	1

\* 706.01 Class 3, 706.02, 706.08 E.S. or 707.13

P.P. No.	Side	LOCATION	603		603		605		Spec 604		600		601		602	
			Type 'B'	Type 'F'	Type 'B'	Type 'F'	Type 'C'	Type 'C'	Type 'C'	Type 'C'	Type 'C'	Type 'C'	Type 'C'	Type 'C'	Type 'C'	
1-D	Lt	510+38 to 512+38														
2-D	Lt	511+38, 51' Lt - 63' Rt														
3-D	Lt	512+38, 6' to 172' Lt														
4-D	Lt	517+06, 34' to 517+36	34													
5-D	Lt	517+20 to 520+00														
6-D	Lt	515+50														
1-P	Lt	516+13														
2-P	Rt	516+02														
3-P	Lt	517+77														
4-P	Rt	517+62														
7-D	Lt	517+50														
1-U	Lt	510+00 to 513+67														
2-U	Lt	510+00 to 516+45														
3-U	Rt	510+00 to 516+40														
4-U	Lt	66+10 to 68+70														
5-U	Lt	517+36 to 520+00														
6-U	Rt	517+40 to 520+00														
8-D	Lt	522+00														
Total		To Gen. Summary	34	148	254	8.0	106	280	600	2046	222	4	55	190	8.0	5.0

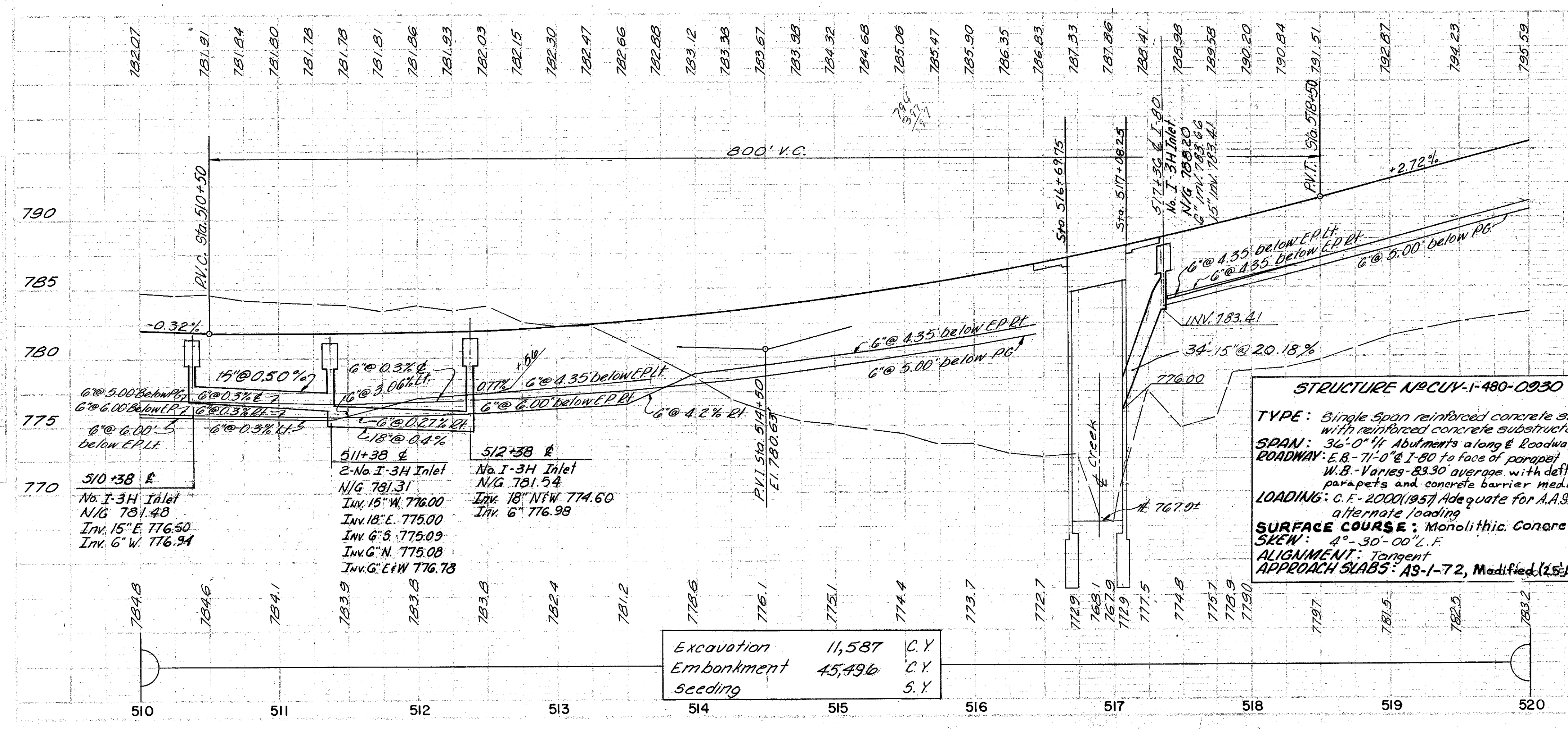

**STRUCTURE NO. CUY-1-480-0930**  
 TYPE: Single span reinforced concrete slab with reinforced concrete substructure  
 SPAN: 36'-0" w/ Abutments along E Roadway  
 ROADWAY: E.B. 11'-0" @ I-80 to face of parapet  
 W.B. Varies 83.30 average with deflector parapets and concrete barrier median.  
 LOADING: C.F. 2000 (1957) Adequate for A.A.S.H.O. alternate loading  
 SURFACE COURSE: Monolithic Concrete  
 SKEW: 4°-30'-00" L.F.  
 ALIGNMENT: Tangent  
 APPROACH SLABS: AS-1-72, Modified (25' Long)

Excavation	11,587	C.Y.
Embankment	45,496	C.Y.
seeding		S.Y.

ESTIMATED QUANTITIES

P.P. No.	Side	Location	L.F.	Ea.	Ea.
1-G	Lt	63+68.5 to 65+43.5	150		
2-G	Rt	514+00.5 to 516+63	2375		
3-G	Lt	65+85 to 68+70	885		
4-G	Rt	517+04 to 520+00	296		
5-G	Rt	510+00 to 510+30	50		
Total			10185	1	2 4

Rev 4-12-78

Rev. D.P. 4-1-78  
 G.P.S. 5/4/66  
 M.S. 5/9/66