

CFN 1974257  
 SLM 10.39=MM 12.56, 15"  
 SEE SHEET 113

**E I-80 CURVE DATA**  
 P.I. Sta. 583+16.04 (Back)  
 Sta. 583+71.11 (Forward)  
 Δ = 29°46'15"  
 D<sub>s</sub> = 1°15'00"  
 R = 4,583.66'  
 T = 1218.37'  
 L = 2,381.67'  
 E = 159.15'

**RAMP W-1 CURVE DATA**  
 P.I. 575+29.15  
 Δ = 14°15'30"  
 D<sub>s</sub> = 4°00"  
 R = 1432.39'  
 T = 179.15'  
 L = 355.54'

CROSS REFERENCE	
Sht. No.	Item
83	Ramp W-1 Pavement Detail
41	Superelevation Table
57	Ramp W-1 Plan & Profile

SLM 10.39 = MM 12.56

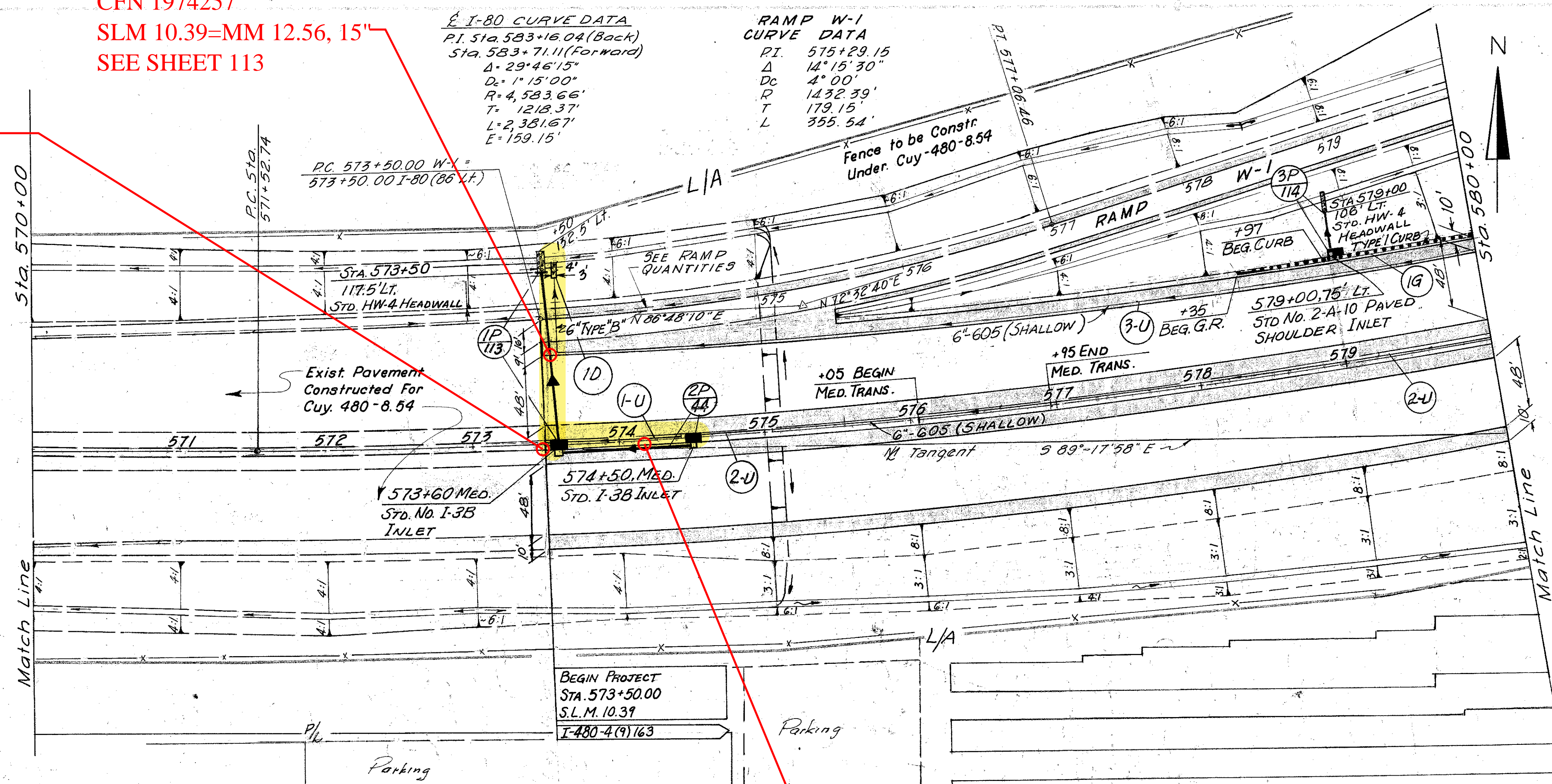

ESTIMATED QUANTITIES	DRAINAGE												
	601	602	603		604		605	660					
REF SIDE	LOCATION	Rock Channel Prot. Type 'B' With Filter	Concrete Masonry	Type 'F'	Type 'B'	Type 'F'	Type 'B'	Sto. No. I-3B Median Inlet	Sto. No. 2-A-10 Inlet	Shallow	Bends & Branches	Reinforced	Sooding
		C.Y.	C.Y.	L.F.	L.F.	L.F.	Ea.	L.F.	Ea.	L.F.	Ea.	S.Y.	S.Y.
1P	Med. Lt. 573+60 to 573+50	3.56	0.25		118			1					
2P	Med. 573+60 to 574+50				90			1					
3P	Lt. 579+00	3.33	0.25		32	2			1				
1U	Med. 573+60 to 574+43				10							73	
2U	Med. 574+50 to 580+00				10							540	
3U	Lt. 573+60 to 580+00				10						52	630	1
1D	Lt. 573+60												3
<b>TOTAL</b>		<b>6.89</b>	<b>0.50</b>	<b>30</b>	<b>208</b>	<b>32</b>	<b>52</b>	<b>2</b>	<b>1</b>	<b>1,243</b>	<b>3</b>		

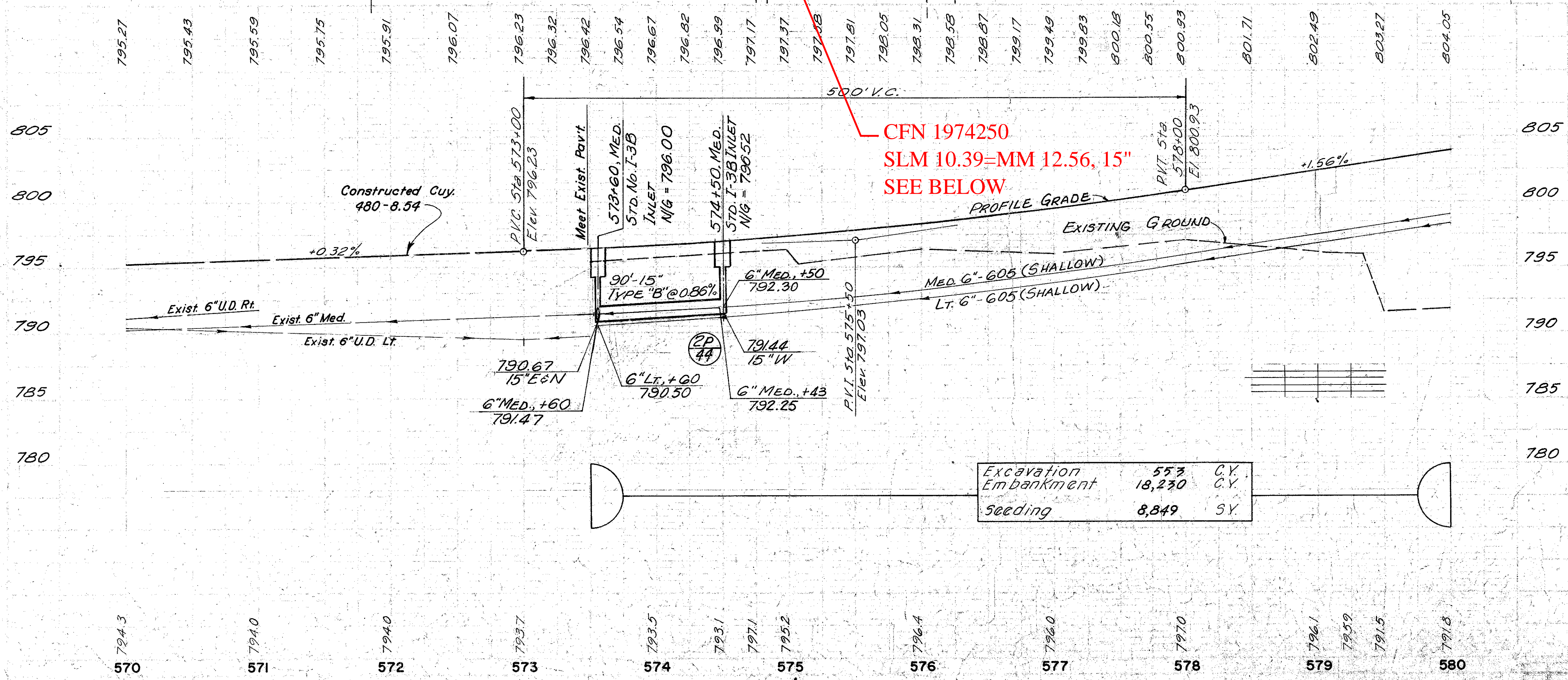

CFN 1974250  
 SLM 10.39=MM 12.56, 15"  
 SEE BELOW

TREE REMOVAL	
Size	No.
0	0

ESTIMATED QUANTITIES	ROADWAY		
	606		
REF SIDE	LOCATION	Anchor Assembly Type 'T'	Guard Rail Type 'S'
1-G	Lt. 578+35 to 580+00	1	155'
<b>TOTAL</b>		<b>1</b>	<b>155</b>

Excavation	553	C.Y.
Embankment	18,230	C.Y.
Seeding	8,849	S.Y.

DALD. BY WAM DATE 3/75  
 CHKO. BY EJK DATE 3/75