

LAK/GEA County  
Line SLM 0.00

CURVE NOTES  
RT. CURVE  
RADIUS 1000' RI.  
L.T.C. 1000' RI.  
P.C. 1000' RI.  
P.T.C. 1000' RI.  
L.C. 1000' RI.  
L.P.C. 1000' RI.

J & M. KLUHS

J V BARTLETT

I. & C. HEATH

EUNICE PRATT

old CFN 28006012  
new CFN 1819319  
SLM 0.12, 3'x3'  
Concrete Box

old CFN 28006025  
new CFN 1820897  
SLM 0.24, 18' VCP

Retired  
CFN 280060000  
SLM 0.00, 3'x3'  
Concrete Box  
Replaced in 2016 by  
ODOT forces  
new CFN 1900815  
8'x4' conc. Box

Transition & Super-Elevation Curve Data

Stations	Grade	Lt. & Outside	Rt & Inside	Extra	
	£	Dist. from £	Dist. from £	Corr. 39yds.	
2+41.5	P.T.C.	947.08	8.00	947.83	0.00
+66.5	+2.5	948.63	8.00	948.55	0.00
+91.5	P.C.	949.40	8.00	949.49	0.00
3+00		949.69	8.00	949.83	0.00
+18.5	+2.5	950.37	8.00	950.63	0.00
+41.5	E.T.C.	951.57	8.00	951.99	0.00
+50		952.00	8.00	952.42	0.00
4+00		955.19	8.00	955.61	0.00
+50		959.25	8.00	959.67	0.00
+69.8	E.C.C.	961.08	8.00	961.45	0.00
+94.8	+2.5	962.87	8.00	963.07	0.00
5+00		963.75	8.00	963.97	0.00
+19.8	P.T.	963.53	8.00	963.62	0.00
+44.8	+2.5	967.78	8.00	967.70	0.00
+50		968.25	8.00	968.18	0.00
+69.8	P.T.T.	970.03	8.00	969.78	0.00
Total = 0.00					

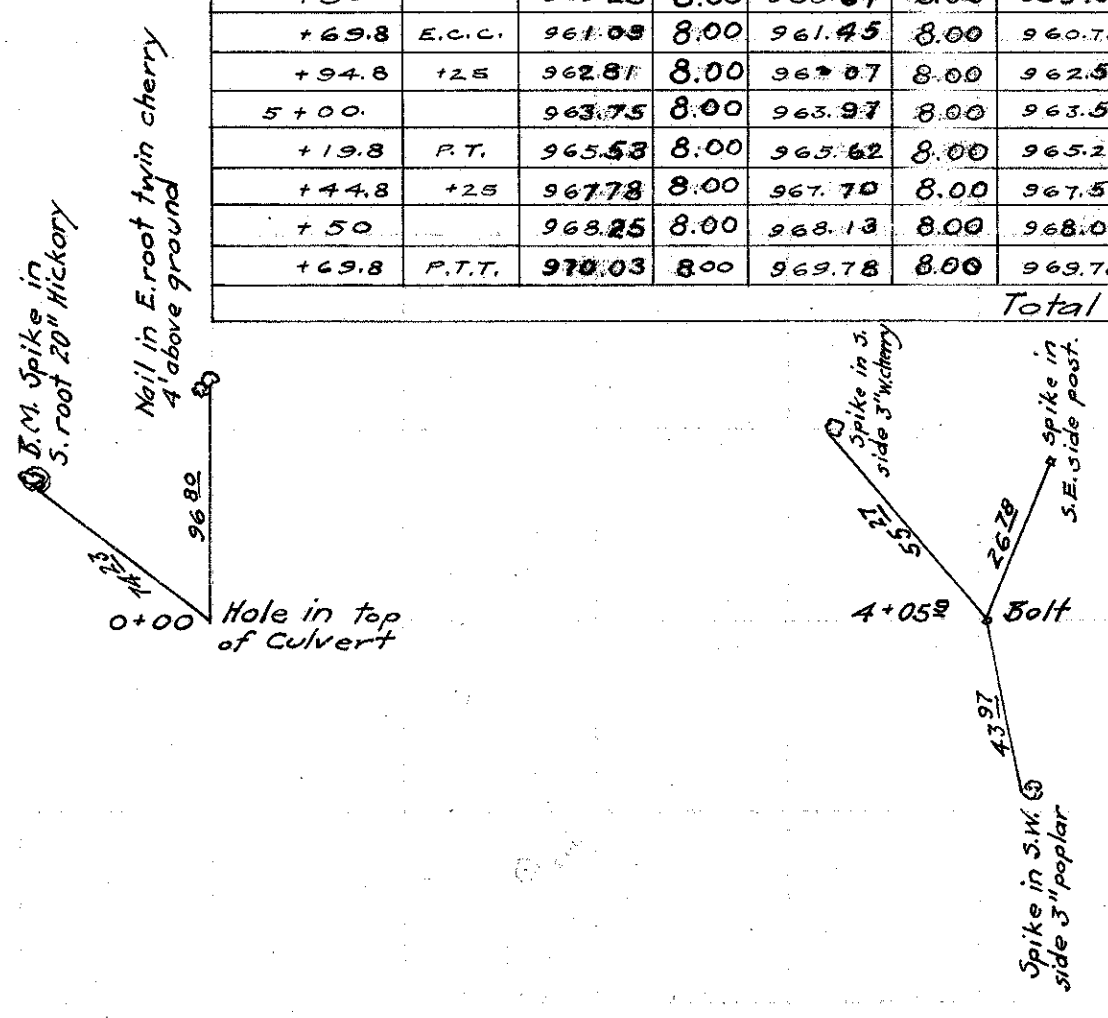
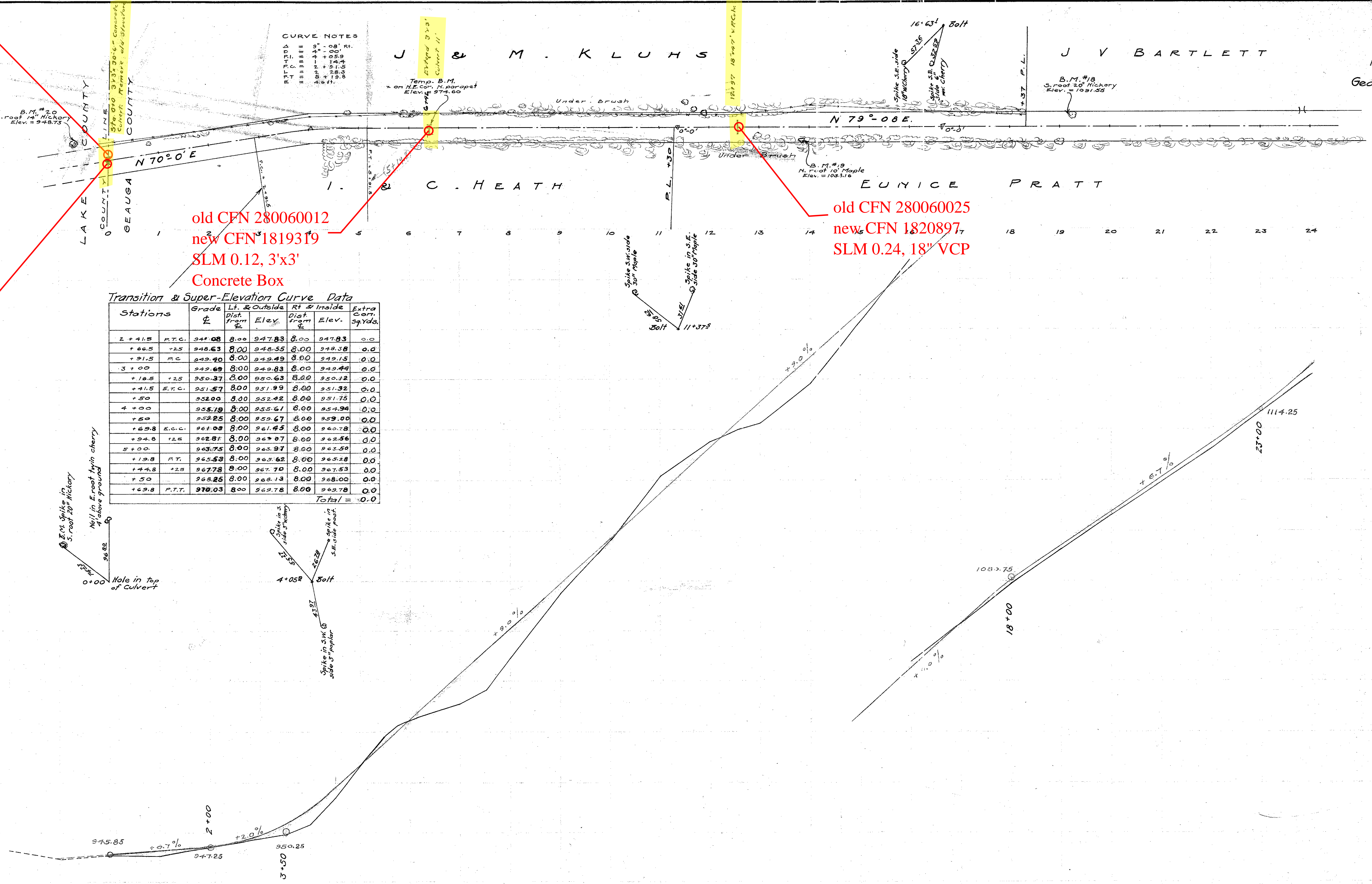

Ground Elev.	Exc. 705 Cu.Yds. Emb. 564 Cu.Yds.	Exc. 1819 Emb. 1455	Exc. 1622 Emb. 1295	Exc. 1005 Emb. 805
945.4	945.85	975.5	1031.25	1096.2
945.2	946.20	978.1	1035.75	1097.50
945.2	946.55	984.6	1040.25	1098.2
946.90	100' V.C.	997.7	1044.75	1099.7
947.1	947.41	1004.25	1049.25	1104.20
+41.5	949.08	1008.75	1053.75	1107.55
+50	948.25	1013.25	1058.25	1111.00
948.9	949.69	1017.75	1062.75	1114.65
948.00	200' V.C.	1022.25	1067.25	1118.50
948.49	951.8	1026.75	1071.75	1122.55
950.25	950.25	1031.25	1076.25	1126.70
953.2	953.75	1035.75	1080.75	
959.3	959.25	1040.25	1085.25	
972.4	972.75	1044.75	1089.75	
977.25		1049.25	1094.25	
975.5	981.75	1053.75	1098.75	
978.1	986.25	1058.25	1103.25	
984.6	990.75	1062.75	1107.75	
997.7	999.75	1067.25	1112.25	
1004.25		1071.75	1116.75	
1008.75		1076.25	1121.25	
1013.25		1080.75	1125.75	
1017.75		1085.25	1130.25	
1022.25		1089.75	1134.75	
1026.75		1094.25	1139.25	
1031.25		1098.75	1143.75	
1035.75		1103.25	1148.25	
1040.25		1107.75	1152.75	
1044.75		1112.25	1157.25	
1049.25		1116.75	1161.75	
1053.75		1121.25	1166.25	
1058.25		1125.75	1170.75	
1062.75		1130.25	1175.25	
1067.25		1134.75	1179.75	
1071.75		1139.25	1184.25	
1076.25		1143.75	1188.75	
1080.75	100' V.C.	1148.25	1193.25	
1084.25	1084.10	1152.75	1197.75	
1088.75	1087.45	1157.25	1202.25	
1093.25	1090.80	1161.75	1206.75	
1097.75	1094.15	1166.25	1211.25	
1102.25	1097.50	1170.75	1215.75	
1106.75	1100.85	1175.25	1220.25	
1111.25	1104.20	1179.75	1224.75	
1115.75	1107.55	1184.25	1229.25	
1120.25	1111.00	1188.75	1233.75	
1124.75	1114.65	1193.25	1238.25	
1129.25	1118.50	1197.75	1242.75	
1133.75	1122.55	1202.25	1247.25	
1138.25	1126.70	1206.75	1251.75	