

\* REESTABLISH PRIOR TO CONSTRUCTION

STA. 189+97.00, 24.00' RT. (FACE)  
 BEGIN TYPE 5 GUARDRAIL  
 END OF 12" CULVERT  
 STA 189+57.0, 28.7' RT.  
 12" INV. 1021.79 (E.)

END OF 12" CULVERT  
 STA 188+53.7, 30.5' RT.  
 12" INV. 1023.25 (S.)

END OF 12" CULVERT  
 STA 188+49.0, 27.7' RT.  
 12" INV. 1023.20 (S.)

VAULT  
 STA 188+85.5, 38.4' RT.

STA. 188+52.50, 24.00' RT. (FACE)  
 END TYPE T ANCHOR ASSEMBLY  
 BEGIN TYPE 5 GUARDRAIL

STA. 188+50.35, 20.00' LT.  
 END 30'R CURVE

STA. 188+50.00, 24.00' RT. (FACE)  
 END TYPE 5 GUARDRAIL  
 END 26' RADIUS  
 BEGIN TYPE T ANCHOR ASSEMBLY

STA. 188+30.00, 35.00' RT. (FACE)  
 BEGIN TYPE 5 GUARDRAIL  
 (FLARED END SECTION)  
 BEGIN 26' RADIUS

STA. 188+20.35, 50.00' LT.  
 BEGIN 30'R CURVE

STA. 187+96.35, 50.00' LT.  
 END 30'R CURVE

STA. 187+66.35, 20.00' LT.  
 BEGIN 30'R CURVE

old CFN 280430050  
 new CFN 1799609  
 SLM 0.50, 12" VCP  
 EXTENSION  
 SEE SHEET 12

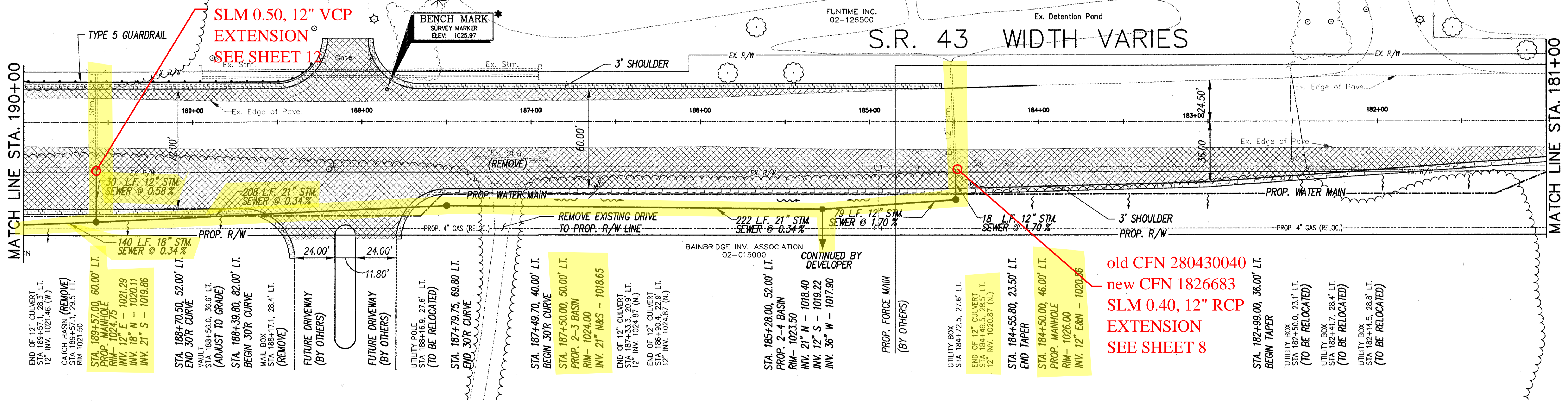

END OF 12" CULVERT  
 STA 189+11.26 (N.)  
 12" INV. 1021.46 (N.)

CATCH BASIN (REMOVE)  
 STA 189+57.1, 28.5' LT.  
 RIM- 1021.50

PROP. MANHOLE  
 STA 189+43.75  
 RIM- 1024.75

INV. 12" E - 1021.29  
 INV. 18" N - 1020.11  
 INV. 21" S - 1019.86

STA. 189+57.00, 60.00' LT.  
 END 30'R CURVE

STA. 188+70.50, 52.00' LT.  
 END 30'R CURVE

VAULT  
 STA 188+56.0, 36.6' LT.  
 (ADJUST TO GRADE)

STA. 188+39.80, 82.00' LT.  
 BEGIN 30'R CURVE

MAIL BOX  
 STA 188+17.1, 28.4' LT.  
 (REMOVE)

FUTURE DRIVEWAY  
 (BY OTHERS)

FUTURE DRIVEWAY  
 (BY OTHERS)

UTILITY POLE  
 STA 188+16.9, 27.6' LT.  
 (TO BE RELOCATED)

STA. 187+79.75, 69.80' LT.  
 END 30'R CURVE

STA. 187+49.70, 40.00' LT.  
 BEGIN 30'R CURVE

STA. 187+50.00, 50.00' LT.  
 PROP. 2-3 BASIN  
 RIM- 1024.00  
 INV. 21" N&S - 1018.65

END OF 12" CULVERT  
 STA 187+33.3, 20.9' LT.  
 12" INV. 1024.87 (N.)

END OF 12" CULVERT  
 STA 186+90.4, 22.9' LT.  
 12" INV. 1024.87 (N.)

STA. 185+28.00, 52.00' LT.  
 PROP. 2-4 BASIN  
 RIM- 1023.50  
 INV. 21" N - 1018.40  
 INV. 12" S - 1019.22  
 INV. 36" W - 1017.90

PROP. FORCE MAIN  
 (BY OTHERS)

UTILITY BOX  
 STA 184+72.5, 27.6' LT.

END OF 12" CULVERT  
 STA 184+43.3, 27.3' LT.  
 12" INV. 1026.87 (N.)

STA. 184+55.80, 23.50' LT.  
 END TAPER

STA. 184+50.00, 46.00' LT.  
 PROP. MANHOLE  
 RIM- 1026.00  
 INV. 12" E&N - 1020.86

STA. 182+99.00, 36.00' LT.  
 BEGIN TAPER

UTILITY BOX  
 STA 182+50.0, 23.1' LT.  
 (TO BE RELOCATED)

UTILITY BOX  
 STA 182+41.7, 28.4' LT.  
 (TO BE RELOCATED)

UTILITY BOX  
 STA 182+14.5, 28.8' LT.  
 (TO BE RELOCATED)

old CFN 280430040  
 new CFN 1826683  
 SLM 0.40, 12" RCP  
 EXTENSION  
 SEE SHEET 8

RECEIVED  
 MAR 29 2002  
 PRODUCTION DEPT.

CHAGRIN VALLEY  
 ENGINEERING, LTD.  
 24850 AURORA ROAD, UNIT A  
 CLEVELAND, OHIO 44146  
 PH: (440) 439-1989  
 FAX: (440) 439-1989

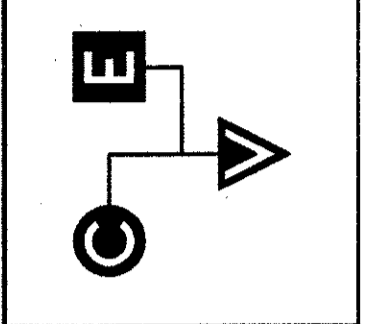

NO.	REVISIONS	DATE
1	REVISIONS AS PER CHIO DEPT.	2-28-02
2	CATCH BASIN @ 185+27 SHIFED PER 0001	3-5-02
3	DRIVEWAY @ 188+100 RT. REVISED PER 0001	3-28-02

SITE PLAN  
 STATE ROUTE 43 WIDENING  
 BAINBRIDGE TOWNSHIP, OHIO

DESIGNED BY: D.P.B.  
 DRAWN BY: L.M.B.  
 CHECKED BY: M.M.J.  
 DATE: 05/14/01  
 SCALE: 1" = 30'  
 PROJECT NUMBER  
 01030  
 Drawing Name  
 01030mst.dwg

SHEET: 3  
 TOTAL SHEETS: 23