

T.B.M. No 1 EL. 838.70
CHISELED ON SIDE OF
COR. OF SIDEWALK ON
IN FRONT OF HSE.
#1200 LT. STA.
784+00 ON
FOWLES ROAD.

BEGIN PROJECT
I-71 STA. 789+00
S.L.M. 5.72
I-71-5 (12) 238

FOR DETAILS ON CULVERT
D-1 SEE SH. 198

FOR PROFILE
STORM SEWER OR
D-1, D-2, D-4 SEE
SHEET 183
STA. 793+42.06 I-71
STA. 30+00 FOWLES RD.

FOR DETAILS OF
STRUCTURE NO. CUY-71-5-80
SEE SHEETS 257 TO 270

FOR DETAILS ON
FOWLES ROAD SEE SHEETS 43 TO 44

FOR PAVEMENT DETAILS
SEE SHEET 170

FED. RD. DIVISION 2	STATE OHIO	PROJECT	FISCAL YEAR 24
------------------------	---------------	---------	-------------------

CUYAHOGA COUNTY
CUY-71-5.72

DRAINAGE

REF. NO.	STATION	S I D E	I-1		I-8	I-2	L-120	E-12			
			6" PIPE CLASS I-3	12" PIPE CLASS J-1	STD. CATCH BASIN No 8	STD. M.H. No 1	MASONRY	JUTE MATTING	PIPE REMOVAL UNDER 15"		
			LINE	FT.	EACH	C.Y.	S.Y.				
D-1	790+10	RT				8					
D-2	790+88	RT	300 *					300 *			
D-3	792+19	LT		130							
D-4	794+95	RT			116	0.23					
D-5	795+45	RT					63				
D-6	789+50	LT		305							
D-7	789+50	RT		265							
D-8	794+68	LT		432							
D-9	794+30	RT		470							
D-10	790+88	RT				1 *					
D-11	791+07	RT				1 *					
D-12	791+12	LT					84				
TOTAL			300 *	1472	130	116	2	2 *	8.23	147	300 *

REF. NO.	STATION	S I D E	I-1	I-2	E-3	L-10	L-10	SPECIAL
			27" PIPE CLASS M-6.8(b)	MASONRY	CHANNEL EXCAVATION	SODDING	SOD FOR SPECIAL BERM AND SLOPE PROTECTION	DRILLED WELLS ABANDON
			L.F.	C.Y.	C.Y.	S.Y.	S.Y.	EA.
D-1	790+10	LT	238	SEE ABOVE	19	7.5		
D-13	794+61	LT					21	
D-14	794+20	RT					35	
W-1	795+33	102' Lt.						1
D-15	792+60	LT					34	
D-16	792+30	RT					34	
TOTALS			238		19	7.5	124	1

* CODE Y060

AS PER PLAN

CFN 180710576
SLM 5.76, 27"
SEE SHEET 198

SLM 5.82, 12"
SEE SHEET 183

SLM 5.85, 12"
SEE SHEET 183

NOTE: THE PROPOSED
DITCHES TO MEET
THOSE OF THE
ADJOINING PROJECT.

FOR GUARD RAIL DETAIL
FOR SIGN PROTECTION
SEE SIGNING PLANS

NOTE: PROPOSED
SECTION OF ADJOINING
PROJECT SAME AS SHOWN
ON PROJECT ON
SHEET 198

FOR SIGN PLAN SEE
SHEET 244

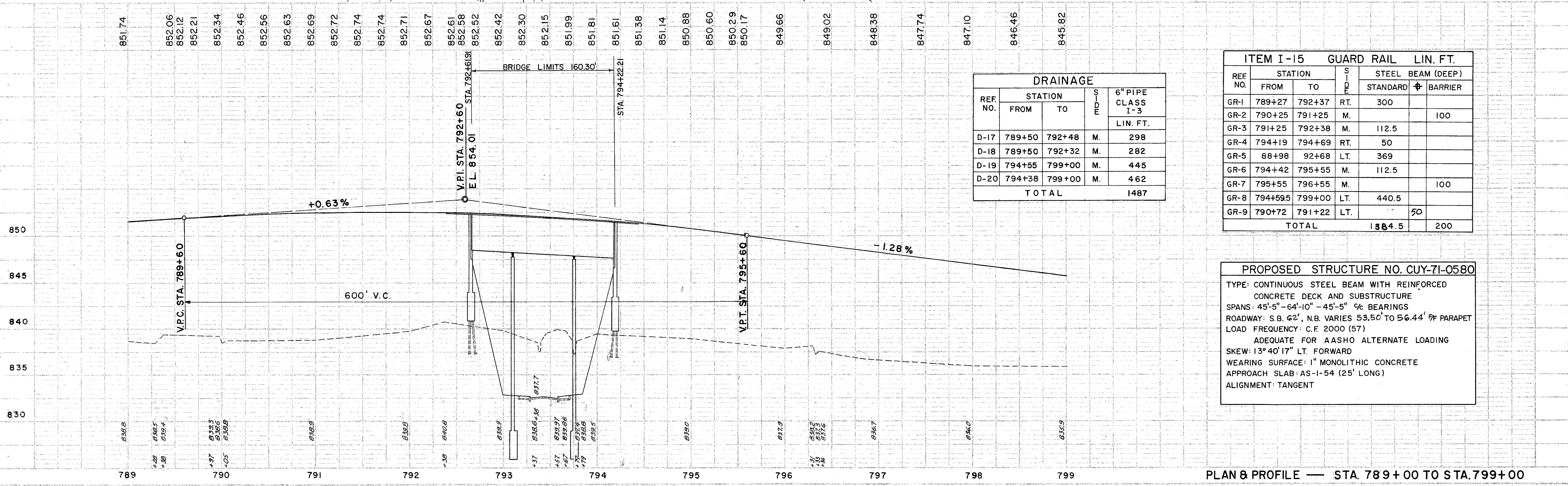

DRAINAGE				
REF. NO.	STATION		S I D E	6" PIPE CLASS I-3
	FROM	TO		
D-17	789+50	792+48	M.	298
D-18	789+50	792+32	M.	282
D-19	794+55	799+00	M.	445
D-20	794+38	799+00	M.	462
TOTAL				1487

ITEM I-15 GUARD RAIL LIN. FT.					
REF. NO.	STATION		S I D E	STEEL BEAM (DEEP)	
	FROM	TO		STANDARD	BARRIER
GR-1	789+27	792+37	RT.	300	
GR-2	790+25	791+25	M.		100
GR-3	791+25	792+38	M.	112.5	
GR-4	794+19	794+69	RT.	50	
GR-5	88+98	92+68	LT.	369	
GR-6	794+42	795+55	M.	112.5	
GR-7	795+55	796+55	M.		100
GR-8	794+59.5	799+00	LT.	440.5	
GR-9	790+72	791+22	LT.	50	
TOTAL				1384.5	200

PROPOSED STRUCTURE NO. CUY-71-0580
 TYPE: CONTINUOUS STEEL BEAM WITH REINFORCED CONCRETE DECK AND SUBSTRUCTURE
 SPANS: 45'-5" - 64'-10" - 45'-5" % BEARINGS
 ROADWAY: S.B. 62', N.B. VARIES 53.50' TO 56.44' % PARAPET
 LOAD FREQUENCY: C.F. 2000 (57)
 ADEQUATE FOR AASHO ALTERNATE LOADING
 SKEW: 13° 40' 17" LT. FORWARD
 WEARING SURFACE: 1" MONOLITHIC CONCRETE
 APPROACH SLAB: AS-1-54 (25' LONG)
 ALIGNMENT: TANGENT