

These 6 columns on the west approach to the Lorain Road Bridge Arch over the Rocky River had their interior Item 514 painting non-performed due to safety access issues on ODOT 20-0082 Project. CO #15 non-performed the blasting and 3 coat paint work. 05/24/2022 T. Hyland.

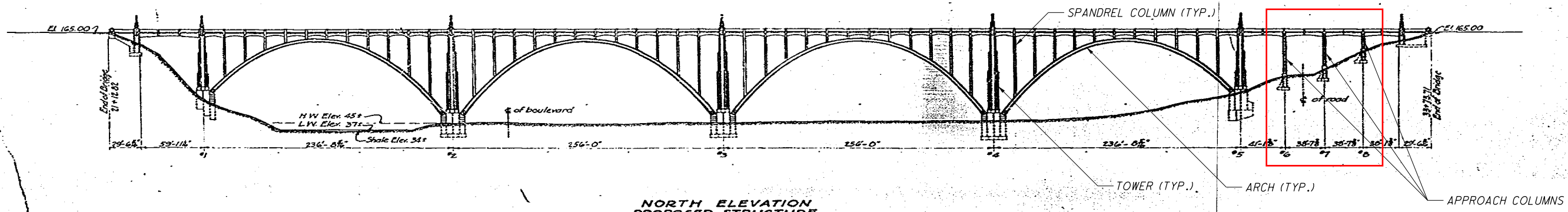
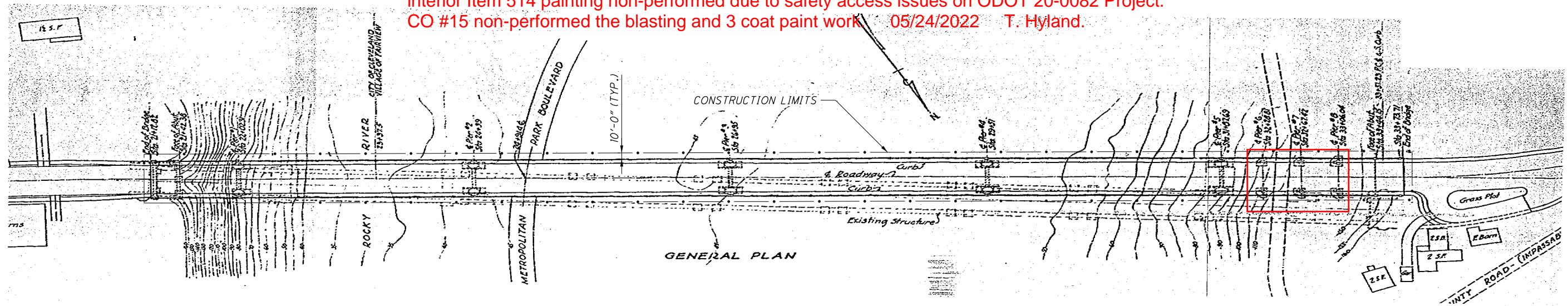

PROPOSED STRUCTURE
 Open spandrel steel arch
 1260.00' length overall
 40' width of roadway
 2 @ 5' concrete side walks
 34.5' distance c.c. of arch ribs
 Concrete deck slabs & substructure
 Brick wearing surface.

NOTES

1. DETAILS ON THIS SHEET ARE TAKEN FROM EXISTING PLANS, AND SHALL BE USED FOR INFORMATION PURPOSE ONLY.
2. PERFORM ONLY THE WORK DESCRIBED IN THE GENERAL NOTES AND GENERAL SUMMARY.
3. NO WORK OR ACCESS WILL BE ALLOWED PAST THE HIGH WATER ELEVATION OF ROCKY RIVER.

P:\DDT\12\0004_CUY-480-06.47_VAR_Point\22131\Design\Structures\CUY10_0869C_Sheets\10_0869C_SP001.dgn Sheet 11/15/2019 2:57:56 PM CMT008

DESIGNED	MTJ	CHECKED	ERK
DRAWN	MTJ	REVISED	
REVIEWED	GDJ	STRUCTURE FILE NUMBER	1801325
DATE	09/26/19		

SITE PLAN
 BRIDGE NO. CUY-10-0869
 OVER VALLEY PARKWAY AND ROCKY RIVER

CUY-480-6.47 /
VAR PAINT
PID No. 22131