

CUYAHOGA COUNTY
CITY OF CLEVELAND
MEDINA-CLARK INTERCHANGE
CUY-71-18.54
CUY-90-13.81

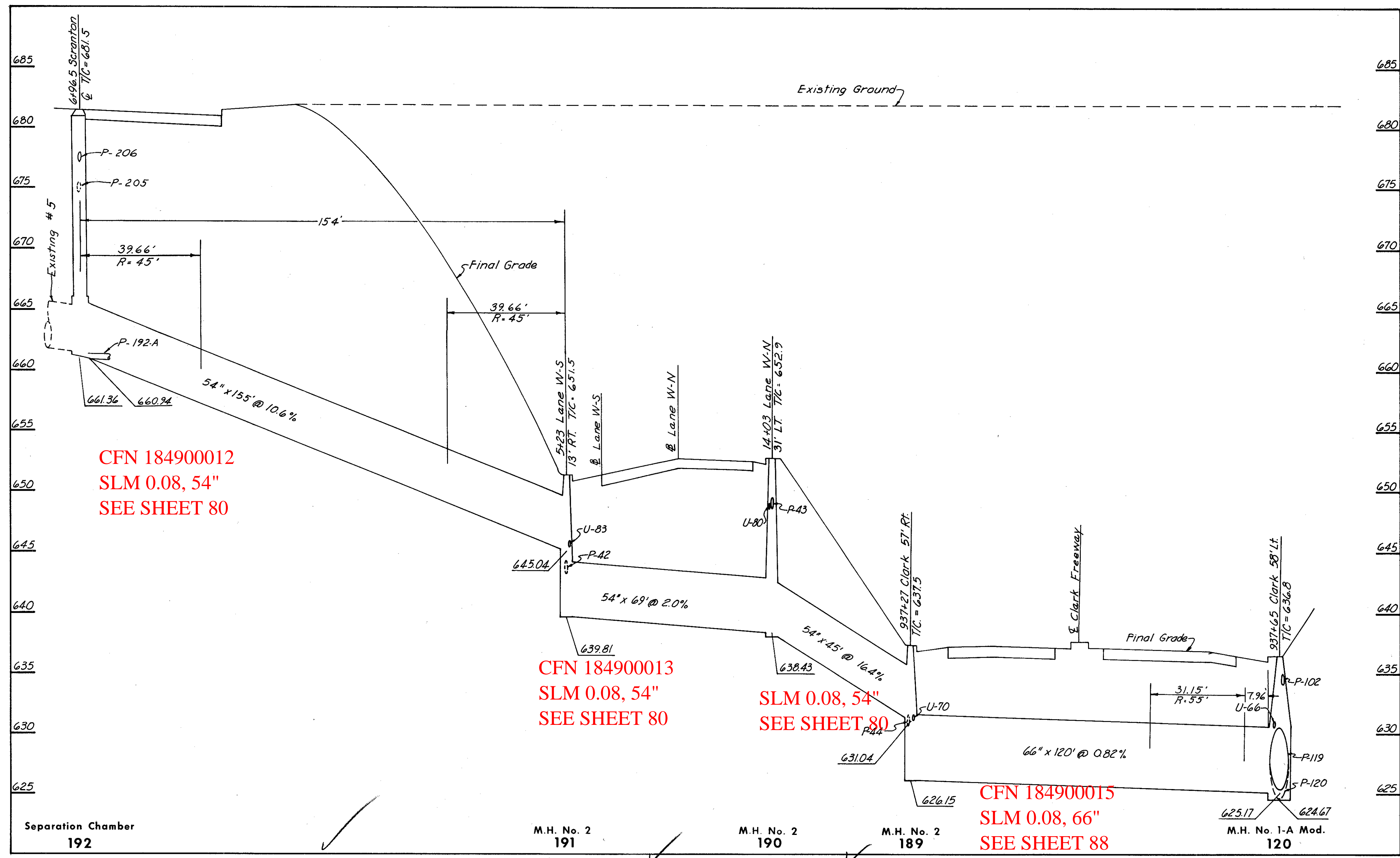

CFN 184900012
SLM 0.08, 54"
SEE SHEET 80

CFN 184900013
SLM 0.08, 54"
SEE SHEET 80

SLM 0.08, 54"
SEE SHEET 80

CFN 184900015
SLM 0.08, 66"
SEE SHEET 88

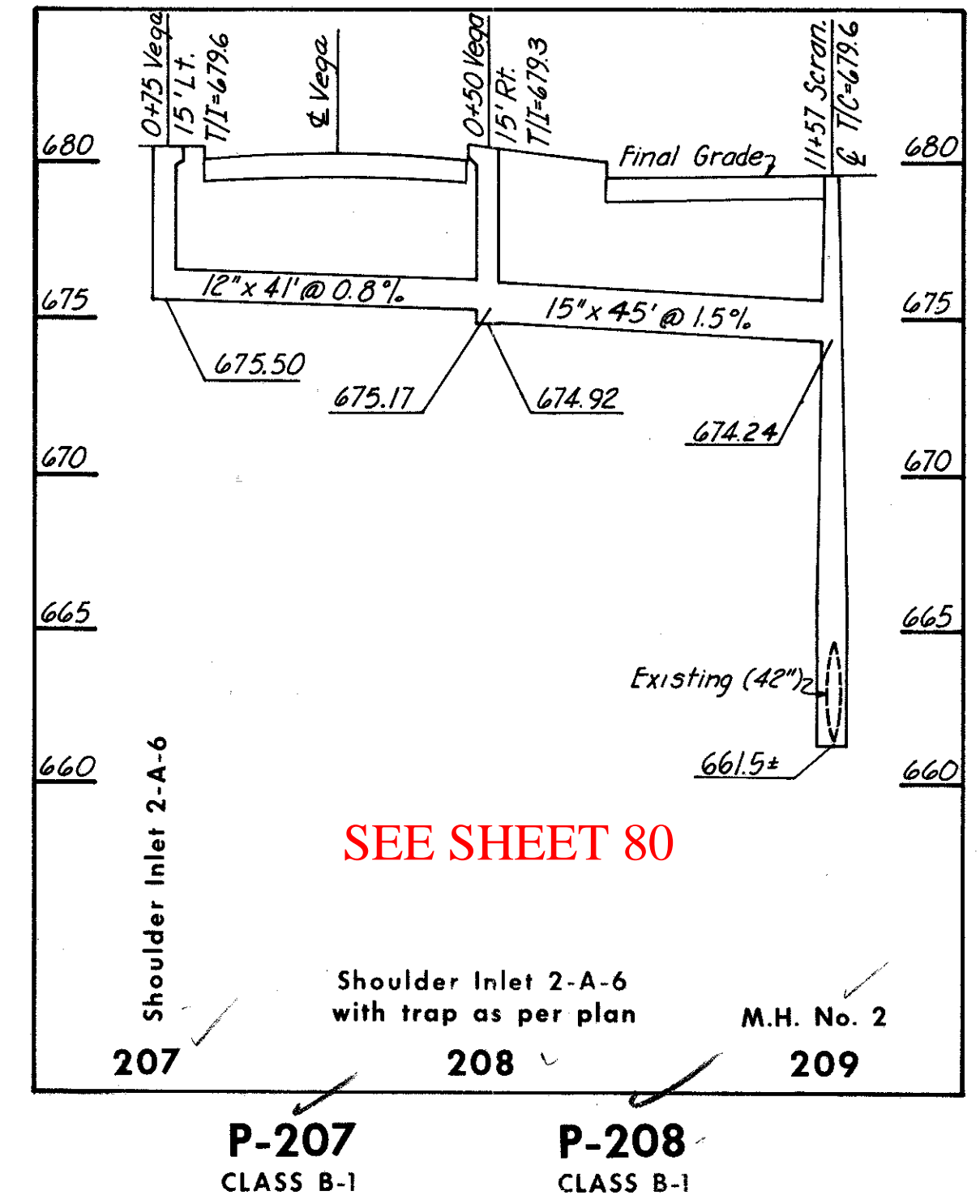

SEE SHEET 80

ESTIMATED QUANTITIES

CODE	LOCATION	I-8 STRUCTURES		
		Shoulder Inlet 2-A-6	Shoulder Inlet 2-A-6 with trap	M.H. No. 2
207	O+75 Vega Avenue 15' LT.	1		
208	O+50 Vega Avenue 15' RT.		1	
209	11+57 Scranton Road			1
CUY-71-18.54 TOTALS		1	1	1

CODE	ROADWAY	INLET CODE		I-1 PIPE						
		FROM	TO	CLASS B-1 12"	CLASS B-1 15"	CLASS B-1 Sec. M-6.6(b) 54"	CLASS B-1 Sec. M-6.6(d) 54"	CLASS B-1 66"	Class B-1 Sec. M-6.6(d) 54" R-45'	Class B-1 66" R-55'
P-189	Clark Freeway	189	120					90'		30'
P-190	Clark Freeway *	190	189			45'*				
P-191	LANE M-5 *	191	190			69'*				
P-192	Scranton Road	192	191				75'✓		80'✓	
P-207	Vega Ave.	207	208	41'✓						
P-208	Vega Ave.	208	209		45'✓					
CUY-71-18.54 TOTALS				41'✓	45'✓		75'✓	90'✓	80'✓	30'✓
CUY-90-13.81 TOTALS						114'*				

P-189 thru P-192,
P-207, and P-208
SEWER PROFILES