

RETURN TO RIGHT-OF-WAY BEFORE SCHEDULING

THE C.E.I. CO. REGISTERED 15-11 GRID #4722-NW 2 WORKING DAYS BEFORE YOU DIG "IT'S THE LAW" CALL TOLL FREE 800-362-2764 OHIO UTILITIES PROTECTION SERVICE

PROJECT FOR: **ODOT INNERBELT BRIDGE PROJECT**
 ADDRESS: **650 HARRISON ST. SOUTH OF W 3RD ST**
 CITY: **CLEVELAND**
 STATE: **OHIO**
 COUNTY: **CLEVELAND**
 SHEET: **1 OF 2**

DATE: **4-28-2011**

PREPARED BY: **D. STREKA**
 SURVEY: **ENGINEERING 444-546-9732**

PROJECT ID: **77332**

WBS: **CE-000224**

CONTRACT: **5-2-11**

APPROVED BY: **J.O.**

DATE	J.P.	FOR EST.	O.H.	REP.	CABLE	SERV.	MARKT.	REC.	ENGR.	TOTAL
2		3							2	1

CONSUMER'S CHARGE #

RETURN TO RIGHT-OF-WAY BEFORE SCHEDULING

JOINT POLE RELEASE

DATE CLEARED

DESCRIPTION

APPROVED BY

REVISION HISTORY

CONSTRUCTION

CAUTION

MAXIMUM RMS SYMMETRICAL FAULT CURRENT AVAILABLE AT SERVICE ENTRANCE IS

THE CUSTOMER SHALL PROVIDE THE GROUNDING ELECTRODE CONDUCTOR AND GROUNDING ELECTRODE TO THE SERVICE ENTRANCE LOCATION.

WIRE NOTES

① TO ① SHT #2 REM 3 3/4 WP AL PRI (H-S-C-N-P) - 350'

OVERHEAD FOREMAN NOTE:

DO NOT REMOVE THIS SERVICE UNTIL THE NEW ITS AND MAINTAINED TRANSFORMER SERVICE HAS BEEN INSTALLED AND ACTIVATED. SEE WBS #S4449248 FOR DETAILS OF THE NEW LAFARGE SERVICE.

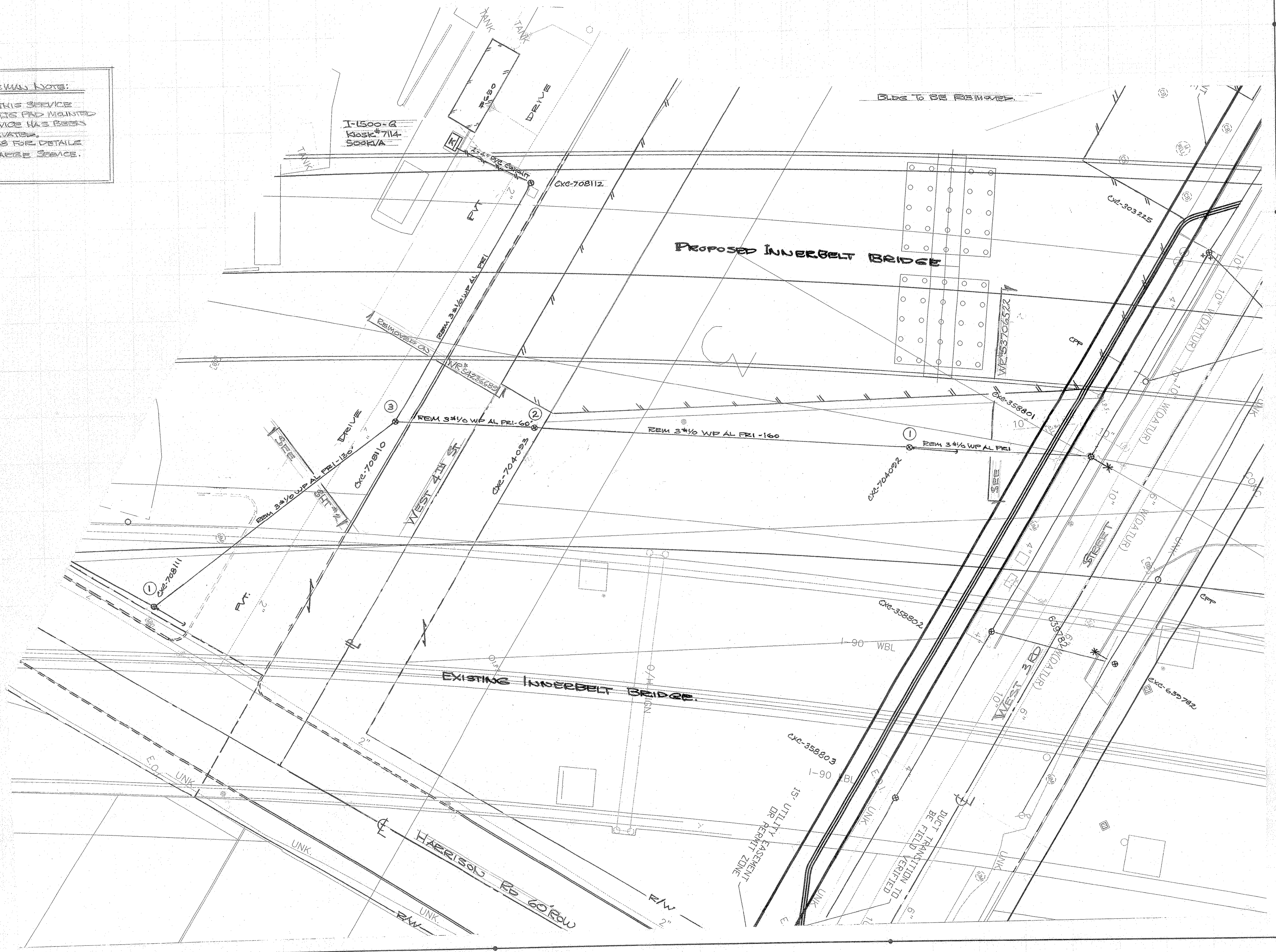

- ① CX-704092-50:3-10-1988-D-60%
 REMOVE POLE TAG & ABANDON POLE
 REM D7X WBS & 3 STL PINS/INSULATORS
 1. 3 3/4 WP AL PRI (H-S-C-N-P) ON WR #S3706522
 2. 3 3/4 WP AL PRI (H-S-C-N-P)
 3. 3 3/4 WP AL PRI (H-S-C-N-P)
 4. ANZ & GUY (H-S-C-N-P) NFE
 EX AT & T PRS (H-S-C-N-P) @ 24'
- ② CX-704093-50:3-10-1988-D-60%
 REMOVE POLE TAG & ABANDON POLE
 REM 10' X WBS & 3 STL PINS/INSULATORS
 1. 3 3/4 WP AL PRI (H-S-C-N-P)
 EX AT & T PRS (H-S-C-N-P) @ 24'
- ③ CX-708110-55:5-23-5-1988-D-60%
 REMOVE POLE TAG & ABANDON POLE
 REM D10BX WBS & 3 3/4 WP AL PRI (H-S-C-N-P)
 1. 3 3/4 WP AL PRI (H-S-C-N-P)
 2. 3 STL PINS/INSULATORS
 3. CUBERTAPS
 4. BUCKTAPS
 5. D7X WBS & 3 3/4 WP AL PRI (H-S-C-N-P)
 6. ANZ & 2 GUY'S (H-S-C-N-P) NFE
 EX AT & T PRS (H-S-C-N-P) @ 24'