

RETURN TO RIGHT-OF-WAY BEFORE SCHEDULING

THE C.E.I. CO. REGISTERED 18-15-11 P.C. NUMBER 4722-NW 2 WORKING DAYS BEFORE YOU DIG "IT'S THE LAW" CALL TOLL FREE 800-362-2764 OHIO UTILITIES PROTECTION SERVICE

FILE # 53859146 DATE 4-28-2011 SHEET 1 OF 2

PROJECT FOR: ODOT INNERBELT BRIDGE PROJECT
ADDRESS: 650 HARRISON ST. SOUTH OF W 3RD ST
CITY: CLEVELAND

WORK FOR: REMOVAL OF OH FACILITIES

PREPARED BY: S. STREKA
SURVEY NUMBER: 444-546-9732

PI# 77332

WBS: CE-000224

CONST. PLAN: 5-2-11 JOINT PROPOSAL

MARKETING: J.O. B.J.O.

DATE	J.P.	FOR EST.	O.H.	REP.	CABLE	SERV.	MARKT.	REC.	ENGR.	TOTAL
2		3							2	1

RETURN TO RIGHT-OF-WAY BEFORE SCHEDULING

DATE CLEARED

DESCRIPTION

APPROVED BY

REVISION HISTORY

CONSTRUCTION

CAUTION

MAXIMUM RMS SYMMETRICAL FAULT CURRENT AVAILABLE AT SERVICE ENTRANCE IS

THE CUSTOMER SHALL PROVIDE THE GROUNDING ELECTRODE CONDUCTOR AND GROUNDING ELECTRODE TO THE SERVICE ENTRANCE LOCATION.

WIRE NOTES

① TO ① SHT #2 REM 3 3/4 WP AL PRI (H-S-C-N-P) - 350'

OVERHEAD FOREMAN NOTE:

DO NOT REMOVE THIS SERVICE UNTIL THE NEW ITS AND MAINTAINED TRANSFORMER SERVICE HAS BEEN INSTALLED AND ACTIVATED. SEE WBS 4449248 FOR DETAILS OF THE NEW LAFARGE SERVICE.

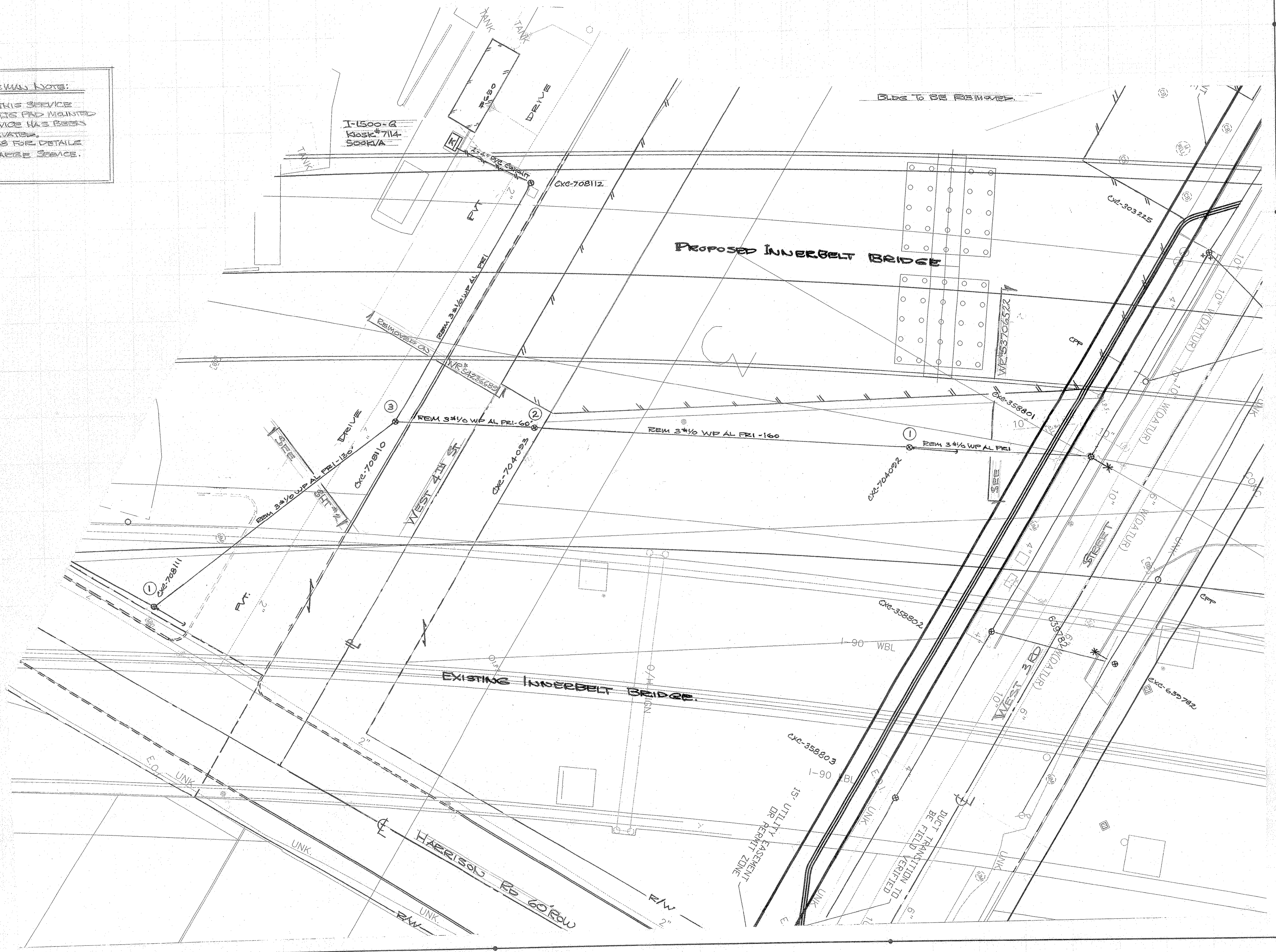

- ① CX-704092-50:3-10-1988-D-60%
REMOVE POLE TAG & ABANDON POLE
REM D7X WBS & 3 STL PINS/INSULATORS
1. 3V8 @ 3 3/4 WP AL PRI (NE) ON WR 453706522
2. 3V8 @ 3 3/4 AL PAGES
3. 3 3/4 WP AL PRI (NE)
4. ANE & GUY (NE) NFE
EX AT & T PRS (NE & SW) @ 24'
- ② CX-704093-50:3-10-1988-D-60%
REMOVE POLE TAG & ABANDON POLE
REM 10' X WBS & 3 STL PINS/INSULATORS
1. 3 3/4 WP AL PRI (NE)
EX AT & T PRS (NE & SW) @ 24'
- ③ CX-708110-55:5-23-5-1988-D-60%
REMOVE POLE TAG & ABANDON POLE
REM D10BX WBS & 3 V8s
1. 3 3/4 WP AL PRI (NW & S)
2. 3 STL PINS/INSULATORS
3. OVERTAPS
4. BUCKTAPS PLS
5. D7X WBS & 3 V8s
6. 3 3/4 WP AL PRI (NE)
7. ANE & 2 GUYs (S) NFE
EX AT & T PRS (NE & NW) @ 24'