

THE C.E.I. CO. REQUESTED 6/15/11 FAC. MAPPING REFERENCE # GRID # 4722
 FILE 53724618 DATE 2/15/11 SHEET 2 OF 6

SURVEY FOR INNERBELT BRIDGE PROJECT - WEST 3RD STREET
 ADDRESS WEST 3RD STREET - STONES LEVEE TO HARRISON ST.
 MUNICIPALITY CITY OF CLEVELAND SCALE NONE
 ORDER FOR OHIO DEPARTMENT OF TRANSPORTATION
 PREPARED BY SURVEY OFFICE DRAWN BY CHATFIELD PHONE 440.717.6846
 DESCRIPTION CIRCUIT RELOCATION WORK - OH TO UG

CONST. PLANS APPROVED JOINT PROPOSAL
 MARKETING SAPDN 13002553 J.D.

CONSUMER'S CHARGE

DATE	REC.	FIR-EST	D.H.	SUB-WAY	CABLE	SERV	RDD	DMCS	WES3	DCB1	RJS1	TOTAL
2/15/11	2		1		2		1	1	1	1	1	10

RETURN TO RIGHT-OF-WAY BEFORE SCHEDULING JOINT POLE RELEASE GANG MEET TREE WORK MUNICIPAL PERMIT INFO
 DATE CLEARED

WBS: CE-000246-DU

REVISION HISTORY

DATE	DESCRIPTION	APPROVED BY
2/15/11	CABLE INSTALL RELEASE	

CONSTRUCTION

A CHECK MARK NEXT TO EACH ITEM ON THE SKETCH INCLUDING CHANGES INDICATES THAT THE WORK HAS BEEN COMPLETED

ITEMS	UNITS OF WORK COMPLETED		
	INSTALLED	REMOVED	SHIFTED
POLES			
WIRE			
FRAMES			
ANCHORS			

KIND OF POLE(S) INSTALLED BY SYMBOL
 POLES LEFT FOR TEL. TO REMOVE

DATE WORK COMPLETED SUPERVISOR'S SIGNATURE

UNDERGROUND FACILITIES WARNING

HIGH PRESSURE PIPELINE	AT SYMBOL	CHECKED BY	SPECIAL INSTRUCTIONS
CEI			
TELEPHONE			

D.H. TRANSMISSION CLEARANCE WARNING

_____ FT. MIN. CLEARANCE REQUIRED AT _____ DEGREES F.
 AT SYMBOLS

ENGINEERING CHECKED BY: _____ DATE _____
 CONSTRUCTION CHECKED BY: _____ DATE _____

CONFIDENTIAL
FIRSTENERGY CORP.

INFORMATION IN THIS DOCUMENT IS PROPRIETARY AND SHALL NOT BE USED, COPIED, REPRODUCED OR DISCLOSED IN WHOLE OR IN PART WITHOUT THE WRITTEN CONSENT OF FIRSTENERGY CORP.

GENERAL CONSTRUCTION NOTES

CONSTRUCT ALL CURVES AND FANS WITH 5 DEGREE COUPLINGS AND CONVENIENT LENGTHS OF CONDUIT, EXCEPT PREFORMED CURVES SPECIFIED ON PLANS.
 LENGTH OF CURVES TO BE CONSTRUCTED AS SHOWN ON DRAWINGS.
 SEE CIVIL ENGINEERING DRAWINGS AND/OR UNDERGROUND CONSTRUCTION DRAWINGS OF MANHOLES FOR ALL DETAILS AND CONDUIT SPACING AT WALLS.
 UNDERGROUND UTILITIES SHOWN ARE PLOTTED FROM RECORDS AND FIELD SURVEYS TO THE BEST OF OUR KNOWLEDGE. CORRECTNESS IS NOT GUARANTEED AND MUST BE USED AT BIDDERS OWN RISK.
 EXACT LOCATION AND DEPTH OF ALL UTILITIES CROSSING PROPOSED TRENCH MUST BE ESTABLISHED IN ADVANCE OF CONDUIT INSTALLATION TO AVOID ANY RADICAL CHANGES IN CONDUIT DIRECTION.
 VERTICAL CURVES, EXCLUDING CONDUIT FANS AND PREDETERMINED CURVES, SHALL HAVE A 50' MINIMUM RADIUS.
 ALL CONDUITS TO BE 5" I.P.S. DIAMETER -- UNLESS OTHERWISE NOTED.
 MINIMUM COVER FROM FINISHED AND/OR EXISTING GRADE TO TOP OF CONCRETE ENVELOPE TO BE 30" UNLESS OTHERWISE NOTED.
 ALL CONDUIT RUNS (CONCRETE ENCASUREMENT) TO HAVE A MINIMUM OF 3.00" OF CONCRETE AROUND THE EXTERIOR CONDUIT OR CONDUITS AND A MINIMUM OF 1.50" OF CONCRETE BETWEEN CONDUITS.
 BASE SPACERS AND INTERMEDIATE SPACERS TO BE PLACED A MAXIMUM DISTANCE OF 5' APART.
 SECTIONS AA, BB, TO ZZ ON PLAN VIEW OR PROFILE ARE TO BE USED FOR CONDUIT DESIGNATION ONLY--DETAILS ON THIS SHEET ARE TO BE USED FOR SPACE REQUIREMENTS.
 A MINIMUM OF ONE LANE OF TRAFFIC SHALL BE MAINTAINED AT ALL TIMES IN CUSTOMER DRIVES.
 A MINIMUM 400lb TEST LINE IS TO BE INSTALLED IN ALL CONDUITS BETWEEN MANHOLES, POLES AND STUBBED CONDUITS
 MATERIAL FOR BACKFILL OPERATIONS ABOVE ALL CONCRETE ENCASED CONDUITS SHALL BE CEMENTITIOUS CONTROLLED DENSITY FILL (CDF) MIXTURES CONTAINING 50lbs. OF PORTLAND CEMENT PER CUBIC YARD. WATER CONTENT SHALL BE REDUCED BY CONCRETE PRODUCER BY ADDING DARAFILL AS MANUFACTURED BY THE W.R. GRACE COMPANY. DARAFILL SHALL BE ADDED AS PER MANUFACTURERS RECOMMENDATIONS TO ACHIEVE AN APPROXIMATE 30% AIR ENTRAINMENT. PLACE CDF BACKFILL BY A METHOD THAT WILL ALLOW FOR RUN-OFF OF EXCESS BLEED WATER.
 MATERIAL FOR ENCASUREMENT OPERATIONS AROUND ALL CONDUITS SHALL BE PORTLAND CEMENT CONCRETE WITH A 3000lb. PSI COMPRESSIVE STRENGTH AT 28 DAYS (FIVE SACK).
 ALL AREAS ARE TO BE RETURNED TO THE SAME OR BETTER CONDITION IN WHICH THEY WERE FOUND PRIOR TO CONSTRUCTION.
 CITY OF CLEVELAND WATER DEPARTMENT DEPTHS ARE NOT GUARANTEED AND SHOULD BE VERIFIED PRIOR TO EXCAVATION AND CLEARANCES SHOULD BE MAINTAINED PER DEPARTMENT STANDARDS.

CORRECTIONS	DATE	BY
REVISIONS	12-01-11	SMG
FOR PREVIOUS CORR. SEE OLD DRAWINGS	1-3-07	
EG0814 - 56155 AT 102.4 50% HOLE IN SOUTH WALL	7-13-02	CAC
INSTALL ADJUST TO GRADE FRAMES 183	8-19-02	CAC
4E4892 INSTALL FIBER OPTIC CABLE	10-27-07	LFW
4E 50415 INSTALL FIBER OPTIC CABLE	11-10-07	LFW
4E09114 INSTALL CONDUIT & F.O.C.	2-11-08	
	2-1-11	SMG

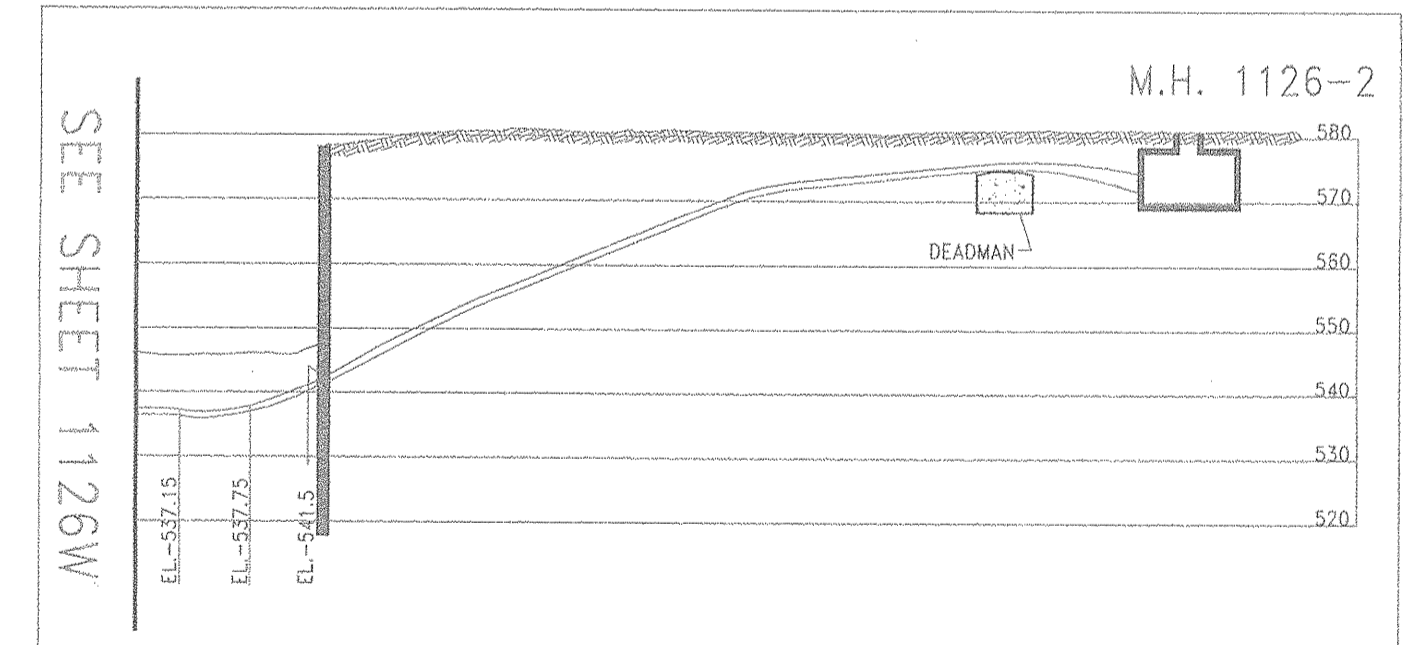
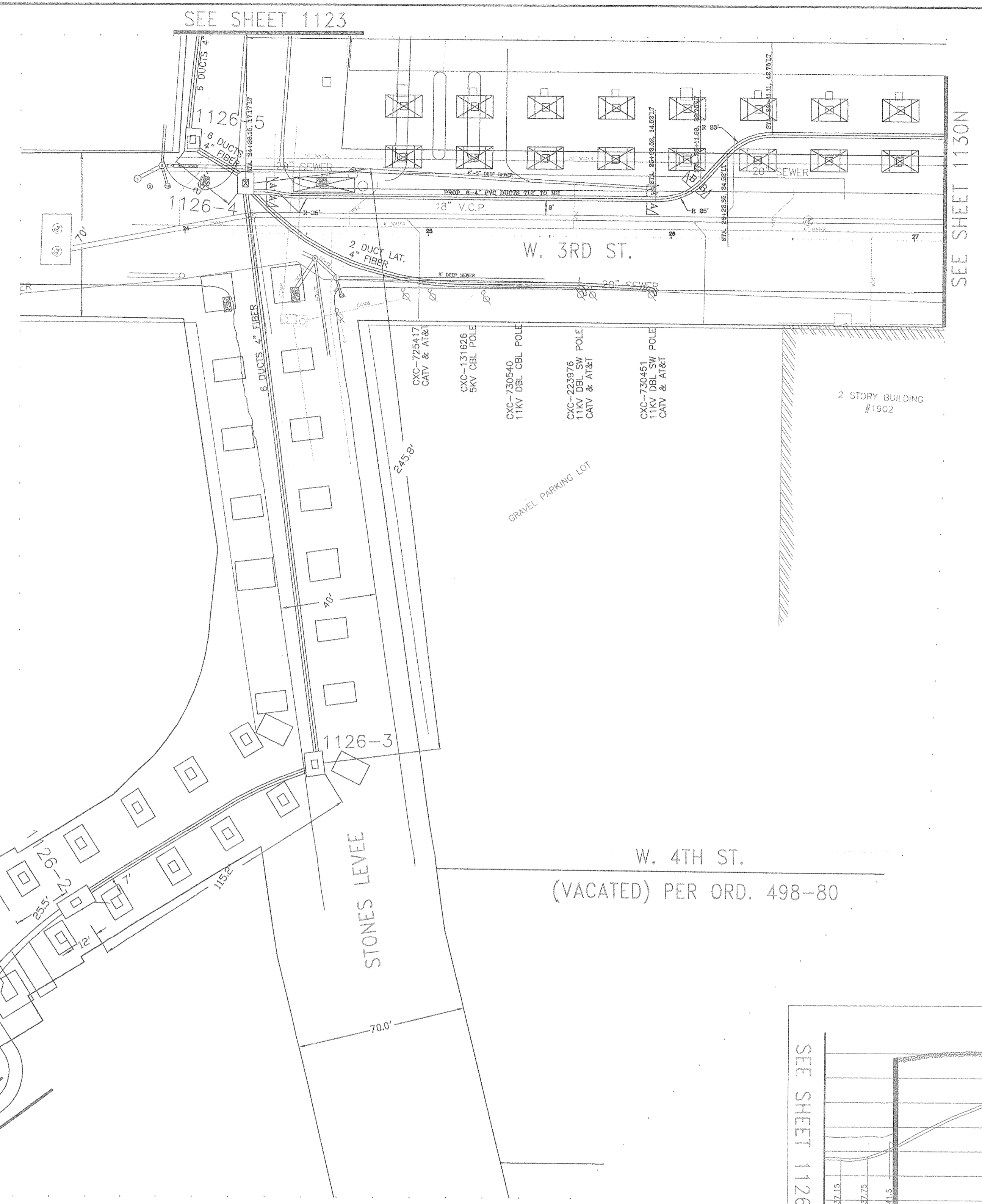

NOTE -- SUBWAY DISTANCES ARE GIVEN TO CENTER OF MANHOLES
 VENTS, CURBS & SERVICES ARE GIVEN TO CENTER OF COVERS

THE CLEVELAND ELECTRIC ILLUMINATING CO.
 SCRANTON RD.
 SUBMARINE CABLE CROSSING
 DRAWN 12-01-11
 SMG SHEET 1126E

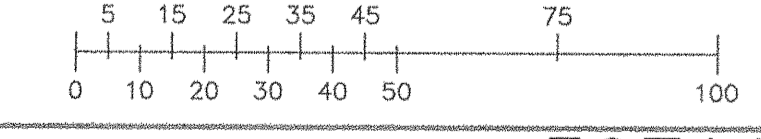

1126E