

RETURN TRACING TO STAKE

THE C.E.I. CO. REQUESTED FOR 12-15-11 P.C. WORKING DRAWS GRID #4222144
 FILE # 54858442 DATE 9-12-2011 SHEET 3 OF 3
 SURVEY FOR ODOT-13000000 BRIDGE PROJECT
 ADDRESS WEST 15TH ST & ABBEY RD
 MUNICIPALITY CLEVELAND SCALE 1"=20'
 ORDER FOR REMOVAL & RELOCATION OF OH FACILITIES
 PREPARED BY P. STELLA ENGINEERING 440-545-8755
 CHECKED BY P. STELLA
 PID # 77332
 WBS: CE-000224
 COST APPROVED 9/16/11 JOINT PROJECT 7.0.
 PROJECTING B.J.O.
 CONSUMER'S CHARGE \$
 DATE J.P. FOR-EST. O.H. SUB. MILE SERV. MKT. REC. ENGR. TOTAL
 2 3 2 1 2 1 1

RETURN TO RIGHT-OF-WAY BEFORE SCHEDULING
 JOINT POLE RELEASE
 GFCI MEET
 TREE WORK
 MUNICIPAL PERMIT INFO
 DATE CLEARED
 DATE DESCRIPTION APPROVED BY

REVISION HISTORY
 A CHECK MARK NEXT TO EACH ITEM ON THE SKETCH, INCLUDING CHANGES, INDICATES THAT THE WORK HAS BEEN COMPLETED
 UNITS OF WORK COMPLETED
 ITDS INSTALLED REMOVED SIFTED
 POLES
 WIRE
 FINISH
 ANCHORS
 KIND OF POLE(S) INSTALLED BY STRUCK
 POLES LEFT FOR TEL. TO REMOVE
 DATE WORK COMPLETED SUPERVISOR SIGNATURE

UNDERGROUND FACILITIES WARNING
 HIGH PRESSURE PIPELINE AT CHECKED BY SPECIAL INSTRUCTIONS
 CEI
 TELEPHONE
 O.H. TRANSMISSION CLEARANCE WARNING
 FT. MIN. CLEARANCE REQUIRED AT DEGREES F.
 AT SYMBOLS
 ENGINEERING CHECKED BY: DATE
 CONSTRUCTION CHECKED BY: DATE

MAXIMUM RMS SYMMETRICAL FAULT CURRENT AVAILABLE AT SERVICE ENTRANCE IS
 RPPS, 3PHASE VOLTS
 RPPS, 1PHASE VOLTS
 CEI CONTRIBUTION ONLY.
 THE CUSTOMER SHALL PROVIDE THE GROUNDING ELECTRODE CONDUCTOR AND GROUNDING ELECTRODE TO THE SERVICE ENTRANCE LOCATION.

11/11
 FORM SR133 REV. 2-82

WIRE NOTES

- ① TO ② REM 3 1/2 WP CU PEI (W) (H-8-CG-L)-135'
- ① TO ④ REM #4 DWP SEC-224'

- ② CXK-266143-50-3-1985-D-60%
 REM POLE TAG # ABA1000 POLE
 " 120'X HWB # 12 STL FINS.
 " 3V8 # 3 1/2 DE'S (W)
 " 3 1/2 WP CU PEI (W) (H-8-CG-L)
 " A100 # 2 GUY (S) WFE
 " 7HX STRAPS, 2-LA # 2-LPE'S
 " 250/A 10 TEASERS
 " 4340-12/240V
 " 3SBK-4 TEL BK
 " #4 DWP SEC (S&W)
 " 5'7" X STRAPS
 " 3-1000W WBB FLOODS
 " EX CPP # 1158 # PE LMP
 " TREMONT SIGN
 " WFE.

- ④ CXK-536735-50-3-1955-D-100%
 REM POLE TAG # ABA1000 POLE
 " REM D7'X WBS # 6 WD FINS.
 " AWC # 2 GUY (S) WFE
 " AWC # 2 GUY (S) WFE
 " E. FORK # 4 DWP SEC (W)
 " EX CPP # 1158 # PE LMP
 " FA 2'X NO WIRE.

- ③ CXK-651364-35-5-2003-D-100%
 REM POLE TAG # ABA1000 POLE
 " 5'7" X STRAPS
 " 2-1000W WBB FLOODS
 " 2 E. FORKS # 4 DWP SEC (S&W)
 " WFE.

- ① CXK-304617-45-3-1997-D-60%
 REM POLE TAG # ABA1000 POLE
 " 120'X WBS # 3 STL FINS.
 " 3 1/2 WP CU PEI (S&W) ST. SIDE (H-8-CG-L)
 " 3 V8 # 3-336.4 KCM DE'S (W) FLD SIDE
 " 3-336.4 KCM WP AL PEI (W) FLD SIDE (H-8-CG-P)
 " X-GUY (S)-135'
 " 120'X WBS
 " 3V8 # 3-336.4 KCM DE'S (W) ST. SIDE
 " 3-336.4 KCM WP AL PEI (W) ST. SIDE (H-8-CG-L)
 " HD GUY (S)-135'
 " E. FORK # 4 DWP SEC (S&W)
 " EX CPP # 1158 # PE LMP
 " TREMONT SIGN
 " BUS STOP SIGN
 " TRAFFIC SIGN

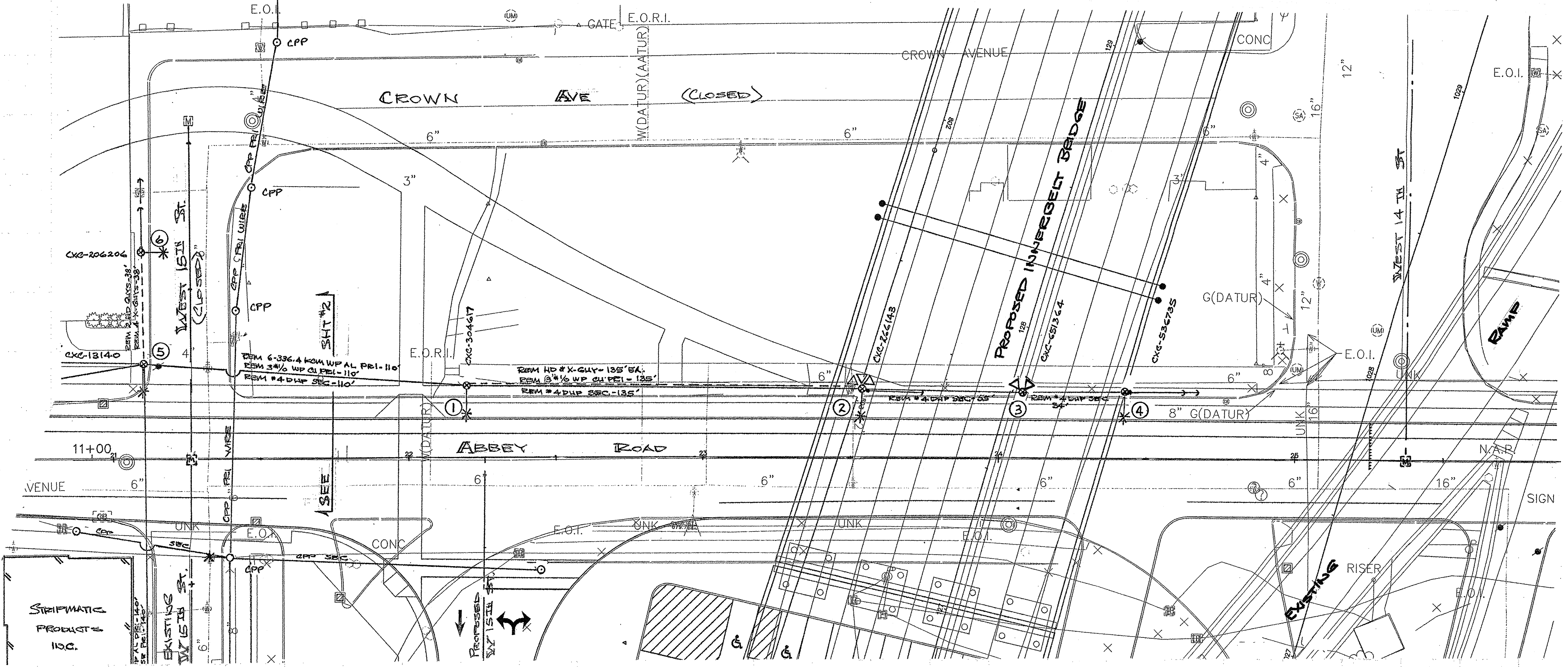

REMOVAL SYM #3
TRANS DATA
 CO # _____ @ COMP
 KVA 25 _____ ABC