

(TO BE TURNED OFF AT AFC SUBMITTAL)

CHECK PRINT (INITIAL & DATE)	CHECKED BY:	MADE BY:
	BACKCHECKED BY:	
CORRECTED BY:	VERIFIED BY:	

NOTE: SEE DWG. NOS. SP-001 TO SP-016 IN SURVEY CONTROL FOR ALIGNMENT INFORMATION.
 SEE DWG. NO. DV-001 FOR DRIVE DETAIL.
 SEE DWG. NOS. IS-008 & IS-009 FOR INTERSECTION DETAILS.
 SEE DWG. NOS. DR-001 TO DR-009 FOR STORM SEWER PROFILES.
 SEE DWG. NO. LS-005 FOR LANDSCAPING PLAN AND PLAZA DETAILS.
 SEE DWG. NO. DM-001 TO DM-026 FOR REMOVAL INFORMATION AND DISPOSITION OF UTILITIES.

LEGEND
 APPROXIMATE FUTURE I-90 EB BRIDGE

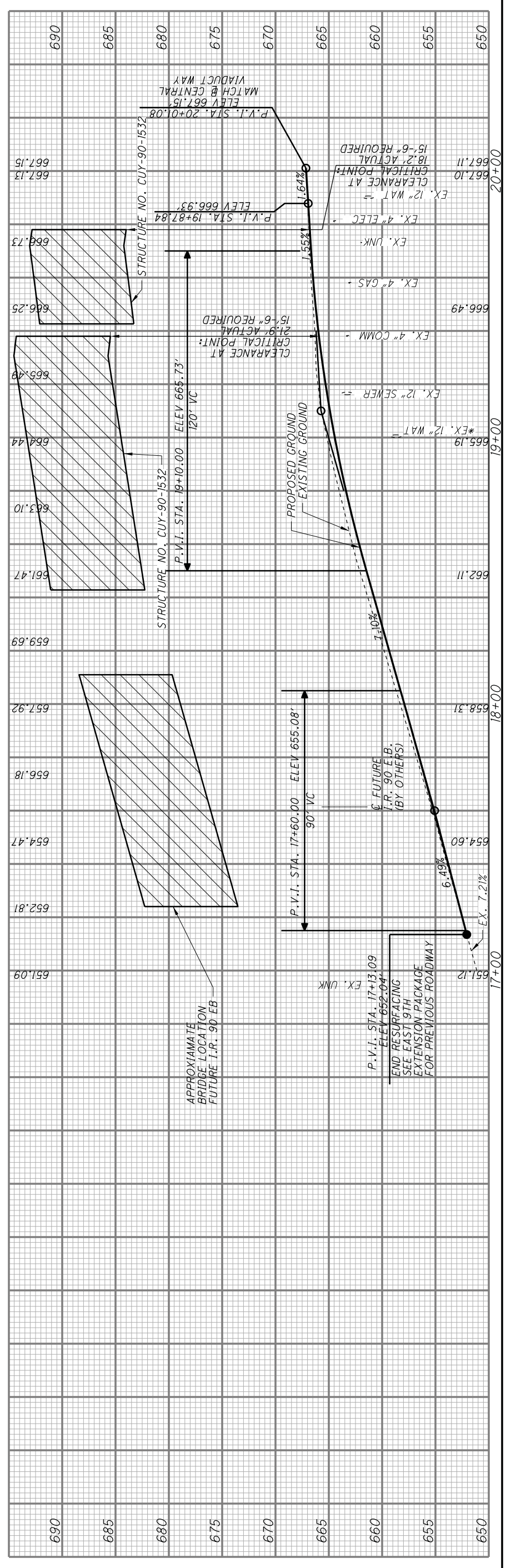
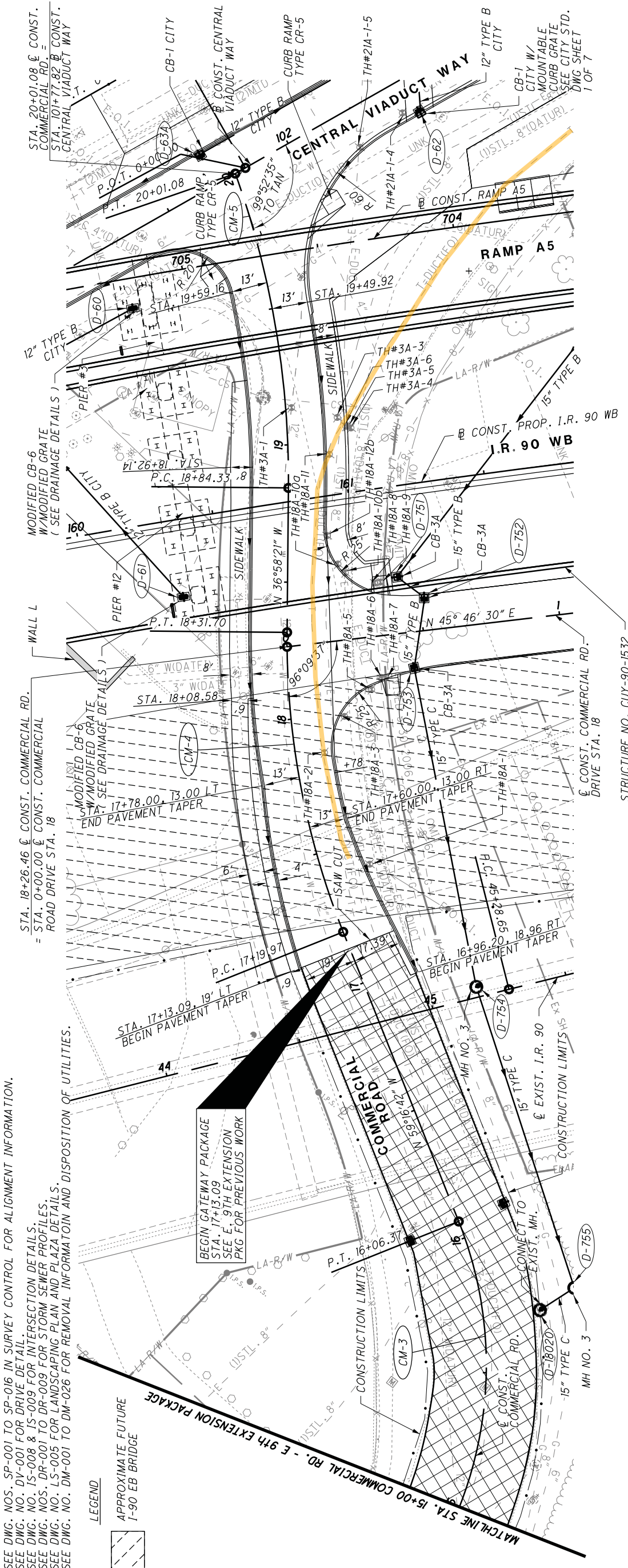

NO.	REVISIONS	DATE
A	FINAL SUBMITTAL	08/17/2011
B	FINAL SUBMITTAL ADDITIONAL INFORMATION	08/23/2011
C	FINAL SUBMITTAL TO ODOT	09/30/2011
D	FINAL COMPLIANCE	11/03/2011

DESIGN AGENCY
WLSH HNTB
 WASHINGTON STATE TRANSPORTATION DEPARTMENT

INNERBELT BRIDGES
 CLEARLANDS
 90
 ROADWAY GATEWAY

ROADWAY GATEWAY
 STA. 17+00 TO STA. 20+01.08

CUY-90-14.90
 SCALE IN FEET
 HORIZONTAL
 0 10 20 40
 DESIGNED: JTL
 CHECKED: JRG
 DRAWING NO.: PP-102A
 145
 349

(TO BE TURNED OFF AT AFC SUBMITTAL)

CHECK PRINT (INITIAL & DATE) CHECKED BY: _____
 MADE BY: _____
 BACKCHECKED BY: _____
 CORRECTED BY: _____
 VERIFIED BY: _____

SEEDING
 END SO.
 WIDTH YDS.

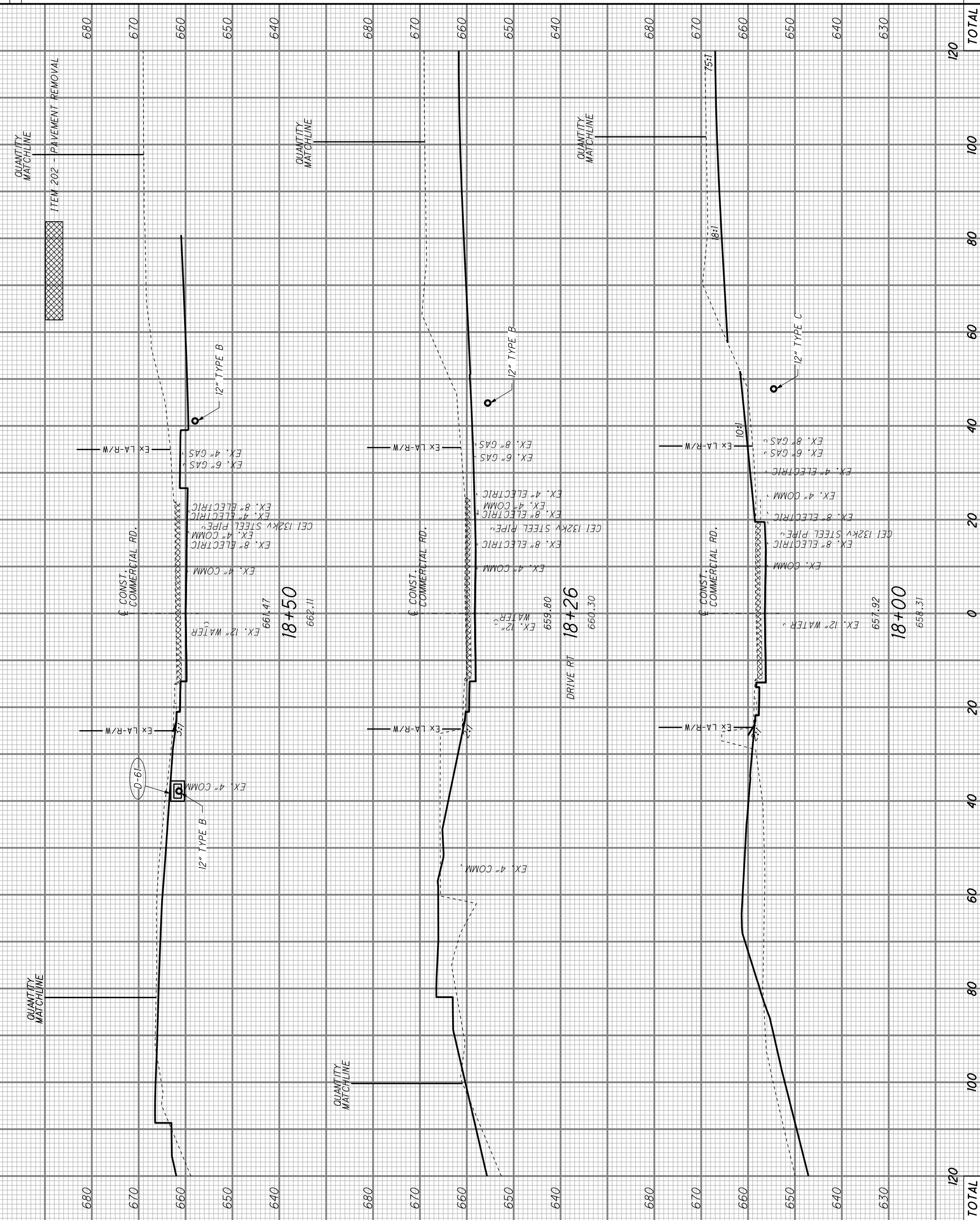

END AREA	VOLUME	CUT	FILL
120	TOTAL		

DESIGNED: JTL
 CHECKED: JRG
 SCALE IN FEET
 HORIZONTAL
 0 5 10 20

ROADWAY
 GATEWAY



DESIGN AGENCY
WILSH HNTB
 WALSH CONSTRUCTION

CUY-90-14.90
 DWG. NO. XS-131

CROSS SECTIONS - COMMERCIAL
 STA. 18+00 TO STA. 18+50

REVISIONS

NO.	DATE	DESCRIPTION
A	12/29/2010	INTERIM SUBMITTAL
B	01/19/2011	ADDENDUM TO INTERIM SUBMITTAL
C	08/03/2011	FINAL SUBMITTAL
D	09/30/2011	FINAL SUBMITTAL TO ODOT
E	11/03/2011	FINAL COMPLIANCE

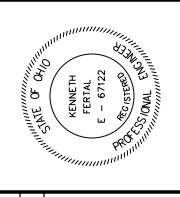

147
 349



ROADWAY
GATEWAY



DESIGN AGENCY
WILSH HNTB

PARKING LOT PLAN
GRADING
DOWNTOWN NEIGHBORHOOD PARKING

NO.	REVISIONS	DATE
A	FINAL SUBMITTAL TO ODOT	08/02/2011
B	FINAL SUBMITTAL TO ODOT	09/30/2011
C	FINAL RESUBMITTAL	11/03/2011

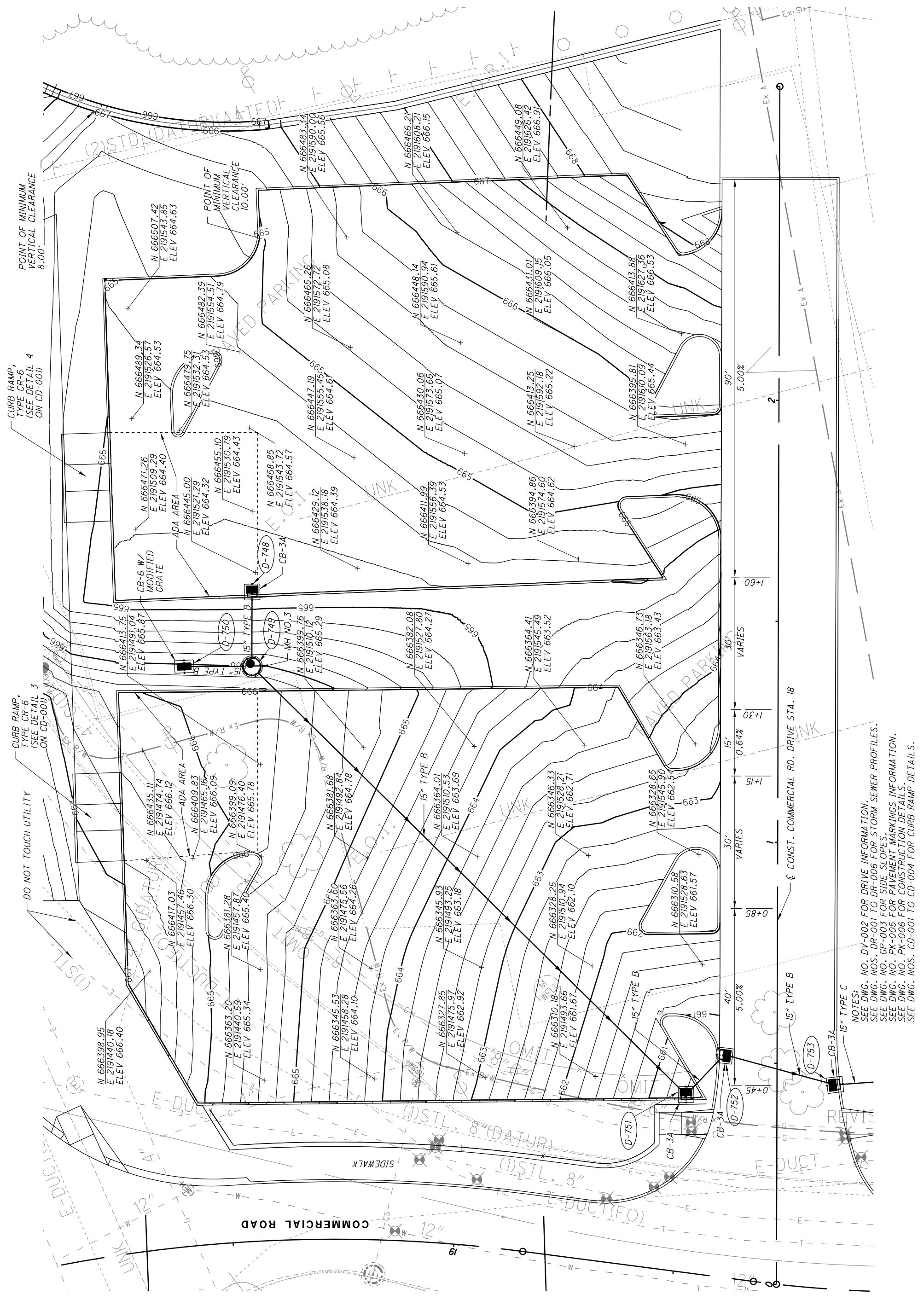
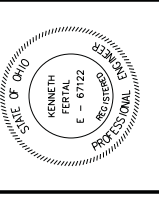

NOTES:
SEE DWG. NO. DV-002 FOR DRIVE INFORMATION.
SEE DWG. NOS. DR-001 TO DR-006 FOR STORM SEWER PROFILES.
SEE DWG. NO. GP-003 FOR SIDE SLOPES.
SEE DWG. NO. PK-005 FOR PAVEMENT MARKINGS INFORMATION.
SEE DWG. NO. PK-006 FOR CONSTRUCTION DETAILS.
SEE DWG. NOS. CD-001 TO CD-004 FOR CURB RAMP DETAILS.

11/10/2011 5:49:46 AM Model:Sheet1 File:49633-S-RD-FRK01.dgn	MADE BY:	CHECKED BY:	BACKCHECKED BY:	VERIFIED BY:
	CHECK PRINT (INITIAL & DATE)			

(TO BE TURNED OFF AT AFC SUBMITTAL)