

LAKE COUNTY  
LAK-I-10.38

P PAVEMENT

REF. NO.	STATION	SIDE	T-71		I-22	T-31	NO. 6 AGGR.	B-219	I-18	E-1	I-12	I-13	I-21	T-71
			10" REINF. PORTLAND CEMENT CONC. PAVT.	PORTLAND CEMENT CONC. PAVT.	BIT. MATL.	3" WATER-PROOFED AGGR. BASE COURSE		5" STAB. CRUSHED AGGR. SHOULDERS & APPRS.	COMP. SUB-GRADE	STD. TYPE 6 CURB	SPECIAL PORTLAND CEMENT CONC. CURB	SPECIAL PORTLAND CEMENT CONC. CURB (MOD.)	PORTLAND CEMENT CONC. SIDEWALK	4" CONC. MED. PAVT. TYPE I
FROM	TO	S.Y.	C.Y.	GALS.	C.Y.	S.Y.	L.F.	S.F.	S.Y.	S.Y.	S.Y.	S.Y.	S.Y.	
1-P	229+26.66	11+27.51 RAMP	3666	845	289	9.3	96	176	4823	450	1493	2531*	39	3781
2-P	11+27.51 RAMP	0+00 RAMP		709					3781	389				
3-P	0+00 RAMP	269+90.85 M	2255	469	73	2.3	24	48	2547	205				
TOTALS			5921	2023	362	11.6	120	224	11,151	594	450	1493	39	3781

\*100% State

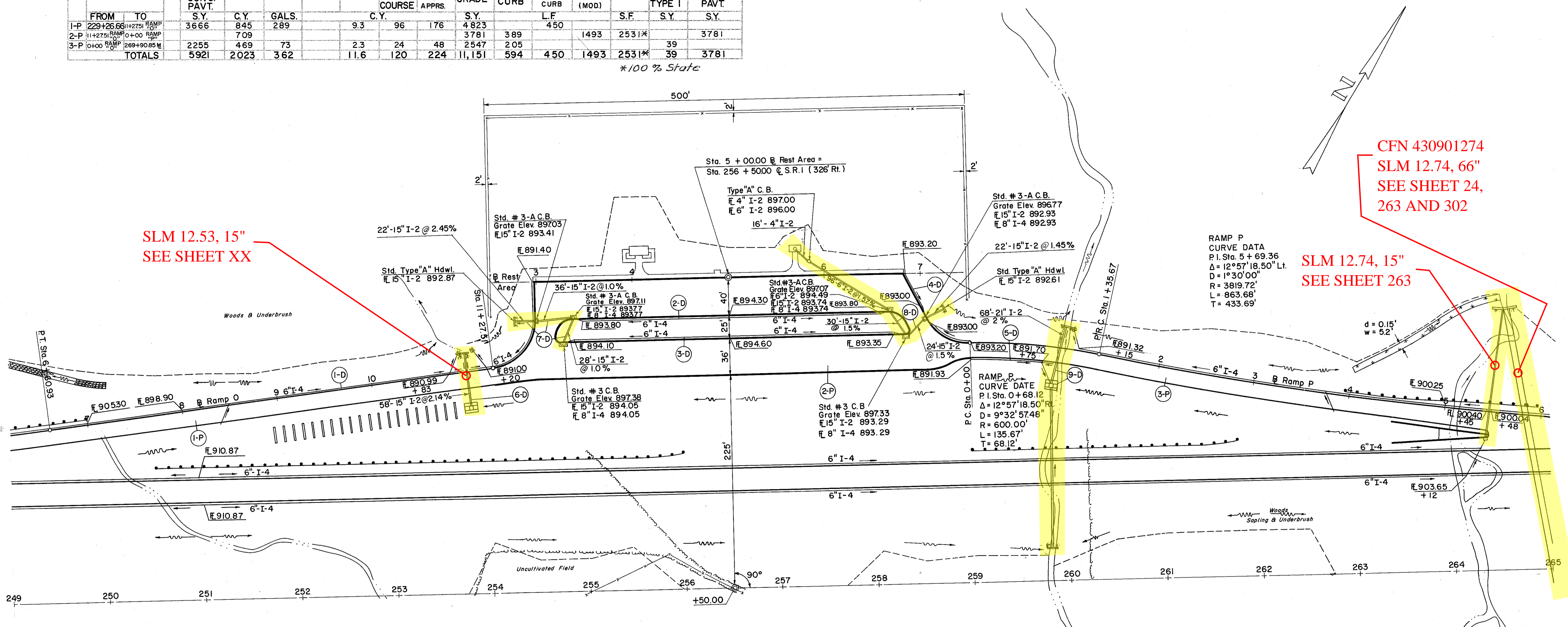

SLM 12.53, 15"  
SEE SHEET XX

CFN 430901274  
SLM 12.74, 66"  
SEE SHEET 24,  
263 AND 302

SLM 12.74, 15"  
SEE SHEET 263

RAMP P  
CURVE DATA  
P.I. Sta. 5 + 69.36  
Δ = 12°57'18.50" Lt.  
D = 1°30'00"  
R = 3819.72'  
L = 863.68'  
T = 433.69'

D DRAINAGE

REF. NO.	STATION	SIDE	E-2	I-2			I-4		I-5	I-8			L-10	S-1	S-4	S-29
			EXC. FOR STRUCT.	CL. "A" STORM SEWER UNDER PAVT.	CL. "A" STORM SEWER	CL. "B" STORM SEWER	15" CL. "B" STORM SEWER UNDER PAVT.	6" PIPE UNDERDRAIN	8" OUTLET PIPE SEC. M-64(a)	6" WYE	TYPE "A" CATCH BASIN	STD. #5 CATCH BASIN	STD. #3 CATCH BASIN	STD. #3-A CATCH BASIN	SODDING	CONC. FOR STRUCT. CL. "C"
FROM	TO	C.Y.	6"	15"	21"	SHALLOW	DEEP	EA	EA	EA	EA	S.Y.	C.Y.	LBS.	C.Y.	
1-D	7+00	LT						576	20							
2-D	3+40	RT						310	20							
3-D	3+30	RT						336	20							
4-D	6+88	RT						82	20							
5-D	0+00	RT						100	10							
6-D	11+00	RT	6		58							56	3.1	146		
7-D	11+00	RT	6									2	3.1	146		
8-D	5+70	RT	6	96		16*		50	36			2	3.1	146		
9-D	0+96	RT	6		68							2	3.1	146		

\*100% State