



To Whom It May Concern:

Enclosed please find a copy of a Columbia Gas of Ohio, Inc. (COH) map showing the approximate location of COH mainline facilities within the limits of the proposed project.

We would appreciate an opportunity to review all potential conflicts with you during the early design phase to eliminate or minimize construction conflicts. We would also like to request a final set of plans and projected construction schedule as soon as they become available.

The attached map of Ohio identifies COH operating territory and engineering contact names, addresses, and telephone numbers.

Before digging, please call the Ohio Utilities Protection Service (OUPS) at 1-800-362-2764 for a field locate of COH facilities.

If you need additional information or if you have any questions, please feel free to call the engineering contact in your project area. Thank you for your cooperation.

Sincerely,

Columbia Gas of Ohio, Inc.

Enclosures

From: Columbia Gas of Ohio Damage Prevention Center
866-632-6243
614-460-6800

To: OUPS Pre-planning or Design Information Requestor

Columbia Gas of Ohio wishes to remind you about the unreliability of information about the "Approximate Depth of Installation" (ADI) of buried utility facilities, and to urge you to ensure that prudent and reasonable efforts are always taken to locate the **actual depth** of buried facilities below grade.

The Ohio Public Works Statute, Ohio Rev. Code §153.64, provides that a utility (or its agent) must respond to a request for location of a buried utility facility by staking, marking or otherwise designating the location of underground facilities in the construction area "in such a manner as to indicate their course together with the approximate depth at which they were installed." When Columbia Gas of Ohio has information about approximate depth of installation, it provides it. In the absence of specific records, it is generally true that Columbia Gas of Ohio installs gas lines from 18 inches to 24 inches below the surface of the ground. However, you need to know that even when reliable information is available about a gas line's approximate depth of installation, **that information gives no reasonable basis for establishing the current depth below grade of the line along its course at any time after the installation date. Excavators must NOT rely on indications of Approximate Depth of Installation when planning or performing their work.**

Several factors make the approximate depth of installation an unreliable predictor of the actual depth below the ground of a gas line. First, Columbia has no way of knowing about changes in the terrain above the underground gas line after a line is installed due to erosion, grading or filling. Moreover, when a gas line is installed its depth is likely to be non-uniform as a consequence of unevenness in the terrain above it, or because of underground obstructions that may require vertical displacement.

As a result, excavators always must proceed with reasonable care in digging within the ~~approximate location, or tolerance zone, of utility facilities and must not use powered equipment~~ within the tolerance zone prior to exposing potentially conflicting facilities via non-intrusive excavation techniques.

The Common Ground Alliance, a broad-based coalition of utilities, municipalities, construction contractors, excavators and federal and state agencies has issued a compilation of industry best practices relating to safely excavating around marked underground utilities, The Best Practice Report, Version 2.0 (December, 2004). Excavation Practices 19 and 20 identify the reasonable techniques excavators should employ to determine the actual location of an underground utility whose approximate location has been marked:

19. EXCAVATION TOLERANCE ZONE

Practice Statement: The excavator observes a tolerance zone which is comprised of the width of the facility plus 18" on either side of the outside edge of the underground facility

on a horizontal plane. This practice is not intended to preempt any existing state requirements that currently specify more than 18”.

20. EXCAVATION WITHIN TOLERANCE ZONE

Practice Statement: When excavation is to take place within the specified tolerance zone, the excavator exercises such reasonable care as may be necessary for the protection of any underground facility in or near the excavation area. Methods to consider, based on certain climate or geographical conditions, include: hand digging when practical (pot holing), soft digging, vacuum excavation methods, pneumatic hand tools, other mechanical methods with the approval of the facility owner/operator, or other technical methods that may be developed. Hand digging and non-invasive methods are not required for pavement removal.

These excavation best practices are quite similar to the excavation duties set forth in Ohio Rev. Code §3781.30:

3781.30 Duties during excavation

When making excavations, the excavator shall do all of the following:

- (A) Maintain reasonable clearance between any underground facility and the cutting edge or point of powered equipment;
- (B) Protect and preserve the markings of approximate locations of underground utility facilities until those markings are no longer required for proper and safe excavations;
- (C) When approaching underground utility facilities while excavating with powered equipment, require an individual other than the equipment operator, to look for any sign of the underground utility facility;
- (D) *Conduct the excavation in the vicinity of the underground utility facility in a careful and prudent manner, excavating by hand, if necessary, to determine the precise location of the facility and to prevent damage...*

Columbia Gas of Ohio is committed to work with governmental subdivisions and their public works project managers and contractors to raise awareness about the danger in assuming that the Approximate Depth of Installation of a utility facility is useful in determining the actual current depth of marked facilities. We urge the use of prudent, non-invasive excavation techniques at all times to establish the actual current location below grade of underground utility facilities.

~~Should you have any questions or require additional information, please contact the Columbia Gas of Ohio Damage Prevention Center.~~

Very truly yours,

Columbia Gas of Ohio

COH OPERATIONS CENTERS LOCATIONS & ENGINEERS

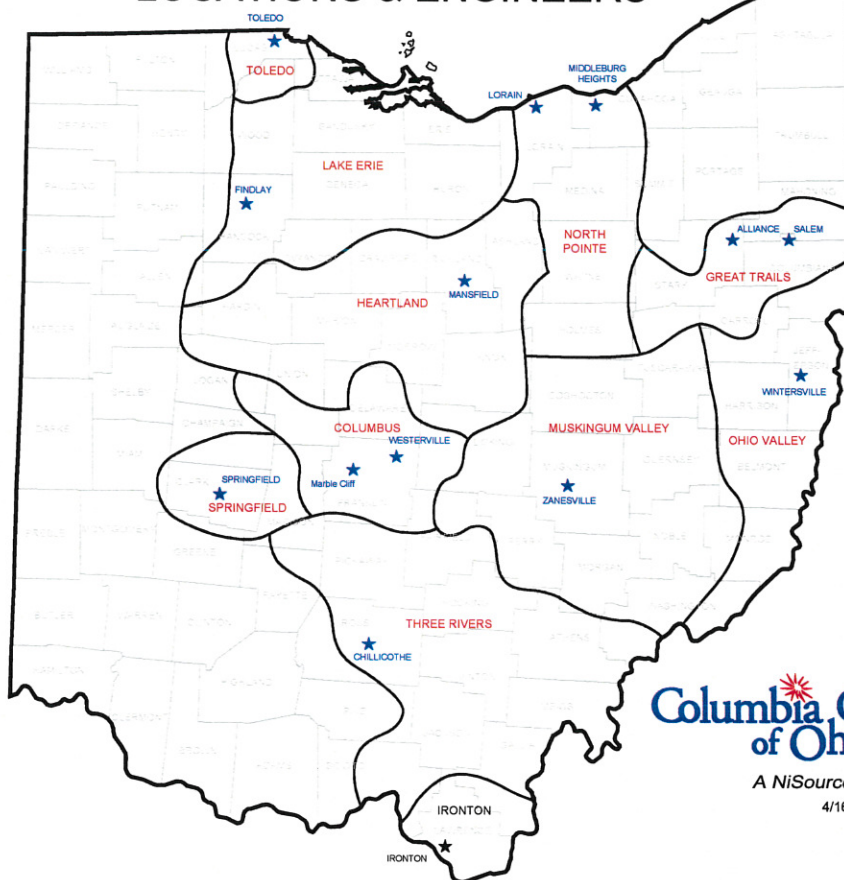

**Columbia Gas[®]
of Ohio**
A NiSource Company
4/16/12

<u>Operating Center</u>	<u>Engineering Contact</u>	<u>Address</u>	<u>Email</u>	<u>Phone</u>
Toledo	Tom Jados	3222 Central Ave. Toledo, OH 43606	tjados@nsource.com	419-539-6065
	Steve Munoz	3222 Central Ave. Toledo, OH 43606	smunoz@nsource.com	419-539-6061
	Clint Wells	3222 Central Ave. Toledo, OH 43606	clintwells@nsource.com	419-539-6209
	Jon Lucas	3222 Central Ave. Toledo, OH 43606	jucas@nsource.com	419-539-6062
	Heidi Zacher	3222 Central Ave. Toledo, OH 43606	hzacher@nsource.com	419-539-6081
	Tony Buckley	3222 Central Ave. Toledo, OH 43606	abuckley@nsource.com	419-539-6063
Lake Erie	Robert Langford	1800 Broad Ave. Findlay, Ohio 45840	rlangford@nsource.com	419-427-3227
	Nathan Loden	1800 Broad Ave. Findlay, Ohio 45840	nloden@nsource.com	419-427-3206
	Linda Risner	1800 Broad Ave. Findlay, Ohio 45840	lrisher@nsource.com	419-427-3242
North Pointe	Adam Woodie	3101 North Ridge Rd., E. Lorain, OH 44055	awoodie@nsource.com	440-240-6144
	Joyce Mesenburg	3101 North Ridge Rd., E. Lorain, OH 44055	jmesenburg@nsource.com	440-240-6118
	Linda Driscoll	7080 Fry Rd. Middleburg Heights, OH 44130	ldriscoll@nsource.com	440-891-2439
	Daniel Suran	7080 Fry Rd. Middleburg Heights, OH 44130	dsuran@nsource.com	440-891-2428
	Molly Zanath	7080 Fry Rd. Middleburg Heights, OH 44130	mzanath@nsource.com	440-891-2441
Great Trails	Eric Slowbe	7080 Fry Rd. Middleburg Heights, OH 44130	eslowbe@nsource.com	440-891-2454
	James Culbertson	7080 Fry Rd. Middleburg Heights, OH 44130	jculbertson@nsource.com	440-891-2449
Ironton	Mike Pierce	121 Ninth St. Ashland, Ky 41101	jpierce@nsource.com	606-324-7115
Heartland	Kurt Saum	1800 Broad Ave. Findlay, OH 45840	ksaum@nsource.com	419-427-3216
	Michael Motter	1021 N. Main Street, Mansfield, OH 44903	mmotter@nsource.com	419-528-1117
Columbus (NW & Marysville)	David Kelly	1600 Dublin Rd. Columbus, OH 43215	dkelly@nsource.com	614-481-1058
	Richard Lester	1600 Dublin Rd. Columbus, OH 43215	rlster@nsource.com	614-481-1051
Columbus (Downtown & SW)	Robert Caldwell	1600 Dublin Rd. Columbus, OH 43215	rcaldwell@nsource.com	614-481-1057
	Ryan Riley	1600 Dublin Rd. Columbus, OH 43215	rriley@nsource.com	614-481-1052
Columbus (NE & Delaware)	Matt Coyne	3550 Johnny Appleseed Court Col, OH 43231	mcoyne@nsource.com	614-818-2107
	David Beadle	3550 Johnny Appleseed Court Col, OH 43231	dbeadle@nsource.com	614-818-2105
	Randall Sekavec	3550 Johnny Appleseed Court Col, OH 43231	rsekavec@nsource.com	614-818-2106
Columbus (SE)	Bryan Kopachy	3550 Johnny Appleseed Court Col, OH 43231	bkopachy@nsource.com	614-818-2133
	Waite Carlisle	3550 Johnny Appleseed Court Col, OH 43231	wcarlisle@nsource.com	614-818-2117
Muskingum Valley	Christopher Dennis	2429 N. Linden Ave. Zanesville, OH 43701	christopherdennis@nsource.com	740-652-0807
	Eric Morrison	2429 N. Linden Ave. Zanesville, OH 43701	emorrison@nsource.com	740-450-1216
	William Rich	98 Steubenville Ave. Cambridge, OH 43727	wrich@nsource.com	740-648-0079
Ohio Valley	Tim Seech	300 Luray Dr. Wintersville, OH 43953	tseech@nsource.com	740-266-4282
	Nicholas Pietro	300 Luray Dr. Wintersville, OH 43953	npietro@nsource.com	740-266-5935
Springfield	David Greenwell	2101 W. Main St. Springfield, OH 45504	dgreenwell@nsource.com	937-215-2255
	Joe Parsley	2101 W. Main St. Springfield, OH 45504	jparsley@nsource.com	937-327-7109
Three Rivers	Palmer Blankenship	843 Piatt Ave. Chillicothe, OH 45601	pblankenship@nsource.com	740-772-9129

NOTICE

THIS MAP REFLECTS ONLY THE APPROXIMATE LOCATION
OF ACTIVE MAINS AND MUST NOT BE USED TO COMMIT
COLUMBIA GAS OF OHIO, INC. UNTIL LOCATIONS
ARE VERIFIED AND FIELDS CHECKED BY THE COMPANY
BEFORE YOU DIG CALL: OHIO UTILITIES PROTECTION SERVICE
AT 1-800-382-2764 (TOLL FREE)

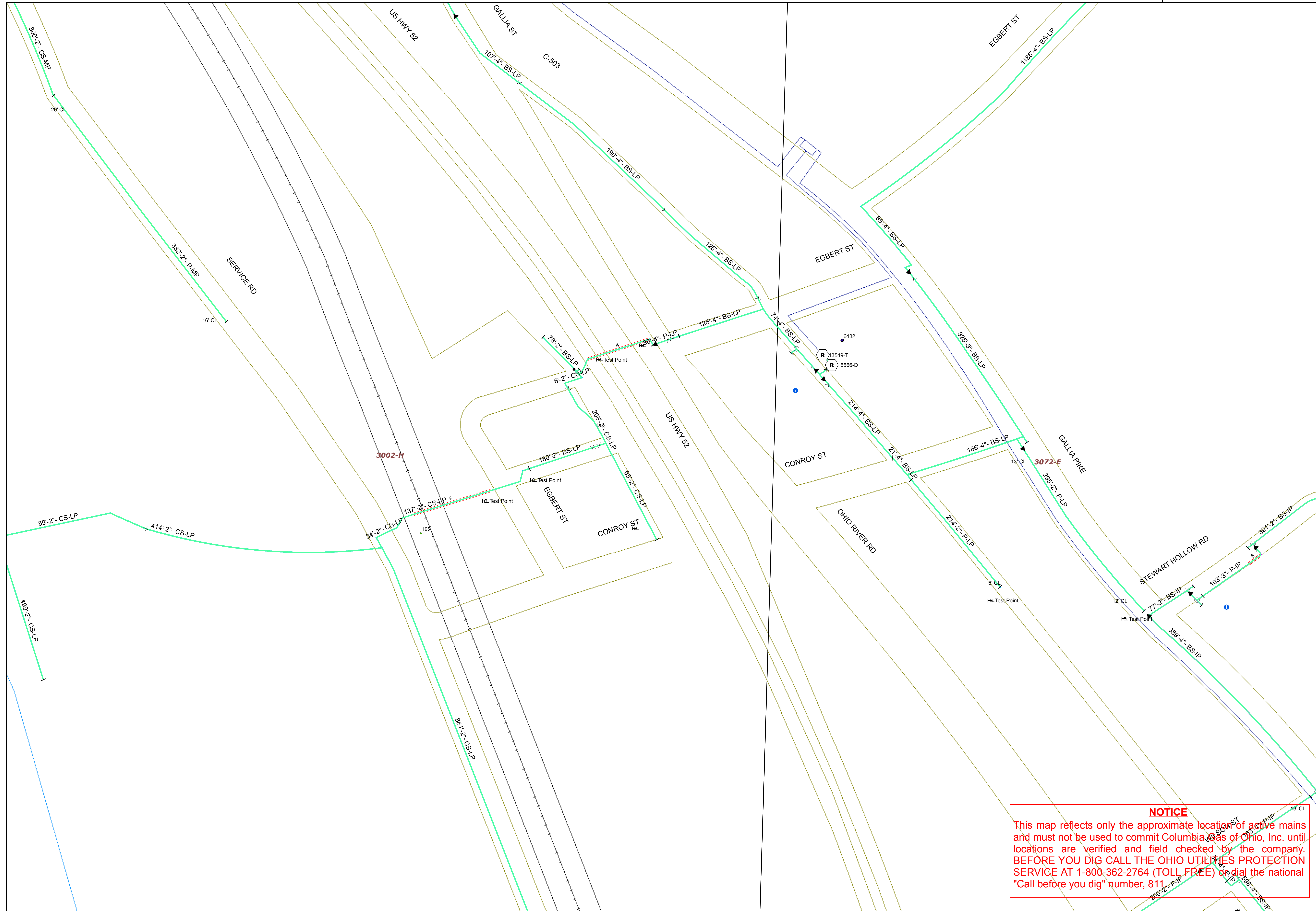
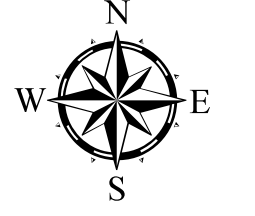

Legend:

- Gas Valve**
- ⊗ <all other values>
 - ⊗ Non-Critical Valve
 - Critical Valve

**Gas Mains:
Distribution & Foreign**

- Distribution
- Foreign

**Gas Mains:
DOT Transmission & Other**

- Transmission
- DOT Transmission
- DOT Gathering
- Pseudo-Transmission

Gas Service

- <all other values>
- Steel
- Cast Iron
- Wrought Iron
- Plastic
- Other
- Fittings
- Historic Map

NOTICE
This map reflects only the approximate location of active mains and must not be used to commit Columbia Gas of Ohio, Inc. until locations are verified and field checked by the company. BEFORE YOU DIG CALL THE OHIO UTILITIES PROTECTION SERVICE AT 1-800-362-2764 (TOLL FREE) or dial the national "Call before you dig" number, 811.

Prepared by:	
Date:	
Coordinates: GCS (Lat/Long) in DMS. Datum: WGS84	

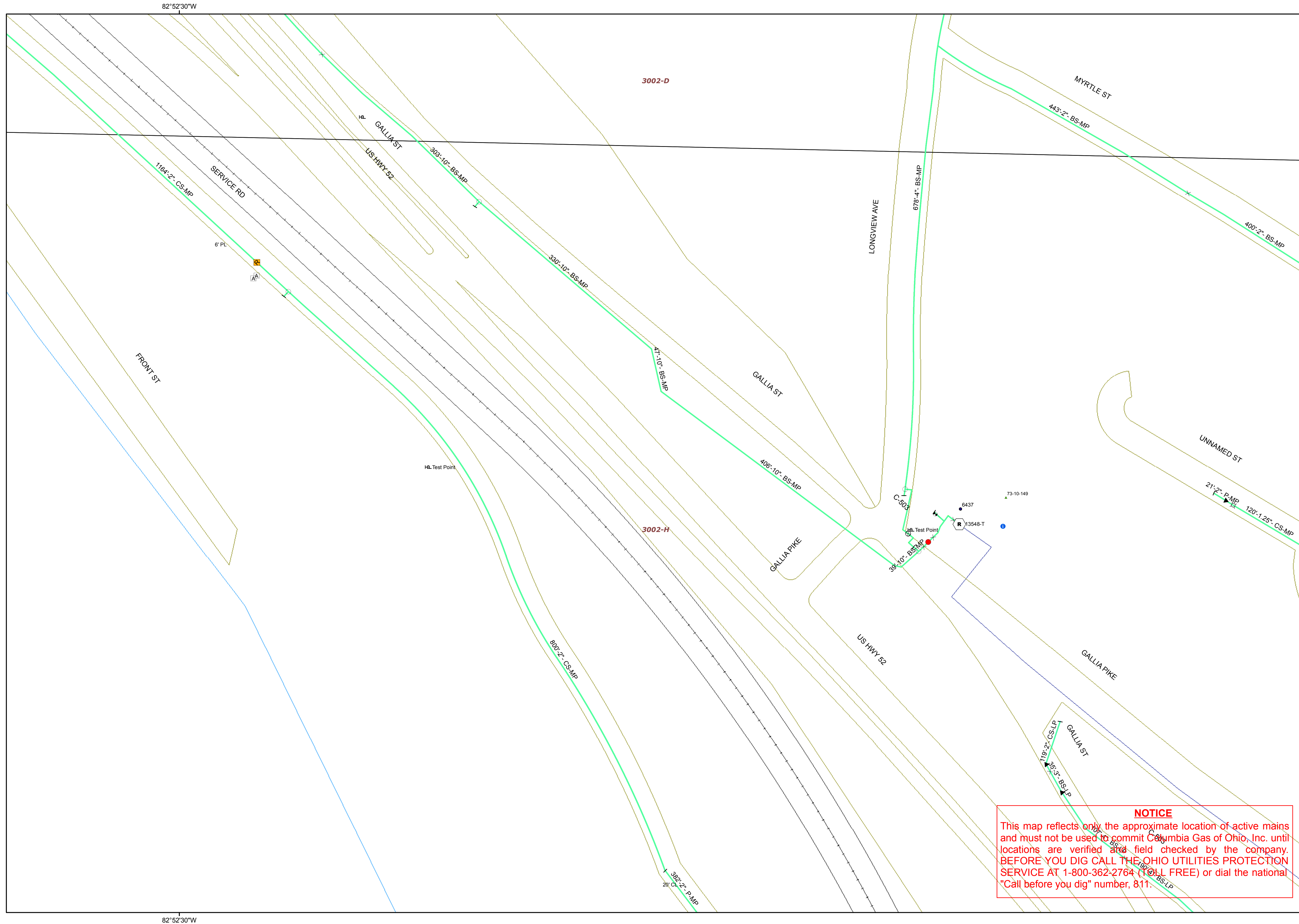
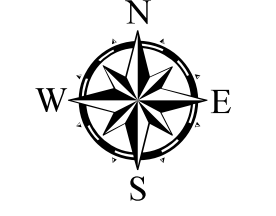

Legend:

Gas Valve

- ⊗ <all other values>
- ⊗ Non-Critical Valve
- Critical Valve

Gas Mains: Distribution & Foreign

- Distribution
- Foreign

Gas Mains: DOT Transmission & Other

- Transmission
- DOT Transmission
- DOT Gathering
- Pseudo-Transmission

Gas Service

- <all other values>
- Steel
- Cast Iron
- Wrought Iron
- Plastic
- Other
- Fittings
- Historic Map

NOTICE
This map reflects only the approximate location of active mains and must not be used to commit Columbia Gas of Ohio, Inc. until locations are verified and field checked by the company. BEFORE YOU DIG CALL THE OHIO UTILITIES PROTECTION SERVICE AT 1-800-362-2764 (TOLL FREE) or dial the national "Call before you dig" number, 811.

Prepared by:	
Date:	
Coordinates: GCS (Lat/Long) in DMS. Datum: WGS84	

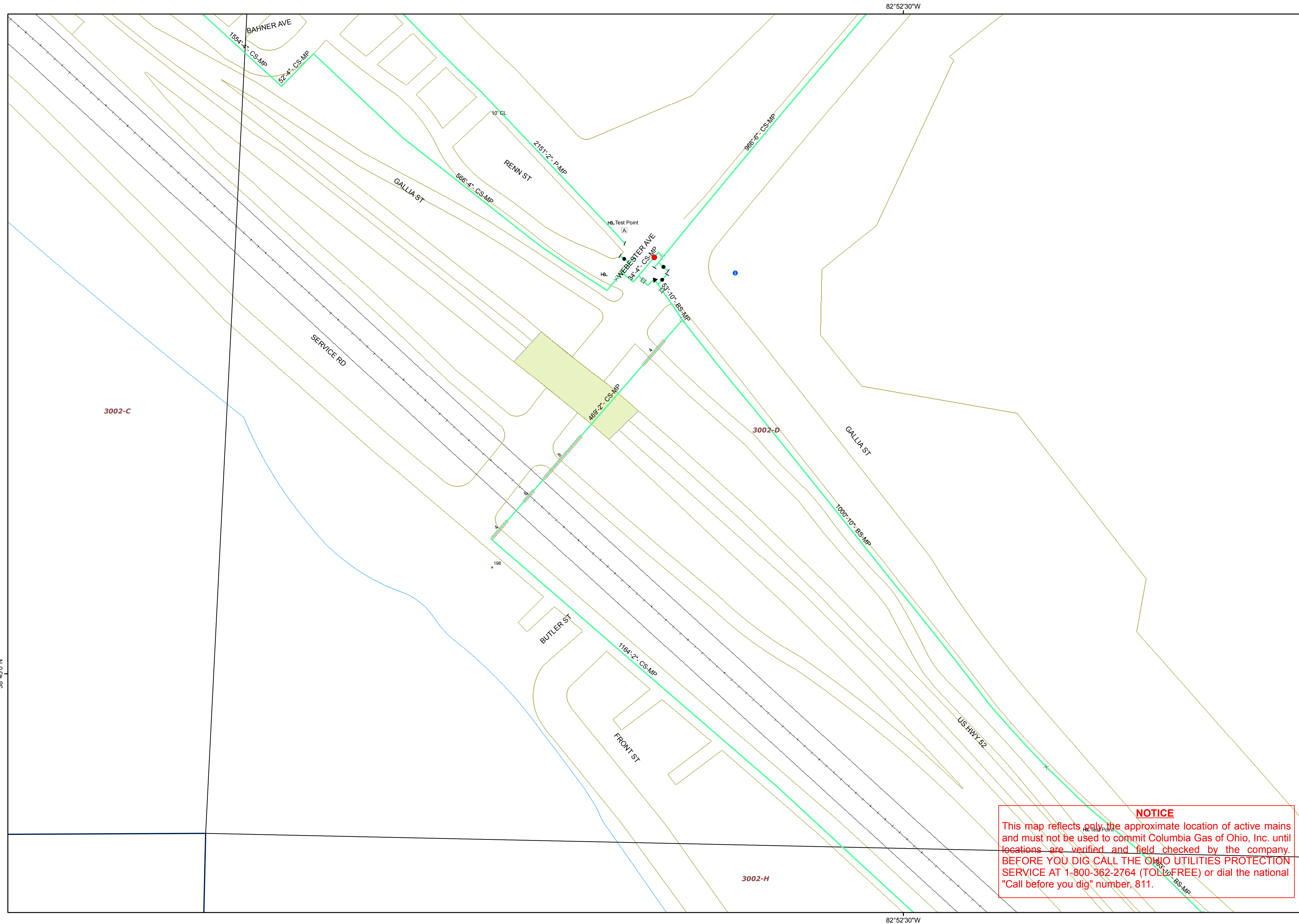
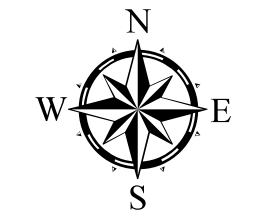

Legend:

Gas Valve

- ⊗ <all other values>
- ⊗ Non-Critical Valve
- Critical Valve

Gas Mains: Distribution & Foreign

- Distribution
- Foreign

Gas Mains: DOT Transmission & Other

- Transmission
- DOT Transmission
- DOT Gathering
- Pseudo-Transmission

Gas Service

- <all other values>
- Steel
- Cast Iron
- Wrought Iron
- Plastic
- Other
- Fittings
- Historic Map

NOTICE
This map reflects only the approximate location of active mains and must not be used to commit Columbia Gas of Ohio, Inc. until locations are verified and field checked by the company. BEFORE YOU DIG CALL THE OHIO UTILITIES PROTECTION SERVICE AT 1-800-362-2764 (TOLL-FREE) or dial the national "Call before you dig" number, 811.

Prepared by:	
Date:	
Coordinates: GCS (Lat/Long) in DMS. Datum: WGS84	

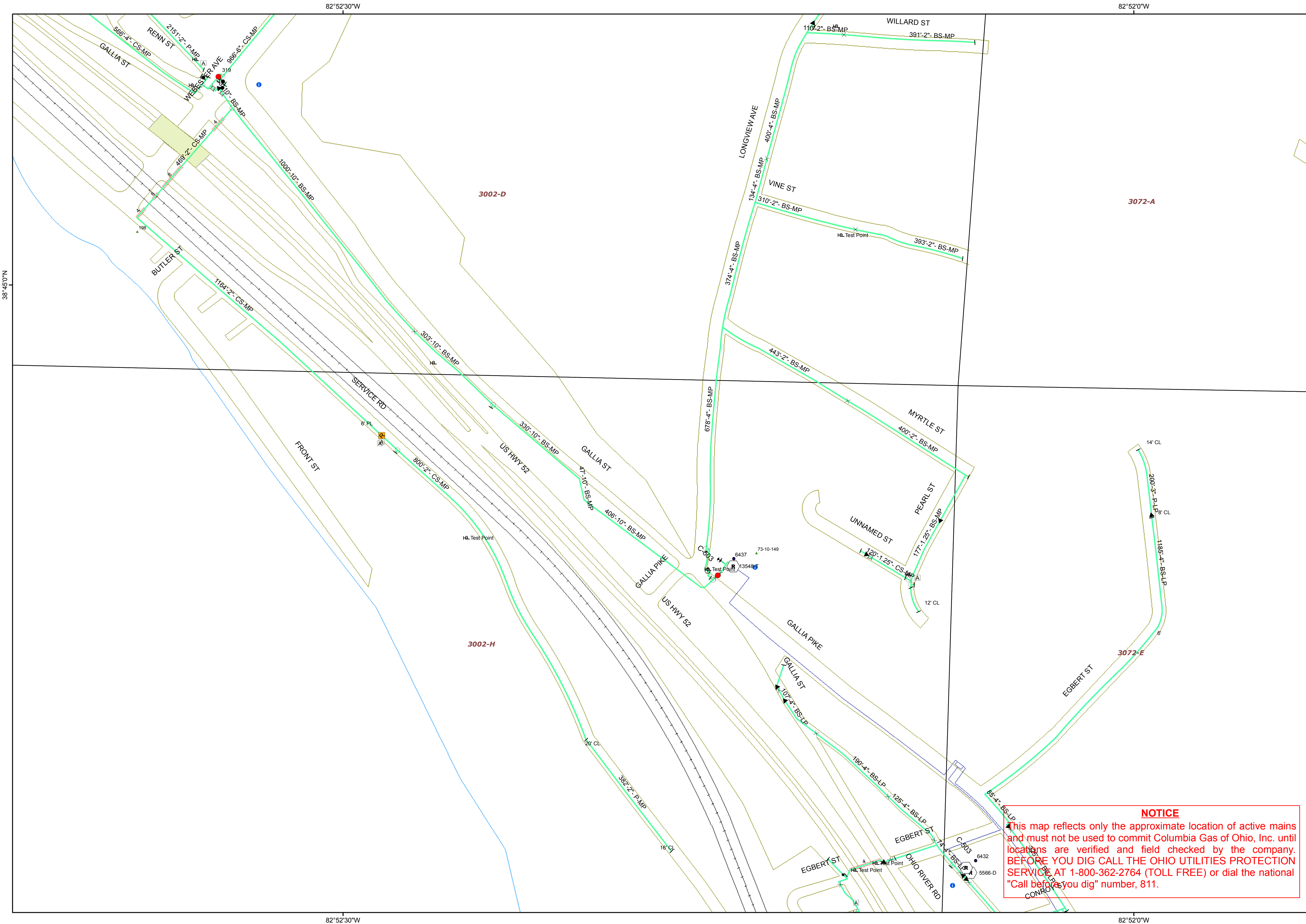
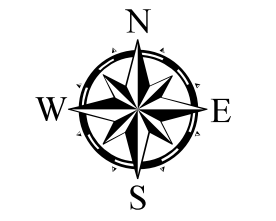

Legend:

Gas Valve

- ⊗ <all other values>
- ⊗ Non-Critical Valve
- Critical Valve

Gas Mains:

Distribution & Foreign

- Distribution
- Foreign

Gas Mains:

DOT Transmission & Other

- Transmission
- DOT Transmission
- DOT Gathering
- Pseudo-Transmission

Gas Service

- <all other values>
- Steel
- Cast Iron
- Wrought Iron
- Plastic
- Other
- Fittings
- Historic Map

NOTICE
 This map reflects only the approximate location of active mains and must not be used to commit Columbia Gas of Ohio, Inc. until locations are verified and field checked by the company. BEFORE YOU DIG CALL THE OHIO UTILITIES PROTECTION SERVICE AT 1-800-362-2764 (TOLL FREE) or dial the national "Call before you dig" number, 811.

Prepared by:	
Date:	
Coordinates: GCS (Lat/Long) in DMS. Datum: WGS84	

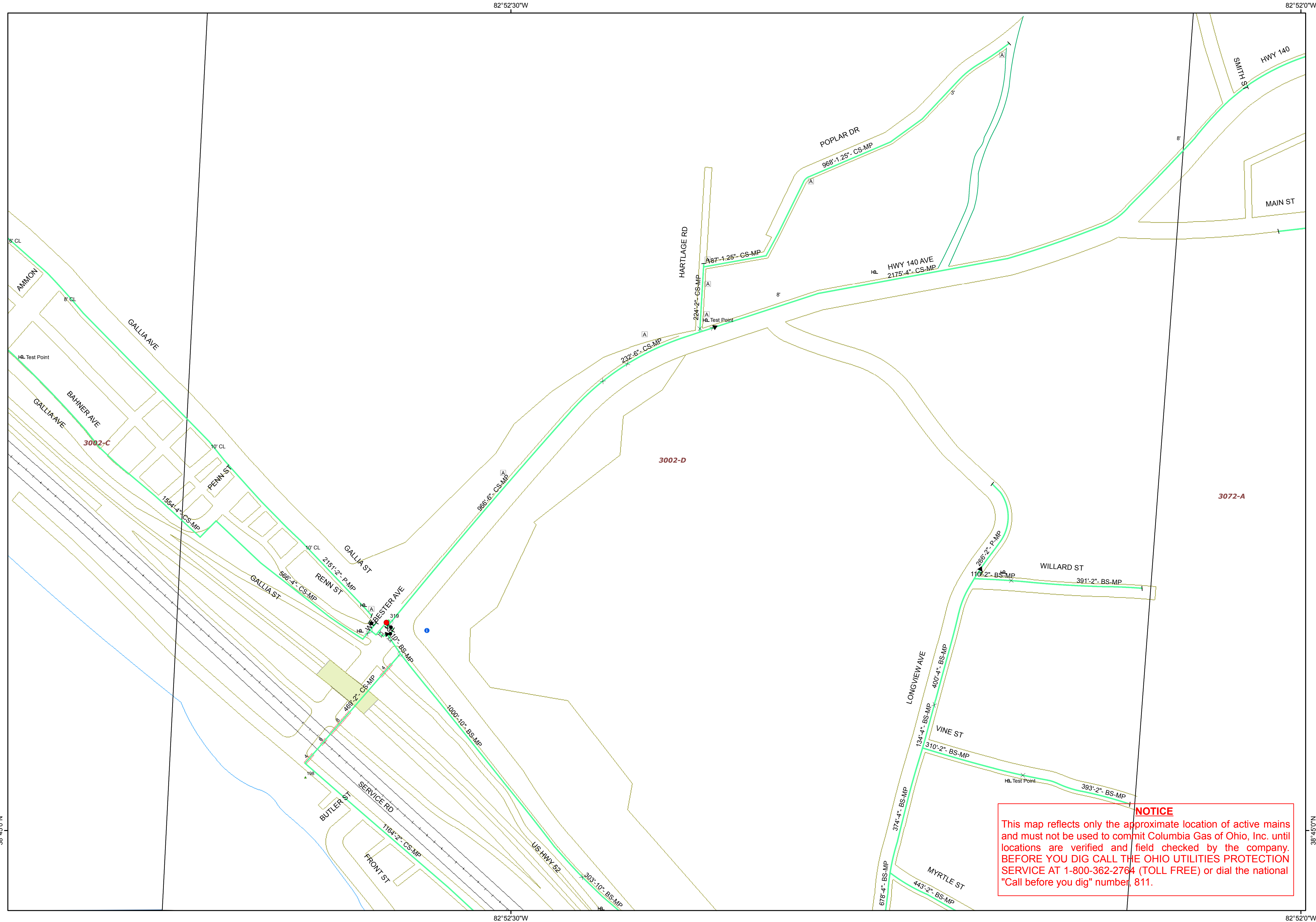
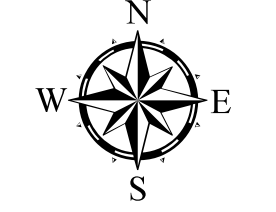

Legend:

Gas Valve

- ⊗ <all other values>
- ⊗ Non-Critical Valve
- Critical Valve

Gas Mains:

Distribution & Foreign

- Distribution
- Foreign

Gas Mains:

DOT Transmission & Other

- Transmission
- DOT Transmission
- DOT Gathering
- Pseudo-Transmission

Gas Service

- <all other values>
- Steel
- Cast Iron
- Wrought Iron
- Plastic
- Other
- Fittings
- Historic Map

NOTICE
This map reflects only the approximate location of active mains and must not be used to commit Columbia Gas of Ohio, Inc. until locations are verified and field checked by the company. BEFORE YOU DIG CALL THE OHIO UTILITIES PROTECTION SERVICE AT 1-800-362-2764 (TOLL FREE) or dial the national "Call before you dig" number, 811.

Prepared by:	
Date:	
Coordinates: GCS (Lat/Long) in DMS. Datum: WGS84	

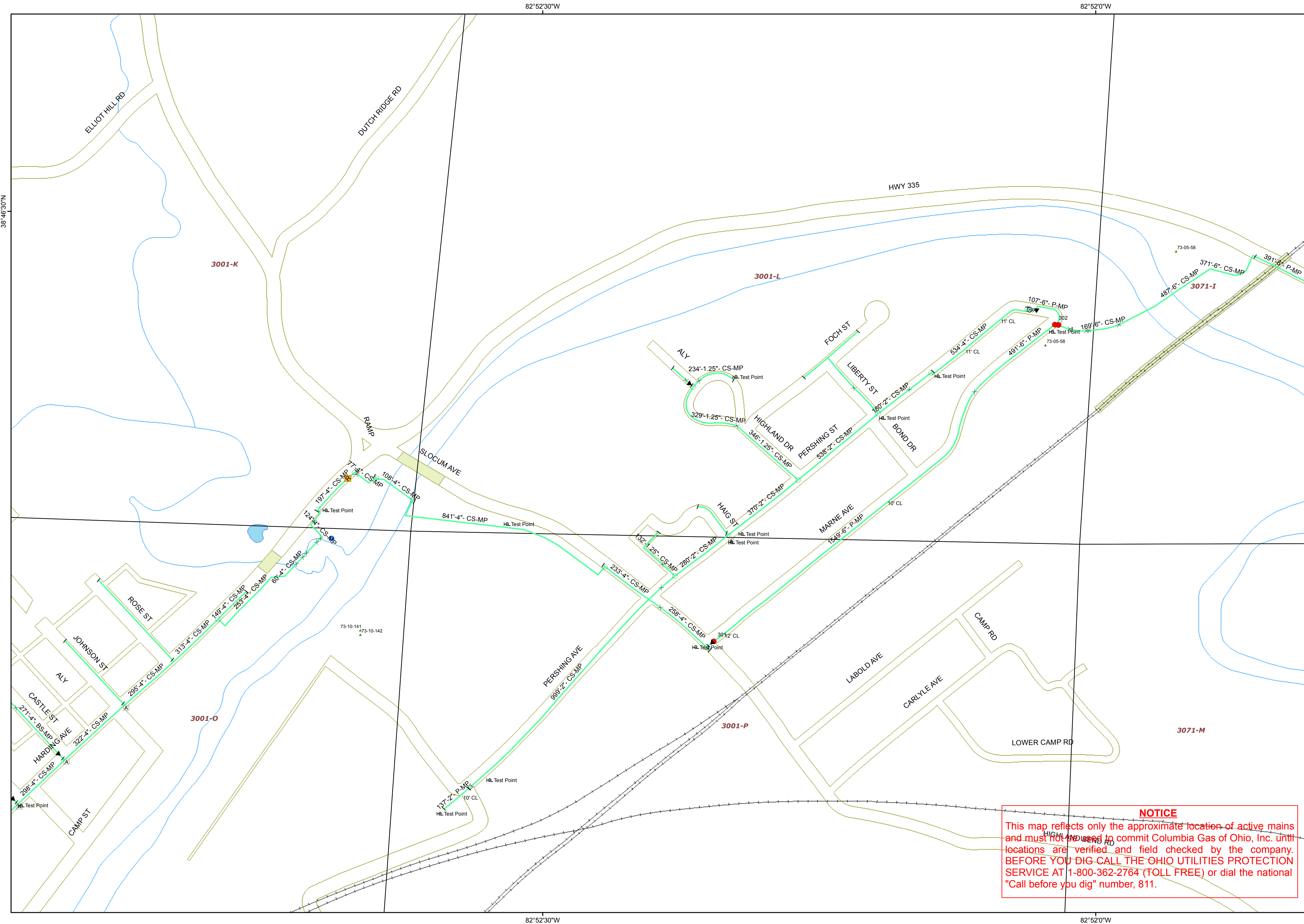
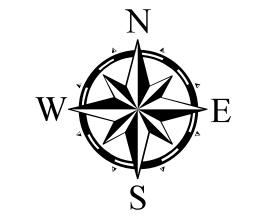

Legend:

Gas Valve

- ⊗ <all other values>
- ⊗ Non-Critical Valve
- Critical Valve

Gas Mains:

Distribution & Foreign

- Distribution
- Foreign

Gas Mains:

DOT Transmission & Other

- Transmission
- DOT Transmission
- DOT Gathering
- Pseudo-Transmission

Gas Service

- <all other values>
- Steel
- Cast Iron
- Wrought Iron
- Plastic
- Other
- Fittings
- Historic Map

NOTICE
This map reflects only the approximate location of active mains and must not be used to commit Columbia Gas of Ohio, Inc. until locations are verified and field checked by the company. BEFORE YOU DIG CALL THE OHIO UTILITIES PROTECTION SERVICE AT 1-800-362-2764 (TOLL FREE) or dial the national "Call before you dig" number, 811.

Prepared by:	
Date:	
Coordinates: GCS (Lat/Long) in DMS. Datum: WGS84	

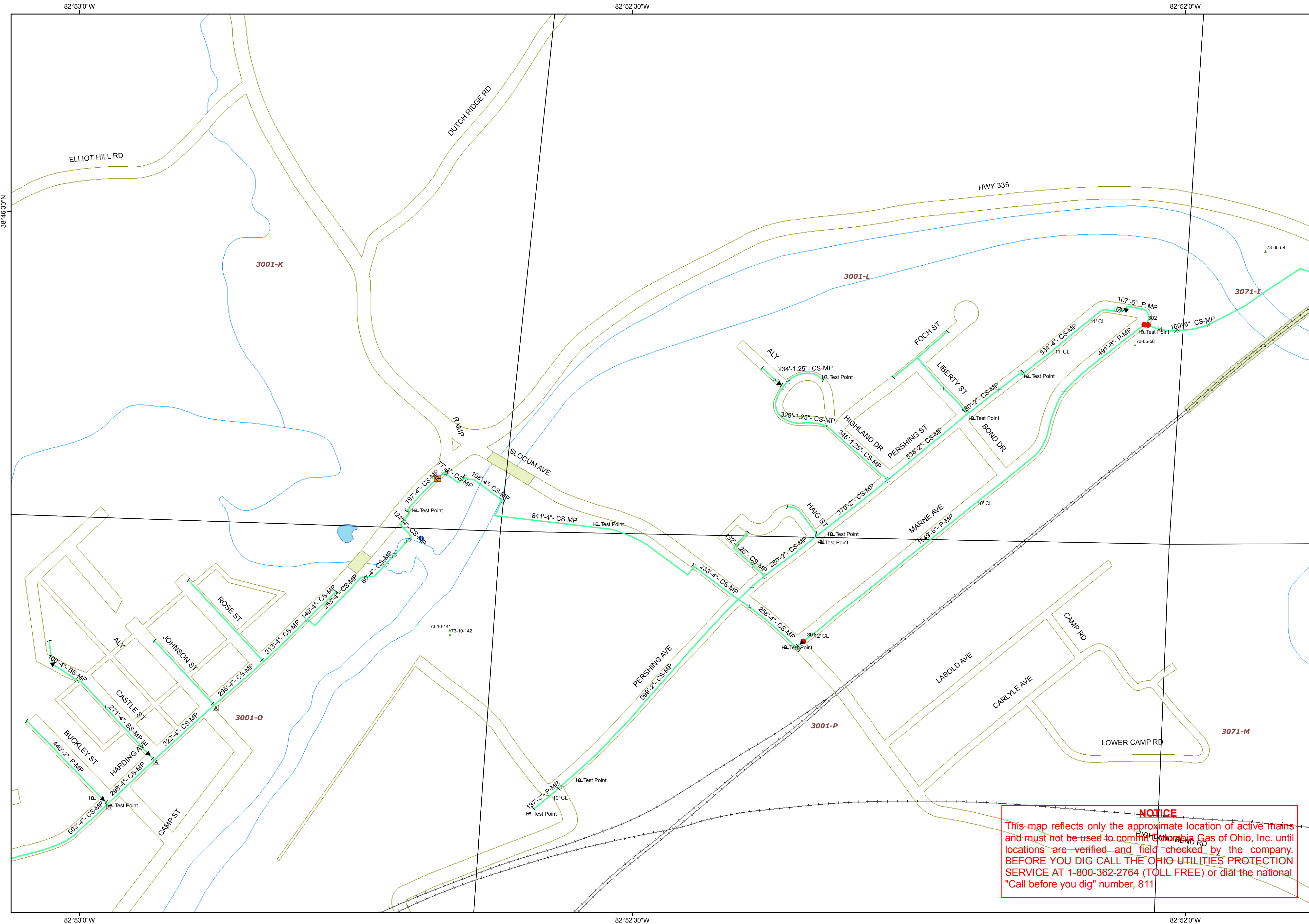
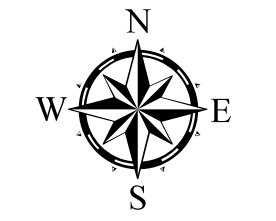

Legend:

Gas Valve

- ⊗ <all other values>
- ⊗ Non-Critical Valve
- Critical Valve

Gas Mains:

Distribution & Foreign

- Distribution
- Foreign

Gas Mains:

DOT Transmission & Other

- Transmission
- DOT Transmission
- DOT Gathering
- Pseudo-Transmission

Gas Service

- <all other values>
- Steel
- Cast Iron
- Wrought Iron
- Plastic
- Other
- Fittings
- Historic Map

NOTICE
This map reflects only the approximate location of active mains and must not be used to commit Columbia Gas of Ohio, Inc. until locations are verified and field checked by the company. BEFORE YOU DIG CALL THE OHIO UTILITIES PROTECTION SERVICE AT 1-800-362-2764 (TOLL FREE) or dial the national "Call before you dig" number, 811

Prepared by:	
Date:	
Coordinates:	GCS (Lat/Long) in DMS. Datum: WGS84

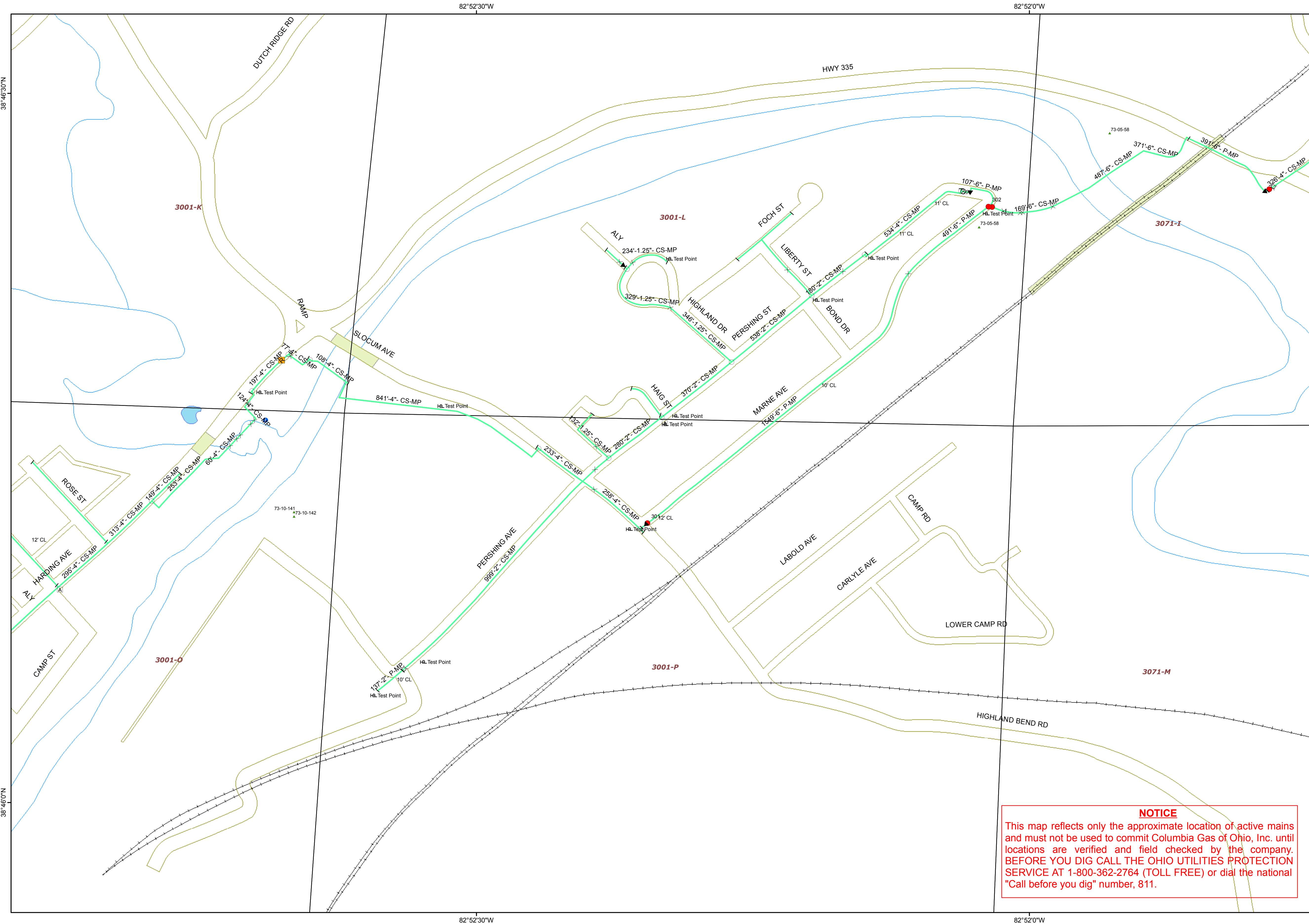
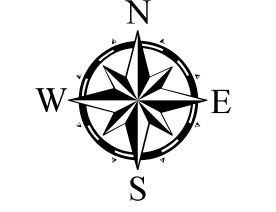

Legend:

Gas Valve

- <all other values>
- Non-Critical Valve
- Critical Valve

Gas Mains:

Distribution & Foreign

- Distribution
- Foreign

Gas Mains:

DOT Transmission & Other

- Transmission
- DOT Transmission
- DOT Gathering
- Pseudo-Transmission

Gas Service

- <all other values>
- Steel
- Cast Iron
- Wrought Iron
- Plastic
- Other
- Fittings
- Historic Map

NOTICE
This map reflects only the approximate location of active mains and must not be used to commit Columbia Gas of Ohio, Inc. until locations are verified and field checked by the company. BEFORE YOU DIG CALL THE OHIO UTILITIES PROTECTION SERVICE AT 1-800-362-2764 (TOLL FREE) or dial the national "Call before you dig" number, 811.

Prepared by:	
Date:	
Coordinates: GCS (Lat/Long) in DMS. Datum: WGS84	

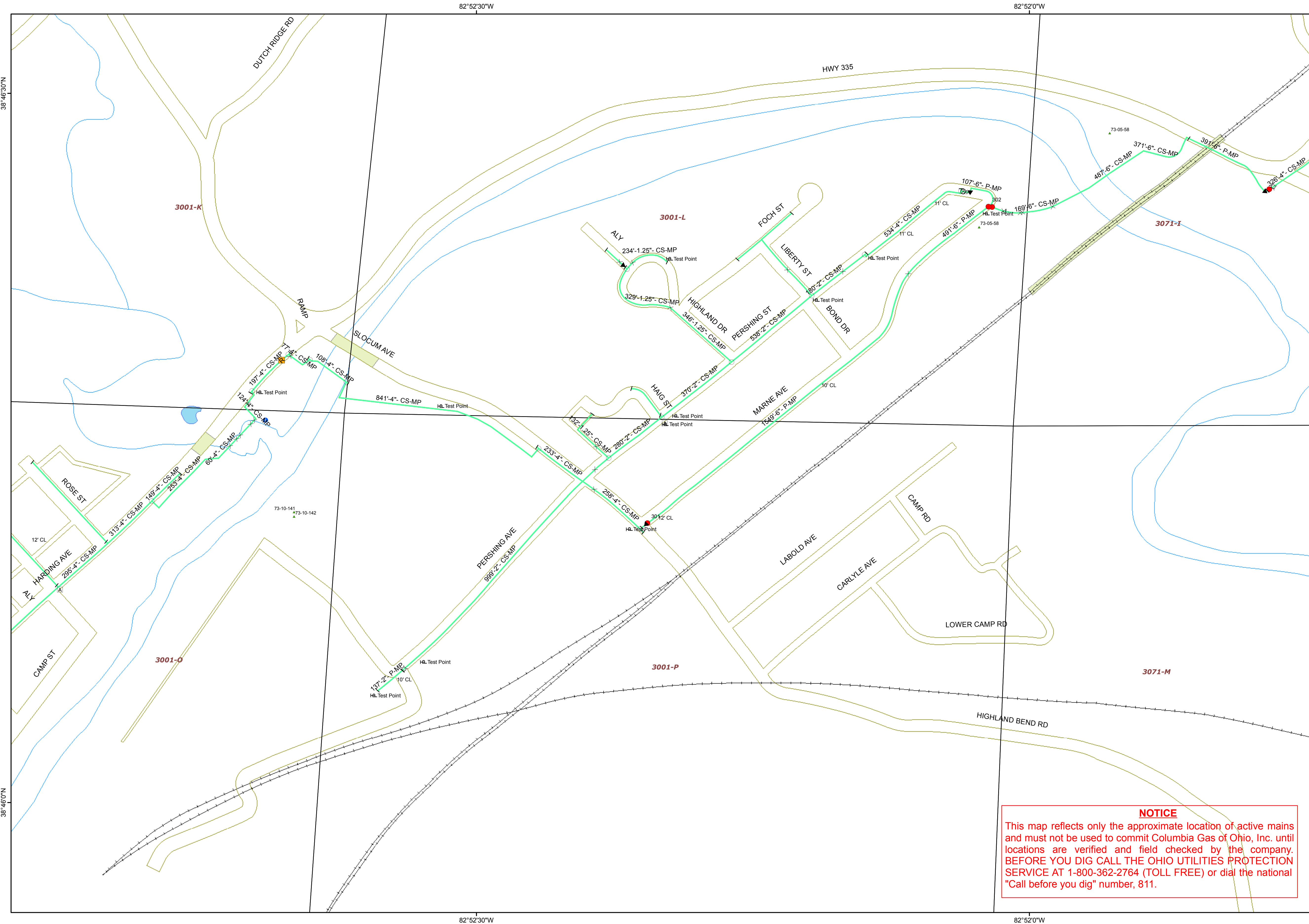
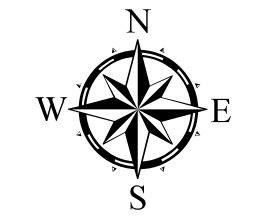

Legend:

Gas Valve

- <all other values>
- Non-Critical Valve
- Critical Valve

Gas Mains:

Distribution & Foreign

- Distribution
- Foreign

Gas Mains:

DOT Transmission & Other

- Transmission
- DOT Transmission
- DOT Gathering
- Pseudo-Transmission

Gas Service

- <all other values>
- Steel
- Cast Iron
- Wrought Iron
- Plastic
- Other
- Fittings
- Historic Map

NOTICE
This map reflects only the approximate location of active mains and must not be used to commit Columbia Gas of Ohio, Inc. until locations are verified and field checked by the company. BEFORE YOU DIG CALL THE OHIO UTILITIES PROTECTION SERVICE AT 1-800-362-2764 (TOLL FREE) or dial the national "Call before you dig" number, 811.

Prepared by:	
Date:	
Coordinates: GCS (Lat/Long) in DMS. Datum: WGS84	