

LEGEND

- FIELD BEND
- COUNTY LINE
- TOWNSHIP LINE
- CORPORATION LINE
- PROPERTY LINE
- OTHER FACILITIES
- TEST LEADS
- INSULATING JOINT
- RIGHT OF WAY NO.
- MAIN LINE VALVE
- RESTRICTED R/W
- PROPERTY CORNER

#5-10" CATHODIC PROTECTION

STAKE NO.	TYPE	ANODE
67817	VIII	
67953	VIII	3
68497	VIII	
68760	VIII	3
72347	VIII	
72513	VIII	3

NOTE: PORTIONS OF #1-8", #2-8", #3-8", #4-8", #6-8", #7-10" & #8-10" REMOVED 1982
SEE #11-12" ATLAS FOR PIPE REMAINING.

NOTE:
710+86 TO 711+42 - 56' x 6" x 10" CONC. PAD. INST.
713+73 TO 714+17 - 44' x 6" x 10" CONC. PAD. INST.

RICHLAND TOWNSHIP

#5-10" STA. 67759 TO STA. 720+60 = 4301' TOTAL FEET

INVENTORY DWG. CORRECT ONLY TO DATE OF LAST REVISION 8/6/2003

SECTIONS 31 & 32 RICHLAND TOWNSHIP, T2S-R6E ALLEN COUNTY, OHIO - SCALE 1"=200'

BUCKEYE PIPE LINE CO.
PIPE LINE ATLAS

LIMA TO CYGNET
#5-10"

PAGE 23

TERRAIN

LAND OWNER AND R/W NO. I-75

PROPERTY LINES AND RODDAGE 92.2 RODS 80.5 RODS 28.8 RODS 99.2 RODS

DATE OF AERIAL 1967

PIPE LINE CONSTRUCTION DATE: TO

REVISION NO. AND DESCRIPTION

- ▲ ADDED TILES 3-2-79 C.B.L.
- ▲ 9-24-79 C.B.L.
- ▲ 8-3-82 G.K.L.
- ▲ ADDED FOREIGN CROSSING AT STA. 698+18 9-28-82 E.G.B.
- ▲ REMOVED PIPE 3-7-83 P.L.S.
- ▲ 12-12-94 D.O.D. W.D.
- ▲ 5-1-95 D.O.D. W.D.

(CLARENCE LEE) L. ZIMMERMAN (57 R)

(CLARENCE LEE) L. ZIMMERMAN (57-A R)

(J.A. STOWER) L. ZIMMERMAN (57 B)

SEE PA. 24

617+47 MATCH LINE

617+59 MATCH LINE

682+80

706+08

710+85

720+60 MATCH LINE

685+78 686+77

692+24 692+80 693+79

698+18 698+27

699+79

706+08

708+30 708+44

710+44 710+63

719+61

TERRAIN											
LAND OWNER AND R/W NO.	R. KINDLE 56	D.E. KAHLER 56-23 NAPOLEON RD.	ROGAMAR CO 56-C	I-75	(CLARENCE LEE)	L. ZIMMERMAN (CLARENCE LEE) 57	L. ZIMMERMAN (CLARENCE LEE) 57A	R.L. ZIMMERMAN (J.A. STONER) 57B	SEE PAGE 16		
PROPERTY LINES AND RODDAGE	28.6 RODS	101 RODS 684+38	20.4 RODS 687+74	66.7 RODS	688+74	86.8 RODS	713+07	28.8 RODS	49.9 RODS	717+63	726+00 MATCH LINE

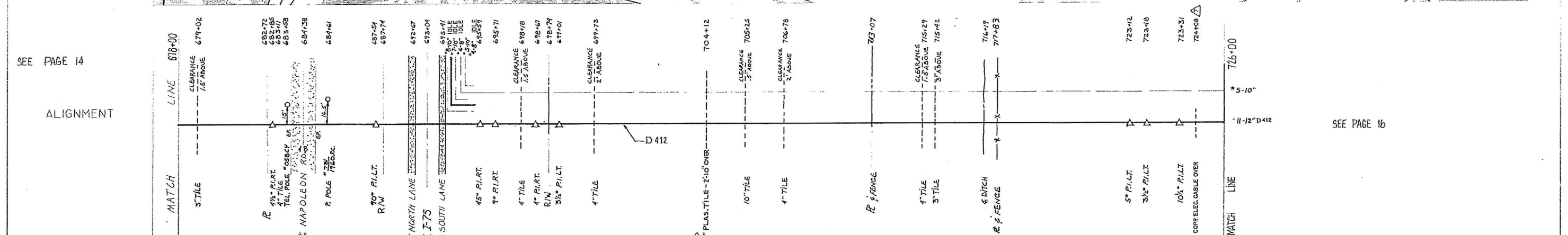
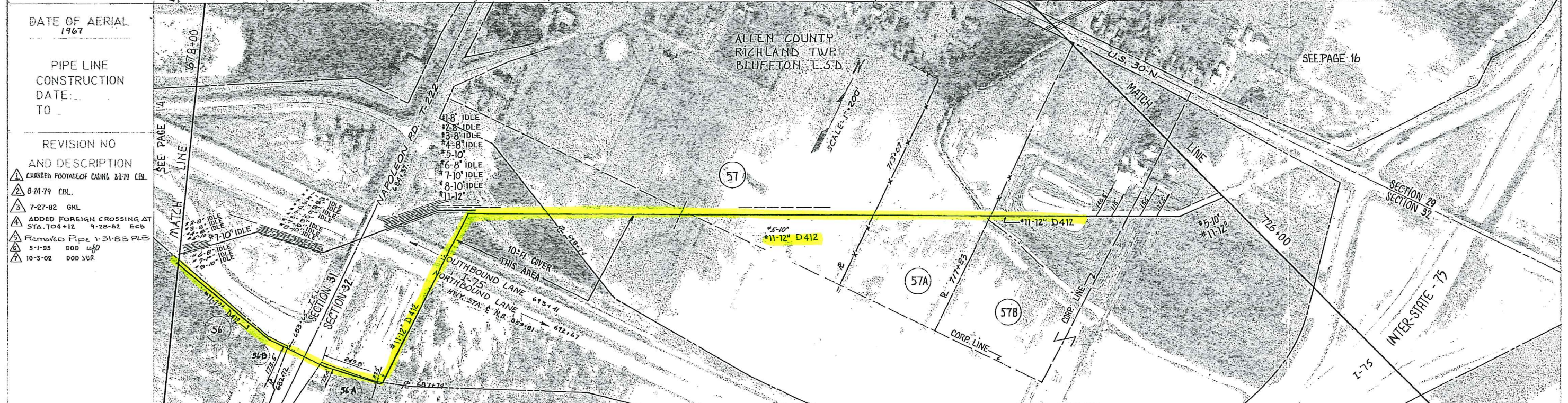

MATERIAL 10" LINE	7-10" IDLE	137'	260.08' 14" CASING	4' COVER	8' COVER	5' COVER	10' COVER	4' COVER	3' COVER	4' COVER	726+00
MATERIAL 12" LINE	#11-12"	2 FI.	5 FI.	974' 12" X 250' X 52	11 FI.	202' 12" X 150' X 52	6 FI.	2975 FI. 12" X 250' X 52			#11-12" D412

LEGEND

- FIELD BEND
- COUNTY LINE
- TOWNSHIP LINE
- CORPORATION LINE
- PROPERTY LINE
- OTHER FACILITIES
- TEST LEADS
- INSULATING JOINT
- RIGHT OF WAY NO
- MAIN LINE VALVE
- RESTRICTED R/W
- PROPERTY CORNER

CATHODIC PROTECTION

STAKE NO.	TYPE	ANODE
683+25	II	
685+11	II	
692+04	II	
694+06	VI	

ABANDONED PIPE

LINE	STA. TO STA.	LENGTH
#4-8"	67800 - 69471	1146' (SEE NOTE)
#6-8"	67800 - 69471	1146' (SEE NOTE)
#7-10"	67800 - 69471	1146' (SEE NOTE)
#8-10"	67800 - 69471	1146' (SEE NOTE)

NOTE: STX. NO'S ARE FOR #11-12" LINE

FOREIGN CROSSING

- 716+61 TO 717+17 - 56" X 6" X 10" CONC. PAD
- 719+48 TO 719+92 - 44" X 6" X 10" CONC. PAD

BUCKEYE PIPE LINE CO. PIPE LINE ATLAS

SCALE 1"=200'

SECTIONS 31, & 32 RICHLAND TOWNSHIP, T2S-R8E, ALLEN COUNTY, OHIO

RICHLAND TOWNSHIP

#11-12" STATION 678+00 TO 726+00 = 4800' TOTAL FEET

LIMA TO CYGNET NORTH #11-12"

THE ONLY TEST LEADS SHOWN ON THIS ATLAS ARE THOSE INSTALLED DURING ORIGINAL PIPELINE CONSTRUCTION. FOR UP-TO-DATE CATHODIC PROTECTION INFORMATION, CONTACT THE AREA OPERATOR.

INVENTORY ONLY SUBJECT TO FIELD VERIFICATION 8/7/2003