

I:\ProjectData\ATH\4589-ATH-329-5.26\Design\Roadway\Sheets\4589_MN002.dgn_Sheet 3/4/2022 8:41:55 AM amorelan

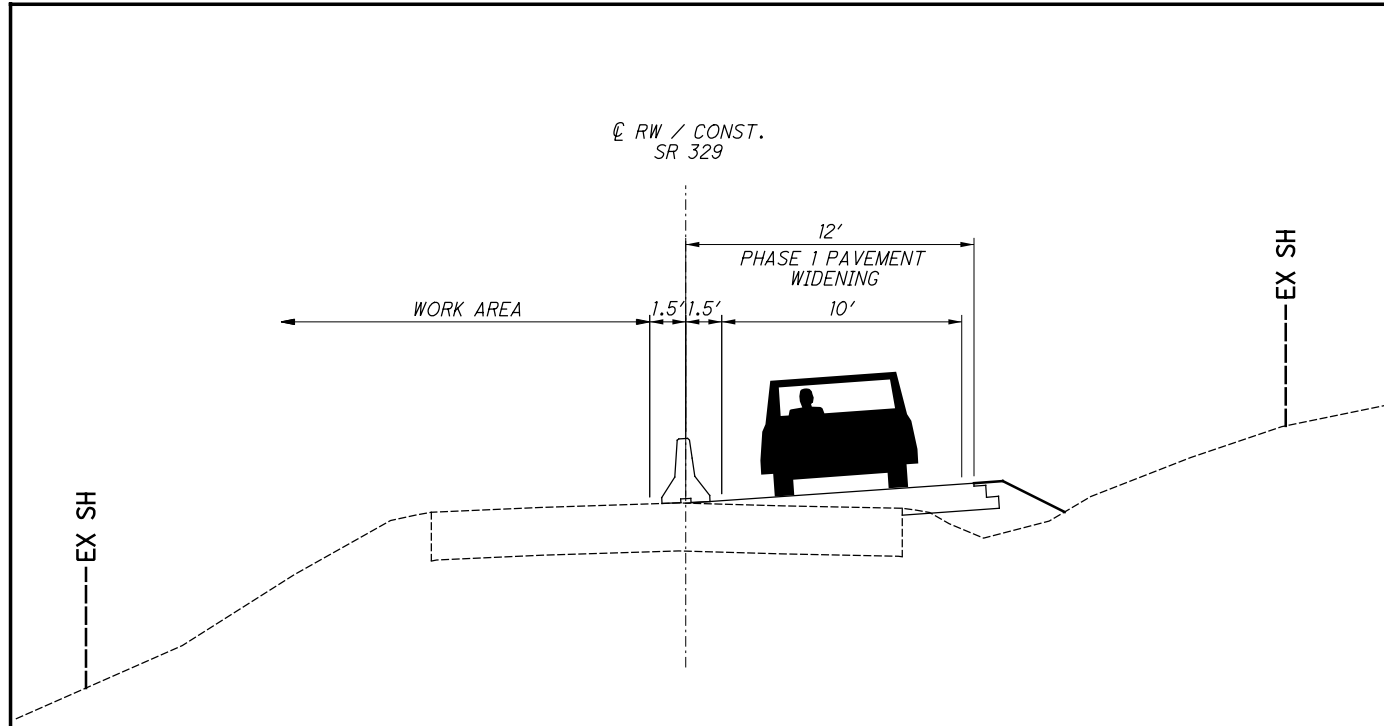

TYPICAL PHASE 2 MOT

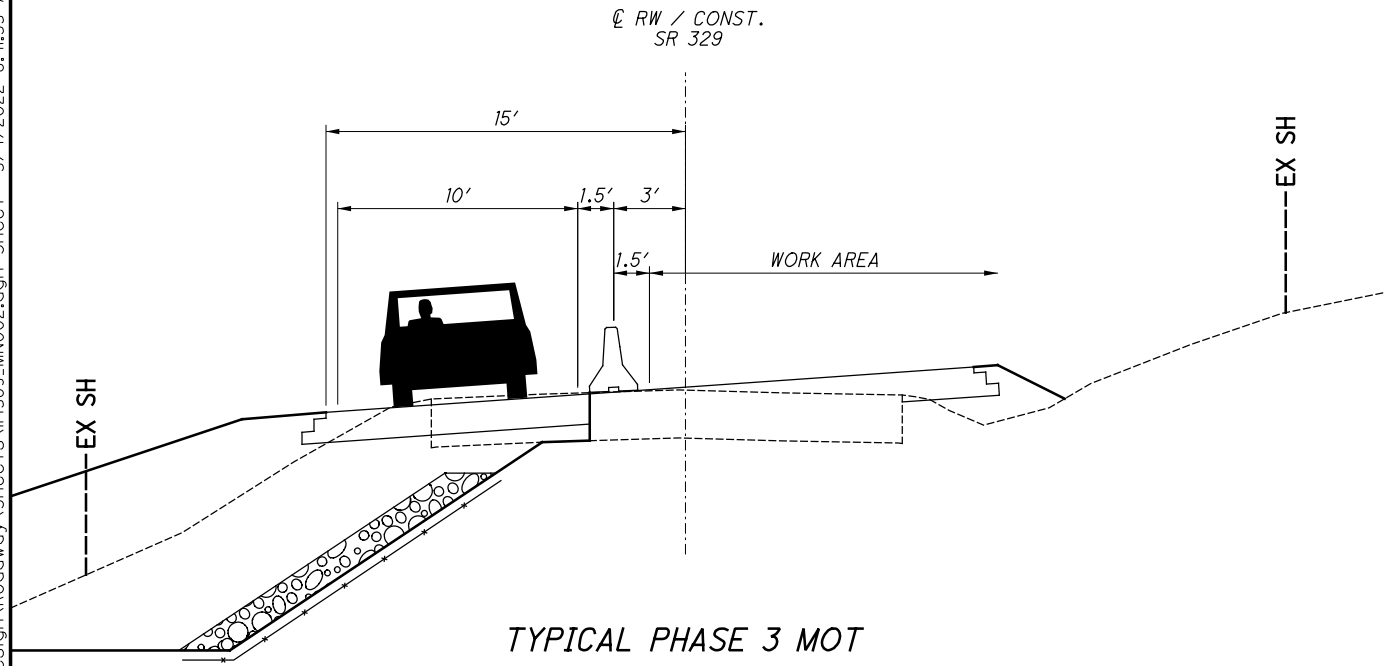

TYPICAL PHASE 3 MOT

SUPERELEVATION TABLE												
P.I. STATION - N/A						DC = N/A						
LEFT SIDE					CENTERLINE CONTROL		RIGHT SIDE					REMARKS
EDGE ELEVATION	TRANSITION RATE	ELEVATION CORRECTION	CROSS SLOPE #	TRANSITION WIDTH #	STATION	PROFILE GRADE	WIDTH	CROSS SLOPE	ELEVATION CORRECTION	TRANSITION RATE	EDGE ELEVATION	
624.29	-	-0.24	-0.016	15	276 + 50.00	624.53	12	-0.016	-0.19	-	624.33	MATCH EX.
625.17	-	-0.24	-0.016	15	277 + 00.00	625.41	12	0	0	-	625.41	
624.7	-	-0.24	-0.016	15	277 + 25.00	624.94	12	0.016	0.19	-	625.13	
624.11	-	-0.30	-0.02	15	277 + 50.00	624.41	12	0.02	0.24	-	624.65	
623.01	-	-0.60	-0.04	15	278 + 00.00	623.61	12	0.04	0.48	-	624.09	
622.91	-	-0.90	-0.06	15	278 + 50.00	623.81	12	0.06	0.72	-	624.53	
622.85	-	-1.20	-0.08	15	279 + 00.00	624.05	12	0.08	0.96	-	625.25	
622.35	-	-1.20	-0.08	15	279 + 50.00	623.55	12	0.08	0.96	-	624.75	
620.49	-	-1.20	-0.08	15	280 + 00.00	621.69	12	0.08	0.96	-	622.89	
618.92	-	-1.20	-0.08	15	280 + 50.00	620.12	12	0.08	0.96	-	621.32	
618.23	-	-1.20	-0.08	15	281 + 00.00	619.43	12	0.08	0.96	-	620.63	
617.97	-	-1.20	-0.08	15	281 + 50.00	619.17	12	0.08	0.96	-	620.37	
617.22	-	-1.20	-0.08	15	282 + 00.00	618.42	12	0.08	0.96	-	619.62	
616.92	-	-1.20	-0.08	15	282 + 25.00	618.12	12	0.08	0.96	-	619.32	
616.92	-	-1.05	-0.07	15	282 + 50.00	617.97	12	0.07	0.84	-	618.81	
617.49	-	-0.75	-0.05	15	283 + 00.00	618.24	12	0.05	0.60	-	618.84	
618.36	-	-0.45	-0.03	15	283 + 50.00	618.81	12	0.03	0.36	-	619.17	
618.33	-	-0.23	-0.016	14.5	284 + 00.00	618.57	12	0.016	0.156	-	618.72	
618.22	-	-0.22	-0.016	14.25	284 + 25.00	618.00	12	0	0	-	618.00	
617.73	-	-0.22	-0.016	14	284 + 50.00	617.51	12	-0.016	-0.19	-	617.31	MATCH EX.

CALCULATED
ARM
CHECKED
XXX

MAINTENANCE OF TRAFFIC GENERAL NOTES

ATH-329-5.26

