

STATE OF OHIO
DEPARTMENT OF TRANSPORTATION

AUG ODNR ST MARYS FH CHIP

ST. MARYS TOWNSHIP
AUGLAIZE COUNTY

PROJECT DESCRIPTION

THIS PROJECT INCLUDES IMPROVING THE ST MARYS FISH HATCHERY IN AUGLAIZE COUNTY. WORK WILL INCLUDE A CHIP SEAL TO THE EXISTING MAIN DRIVE AND OTHER DETAILED AREAS.

EARTH DISTURBED AREAS

PROJECT EARTH DISTURBED AREA: _____ ACRES
ESTIMATED CONTRACTOR EARTH DISTURBED AREA: _____ ACRES
NOTICE OF INTENT EARTH DISTURBED AREA: _____ ACRES
* MAINTENANCE PROJECT

2019 SPECIFICATIONS

THE STANDARD SPECIFICATIONS OF THE STATE OF OHIO, DEPARTMENT OF TRANSPORTATION, INCLUDING SUPPLEMENTAL SPECIFICATIONS LISTED IN THE PLANS AND CHANGES LISTED IN THE PROPOSAL SHALL GOVERN THIS IMPROVEMENT.

I HEREBY APPROVE THESE PLANS AND DECLARE THAT THE MAKING OF THIS IMPROVEMENT WILL NOT REQUIRE THE CLOSING TO TRAFFIC OF THE HIGHWAY AND THAT TRAFFIC WILL BE AS SET FORTH ON THE PLANS AND ESTIMATES.

APPROVED: Randall L. Chivalley PE, PS.
DATE: 01/28/2021 DISTRICT DEPUTY DIRECTOR

APPROVED: _____
DATE: _____ DIRECTOR, DEPARTMENT OF TRANSPORTATION

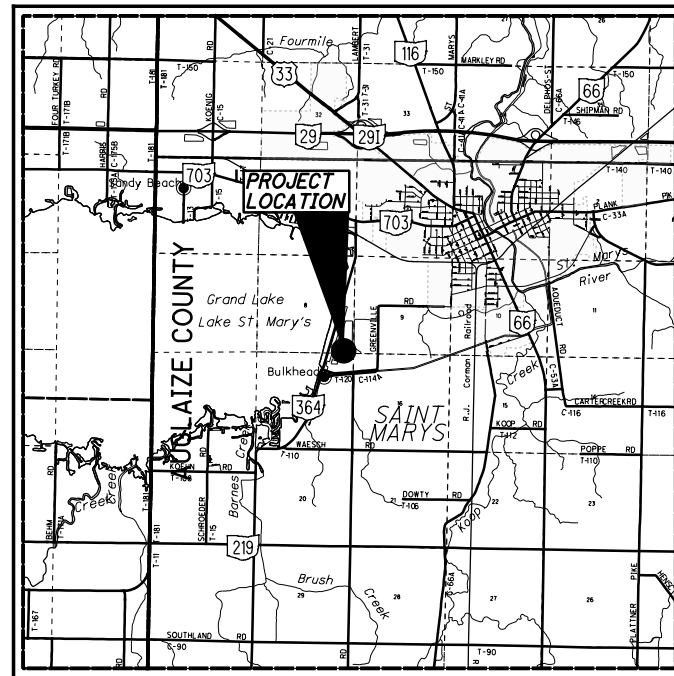

LOCATION MAP

LATITUDE: 40°31'32" LONGITUDE: 84°25'06"



PORTION TO BE IMPROVED	-----
INTERSTATE HIGHWAY	=====
FEDERAL ROUTES	====
STATE ROUTES	====
COUNTY & TOWNSHIP ROADS	====
OTHER ROADS	-----

INDEX OF SHEETS:

TITLE SHEET	1
SCHEMATIC PLAN	2
TYPICAL SECTIONS	3
GENERAL NOTES	4
GENERAL SUMMARY	5

UNDERGROUND UTILITIES
Contact Two Working Days
Before You Dig

OHIO811, 8-1-1, or 1-800-362-2764
(Non-members must be called directly)

PLAN PREPARED BY:
OHIO DEPT. OF TRANSPORTATION
DISTRICT 7 ENGINEERING
SIDNEY, OH

ENGINEERS SEAL:

SIGNED: Chris Weiss
DATE: 1/27/2021

		STANDARD CONSTRUCTION DRAWINGS				SUPPLEMENTAL SPECIFICATIONS	SPECIAL PROVISIONS
BP-3.1	01/17/20					800-2020 1/15/21	
DM-4.3	1/15/16					832 10/19/18	
DM-4.4	1/15/16						
MT-97.11	1/20/17						
MT-101.60	1/17/20						
MT-105.10	1/17/20						
TC-41.20	10/18/13						
TC-42.20	10/18/13						
TC-52.10	10/18/13						
TC-52.20	7/20/18						

FEDERAL PROJECT NO. **NON-FEDERAL**

CONSTRUCTION PROJECT NO. **109369**

RAILROAD INVOLVEMENT **NONE**

AUG-ODNR ST MARYS FH CHIP

1
5

I:\ProjectData\AUG\109369_ODNR_HATCHERY\Design\Roadway\Sheets\109369_GT001.dgn Sheet 1/26/2021 2:14:31PM bcao

I:\ProjectData\AUG\109369_ODNR_HATCHERY\Design\Roadway\Sheets\109369_6B001.dgn Sheet 1/26/2021 2:41:36 PM bcao

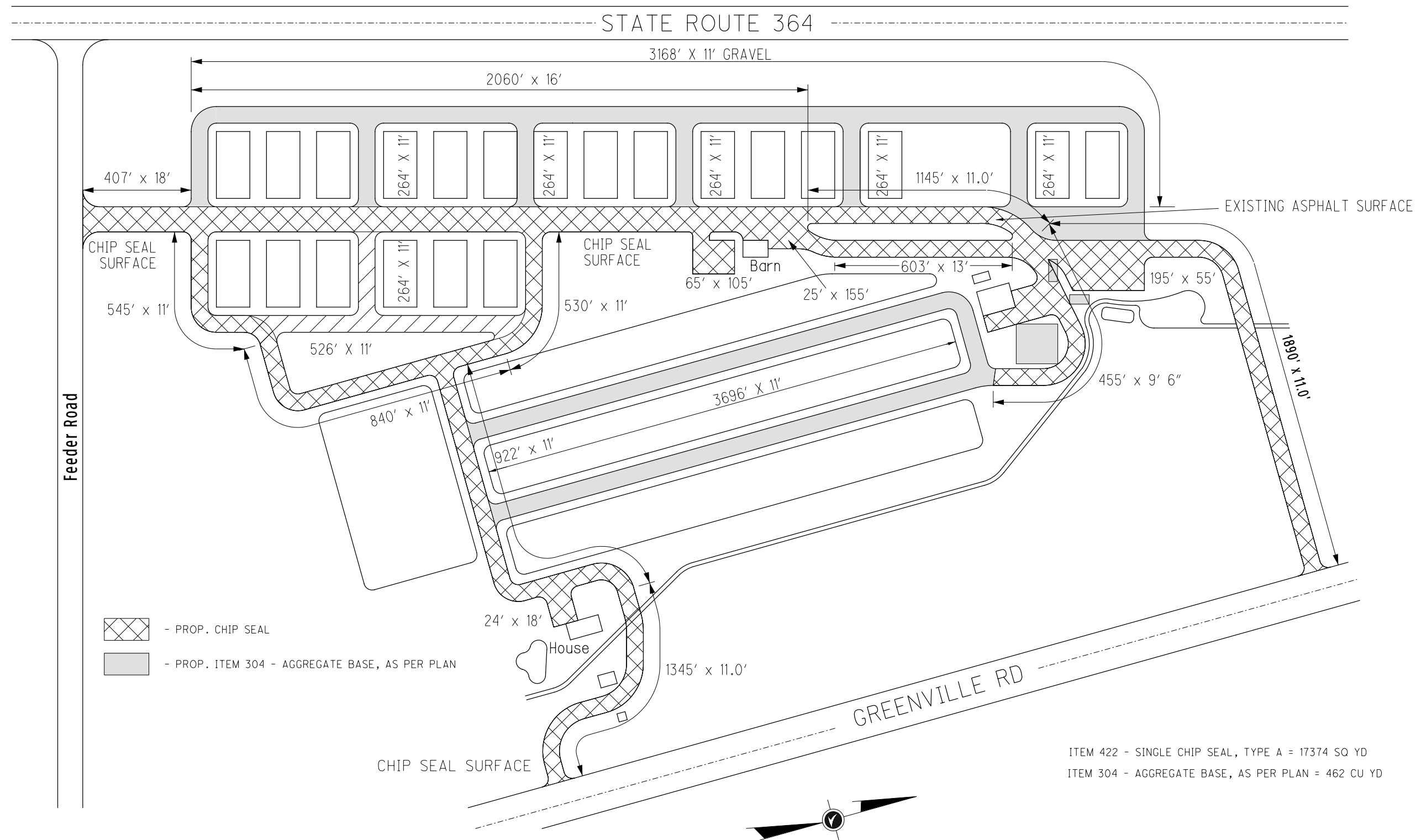

-  - PROP. CHIP SEAL
-  - PROP. ITEM 304 - AGGREGATE BASE, AS PER PLAN

ITEM 422 - SINGLE CHIP SEAL, TYPE A = 17374 SQ YD
 ITEM 304 - AGGREGATE BASE, AS PER PLAN = 462 CU YD



CALCULATED
BTC
CHECKED
CWW

SCHEMATIC PLAN

**AUG-ODNR ST
MARYS FH CHIP**

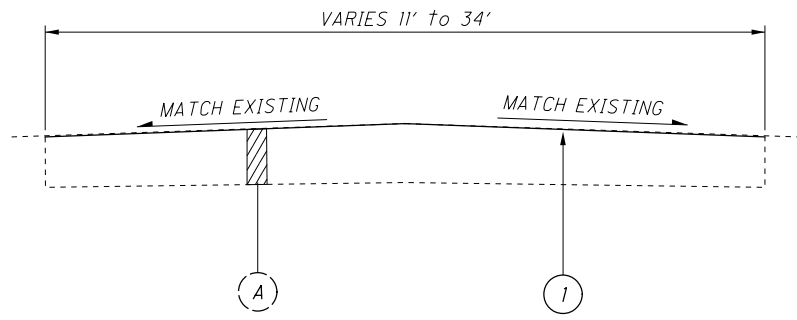

TYPICAL 1
MAIN DRIVE AND DETAILED AREAS

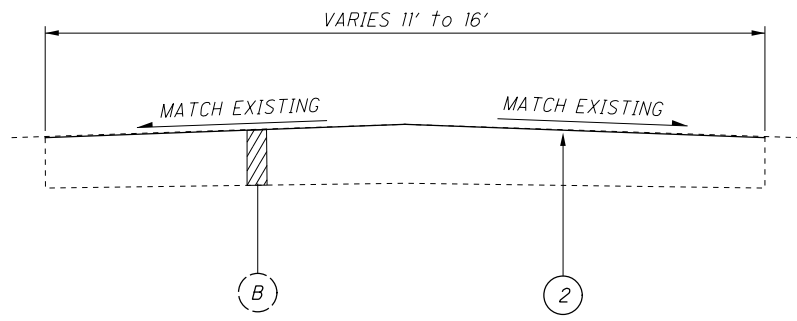

TYPICAL 2
GRAVEL DRIVES & LOTS

LEGEND

- (A) EXISTING ASPHALT DRIVE
- (B) EXISTING GRAVEL DRIVE
- (1) ITEM 422 - SINGLE CHIP SEAL, TYPE A
- (2) ITEM 304 - AGGREGATE BASE, AS PER PLAN

ALIGNMENT AND PROFILE

THE WORK PROPOSED BY THIS PROJECT CONSISTS OF A CHIP SEAL OF THE EXISTING PAVEMENT AND DRIVE/LOTS. THE ALIGNMENT OF THE EXISTING PAVEMENT WILL NOT BE CHANGED AND THE PROFILE OF THE PROPOSED SURFACE WILL BE SIMILAR TO THAT OF THE EXISTING PAVEMENT.

UTILITIES

THERE ARE NO UNDERGROUND UTILITIES SHOWN ON THIS PLAN. THE NATURE OF THE WORK REQUIRED BY THIS PROJECT WILL NOT AFFECT ANY KNOWN UNDERGROUND UTILITIES THAT EXIST UNDER OR ADJACENT TO THE WORK AREA.

PROTECTION OF MANHOLES

THERE ARE APPROXIMATELY 3 MANHOLE CASTINGS ON THE MAIN DRIVE OFF FEEDER RD. THE CONTRACTOR SHALL ENSURE THAT MANHOLES ARE PROTECTED DURING CHIP SEAL WORK TO AVOID ANY POTENTIAL DAMAGE.

ITEM 253 - PAVEMENT REPAIR, AS PER PLAN

PAVEMENT REPAIR SHALL BE IN ACCORDANCE WITH ITEM 253 - PAVEMENT REPAIR, WITH THE FOLLOWING ADDITIONS:

THE AREAS OF ITEM 253, PAVEMENT REPAIR, AS PER PLAN ARE LOCATED THROUGHOUT THE PROJECT LIMITS. THE ENGINEER SHALL DESIGNATE THE LOCATIONS AND LIMITS OF THE AREAS TO BE REPAIRED. THE AREAS SHALL BE ROUGHLY RECTANGULAR IN SHAPE AND SAWED OR MILLED TO A NEAT LINE. THE DEPTH OF REMOVAL, AS DIRECTED BY THE ENGINEER, SHALL BE SUFFICIENT TO REMOVE ALL DETERIORATED PAVEMENT. THE ENTIRE AREA INCLUDING VERTICAL FACES SHALL BE COATED PRIOR TO PLACING THE REPLACEMENT MATERIAL PER 253.03. THE REPLACEMENT MATERIAL SHALL BE ITEM 441 - ASPHALT CONCRETE INTERMEDIATE COURSE, TYPE 2, (448) AND DEPTH OF REPAIR SHALL BE MEASURED FROM THE PAVEMENT SURFACE.

THE ESTIMATED PAVEMENT REPAIR AREAS SHALL BE A MINIMUM OF 4 FEET IN WIDTH AND 2 INCHES IN DEPTH OR AS DIRECTED BY THE ENGINEER.

THE FOLLOWING ESTIMATED QUANTITIES HAVE BEEN CARRIED TO THE GENERAL SUMMARY TO BE USED AS DIRECTED BY THE ENGINEER.

ITEM 253 - PAVEMENT REPAIR, AS PER PLAN = 250 SQ YD

ITEM 304 AGGREGATE BASE, AS PER PLAN

AGGREGATE BASE SHALL BE PLACED AS DIRECTED BY THE ENGINEER. THE ESTIMATED AGGREGATE BASE SHALL BE PLACED AT A THICKNESS OF 1.5" OVER THE EXISTING GRAVEL AREAS. THE FOLLOWING ESTIMATED QUANTITY HAS BEEN CARRIED TO THE GENERAL SUMMARY.

ITEM 304 - AGGREGATE BASE, AS PER PLAN = 462 CU YD

**ITEM 422 - SINGLE CHIP SEAL, TYPE A, AS PER PLAN
ITEM 422 - EMULSION, CHIP SEAL, AS PER PLAN**

THE REQUIREMENTS OF 422 APPLY EXCEPT AS FOLLOWS:

THE SECOND SENTENCE OF 422.01 IS DELETED. THE REQUIREMENTS OF 422.12 ARE DELETED IN THEIR ENTIRETY.

CENTERLINE DELINEATION IS REQUIRED TO BE IN PLACE IN ANY SECTION OF UNFLAGGED WORK ZONE.

TRUCK LOADING/HAULING

LOADS SHALL BE HELD TO A MAXIMUM LOAD OF SIXTEEN (16) TONS.

ITEM 614 - MAINTAINING TRAFFIC

NO WORK SHALL BE PERFORMED ON A NATIONAL OR STATE HOLIDAY (MEMORIAL DAY, FOURTH OF JULY)

PARK AND DRIVE CLOSURES SHALL ONLY BE PERMITTED UPON THE APPROVAL OF THE ENGINEER AND FIVE RIVERS METROPARK DISTRICT.

JAY WILLIAMS, HATCHERY SUPERVISOR OHIO DEPARTMENT OF NATURAL RESOURCES O: 419-394-5170 M: 419-305-8742

THE CONTRACTOR SHALL FURNISH AND PLACE ALL SIGNS, LIGHTS AND BARRIERS TO CLOSE AREAS, WHEN PERMITTED, DURING OPERATIONS. THE CONTRACTOR SHALL FURNISH AND PLACE SIGNS AND FLAGGERS TO CONTROL TRAFFIC IN AREAS OPEN TO TRAFFIC, AS DIRECTED BY THE ENGINEER.

NOTIFICATION OF TRAFFIC RESTRICTIONS

THROUGHOUT THE DURATION OF THE PROJECT, THE CONTRACTOR SHALL NOTIFY THE PROJECT ENGINEER IN WRITING OF ALL TRAFFIC RESTRICTIONS AND UPCOMING MAINTENANCE OF TRAFFIC CHANGES. THE CONTRACTOR SHALL ENSURE THE WRITING OF ALL TRAFFIC RESTRICTIONS AND UPCOMING MAINTENANCE OF TRAFFIC CHANGES. THE CONTRACTOR SHALL ENSURE THE WRITTEN NOTIFICATION IS SUBMITTED IN A TIMELY MANNER TO ALLOW THE PROJECT ENGINEER TO MEET THE REQUIRED TIME FRAMES SET FORTH IN THE TABLE BELOW TO INFORM THE SPECIAL HAULING PERMITS SECTION (HAULING.PERMITS@DOT.OHIO.GOV) AND THE DISTRICT PUBLIC INFORMATION OFFICE (PIO). THIS NOTIFICATION SHALL BE RECEIVED BY THE PROJECT ENGINEER PRIOR TO THE PHYSICAL SETUP OF ANY APPLICABLE SIGNS OR MESSAGE BOARDS.

INFORMATION SHOULD INCLUDE, BUT IS NOT LIMITED TO, ALL CONSTRUCTION ACTIVITIES THAT IMPACT OR INTERFERE WITH TRAFFIC AND SHALL LIST THE SPECIFIC LOCATION, TYPE OF WORK, ROAD STATUS, DATE AND TIME OF RESTRICTION, DURATION OF RESTRICTION, NUMBER OF LANES MAINTAINED, NUMBER OF LANES CLOSED, MINIMUM VERTICAL CLEARANCE, MINIMUM WIDTH OF DRIVABLE PAVEMENT, DETOUR ROUTES, IF APPLICABLE, AND ANY OTHER INFORMATION REQUESTED BY THE PROJECT ENGINEER.

NOTIFICATION TIME TABLE		
ITEM	DURATION OF CLOSURE	NOTICE DUE TO D7 PERMITS & PIO
RAMP & ROAD CLOSURES	>= 2 WKS	21 CALENDAR DAYS PRIOR TO CLOSURE
	> 12 HRS & < 2 WKS	14 CALENDAR DAYS PRIOR TO CLOSURE
	< 12 HRS	4 BUSINESS DAYS PRIOR TO CLOSURE
LANE CLOSURES AND RESTRICTIONS	>= 2 WKS	14 CALENDAR DAYS PRIOR TO CLOSURE
	< 2 WKS	5 BUSINESS DAYS PRIOR TO CLOSURE
START OF CONSTRUCTION & TRAFFIC PATTERN CHANGES	N/A	14 CALENDAR DAYS PRIOR TO IMPLEMENTATION

ANY UNFORESEEN CONDITIONS NOT SPECIFIED IN THE PLANS REQUIRING TRAFFIC RESTRICTIONS SHALL ALSO BE REPORTED TO THE PROJECT ENGINEER USING THE NOTIFICATION TIME TABLE.

I:\ProjectData\AUG\09369\0DNR\HATCHERY\Design\Roadway\Sheets\09369_GN001.dgn Sheet 1/26/2021 12:41:38 PM bcao

CALCULATED
BTC
CHECKED
CWW

GENERAL NOTES

AUG-ODNR ST
MARYS FH CHIP

4
5

