

I:\ProjectData\BUT\SR4-15.80\Design\M0T\Sheets\02T36_MB002.dgn Sheet 1/12/2021 11:56:30 PM choward4

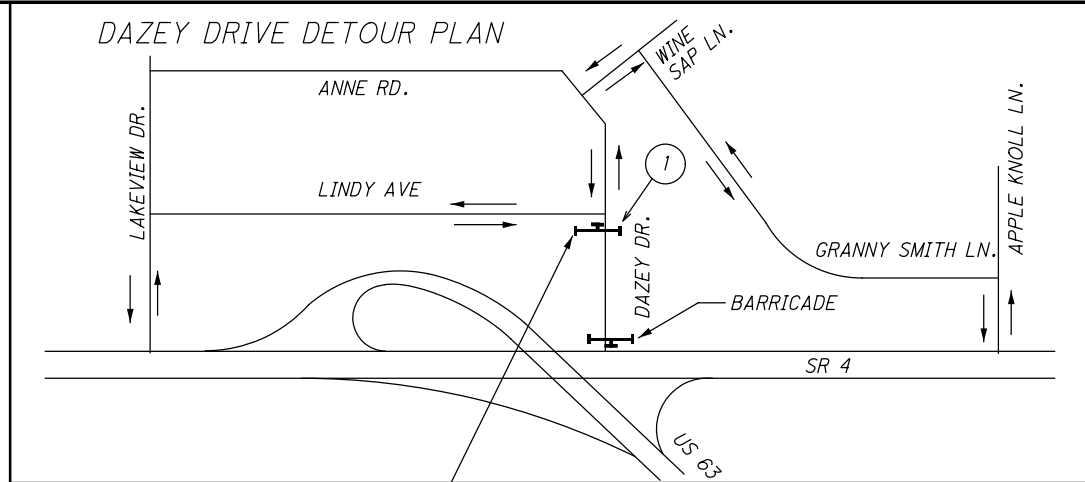

ROAD CLOSED
LOCAL TRAFFIC ONLY

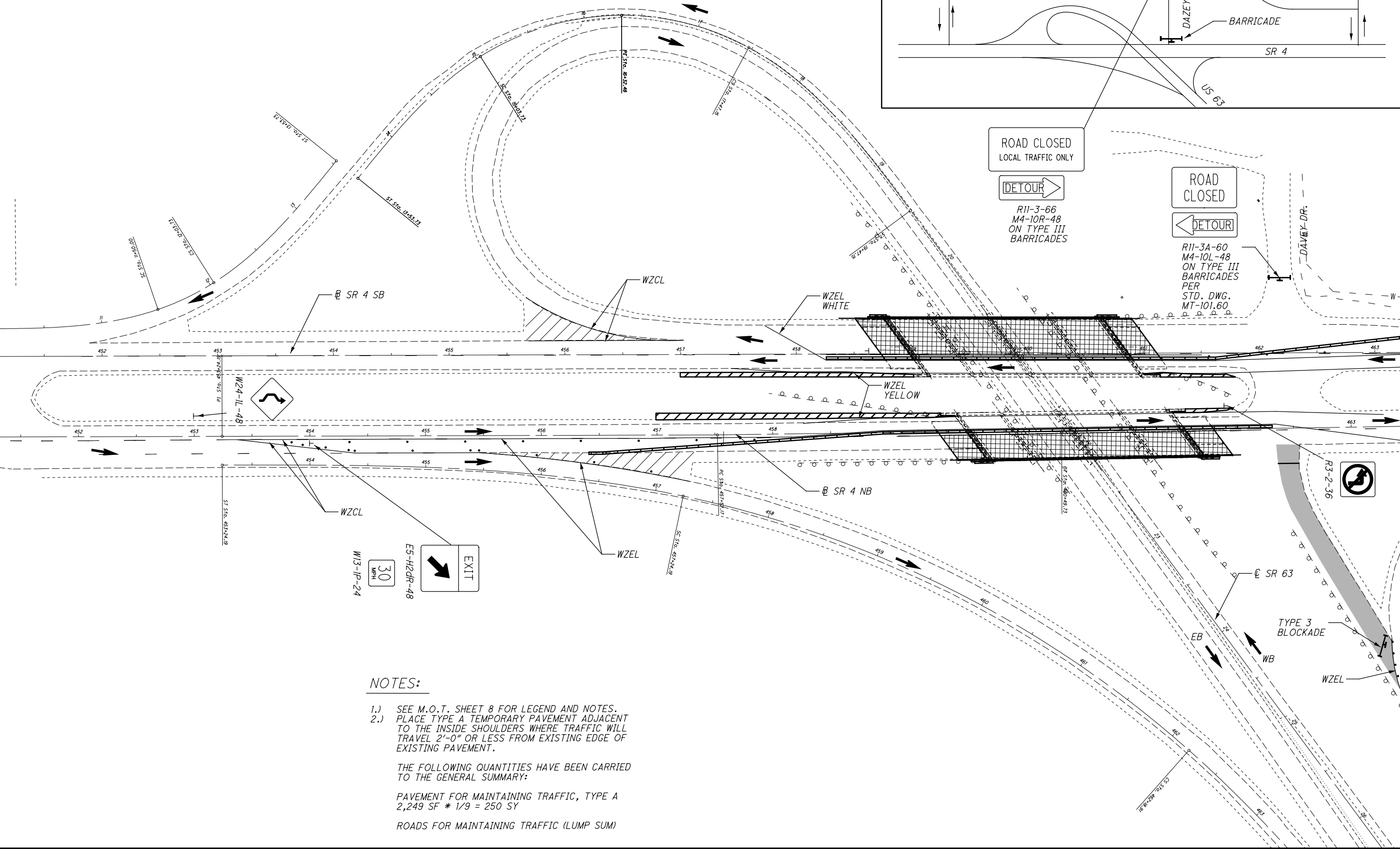

R11-3-66
M4-10R-48
ON TYPE III
BARRICADES

ROAD CLOSED



R11-3A-60
M4-10L-48
ON TYPE III
BARRICADES
PER
STD. DWG.
MT-101.60

NOTES:

- 1.) SEE M.O.T. SHEET 8 FOR LEGEND AND NOTES.
- 2.) PLACE TYPE A TEMPORARY PAVEMENT ADJACENT TO THE INSIDE SHOULDERS WHERE TRAFFIC WILL TRAVEL 2'-0" OR LESS FROM EXISTING EDGE OF EXISTING PAVEMENT.

THE FOLLOWING QUANTITIES HAVE BEEN CARRIED TO THE GENERAL SUMMARY:

PAVEMENT FOR MAINTAINING TRAFFIC, TYPE A
2,249 SF * 1/9 = 250 SY

ROADS FOR MAINTAINING TRAFFIC (LUMP SUM)

CALCULATED
CAH
CHECKED
XXX

HORIZONTAL
SCALE IN FEET

**MAINTENANCE OF TRAFFIC SCHEMATIC
PHASE 1 - STA. 452+50 TO STA. 463+00**

BUT-SR4-15.80

I:\Project+Data\BUT\102736_BUT-SR4-15.80_Design\Structures\BUT004_580R_Sheets\004_580R_S000.dgn_Sheet 1/12/2021 1:50:21 PM choward4

ESTIMATED QUANTITIES - STRUCTURE No.: BUT-4-1580R					(100% 01/NHS/BR FUNDING)			
ITEM	EXTENSION	TOTAL	UNIT	DESCRIPTION	ABUTMENT	PIERS	SUPERSTRUCTURE	GENERAL
202	11203	LS	LUMP	PORTIONS OF STRUCTURE REMOVED, OVER 20 FOOT SPAN, AS PER PLAN	LUMP		LUMP	
202	98000	LS	LUMP	REMOVAL MISC.: BULB ANGLE DRAINAGE SYSTEM REMOVED			LUMP	
503	11100	LS	LUMP	COFFERDAMS AND EXCAVATION BRACING, AS PER PLAN	LUMP			
503	21100	167	CY	UNCLASSIFIED EXCAVATION	167			
509	10000	20964	LB	EPOXY COATED REINFORCING STEEL	10,221		10,743	
509	20001	200	LB	REINFORCING STEEL, REPLACEMENT OF EXISTING REINFORCING STEEL, AS PER PLAN				200
509	30020	4433	FT	No. 4 GFRP DEFORMED BARS			4,433	
510	10001	1248	EACH	DOWEL HOLES WITH NONSHRINK, NONMETALLIC GROUT, AS PER PLAN	246		1,002	
511	33501	2	EACH	SEMI-INTEGRAL DIAPHRAGM GUIDE, AS PER PLAN	2			
511	53014	129	CY	CLASS QC3 CONCRETE, MISC.: SUPERSTRUCTURE CONCRETE WITH QC/QA, AS PER PLAN			129	
511	53014	37	CY	CLASS QC3 CONCRETE, MISC.: SUBSTRUCTURE CONCRETE WITH QC/QA, AS PER PLAN	37			
511	71100	7	CY	CONCRETE, MISC.: DECK REPAIR FOR BULB ANGLE REMOVAL			7	
512	10100	685	SY	SEALING OF CONCRETE SURFACES (EPOXY-URETHANE)	146	271	268	
512	10300	53	SY	SEALING CONCRETE BRIDGE DECKS WITH HMWM RESIN			53	
512	33000	10	SY	TYPE 2 WATERPROOFING	10			
512	74000	542	SY	REMOVAL OF EXISTING COATINGS FROM CONCRETE SURFACES	146	271	125	
514	00050	12185	SF	SURFACE PREPARATION OF EXISTING STRUCTURAL STEEL			12,185	
514	00056	12185	SF	PAINTING EXISTING STRUCTURAL STEEL, PRIME COAT			12,185	
514	00060	12185	SF	PAINTING STRUCTURAL STEEL, INTERMEDIATE COAT			12,185	
514	00066	12185	SF	PAINTING STRUCTURAL STEEL, FINISH COAT			12,185	
514	00504	19	MNHR	GRINDING OF FINIS, TEARS AND SLIVERS ON EXISTING STRUCTURAL STEEL			19	
514	10000	11	EACH	FINAL INSPECTION REPAIR			11	
516	10000	129	FT	PREFORMED ELASTOMERIC COMPRESSION JOINT SEAL			129	
516	13600	17	SF	1" PREFORMED EXPANSION JOINT FILLER			17	
516	13900	88	SF	2" PREFORMED EXPANSION JOINT FILLER			88	
516	14020	145	FT	SEMI-INTEGRAL ABUTMENT EXPANSION JOINT SEAL	145			
516	44101	14	EACH	ELASTOMERIC BEARING WITH INTERNAL LAMINATES AND LOAD PLATE (NEOPRENE), AS PER PLAN, 12"x12"x2.70" w/ 14"x14"x1" LOAD PLATE			14	
516	47001	LS	LUMP	JACKING AND TEMPORARY SUPPORT OF SUPERSTRUCTURE, AS PER PLAN			LUMP	
518	21200	62	CY	POROUS BACKFILL WITH GEOTEXTILE FABRIC	62			
518	40000	152	FT	6" PERFORATED CORRUGATED PLASTIC PIPE	152			
518	40010	120	FT	6" NON-PERFORATED CORRUGATED PLASTIC PIPE, INCLUDING SPECIALS	120			
526	25010	227	SY	REINFORCED CONCRETE APPROACH SLABS WITH QC/QA (T=15")				227
526	90010	130	FT	TYPE A INSTALLATION				130
SPECIAL	530E00200	LS	LUMP	STRUCTURES, MISC.: CONSULTANT FOR CONCRETE QUALITY CONTROL INCLUDING TESTING AND INSPECTION	LUMP		LUMP	
607	39900	370	FT	VANDAL PROTECTION FENCE, 6' STRAIGHT, COATED FABRIC			370	
846	00110	35	CF	POLYMER MODIFIED ASPHALT EXPANSION JOINT SYSTEM				35
848	10201	808	SY	SUPERPLASTICIZED DENSE CONCRETE OVERLAY USING HYDRODEMOLITION, AS PER PLAN (T=2.25")			808	
848	20000	808	SY	SURFACE PREPARATION USING HYDRODEMOLITION			808	
848	30201	22	CY	SUPERPLASTICIZED DENSE CONCRETE OVERLAY (VARIABLE THICKNESS), MATERIAL ONLY, AS PER PLAN			22	
848	50000	202	SY	HAND CHIPPING			202	
848	50100	LS	LUMP	TEST SLAB				
848	50320	808	SY	EXISTING CONCRETE OVERLAY REMOVED			808	

DESIGN AGENCY	OHIO DEPT OF TRANSPORTATION
DATE	DISTRICT 8 BRIDGE OFFICE
REVIEWED	FILE NUMBER
DATE	0900249/0900273
DRAWN	CAH
CHECKED	XXX
DESIGNED	GTF
STRUCTURE QUANTITIES	
BRIDGE NO: BUT-SR4-1580 R	
SR 4 NORTHBOUND OVER SR 63 RAMPS	
BUT - SR4-15.80	
PID No. 102736	
7 / 30	
25	48