

STATE OF OHIO
DEPARTMENT OF TRANSPORTATION

BUT - 4 / 4D - 20.64 / 0.00

CITY OF MIDDLETOWN
BUTLER COUNTY

PROJECT DESCRIPTION

RESURFACING OF 1.4 MILES OF S.R. 4 FROM GIRARD AVENUE TO TYTUS AVENUE. WORK INCLUDES PAVEMENT PLANING, ASPHALT OVERLAY, STRIPING AND CURB RAMP IMPROVEMENTS.

PROJECT EARTH DISTURBED AREA: N/A ACRES
ESTIMATED CONTRACTOR EARTH DISTURBED AREA: N/A ACRES
NOTICE OF INTENT EARTH DISTURBED AREA: N/A ACRES
*MAINTENANCE PROJECT

2013 SPECIFICATIONS

THE STANDARD SPECIFICATIONS OF THE STATE OF OHIO, DEPARTMENT OF TRANSPORTATION, INCLUDING CHANGES AND SUPPLEMENTAL SPECIFICATIONS LISTED IN THE PROPOSAL SHALL GOVERN THIS IMPROVEMENT.

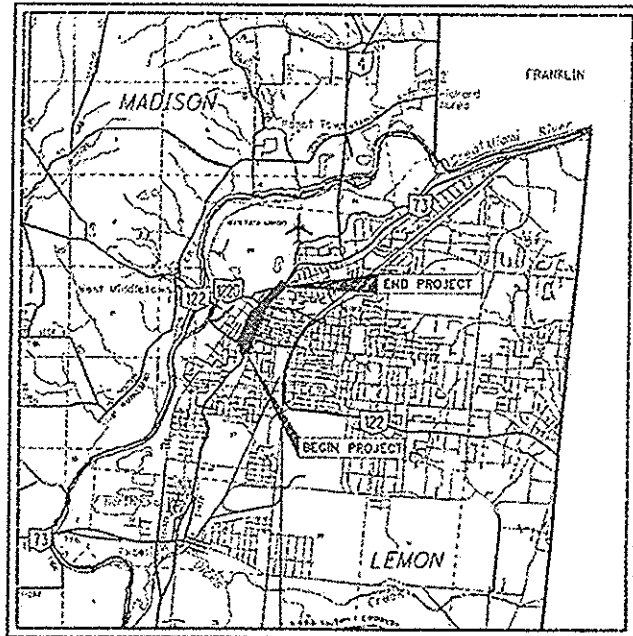

LOCATION MAP

LATITUDE: 39°31'06" LONGITUDE: 84°24'00"



PORTION TO BE IMPROVED	-----
INTERSTATE HIGHWAY	-----
FEDERAL ROUTES	-----
STATE ROUTES	-----
COUNTY & TOWNSHIP ROADS	-----
OTHER ROADS	-----

INDEX OF SHEETS:

TITLE SHEET	1
SCHEMATIC PLAN	2
TYPICAL SECTIONS	3
GENERAL NOTES	4-5
GENERAL SUMMARY	6
RESURFACING PLAN	7-22
PAVEMENT MARKING SUBSUMMARY	23-26
PAVEMENT MARKING PLAN	27-34

NHS PROJECT
DESIGN EXCEPTIONS
NONE

PLAN PREPARED BY:



CIVIL ENGINEERING
SURVEYING
LANDSCAPE
ARCHITECTURE
1800 Center Pointe
The Ohio State Univ
513779 TEL
www.kleingers.com

ENGINEERS SEAL:



SIGNED: *Yezouk S. Yezoukian*
DATE: 12/02/2015

STANDARD CONSTRUCTION DRAWINGS		SUPPLEMENTAL SPECIFICATIONS	SPECIAL PROVISIONS
BP-3.1	7/18/14	800	1/15/16
BP-4.1	7/19/13	821	4/20/12
BP-5.1	7/19/13	832	1/17/14
BP-7.1	7/18/14	921	4/20/12
MT-95.31	7/18/14		
MT-95.32	7/18/14		
MT-99.20	7/19/13		
MT-101.30	7/18/14		
MT-105.10	7/19/13		
MT-110.10	7/19/13		
TC-65.10	1/17/14		
TC-65.11	7/18/14		
TC-71.10	1/17/14		
TC-82.10	7/17/15		

UNDERGROUND UTILITIES
CONTACT BOTH SERVICES
CALL TWO WORKING DAYS
BEFORE YOU DIG

CALL
1-800-362-2764
(TOLL FREE)

OHIO UTILITIES PROTECTION SERVICE
NON-MEMBERS
MUST BE CALLED DIRECTLY

OIL & GAS PRODUCERS UNDERGROUND
PROTECTION SERVICE CALL: 1-800-925-0988

APPROVED: *Tammy K Campbell*
DATE: 12/15/15 DISTRICT DEPUTY DIRECTOR

APPROVED: *[Signature]*
DATE: 1-4-16 DIRECTOR, DEPARTMENT OF TRANSPORTATION

BUT - SR 4/SR 4D-20.64/0.00
160136 PID - 94262
Dist 8 3/24/2016
Contract Proposal Available @ www.contracts.dot.state.oh.us/home

FEDERAL PROJECT NO. E130858
PID NO. 94262
CONSTRUCTION PROJECT NO.
RAILROAD INVOLVEMENT CONSOLIDATED RAIL
BUT - 4 / 4D - 20.64 / 0.00
1/34

H:\2015\150055\99999\roadway\sheet\sheet\99999\B001.dgn 11/13/2015 10:00:23 AM arichard.s

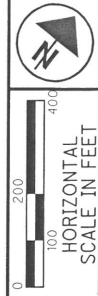
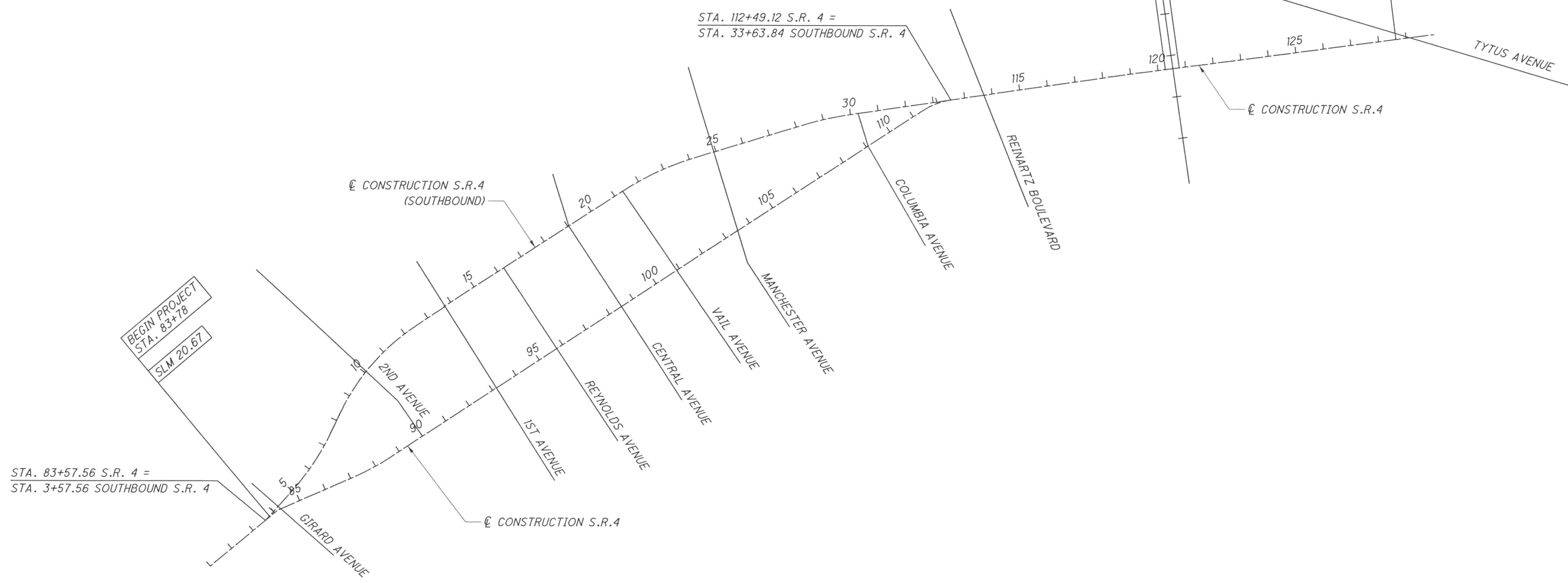

SCHEMATIC PLAN

BUT-4/4D-60.64/0.00

NOTES:

S.R. 4 ☒ CONSTRUCTION AND S.R. 4 SOUTHBOUND CONSTRUCTION ARE BASED ON THE VISUAL CENTER OF ROADWAY.

PROJECT BEGINS SOUTH SIDE OF GIRARD AVENUE INTERSECTION.

SUSPEND PAVEMENT OPERATIONS AT GRADE RAILROAD CROSSING.

PROJECT ENDS AT EDGE OF THE EB THRU LANE OF TYTUS AVENUE.

H:\2015\150055\99999\roadway\sheets\99999GY001.dgn 11/13/2015 10:00:32 AM arichards

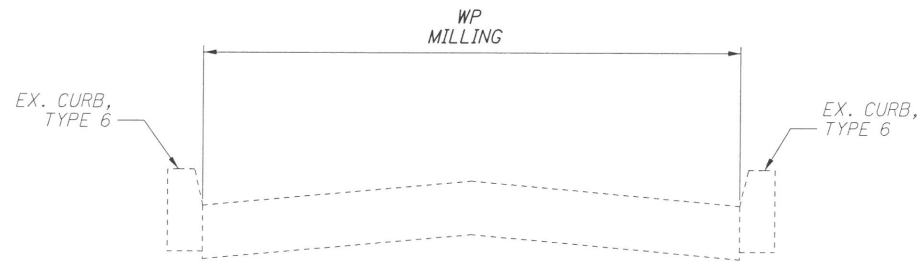

TYPICAL 1

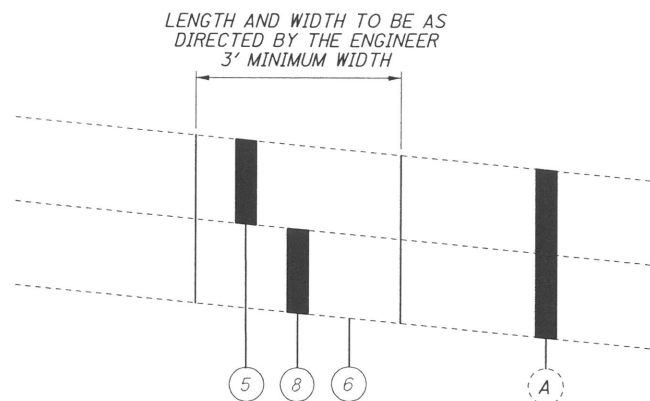
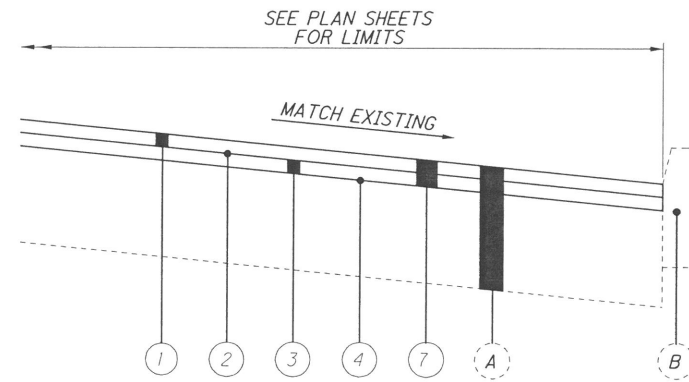

ITEM 253 - PAVEMENT REPAIR, AS PER PLAN
NOT TO SCALE

LEGEND

- ① ITEM 441 - 1 1/4" ASPHALT CONCRETE SURFACE COURSE, TYPE 1, (448), PG64-22
- ② ITEM 407 - TACK COAT (0.075 GAL/S.Y.)
- ③ ITEM 441 - 1 3/4" ASPHALT CONCRETE INTERMEDIATE COURSE, TYPE 2, (448)
- ④ ITEM 407 - TACK COAT FOR INTERMEDIATE COURSE (0.04 GAL/S.Y.)
- ⑤ ITEM 301 - 10" ASPHALT CONCRETE BASE, PG64-22
- ⑥ ITEM 204 - SUBGRADE COMPACTION
- ⑦ ITEM 254 - PAVEMENT PLANING, ASPHALT CONCRETE (3"), AS PER PLAN
- ⑧ ITEM 304 - 6" AGGREGATE BASE
- Ⓐ EXISTING ASPHALT PAVEMENT, THICKNESS UNKNOWN
- Ⓑ EXISTING CURB

SPECIFICATIONS AND STANDARD CONSTRUCTION DRAWINGS

THE STATE OF OHIO DEPARTMENT OF TRANSPORTATION, CONSTRUCTION AND MATERIALS SPECIFICATIONS, DATED JANUARY 1, 2013, AND THE NOTED STANDARD CONSTRUCTION DRAWINGS SHALL GOVERN THIS IMPROVEMENT.

EXISTING FACILITIES

IT SHALL BE THE RESPONSIBILITY OF THE CONTRACTOR TO PERFORM HIS WORK IN SUCH A MANNER AS TO NOT DAMAGE OR DESTROY ANY EXISTING FACILITY. IF ANY SUCH DAMAGE DOES OCCUR DUE TO THE CONTRACTOR'S OPERATIONS, HE SHALL REPLACE THE DAMAGED PORTION AT HIS EXPENSE AND TO THE SATISFACTION OF THE ENGINEER.

WORK LIMITS

THE WORK LIMITS SHOWN ON THESE PLANS ARE FOR PHYSICAL CONSTRUCTION ONLY. PROVIDE THE INSTALLATION AND OPERATION OF ALL WORK ZONE TRAFFIC CONTROL AND WORK ZONE TRAFFIC CONTROL DEVICES REQUIRED BY THESE PLANS WHETHER INSIDE OR OUTSIDE THESE WORK LIMITS.

CONSTRUCTION NOTIFICATION

THE CONTRACTOR WILL ADVISE THE PROJECT ENGINEER A MINIMUM OF:
- FOURTEEN (14) DAYS PRIOR TO THE START OF CONSTRUCTION ACTIVITIES, AND/OR ROAD CLOSURES.
- SEVEN (7) DAYS PRIOR TO LANE CLOSURES AND/OR SHIFTS IN TRAFFIC PATTERNS.

THE PROJECT ENGINEER WILL FORWARD THIS INFORMATION TO THE FOLLOWING:

DISTRICT PUBLIC INFORMATION OFFICER (PIO) BY FAX AT (513) 933-9472 OR EMAIL AT DOB.PIO.FORM@DOT.OHIO.GOV

DISTRICT PERMIT SECTION BY FAX AT (513) 933-9472 OR EMAIL AT TOM.MAKRIS@DOT.OHIO.GOV

CENTRAL OFFICE SPECIAL HAUL PERMITS SECTION BY FAX AT (514) 728-4099 OR EMAIL AT HAULING.PERMITS@DOT.OHIO.GOV

THE PIO WILL, IN TURN, NOTIFY THE PUBLIC, THE LOCAL EMERGENCY SERVICES, AFFECTED SCHOOLS AND BUSINESSES, AND ANY OTHER IMPACTED LOCAL PUBLIC AGENCY OF ANY OF THE ABOVE MENTIONED ITEMS, VIA MEDIA SOURCES.

CENTER LINE OF CONSTRUCTION

THE CENTER LINE OF CONSTRUCTION LABELED ON THESE PLANS IS AN ASSUMED CENTER LINE OF THE EXISTING ROADWAY. STATIONING IS ADDED TO AID IN CONSTRUCTION LAYOUT.

UTILITY COORDINATION:

THE FOLLOWING IS A LIST OF THE KNOWN EXISTING UTILITIES IN THE PROJECT AREA ALONG WITH THE RESPECTIVE OWNERS. THE LIST IS INCLUDED FOR INFORMATIONAL PURPOSES ONLY. THE CONTRACTOR IS RESPONSIBLE FOR CONTACTING ALL UTILITY OWNERS IN THE PROJECT AREA PRIOR TO START OF CONSTRUCTION WHETHER LISTED ON THIS PAGE OR NOT.

ELECTRIC

Duke Energy
139 East Fourth Street, Rm 467A
Cincinnati, OH 45202
(513) 287-1266 (Tim Meyer)

GAS

Duke Energy
139 East Fourth Street, Rm 460A
Cincinnati, OH 45202
(513) 287-2934 (Ed Ackerson)

CABLE

Time Warner Cable
11252 Cornell Park Drive
Cincinnati, OH 45242
(513) 386-5499 (Kent Rieger)

TELEPHONE

AT&T
3233 Woodman Dr
Kettering, OH 45420
(937) 296-3555

FIBER OPTICS

Windstream Communications
111 W 1st St, Suite 400
Dayton, OH 45402
(973) 853-4000

WATER & SEWER

City of Middletown
One Donham Plaza
Middletown, OH 45042
(513) 425-1860

TRAFFIC SIGNAL

City of Middletown
One Donham Plaza
Middletown, OH 45042
(513) 425-7927

THERE ARE NO UNDERGROUND UTILITIES SHOWN ON THIS PLAN. THE NATURE OF THE WORK REQUIRED BY THIS PROJECT WILL NOT AFFECT ANY KNOWN UNDERGROUND UTILITIES THAT EXIST UNDER OR ADJACENT TO THE WORK AREA.

CONTINGENCY QUANTITIES

THE CONTRACTOR SHALL NOT ORDER MATERIALS OR PERFORM WORK FOR ITEMS DESIGNATED BY PLAN NOTE TO BE USED "AS DIRECTED BY THE ENGINEER" OR LABELED CONTINGENCY UNLESS AUTHORIZED BY THE ENGINEER. THE ACTUAL WORK LOCATIONS AND QUANTITIES USED FOR SUCH ITEMS SHALL BE INCORPORATED INTO THE FINAL CHANGE ORDER GOVERNING COMPLETION OF THIS PROJECT.

TACK COAT

THE RATE OF APPLICATION OF THE 407 TACK COAT SHALL BE SUBJECT TO ADJUSTMENT AS DIRECTED BY THE ENGINEER. RATE OF APPLICATION SHOWN ON TYPICAL SECTION.

PROFILE AND ALIGNMENT

THE PROPOSED PAVEMENT RESURFACING SHALL FOLLOW THE ALIGNMENT AND PROFILE OF THE EXISTING PAVEMENT (AS SHOWN ON THE TYPICAL SECTIONS).

ITEM 253, PAVEMENT REPAIR, AS PER PLAN

THIS WORK SHALL CONSIST OF FULL DEPTH PAVEMENT REMOVAL AND INSTALLING NEW PAVEMENT PER THE TYPICAL SECTION OF THIS PLAN SET AT THE DIRECTION OF THE ENGINEER.

THIS ITEM SHALL COVER PAVEMENT REMOVAL, SUBGRADE COMPACTION, AGGREGATE BASE, AND ASPHALT CONCRETE BASE. THE FOLLOWING CONTINGENCY QUANTITY HAS BEEN CARRIED TO THE GENERAL SUMMARY:

ITEM 253, PAVEMENT REPAIR, AS PER PLAN 163 CY

ITEM 254, PAVEMENT PLANING, ASPHALT CONCRETE, AS PER PLAN

THE PLANING SHALL BE SCHEDULED SO AS TO BE COVERED BY THE INTERMEDIATE COURSE WITHIN 48 HOURS AFTER BEING PERFORMED. ALL CASTING ADJUSTMENTS AND PAVEMENT REPAIR WORK AS DIRECTED BY THE ENGINEER SHALL BE SCHEDULED SO AS TO COMPLY WITH THIS REQUIREMENT. ALL PATCHING OF PLANED AREAS SHALL BE DONE WITHIN 24 HOURS OF NOTIFICATION OF ITS NECESSITY. THE PLANING MAY HAVE TO BE DONE IN MORE THAN ONE OPERATION TO COMPLY WITH THE INTENT OF THIS NOTE. FAILURE TO COMPLY WITH THE ABOVE REQUIREMENTS SHALL RESULT IN LIQUIDATED DAMAGES AS PER ITEM 108.07.

PAYMENT FOR THE ABOVE SHALL BE INCLUDED IN THE PRICE BID FOR THE PERTINENT BID ITEM.

ITEM 204, SUBGRADE COMPACTION

THIS ITEM QUANTIFIES THE SUBGRADE COMPACTION IN PAVEMENT SECTIONS WHERE PAVEMENT WAS REMOVED DUE TO CURB RAMP INSTALLATION.

ITEM 204, SUBGRADE COMPACTION 26 CY

ITEM 623, CONSTRUCTION LAYOUT STAKES, AS PER PLAN

PRIOR TO THE START OF ROADWAY OPERATION, THE CONTRACTOR SHALL REFERENCE THE LENGTH OF THE PROJECT ON BOTH SIDES OF THE ROADWAY, IN A MANNER SATISFACTORY TO THE ENGINEER. THE PAVEMENT SHALL BE REFERENCED IN 1000 FEET INCREMENTS ACCEPTABLE TO THE ENGINEER, IN A SEMIPERMANENT CONDITION.

ITEM 632, DETECTOR LOOP, AS PER PLAN

PRIOR TO REPAIR WORK OR PLANING AT INTERSECTIONS, THAT MAY AFFECT THE TRAFFIC LOOP DETECTOR WIRE, THE MAINTAINING AGENCY SHALL LOCATE THEM. THEY SHALL BE CHECKED TO INSURE THAT THEY ARE WORKING PROPERLY BY HAVING A REVIEW OF THE EXISTING FACILITIES WITH THE PROJECT ENGINEER, MAINTAINING AGENCY AND THE CONTRACTOR.

IF PROPERLY WORKING TRAFFIC LOOP DETECTOR WIRE IS DISTURBED DURING REPAIR WORK OR PAVEMENT PLANING, THE LOOP DETECTOR SHALL BE REPLACED AT THE DIRECTION OF THE ENGINEER. THIS WORK SHALL INCLUDE REMOVAL OF THE EXISTING DETECTOR LOOP CONNECTION, INSTALLATION OF NEW DETECTOR LOOP AND CONNECTION, AND TESTING THE NEW DETECTOR LOOP. THE FOLLOWING CONTINGENCY QUANTITIES HAVE BEEN CARRIED TO THE GENERAL SUMMARY FOR THIS WORK:

ITEM 632, DETECTOR LOOP, AS PER PLAN 2 EA

BEGIN WORK START DATE

WORK FOR THIS CONTRACT SHALL NOT BEGIN PRIOR TO JUNE 1, 2016.

CALCULATED BY: SUBMITTED BY: CHECKED BY: YSY
GENERAL NOTES
BUT - 4 / 4D - 60.64 / 0.00
4
34

H:\2015\150055\99999\roadway\sheet\99999\1001.dgn 11/13/2015 11:30:40 AM arichard.s

ITEM 614, MAINTENANCE OF TRAFFIC

THE REQUIRED WORK SHALL BE PERFORMED IN A MANNER THAT CAUSES THE LEAST INCONVENIENCE TO AND THAT PROVIDES THE MAXIMUM SAFETY FOR THE TRAVELING PUBLIC, SAFETY-SERVICE AND THE CONTRACTOR. THE REQUIREMENTS FOR MAINTAINING TRAFFIC AS INDICATED IN THE OHIO MANUAL OF UNIFORM TRAFFIC CONTROL DEVICES FOR STREETS AND HIGHWAYS (REFERRED TO AS THE "OMUTCD"), CURRENT EDITION, PERTINENT ITEMS IN THE ODOT SPECIFICATIONS, AND AS REQUESTED BY THE ENGINEER SHALL APPLY IN ADDITION TO THE FOLLOWING NOTES.

SHOULD ANY PAVED AREAS NOT DESIGNATED FOR MAINTAINING TRAFFIC BECOME DAMAGED OR DESTROYED DURING CONSTRUCTION DUE TO THE CONTRACTOR'S NEGLIGENCE OR FAILURE TO PROVIDE ADEQUATE SIGNS, BARRICADES, DRUMS, FLAGGERS OR OTHER TRAFFIC CONTROL DEVICES, THE RESTORATION OF THE PAVED AREAS SHALL BE AT THE EXPENSE OF THE CONTRACTOR AND TO THE SATISFACTION OF THE ENGINEER.

THE CONTRACTOR WILL BE REQUIRED TO PROVIDE, ERECT, MAINTAIN (PROPER POSITION, KEPT CLEAN AND LEGIBLE, AND IN GOOD WORKING CONDITION), AND REMOVE LIGHTS, SIGNS, DRUMS, AND ALL OTHER TRAFFIC CONTROL DEVICES NECESSARY FOR THE MAINTENANCE OF TRAFFIC. ALL SIGNS SHALL BE REFLECTORIZED OR ILLUMINATED. PLACEMENT OF ALL TRAFFIC CONTROL DEVICES SHALL START AND PROCEED IN THE DIRECTION OF THE FLOW OF TRAFFIC. REMOVAL OF TRAFFIC CONTROL DEVICES SHALL BEGIN AT THE END OF THE CONSTRUCTION AREA AND PROCEED TOWARD ONCOMING TRAFFIC. THE CONTRACTOR SHALL PROVIDE FOR THE INSTALLATION OF ALL NECESSARY TRAFFIC CONTROL DEVICES BEFORE BEGINNING WORK AND IMMEDIATELY REMOVE THESE DEVICES WHEN WORK IS SUSPENDED OR COMPLETE.

FROM STATION 18+00 TO 37+00 AND STATION 79+00 TO 136+52 A MINIMUM OF ONE-HALF OF THE EXISTING PAVEMENT WIDTH SHALL BE MAINTAINED AT ALL TIMES BY THE USE OF EXISTING PAVEMENT AND THE COMPLETED PAVEMENT.

FROM STATION 37+00 TO 72+24 A MINIMUM OF ONE-HALF OF THE EXISTING PAVEMENT WIDTH SHALL BE MAINTAINED FROM 7PM TO 6AM BY THE USE OF EXISTING PAVEMENT AND THE COMPLETED PAVEMENT.

DURING NON-WORKING HOURS A MINIMUM OF THE FULL WIDTH OF EXISTING PAVEMENT SHALL BE MAINTAINED AT ALL TIMES BY THE USE OF THE EXISTING PAVEMENT AND THE COMPLETED PAVEMENT.

THE CONTRACTOR SHALL MAINTAIN ACCESS TO ALL LOCAL DRIVES, PRIVATE OR PUBLIC, WITHIN THE PROJECT LIMITS THROUGHOUT CONSTRUCTION.

LENGTH AND DURATION OF LANE CLOSURES AND RESTRICTIONS SHALL BE AT THE APPROVAL OF THE ENGINEER. IT IS THE INTENT TO MINIMIZE THE IMPACT TO THE TRAVELING PUBLIC. LANE CLOSURES OR RESTRICTIONS OVER SEGMENTS OF THE PROJECT IN WHICH NO WORK IS ANTICIPATED WITHIN A REASONABLE TIME FRAME, AS DETERMINED BY THE ENGINEER, SHALL NOT BE PERMITTED. THE LEVEL OF UTILIZATION OF MAINTENANCE OF TRAFFIC DEVICES SHALL BE COMMENSURATE WITH THE WORK IN PROGRESS.

ITEM 614, MAINTENANCE OF TRAFFIC (CONTINUED)

IN THOSE AREAS WHERE EXISTING PAVEMENT IS TO BE RESURFACED OR REMOVED AND REPLACED, THE CONTRACTOR SHALL CONDUCT HIS OPERATIONS SO AS TO MAINTAIN DRIVEWAY TRAFFIC THROUGH THE CONSTRUCTION AREA. IF TWO APPROVED ACCESS POINTS SERVE THE SAME PARKING AREA, THE CONTRACTOR WILL BE PERMITTED TO CLOSE PAVED AREAS TO TRAFFIC FOR A MINIMUM PERIOD OF TIME, CONSISTENT WITH THE REQUIREMENTS OF THE SPECIFICATIONS FOR THE PROTECTION OF COMPLETED ASPHALT COURSES.

IF BUSINESS PROPERTY IS INVOLVED, AN ALTERNATE ACCESS MUST BE PROVIDED IF BLOCKAGE EXCEEDS ONE (1) HOUR. REPEATED BLOCKING MUST ALLOW AT LEAST 15 MINUTE INTERVAL OF TRAFFIC ACCESS EVERY HOUR. BEFORE THE WORK BEGINS, THE CONTRACTOR WILL PROVIDE THE ENGINEER WITH THE NAMES AND TELEPHONE NUMBERS OF TWO (2) PERSONS WHO CAN BE CONTACTED 24 HOURS A DAY BY THE ENGINEER, AFFECTED SAFETY-SERVICE AGENCIES, AND ALL INTERESTED POLICE AGENCIES, TO REPAIR AND/OR REPLACE THE TRAFFIC CONTROL DEVICES AS NEEDED TO MAINTAIN THE SAFETY OF THE TRAVELED PAVEMENT.

ALL WORK AND TRAFFIC CONTROL DEVICES SHALL BE IN ACCORDANCE WITH ITEM 614 AND OTHER APPLICABLE PORTIONS OF THE SPECIFICATIONS, AS WELL AS THE OMUTCD. PAYMENT FOR ALL LABOR, EQUIPMENT AND MATERIALS SHALL BE INCLUDED IN THE LUMP SUM CONTRACT PRICE FOR 614, MAINTAINING TRAFFIC.

MAINTENANCE OF TRAFFIC PAVEMENT MARKING

THE NATURE OF THE WORK TO BE CONDUCTED REQUIRES TEMPORARY PAVEMENT MARKINGS TO BE PLACED AFTER PAVEMENT PLANING AND ASPHALT COURSES ARE PLACED. THE FOLLOWING QUANTITIES HAVE BEEN CARRIED TO THE GENERAL SUMMARY FOR THIS WORK:

614, WORK ZONE LANE LINE, CLASS I	2.55 MILE
614, WORK ZONE CENTER LINE, CLASS I	0.42 MILE
614, WORK ZONE CHANNELIZING LINE, CLASS I	3533 FT
614, WORK ZONE STOP LINE, CLASS I	793 FEET
614, WORK ZONE ARROW, CLASS I	21 EACH
614, WORK ZONE RAILROAD SYMBOL, CLASS I	4 EACH
614, WORK ZONE CROSSWALK LINE, CLASS I	4166 FEET
614, WORK ZONE LANE LINE, CLASS III, 642 PAINT	2.55 MILE
614, WORK CENTER LINE, CLASS III, 642 PAINT	0.42 MILE
614, WORK ZONE CHANNELIZING LINE, CLASS III, 642 PAINT	3533 FT
614, WORK ZONE STOP LINE, CLASS III, 642 PAINT	793 FT
614, WORK ZONE ARROW, CLASS III, 624 PAINT	21 EACH
614, WORK ZONE RAILROAD SYMBOL, CLASS III, 642 PAINT	4 EACH
614, WORK ZONE CROSSWALK LINE, CLASS III, 642 PAINT	4166 FEET

ITEM 614, LAW ENFORCEMENT OFFICER (WITH PATROL CAR) FOR ASSISTANCE, AS PER PLAN

USE OF LAW ENFORCEMENT OFFICERS (LEOs) BY CONTRACTORS OTHER THAN THE USES SPECIFIED BELOW WILL NOT BE PERMITTED AT PROJECT COST. LEOs SHOULD NOT BE USED WHERE THE OMUTCD INTENDS THAT FLAGGERS BE USED.

IN ADDITION TO THE REQUIREMENT OF CMS 614 AND THE OMUTCD, A UNIFORMED LEO AND AN OFFICIAL PATROL CAR (CAR WITH TOP-MOUNTED EMERGENCY FLASHING LIGHTS AND COMPLETE MARKINGS OF THE APPROPRIATE LAW ENFORCEMENT AGENCY) SHALL BE PROVIDED FOR THE FOLLOWING TRAFFIC CONTROL TASKS:

DURING A TRAFFIC SIGNAL INSTALLATION WHEN IMPACTING THE NORMAL FUNCTION OF THE SIGNAL OR THE FLOW OF TRAFFIC OR WHEN TRAFFIC NEEDS TO BE DIRECTED THROUGH AN ENERGIZED TRAFFIC SIGNAL CONTRARY TO THE SIGNAL DISPLAY (E.G., DIRECTING MOTORISTS THROUGH A RED LIGHT).

LEOs SHOULD NOT FORGO THEIR TRAFFIC CONTROL RESPONSIBILITIES TO APPREHEND MOTORISTS FOR ROUTINE TRAFFIC VIOLATIONS. HOWEVER, IF A MOTORIST'S ACTIONS ARE CONSIDERED TO BE RECKLESS, THEN PURSUIT OF THE MOTORIST IS APPROPRIATE.

THE LEOs WORK AT THE DIRECTION OF THE CONTRACTOR. THE CONTRACTOR IS RESPONSIBLE FOR SECURING THE SERVICES OF THE LEOs WITH THE APPROPRIATE AGENCIES AND COMMUNICATING THE INTENTIONS OF THE PLANS WITH RESPECT TO DUTIES OF THE LEOs. THE ENGINEER SHALL HAVE FINAL CONTROL OVER THE LEOs DUTIES AND PLACEMENT, AND WILL RESOLVE AN ISSUES THAT MAY ARISE BETWEEN THE TWO PARTIES.

THE LEO SHALL REPORT TO THE CONTRACTOR PRIOR TO THE START OF THE SHIFT, IN ORDER TO RECEIVE INSTRUCTIONS REGARDING SPECIFIC WORK ASSIGNMENTS DURING HIS/HER SHIFT, THE LEO IS EXPECTED TO STAY AT THE PROJECT SITE OF THE ENTIRE DURATION OF HIS/HER SHIFT. THE LEO SHALL REPORT TO THE CONTRACTOR AT THE END OF HIS/HER SHIFT. ONCE THE LEO HAS COMPLETED THE DUTIES DESCRIBED ABOVE AND STILL HAS TIME REMAINING ON HIS/HER SHIFT, THE LEO MAY BE ASKED TO PATROL THROUGH THE WORK ZONE (WITH FLASHING LIGHTS OFF) OR BE PLACED AT A LOCATION TO DETER MOTORISTS FROM SPEEDING. SHOULD IT BE NECESSARY TO LEAVE THE PROJECT SITE, THE LEO SHALL NOTIFY THE ENGINEER. THE CONTRACTOR SHALL PROVIDE THE LEO WITH A TWO-WAY COMMUNICATION DEVICE WHICH SHALL BE RETURNED TO THE CONTRACTOR AT THE END OF HIS/HER SHIFT.

LEOs (WITH PATROL CAR) REQUIRED BY THE TRAFFIC MAINTENANCE TASKS ABOVE SHALL BE PAID FOR ON A UNIT PRICE (HOURLY) BASIS UNDER ITEM 614, LAW ENFORCEMENT OFFICER (WITH PATRL CAR) FOR ASSISTANCE. THE FOLLOWING ESTIMATED QUANTITIES HAVE BEEN CARRIED TO THE GENEREAL SUMMARY.

ITEM 614, LAW ENFORCEMENT OFFICER WITH 40 HRS PATROL CAR FOR ASSISTANCE, A.P.P.

THE HOURS PAID SHALL INCLUDED MINIMUM SHOW-UP TIME REQUIRED BY THE LAW ENFORCEMENT AGENCY INVOLVED.

ITEM 614, LAW ENFORCEMENT OFFICER (WITH PATROL CAR) FOR ASSISTANCE, AS PER PLAN (CONTINUED)

ANY ADDITIONAL COSTS (ADMINISTRATIVE OR OTHERWISE) INCURRED BY THE CONTRACOTR TO OBTAIN THE SERVICES OF AN LEO ARE INCLUDED WITH THE BID UNIT PRICE FOR ITEM 614, LAW ENFORCEMENT OFFICER WITH PATROL CAR FOR ASSISTANCE.

THE CONTRACTOR SHALL MAKE ARRANGEMENTS FOR THESE SERVICES WITH:

CITY OF FRANKLIN POLICE DIVISION
400 ANDERSON STREET
FRANKLIN, OH 45005
(937) 746-2882

TEMPORARY PAVEMENT WEDGE

TEMPORARY PAVEMENT WEDGES SHALL BE PROVIDED AT ALL TIMES WHERE TRAFFIC IS REQUIRED TO TRAVEL FROM OR ONTO A PAVEMENT SURFACE OF A DIFFERENT ELEVATION. THE MINIMUM SLOPE OF THE TEMPORARY PAVEMENT WEDGE SHALL BE 3:1 ALONG LONGITUDINAL JOINTS AND 120:1 AT TRANSVERSE JOINTS. THESE WEDGES SHALL BE REMOVED PRIOR TO PLACING THE SPECIFIED PAVEMENT COURSE. PAYMENT FOR ALL WORK, MATERIALS, ETC. ASSOCIATED WITH THIS ITEM SHALL BE PAID FOR UNDER THE LUMP SUM ITEM 614, MAINTAINING TRAFFIC.

H:\2015\150055\99999\roadway\sheets\99999\GN002.dgn 11/13/2015 12:20:41 PM arichards

GENERAL NOTES

BUT -4/ 4D -60.64 / 0.00

CALCULATED
SUB
CHECKED
YSY

H:\2015\150055\99999\roadway\sheet\99999GF001.dgn 11/13/2015 10:03:10 AM arichards

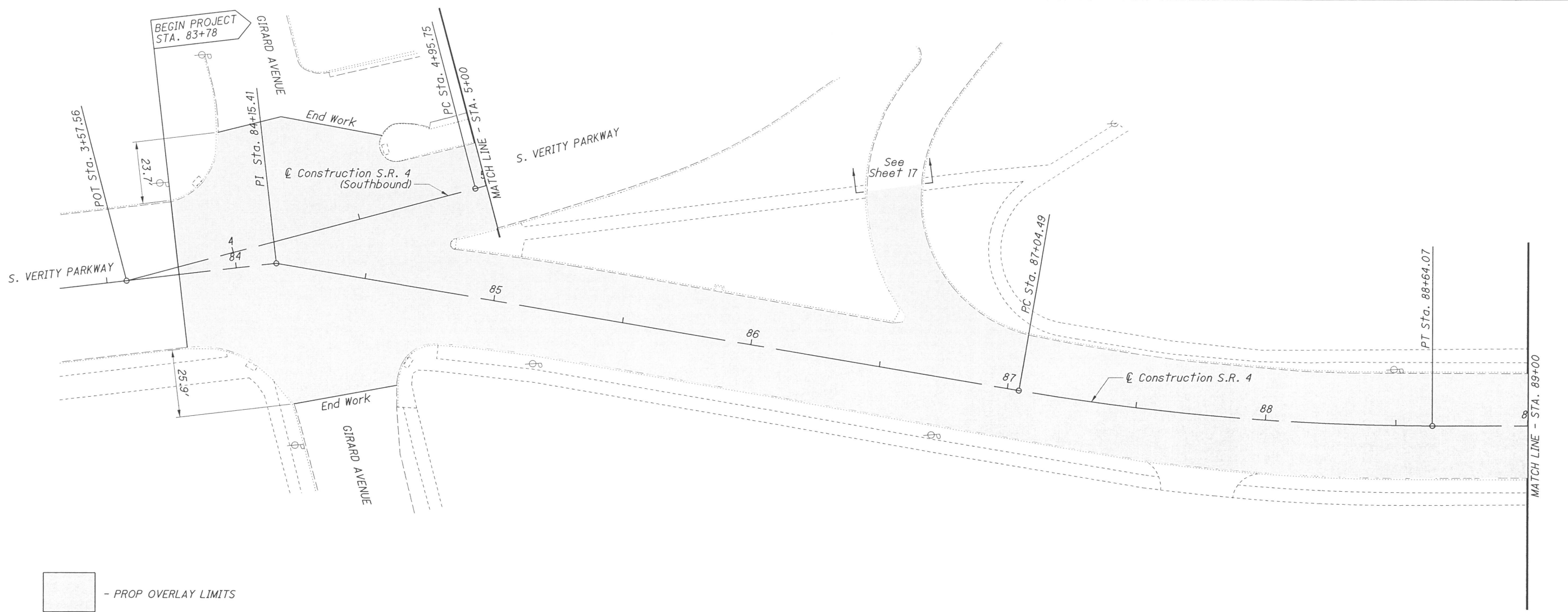

ROUTE	STATION		LENGTH		PAVEMENT WIDTH FEET	TYPICAL SECTION	EXISTING PAVEMENT TYPE	PAVEMENT AREA SQ YD	202	202	202	254	254	301	304	407	407	441	441	608	608	608	608	608	609
	FROM	TO	MILES	FEET					PAVEMENT REMOVED SQ YD	WALK REMOVED SQ FT	CURB REMOVED FT	PAVEMENT PLANING ASPHALT CONCRETE, AS PER PLAN SQ YD	PATCHING PLANED SURFACE SQ YD	ASPHALT CONCRETE BASE, PG64-22 CU YD	AGGREGATE BASE CU YD	TACK COAT GAL	TACK COAT FOR INTERMEDIATE COURSE GAL	ASPHALT CONCRETE SURFACE COURSE, TYPE 1, (448) CU YD	ASPHALT CONCRETE INTERMEDIATE COURSE, TYPE 2, (448) CU YD	4" CONCRETE WALK SQ FT	CURB RAMP, TYPE A1 SQ FT	CURB RAMP, TYPE A2 SQ FT	CURB RAMP, TYPE C1 SQ FT	DETECTABLE WARNING SQ FT	CURB, TYPE 6 FT
SR 4	83+78	89+00	0.099	522	+/-36 TO +/-40	1	ASPHALT	2975				2975	30			223	119	103	145						
TOTALS THIS SHEET CARRIED TO SHEET 22												2975	30			223	119	103	145						

RESURFACING PLAN
BEGIN PROJECT - STA. 89+00

BUT -4/ 4D-60.64 / 0.00

7
34

SCALE IN FEET
0 20 40
HORIZONTAL

H:\2015\150055\99999\roadway\sheet\99999GP003.dgn 11/13/2015 10:03:28 AM arichard.s

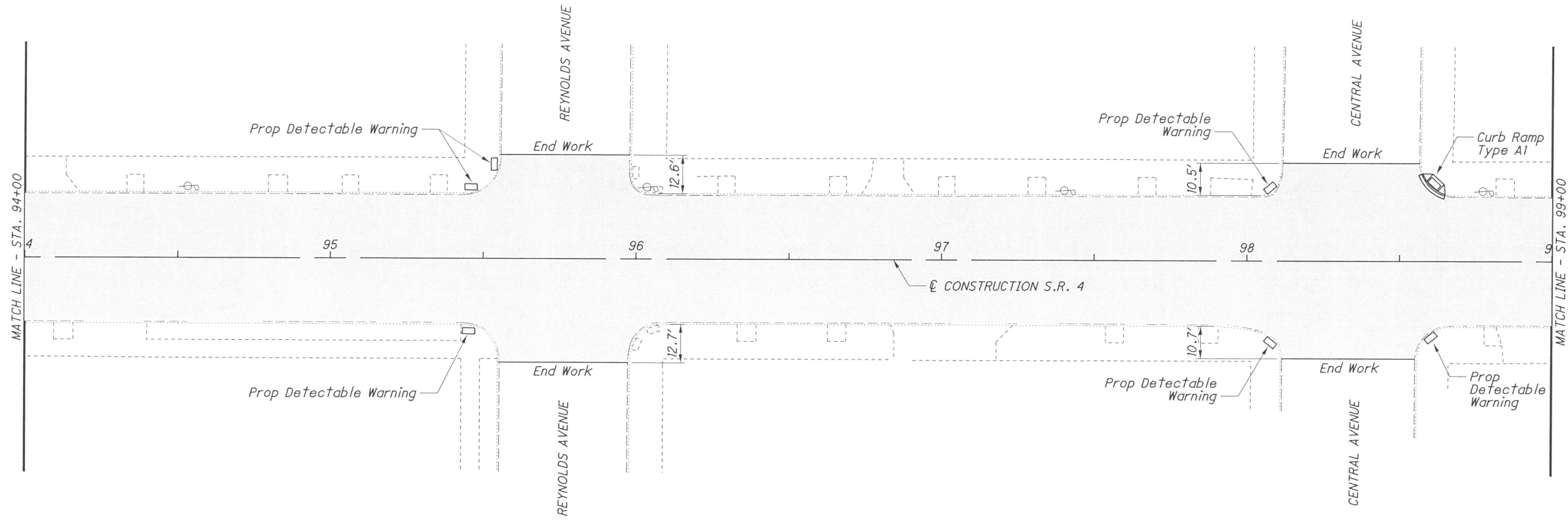

 - PROP OVERLAY LIMITS

ROUTE	STATION		LENGTH		PAVEMENT WIDTH FEET	TYPICAL SECTION	EXISTING PAVEMENT TYPE	PAVEMENT AREA SQ YD	202	202	202	254	254	301	304	407	407	441	441	608	608	608	608	608	609
	FROM	TO	MILES	FEET					PAVEMENT REMOVED SQ YD	WALK REMOVED SQ FT	CURB REMOVED FT	PAVEMENT PLANING ASPHALT CONCRETE, AS PER PLAN SQ YD	PATCHING PLANED SURFACE SQ YD	ASPHALT CONCRETE BASE, PG64-22 CU YD	AGGREGATE BASE CU YD	TACK COAT GAL	TACK COAT FOR INTERMEDIATE COURSE GAL	ASPHALT CONCRETE SURFACE COURSE, TYPE 1, (448) CU YD	ASPHALT CONCRETE INTERMEDIATE COURSE, TYPE 2, (448) CU YD	4" CONCRETE WALK SQ FT	CURB RAMP, TYPE A1 SQ FT	CURB RAMP, TYPE A2 SQ FT	CURB RAMP, TYPE C1 SQ FT	DETECTABLE WARNING SQ FT	CURB, TYPE 6 FT
SR 4	94+00	99+00	0.095	500	+/-42	1	ASPHALT	2575	1	24	11	2575	26	0.34	0.20	193	103	89	125		29			48	
TOTALS THIS SHEET CARRIED TO SHEET 22									1	24	11	2575	26	0.34	0.20	193	103	89	125		29			48	



CALCULATED
SUB
CHECKED
YSY

RESURFACING PLAN
STA. 94+00 - STA. 99+00

BUT-4/4D-60.64/0.00

H:\2015\150055\99999\roadway\sheet\99999CP004.dgn 11/13/2015 10:03:36 AM arichards

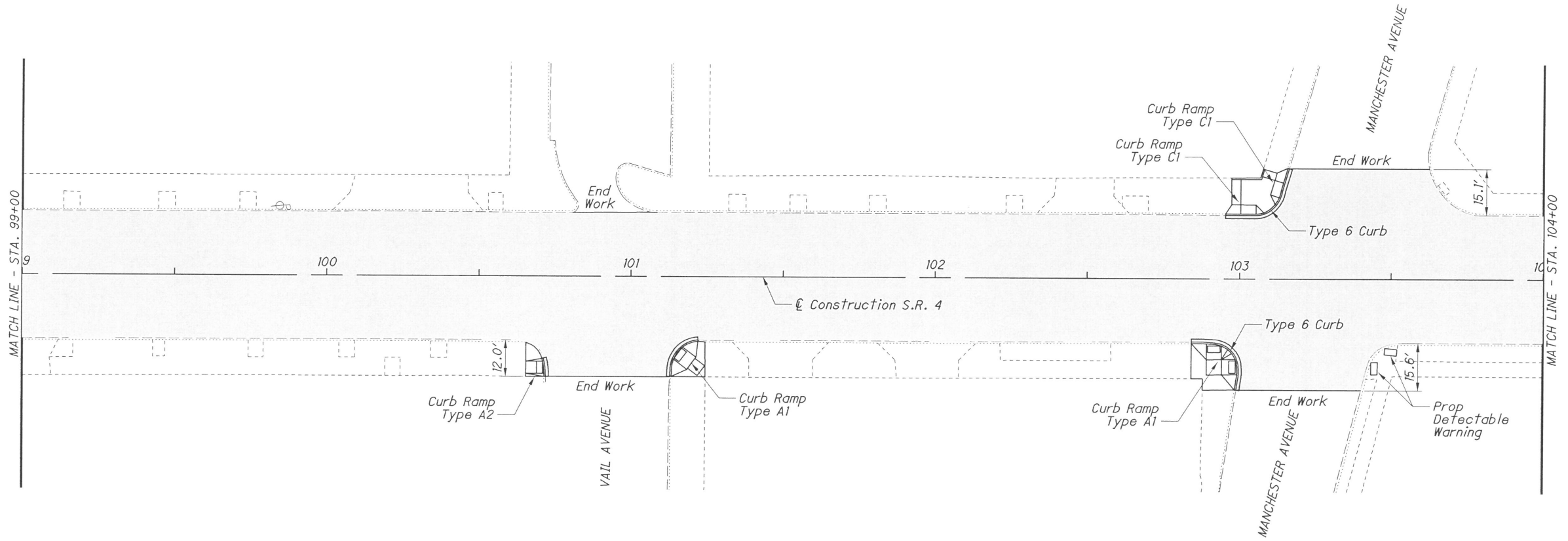

CALCULATED
SUB
CHECKED
YSY

RESURFACING PLAN
STA. 99+00 - STA. 104+00

ROUTE	STATION		LENGTH		PAVEMENT WIDTH FEET	TYPICAL SECTION	EXISTING PAVEMENT TYPE	PAVEMENT AREA	ITEMS																
	FROM	TO	MILES	FEET					PAVEMENT REMOVED SQ YD	WALK REMOVED SQ FT	CURB REMOVED FT	PAVEMENT PLANING ASPHALT CONCRETE, AS PER PLAN SQ YD	PATCHING PLANED SURFACE SQ YD	ASPHALT CONCRETE BASE, P664-22 CU YD	AGGREGATE BASE CU YD	TACK COAT GAL	TACK COAT FOR INTERMEDIATE COURSE GAL	ASPHALT CONCRETE SURFACE COURSE, TYPE 1, (448) CU YD	ASPHALT CONCRETE INTERMEDIATE COURSE, TYPE 2, (448) CU YD	4" CONCRETE WALK SQ FT	CURB RAMP, TYPE A1 SQ FT	CURB RAMP, TYPE A2 SQ FT	CURB RAMP, TYPE C1 SQ FT	DETECTABLE WARNING SQ FT	CURB, TYPE 6 FT
SR 4	99+00	104+00	0.095	500	+/-42	1	ASPHALT	2553	9	558	80	2553	26	2.47	1.48	191	102	89	124	172	208	35	183	16	5
TOTALS THIS SHEET CARRIED TO SHEET 22									9	558	80	2553	26	2.47	1.48	191	102	89	124	172	208	35	183	16	5

BUT -4/ 4D -60.64 / 0.00

H:\2015\150055\99999\roadway\sheet\sheet\99999CP006.dgn 11/13/2015 10:03:59 AM arichard.s

 - PROP OVERLAY LIMITS

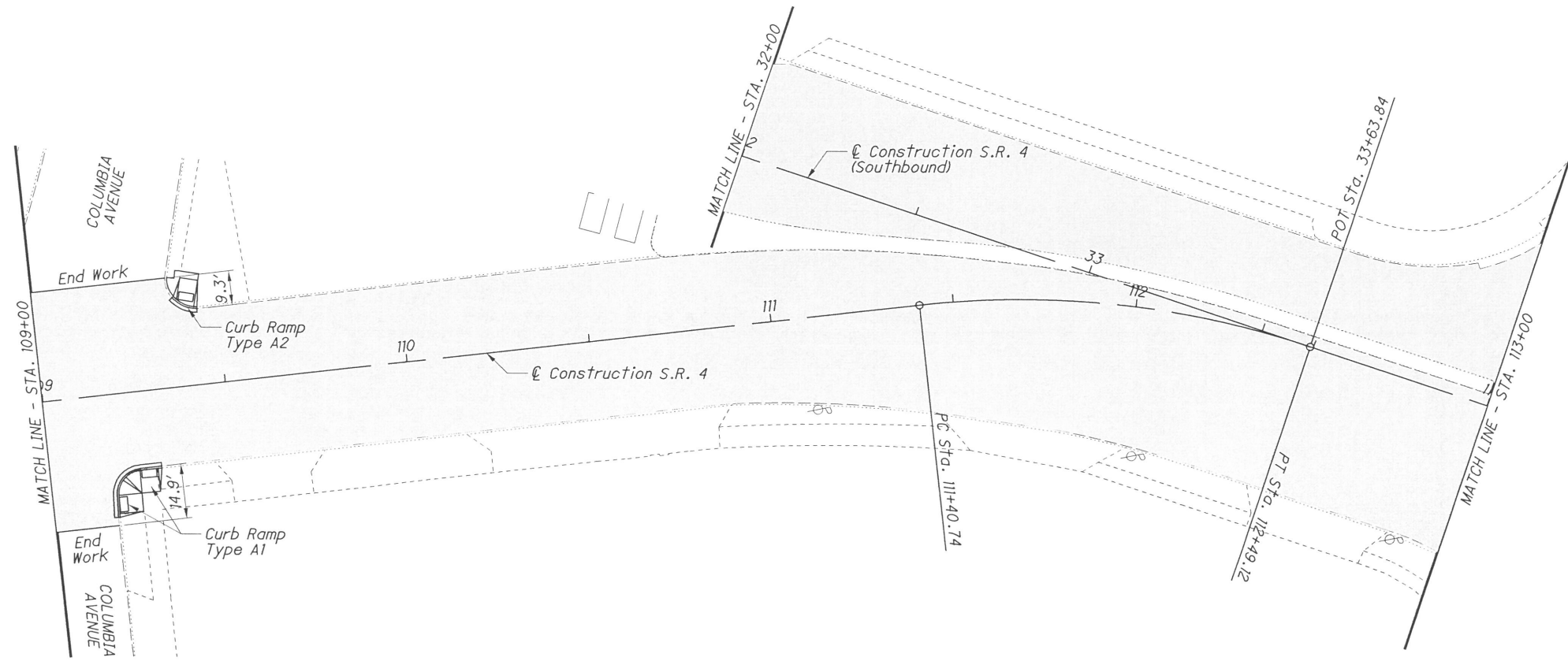

ROUTE	STATION		LENGTH		PAVEMENT WIDTH FEET	TYPICAL SECTION	EXISTING PAVEMENT TYPE	PAVEMENT AREA SQ YD	202	202	202	254	254	301	304	407	407	441	441	608	608	608	608	608	609		
	FROM	TO	MILES	FEET					PAVEMENT REMOVED SQ YD	WALK REMOVED SQ FT	CURB REMOVED FT	PAVEMENT PLANING ASPHALT CONCRETE, AS PER PLAN SQ YD	PATCHING PLANED SURFACE SQ YD	ASPHALT CONCRETE BASE, PG64-22 CU YD	AGGREGATE BASE CU YD	TACK COAT GAL	TACK COAT FOR INTERMEDIATE COURSE GAL	ASPHALT CONCRETE SURFACE COURSE, TYPE 1, (448) CU YD	ASPHALT CONCRETE INTERMEDIATE COURSE, TYPE 2, (448) CU YD	4" CONCRETE WALK SQ FT	CURB RAMP, TYPE A1 SQ FT	CURB RAMP, TYPE A2 SQ FT	CURB RAMP, TYPE C1 SQ FT	DETECTABLE WARNING SQ FT	CURB, TYPE 6 FT		
SR 4	109+00	113+00	0.076	400	+/-42 TO +/-44	1	ASPHALT	2617	3	157	31	2617	26	0.96	0.57	196	105	91	127	23	112	44					
TOTALS THIS SHEET CARRIED TO SHEET 22								3	157	31	2617	26	0.96	0.57	196	105	91	127	23	112	44						

RESURFACING PLAN
STA. 109+00 - STA. 113+00

BUT -4/ 4D-60.64 / 0.00

12
34

CALCULATED
SJB
CHECKED
YSY

0 20 40
10
HORIZONTAL
SCALE IN FEET

H:\2015\150055\99999\roadway\sheet\99999\F007.dgn 11/13/2015 10:04:08 AM arichards

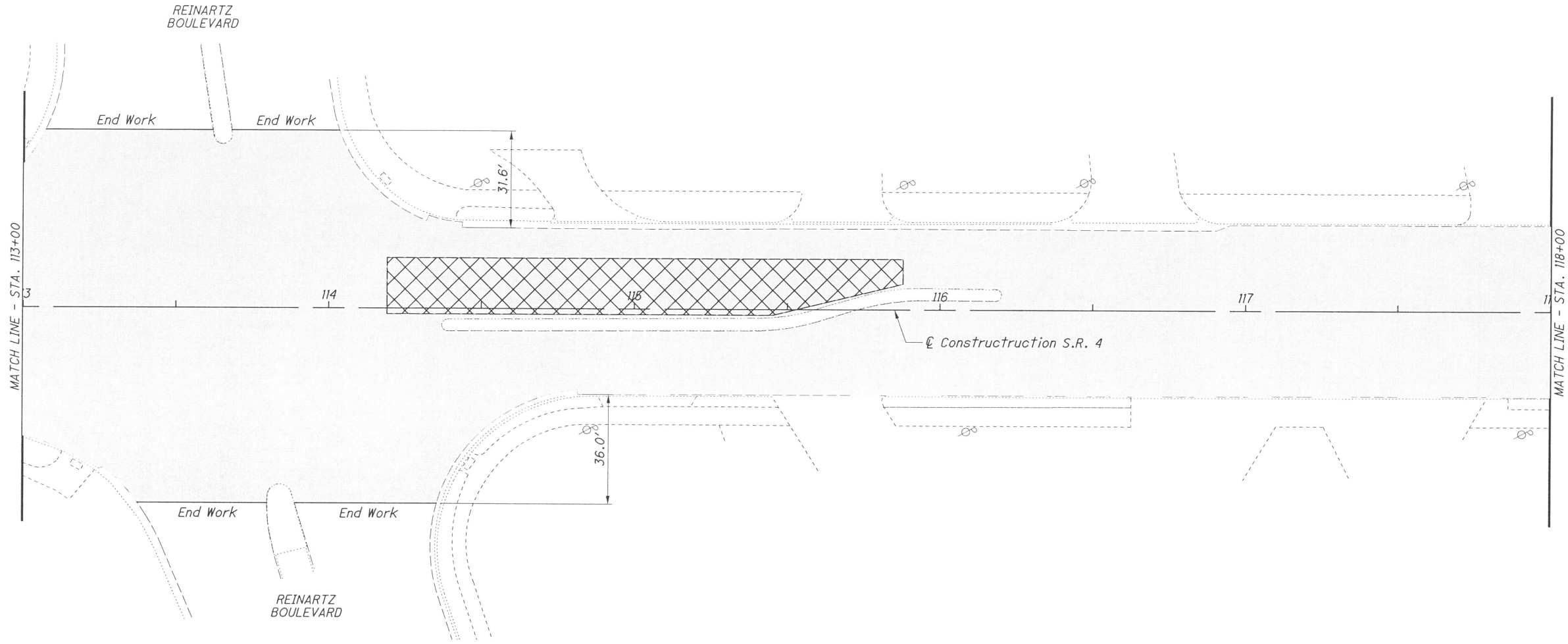

- PROP OVERLAY LIMITS
 - PAVEMENT REPAIR LOCATION

ROUTE	STATION		LENGTH		PAVEMENT WIDTH FEET	TYPICAL SECTION	EXISTING PAVEMENT TYPE	PAVEMENT AREA SQ YD	202	202	202	254	254	301	304	407	407	441	441	608	608	608	608	608	609
	FROM	TO	MILES	FEET					PAVEMENT REMOVED SQ YD	WALK REMOVED SQ FT	CURB REMOVED FT	PAVEMENT PLANING ASPHALT CONCRETE, AS PER PLAN SQ YD	PATCHING PLANED SURFACE SQ YD	ASPHALT CONCRETE BASE, PG64-22 CU YD	AGGREGATE BASE CU YD	TACK COAT GAL	TACK COAT FOR INTERMEDIATE COURSE GAL	ASPHALT CONCRETE SURFACE COURSE, TYPE 1, (448) CU YD	ASPHALT CONCRETE INTERMEDIATE COURSE, TYPE 2, (448) CU YD	4" CONCRETE WALK SQ FT	CURB RAMP, TYPE A1 SQ FT	CURB RAMP, TYPE A2 SQ FT	CURB RAMP, TYPE C1 SQ FT	DETECTABLE WARNING SQ FT	CURB, TYPE 6 FT
SR 4	113+00	118+00	0.095	500	+/-54 TO +/-56	1	ASPHALT	3880				3880	39			291	155	135	189						
TOTALS THIS SHEET CARRIED TO SHEET 22												3880	39				291	155	135	189					

RESURFACING PLAN

STA. 113+00 - STA. 118+00

BUT -4/ 4D -60.64 / 0.00

13
34

CALCULATED SUB CHECKED YSY

- PROP OVERLAY LIMITS
 - PAVEMENT REPAIR LOCATION

- PROP OVERLAY LIMITS
 - PAVEMENT REPAIR LOCATION

- PROP OVERLAY LIMITS
 - PAVEMENT REPAIR LOCATION

- PROP OVERLAY LIMITS
 - PAVEMENT REPAIR LOCATION

- PROP OVERLAY LIMITS
 - PAVEMENT REPAIR LOCATION

- PROP OVERLAY LIMITS
 - PAVEMENT REPAIR LOCATION

- PROP OVERLAY LIMITS
 - PAVEMENT REPAIR LOCATION

- PROP OVERLAY LIMITS
 - PAVEMENT REPAIR LOCATION

- PROP OVERLAY LIMITS
 - PAVEMENT REPAIR LOCATION

- PROP OVERLAY LIMITS
 - PAVEMENT REPAIR LOCATION

- PROP OVERLAY LIMITS
 - PAVEMENT REPAIR LOCATION

- PROP OVERLAY LIMITS
 - PAVEMENT REPAIR LOCATION

- PROP OVERLAY LIMITS
 - PAVEMENT REPAIR LOCATION

- PROP OVERLAY LIMITS
 - PAVEMENT REPAIR LOCATION

- PROP OVERLAY LIMITS
 - PAVEMENT REPAIR LOCATION

- PROP OVERLAY LIMITS
 - PAVEMENT REPAIR LOCATION

- PROP OVERLAY LIMITS
 - PAVEMENT REPAIR LOCATION

- PROP OVERLAY LIMITS
 - PAVEMENT REPAIR LOCATION

- PROP OVERLAY LIMITS
 - PAVEMENT REPAIR LOCATION

- PROP OVERLAY LIMITS
 - PAVEMENT REPAIR LOCATION

- PROP OVERLAY LIMITS
 - PAVEMENT REPAIR LOCATION

- PROP OVERLAY LIMITS
 - PAVEMENT REPAIR LOCATION

- PROP OVERLAY LIMITS
 - PAVEMENT REPAIR LOCATION

- PROP OVERLAY LIMITS
 - PAVEMENT REPAIR LOCATION

- PROP OVERLAY LIMITS
 - PAVEMENT REPAIR LOCATION

- PROP OVERLAY LIMITS
 - PAVEMENT REPAIR LOCATION

- PROP OVERLAY LIMITS
 - PAVEMENT REPAIR LOCATION

- PROP OVERLAY LIMITS
 - PAVEMENT REPAIR LOCATION

- PROP OVERLAY LIMITS
 - PAVEMENT REPAIR LOCATION

- PROP OVERLAY LIMITS
 - PAVEMENT REPAIR LOCATION

- PROP OVERLAY LIMITS
 - PAVEMENT REPAIR LOCATION

- PROP OVERLAY LIMITS
 - PAVEMENT REPAIR LOCATION

- PROP OVERLAY LIMITS
 - PAVEMENT REPAIR LOCATION

- PROP OVERLAY LIMITS
 - PAVEMENT REPAIR LOCATION

- PROP OVERLAY LIMITS
 - PAVEMENT REPAIR LOCATION

- PROP OVERLAY LIMITS
 - PAVEMENT REPAIR LOCATION

- PROP OVERLAY LIMITS
 - PAVEMENT REPAIR LOCATION

- PROP OVERLAY LIMITS
 - PAVEMENT REPAIR LOCATION

- PROP OVERLAY LIMITS
 - PAVEMENT REPAIR LOCATION

- PROP OVERLAY LIMITS
 - P

H:\2015\150055\99999\roadway\sheet\99999\F006.dgn 11/13/2015 10:04:16 AM arichards

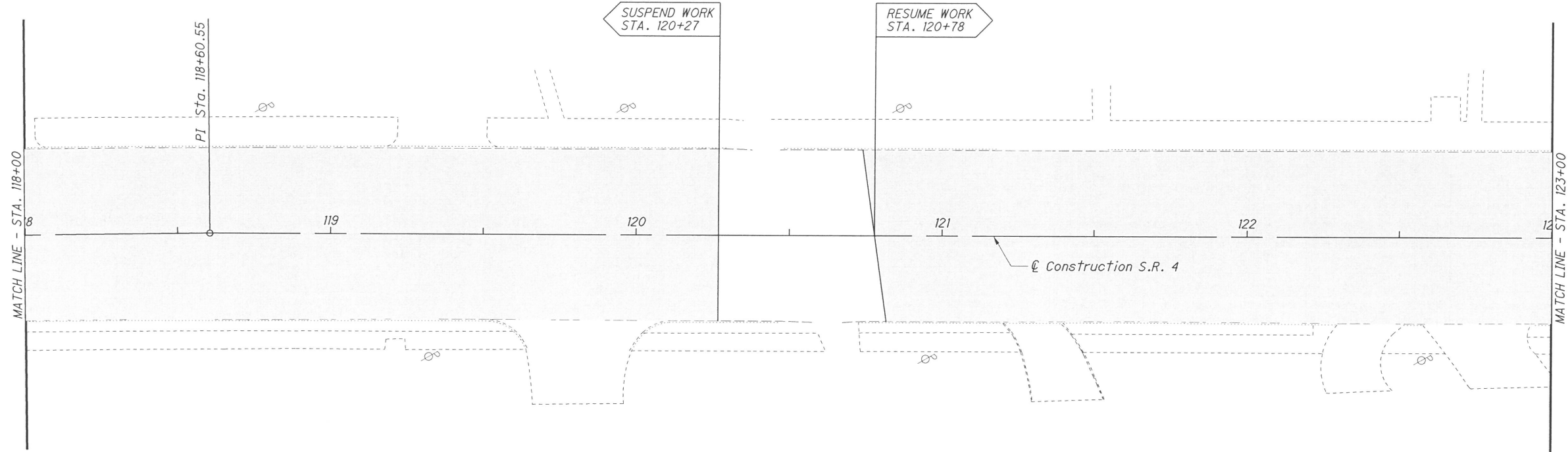

- PROP OVERLAY LIMITS

ROUTE	STATION		LENGTH		PAVEMENT WIDTH FEET	TYPICAL SECTION	EXISTING PAVEMENT TYPE	PAVEMENT AREA SQ YD	202	202	202	254	254	301	304	407	407	441	441	608	608	608	608	608	609	
	FROM	TO	MILES	FEET					PAVEMENT REMOVED SQ YD	WALK REMOVED SQ FT	CURB REMOVED FT	PAVEMENT PLANING ASPHALT CONCRETE, AS PER PLAN SQ YD	PATCHING PLANED SURFACE SQ YD	ASPHALT CONCRETE BASE, P664-22 CU YD	AGGREGATE BASE CU YD	TACK COAT GAL	TACK COAT FOR INTERMEDIATE COURSE GAL	ASPHALT CONCRETE SURFACE COURSE, TYPE 1, (448) CU YD	ASPHALT CONCRETE INTERMEDIATE COURSE, TYPE 2, (448) CU YD	4" CONCRETE WALK SQ FT	CURB RAMP, TYPE A1 SQ FT	CURB RAMP, TYPE A2 SQ FT	CURB RAMP, TYPE C1 SQ FT	DETECTABLE WARNING SQ FT	CURB, TYPE 6 FT	
SR 4	118+00	120+27	0.043	227	+/-56	1	ASPHALT	1414				1414	14		106	57	49	69								
SR 4	120+78	123+00	0.042	222	+/-56	1	ASPHALT	1383				1383	69		104	55	48	67								
TOTALS THIS SHEET CARRIED TO SHEET 22												2797	83			210	112	97	136							

RESURFACING PLAN
STA. 118+00 - STA. 123+00

BUT-4/4D-60.64/0.00

14
34

CALCULATED
SUB
CHECKED
YSY

0 20 40
HORIZONTAL
SCALE IN FEET

H:\2015\150055\99999\roadway\sheet\99999\F009.dgn 11/13/2015 10:04:27 AM arichards

 - PROP OVERLAY LIMITS

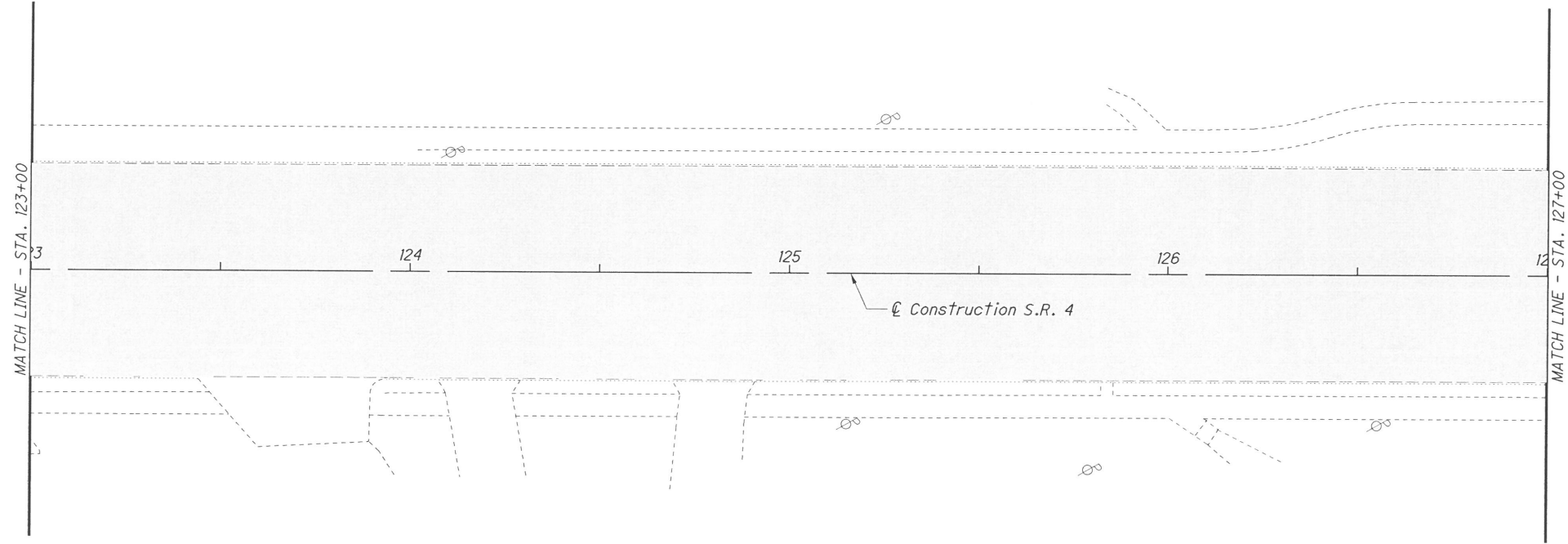

ROUTE	STATION		LENGTH		PAVEMENT WIDTH FEET	TYPICAL SECTION	EXISTING PAVEMENT TYPE	PAVEMENT AREA	PAVEMENT REMOVED												PAVEMENT PLANNING					
	FROM	TO	MILES	FEET					SQ YD	SQ YD	SQ FT	FT	SQ YD	SQ YD	CU YD	CU YD	GAL	GAL	CU YD	CU YD	SQ FT	SQ FT	SQ FT	SQ FT	SQ FT	FT
SR 4	123+00	127+00	0.076	400	+/-56	1	ASPHALT	2492	202	202	202	254	254	301	304	407	407	441	441	608	608	608	608	608	609	
TOTALS THIS SHEET CARRIED TO SHEET 22											2492	25					187	100	87	121						

CALCULATED
SUB
CHECKED
YSY



HORIZONTAL SCALE IN FEET

RESURFACING PLAN
STA. 123+00 - STA. 127+00

H:\2015\150055\99999\roadway\sheets\99999\PO10.dgn 11/13/2015 10:04:44 AM arichards

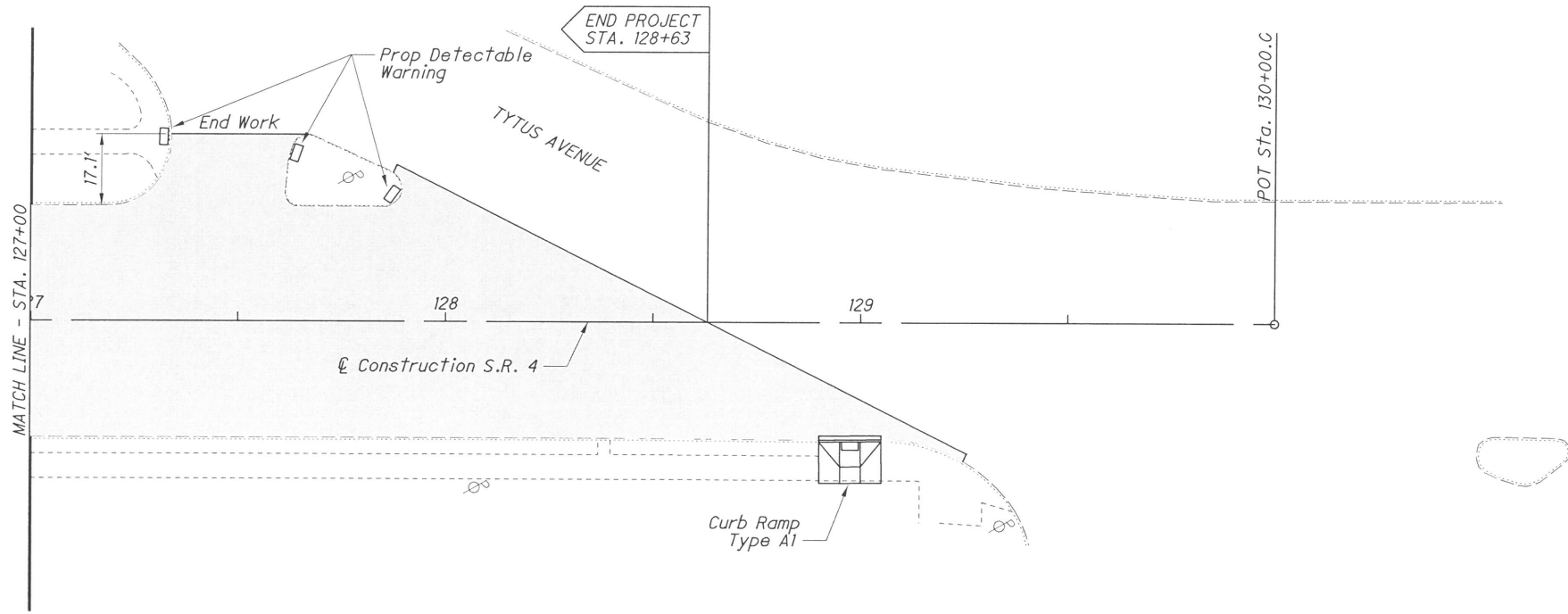

 - PROP OVERLAY LIMITS

ROUTE	STATION		LENGTH		PAVEMENT WIDTH FEET	TYPICAL SECTION	EXISTING PAVEMENT TYPE	PAVEMENT AREA SQ YD	202	202	202	254	254	301	304	407	407	441	441	608	608	608	608	608	609
	FROM	TO	MILES	FEET					PAVEMENT REMOVED SQ YD	WALK REMOVED SQ FT	CURB REMOVED FT	PAVEMENT PLANING ASPHALT CONCRETE, AS PER PLAN SQ YD	PATCHING PLANED SURFACE SQ YD	ASPHALT CONCRETE BASE, PG64-22 CU YD	AGGREGATE BASE CU YD	TACK COAT GAL	TACK COAT FOR INTERMEDIATE COURSE GAL	ASPHALT CONCRETE SURFACE COURSE, TYPE 1, (448) CU YD	ASPHALT CONCRETE INTERMEDIATE COURSE, TYPE 2, (448) CU YD	4" CONCRETE WALK SQ FT	CURB RAMP, TYPE A1 SQ FT	CURB RAMP, TYPE A2 SQ FT	CURB RAMP, TYPE C1 SQ FT	DETECTABLE WARNING SQ FT	CURB, TYPE 6 FT
SR 4	127+00	128+63	0.031	163	+/-56	1	ASPHALT	1087	2	141	15	1087	11	0.46	0.28	82	43	38	53	70	88			24	
TOTALS THIS SHEET CARRIED TO SHEET 22									2	141	15	1087	11	0.46	0.28	82	43	38	53	70	88			24	

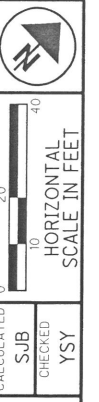

RESURFACING PLAN
STA. 127+00 - END PROJECT

BUT -4/ 4D -60.64 / 0.00

H:\2015\150055\99999\roadway\sheet\99999\99999.dgn 11/13/2015 10:04:52 AM arichards

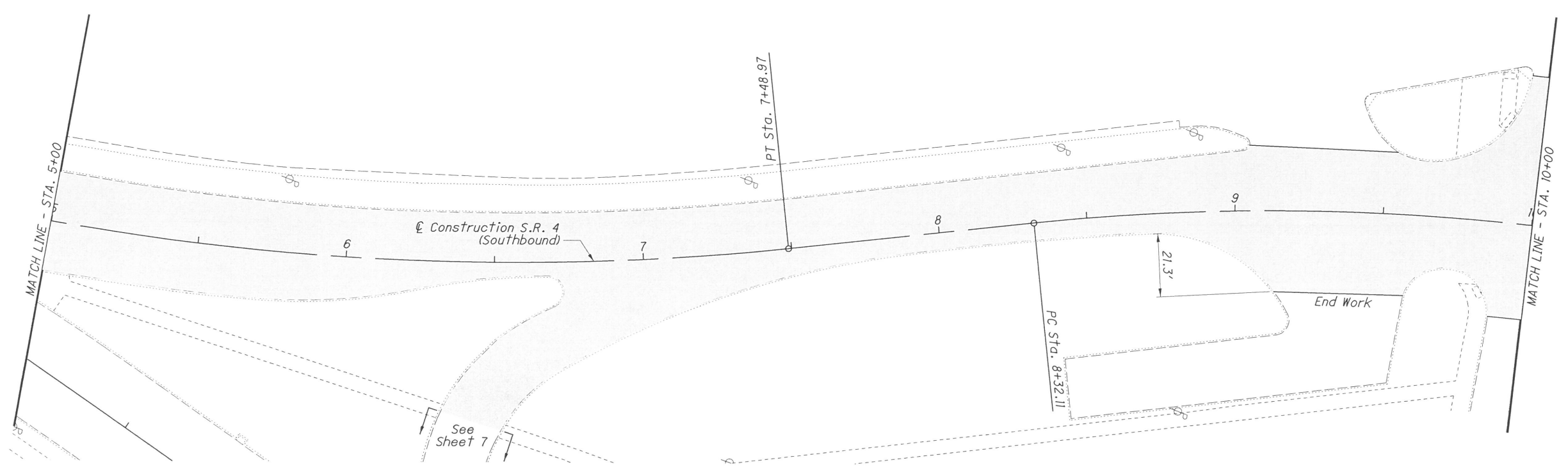

 - PROP OVERLAY LIMITS

ROUTE	STATION		LENGTH		PAVEMENT WIDTH FEET	TYPICAL SECTION	EXISTING PAVEMENT TYPE	PAVEMENT AREA SQ YD	202	202	202	254	254	301	304	407	407	441	441	608	608	608	608	608	609
	FROM	TO	MILES	FEET					PAVEMENT REMOVED SQ YD	WALK REMOVED SQ FT	CURB REMOVED FT	PAVEMENT PLANING ASPHALT CONCRETE, AS PER PLAN SQ YD	PATCHING PLANED SURFACE SQ YD	ASPHALT CONCRETE BASE, P664-22 CU YD	AGGREGATE BASE CU YD	TACK COAT GAL	TACK COAT FOR INTERMEDIATE COURSE GAL	ASPHALT CONCRETE SURFACE COURSE, TYPE 1, (448) CU YD	ASPHALT CONCRETE INTERMEDIATE COURSE, TYPE 2, (448) CU YD	4" CONCRETE WALK SQ FT	CURB RAMP, TYPE A1 SQ FT	CURB RAMP, TYPE A2 SQ FT	CURB RAMP, TYPE C1 SQ FT	DETECTABLE WARNING SQ FT	CURB, TYPE 6 FT
SR 4	5+00	10+00	0.095	500	+/-21 TO +/-34	1	ASPHALT	1913				1913	19			143	77	66	93						
TOTALS THIS SHEET CARRIED TO SHEET 22												1913	19			143	77	66	93						

RESURFACING PLAN
STA. 5+00 - STA. 10+00

BUT -4/ 4D -60.64 / 0.00

17
34

CALCULATED
SUB
CHECKED
YSY

0 20 40
HORIZONTAL
SCALE IN FEET

H:\2015\150055\99999\roadway\sheet\99999CP014.dgn 11/13/2015 10:05:20 AM arichards

 - PROP OVERLAY LIMITS

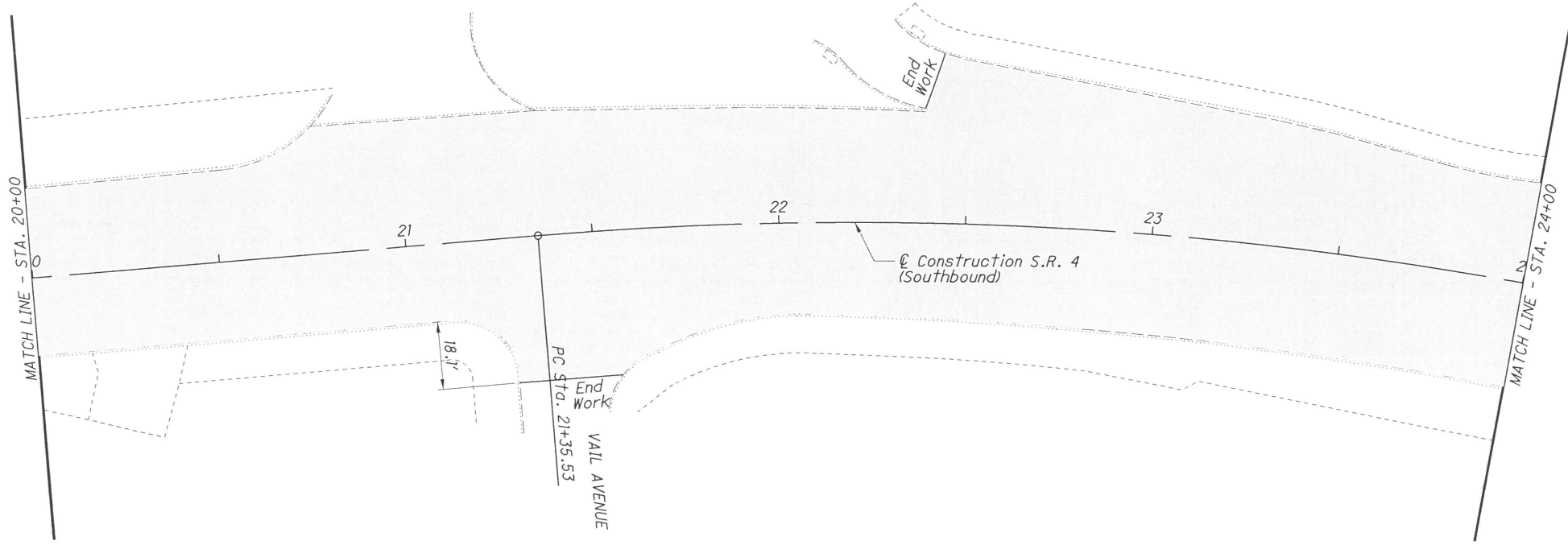

ROUTE	STATION		LENGTH		PAVEMENT WIDTH FEET	TYPICAL SECTION	EXISTING PAVEMENT TYPE	PAVEMENT AREA SQ YD	202	202	202	254	254	301	304	407	407	441	441	608	608	608	608	608	609
	FROM	TO	MILES	FEET					PAVEMENT REMOVED SQ YD	WALK REMOVED SQ FT	CURB REMOVED FT	PAVEMENT PLANING ASPHALT CONCRETE, AS PER PLAN SQ YD	PATCHING PLANED SURFACE SQ YD	ASPHALT CONCRETE BASE, PG64-22 CU YD	AGGREGATE BASE CU YD	TACK COAT GAL	TACK COAT FOR INTERMEDIATE COURSE GAL	ASPHALT CONCRETE SURFACE COURSE, TYPE 1, (448) CU YD	ASPHALT CONCRETE INTERMEDIATE COURSE, TYPE 2, (448) CU YD	4" CONCRETE WALK SQ FT	CURB RAMP, TYPE A1 SQ FT	CURB RAMP, TYPE A2 SQ FT	CURB RAMP, TYPE C1 SQ FT	DETECTABLE WARNING SQ FT	CURB, TYPE 6 FT
SR 4	20+00	24+00	0.076	400	+/-45 TO +/-70	1	ASPHALT	2576				2576	26			193	103	89	125						
TOTALS THIS SHEET CARRIED TO SHEET 22												2576	26			193	103	89	125						

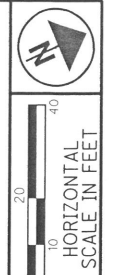

CALCULATED
SUB
CHECKED
YSY

RESURFACING PLAN
STA. 20+00 - STA. 24+00

BUT -4/ 4D -60.64 / 0.00

H:\2015\150055\99999\roadway\sheet\99999CP016.dgn 11/13/2015 10:05:37 AM arichards

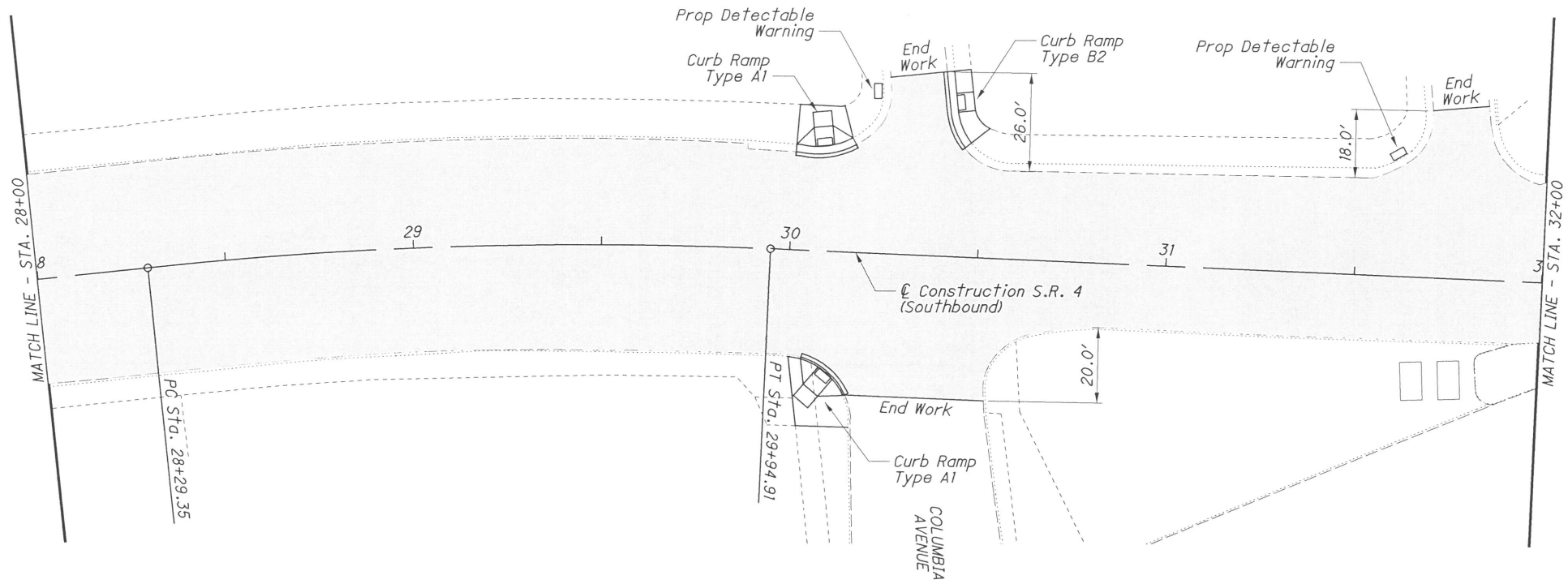

ROUTE	STATION		LENGTH		PAVEMENT WIDTH FEET	TYPICAL SECTION	EXISTING PAVEMENT TYPE	PAVEMENT AREA SQ YD	202	202	202	254	254	301	304	407	407	441	441	608	608	608	608	608	608	609
	FROM	TO	MILES	FEET					PAVEMENT REMOVED SQ YD	WALK REMOVED SQ FT	CURB REMOVED FT	PAVEMENT PLANING ASPHALT CONCRETE, AS PER PLAN SQ YD	PATCHING PLANED SURFACE SQ YD	ASPHALT CONCRETE BASE, PG64-22 CU YD	AGGREGATE BASE CU YD	TACK COAT GAL	TACK COAT FOR INTERMEDIATE COURSE GAL	ASPHALT CONCRETE SURFACE COURSE, TYPE 1, (448) CU YD	ASPHALT CONCRETE INTERMEDIATE COURSE, TYPE 2, (448) CU YD	4" CONCRETE WALK SQ FT	CURB RAMP, TYPE A1 SQ FT	CURB RAMP, TYPE A2 SQ FT	CURB RAMP, TYPE B2 SQ FT	CURB RAMP, TYPE C1 SQ FT	DETECTABLE WARNING SQ FT	CURB, TYPE 6 FT
SR 4	28+00	32+00	0.076	400	+/-41 TO +/-56	1	ASPHALT	2386	6	311	53	2386	24	1.64	0.98	179	95	83	116	203	193		129	16		
	SHEET 7											2975	30			223	119	103	145							
	SHEET 8											2462	25			185	98	85	120					64		
	SHEET 9							1	24	11	2575	26	0.34	0.20	193	103	89	125		29				48		
	SHEET 10							9	558	80	2553	26	2.47	1.48	191	102	89	124	172	208	35		183	16	5	
	SHEET 11										2361	24			177	94	82	115								
	SHEET 12							3	157	31	2617	26	0.96	0.57	196	105	91	127	23	112	44					
	SHEET 13										3880	39			291	155	135	189								
	SHEET 14										2797	83			210	112	97	136								
	SHEET 15										2492	25			187	100	87	121								
	SHEET 16							2	141	15	1087	11	0.46	0.28	82	43	38	53	70	88				24		
	SHEET 17										1913	19			143	77	66	93								
	SHEET 18							3	134	29	2442	24	0.90	0.54	183	98	85	119	26	122				24		
	SHEET 19										2581	26			194	103	90	125							56	
	SHEET 20										2576	26			193	103	89	125								
	SHEET 21							2	72	16	2698	27	0.49	0.30	202	108	94	131		79				8		
TOTALS CARRIED TO GENERAL SUMMARY									26	1397	235	40395	461	8	5	3029	1615	1403	1964	494	831	79	129	183	256	5

0 20 40
HORIZONTAL SCALE IN FEET

CALCULATED
SUB
CHECKED
YSY

RESURFACING PLAN
STA. 28+00 - STA. 32+00

BUT-4/4D-60.64/0.00

22
34

H:\2015\150055\99999\roadway\sheet\99999TS003.dgn 11/13/2015 10:06:16 AM arichards

SHEET NO.	REFERENCE NO.	LOCATION	STATION		SIDE	644																	
			FROM	TO		EDGE LINE, 4"	LANE LINE, 4"	CENTER LINE (DOUBLE SOLID)	CENTER LINE (SOLID DASHED)	CHANNELIZING LINE	STOP LINE	CROSSWALK LINE	TRANSVERSE/DIAGONAL LINE	RAILROAD SYMBOL MARKING	LANE ARROW	WORD ON PAVEMENT, 72"							
						MILE	MILE	MILE	MILE	FT	FT	FT	FT	EACH	EACH	EACH							
30	SL-9	C/L Const. S.R. 4	113+01	113+10	RT						50												
30	SL-10	REINARTZ BOULEVARD									53												
30	SL-11	REINARTZ BOULEVARD									48												
30	SL-12	C/L Const. S.R. 4	114+30	114+39	LT						34												
30	SL-13	C/L Const. S.R. 4	120+19		RT						23												
30	SL-14	C/L Const. S.R. 4	120+86		LT						23												
31	SL-15	C/L Const. S.R. 4	128+12	128+80	RT						77												
32	SL-16	2ND AVENUE									16												
32	SL-17	C/L Const. South S.R. 4	14+11	14+24							55												
33	SL-18	C/L Const. South S.R. 4	19+30								51												
34	SL-19	C/L Const. South S.R. 4	25+09								56												
34	SL-20	COLUMBIA AVENUE									16												
31	SL-21	C/L Const. S.R. 4	127+89		LT						3												
27	CW-1	C/L Const. S.R. 4	83+96	84+08																			
27	CW-2	C/L Const. S.R. 4	83+96	4+67	LT							128											
27	CW-3	C/L Const. S.R. 4	84+08	84+76	RT							133											
27	CW-4	C/L Const. S.R. 4	92+86									109											
27	CW-5	1ST AVENUE										85											
												80											
27	CW-6	C/L Const. S.R. 4	93+47									87											
27	CW-7	1ST AVENUE										81											
28	CW-8	C/L Const. S.R. 4	98+02									87											
28	CW-9	CENTRAL AVENUE										90											
28	CW-10	CENTRAL AVENUE										91											
28	CW-11	C/L Const. S.R. 4	98+64									87											
28	CW-12	C/L Const. S.R. 4	102+88	102+98								89											
28	CW-13	MANCHESTER AVENUE										98											
28	CW-14	C/L Const. S.R. 4	103+56	103+71								98											
28	CW-15	MANCHESTER AVENUE										86											
29	CW-16	C/L Const. S.R. 4	108+63	108+77								89											
29	CW-17	COLUMBIA AVENUE										61											
29	CW-18	C/L Const. S.R. 4	109+31	109+46								92											
30	CW-19	C/L Const. S.R. 4	113+08	113+25								186											
30	CW-20	C/L Const. S.R. 4	113+08	114+12	LT							208											
30	CW-21	C/L Const. S.R. 4	113+25	114+35	RT							220											
30	CW-22	C/L Const. S.R. 4	114+12	114+35								165											
31	CW-23	C/L Const. S.R. 4	127+89	129+09								259											
32	CW-24	C/L Const. South S.R. 4	9+81	10+27	RT							83											
32	CW-25	C/L Const. South S.R. 4	9+87	10+34	LT							94											
32	CW-26	C/L Const. South S.R. 4	10+27	10+34								98											
32	CW-27	C/L Const. South S.R. 4	13+49									77											
32	CW-28	C/L Const. South S.R. 4	13+49	13+95	RT							86											
32	CW-29	C/L Const. South S.R. 4	13+49	14+08	LT							120											
32	CW-30	C/L Const. South S.R. 4	13+95	14+08								114											
33	CW-31	C/L Const. South S.R. 4	18+59									88											
33	CW-32	CENTRAL AVENUE										93											
33	CW-33	C/L Const. South S.R. 4	19+25									109											
33	CW-34	CENTRAL AVENUE										89											
34	CW-35	C/L Const. South S.R. 4	24+49									149											
34	CW-36	C/L Const. South S.R. 4	24+49	24+93	LT							45											
34	CW-37	C/L Const. South S.R. 4	24+47	24+92	RT							87											
34	CW-38	C/L Const. South S.R. 4	24+93									125											
TOTALS CARRIED TO GENERAL SUMMARY											505	4166											

CALCULATED	SUB	CHECKED	YSY		
PAVEMENT MARKING SUBSUMMARY					
BUT -4/ 4D -60.64 / 0.00					
<table border="1"> <tr><td>25</td></tr> <tr><td>34</td></tr> </table>				25	34
25					
34					

H:\2015\150055\99999\roadway\sheet\99999TP001.dgn 11/13/2015 10:06:30 AM arichards

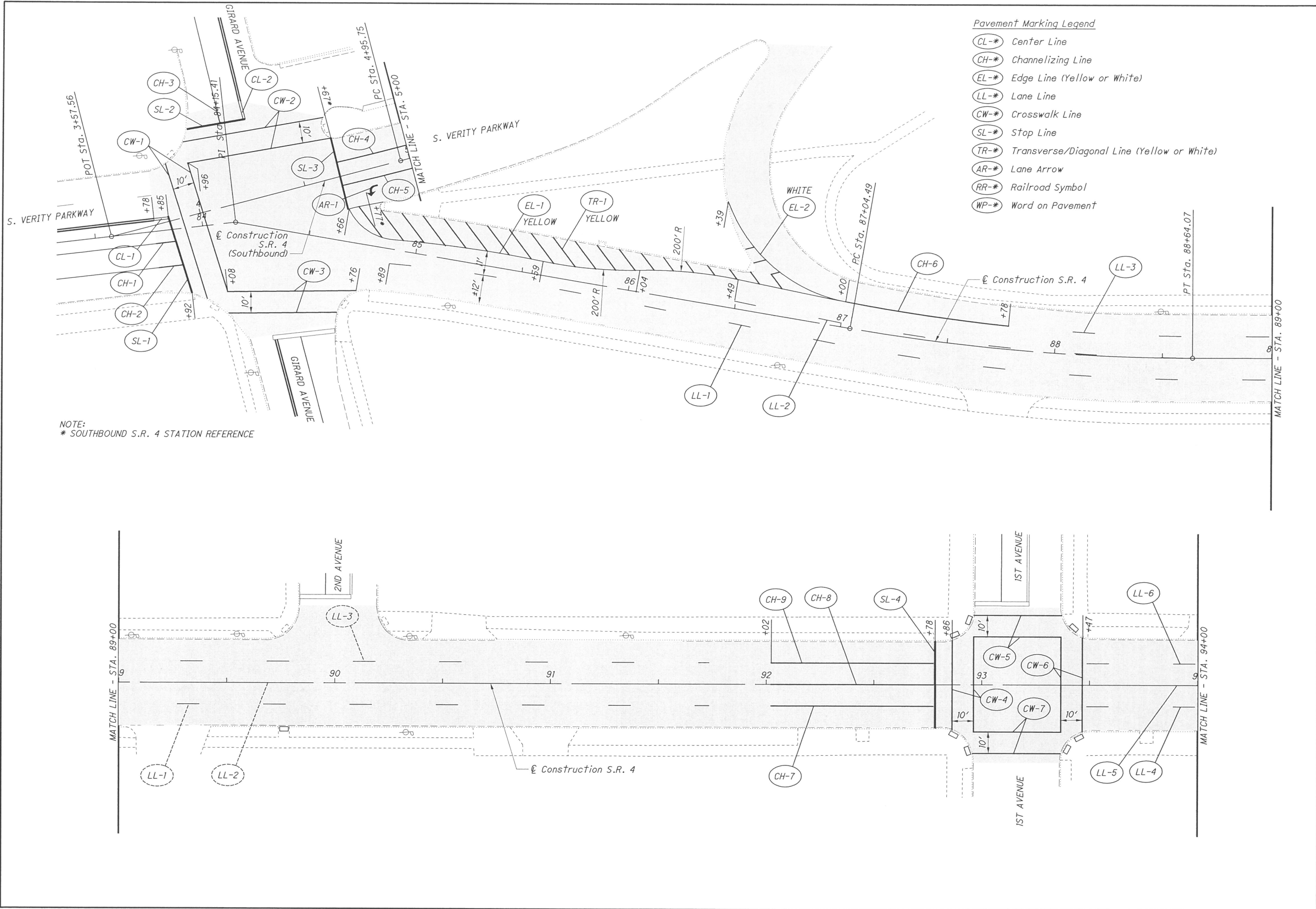

NOTE:
* SOUTHBOUND S.R. 4 STATION REFERENCE

- Pavement Marking Legend**
- CL-* Center Line
 - CH-* Channelizing Line
 - EL-* Edge Line (Yellow or White)
 - LL-* Lane Line
 - CW-* Crosswalk Line
 - SL-* Stop Line
 - TR-* Transverse/Diagonal Line (Yellow or White)
 - AR-* Lane Arrow
 - RR-* Railroad Symbol
 - WP-* Word on Pavement

CALCULATED
SUB
CHECKED
YSY

0 20 40
10
HORIZONTAL
SCALE IN FEET

N

**PAVEMENT MARKING PLAN
BEGIN PROJECT - STA. 94+00**

BUT -4/ 4D-60.64 / 0.00

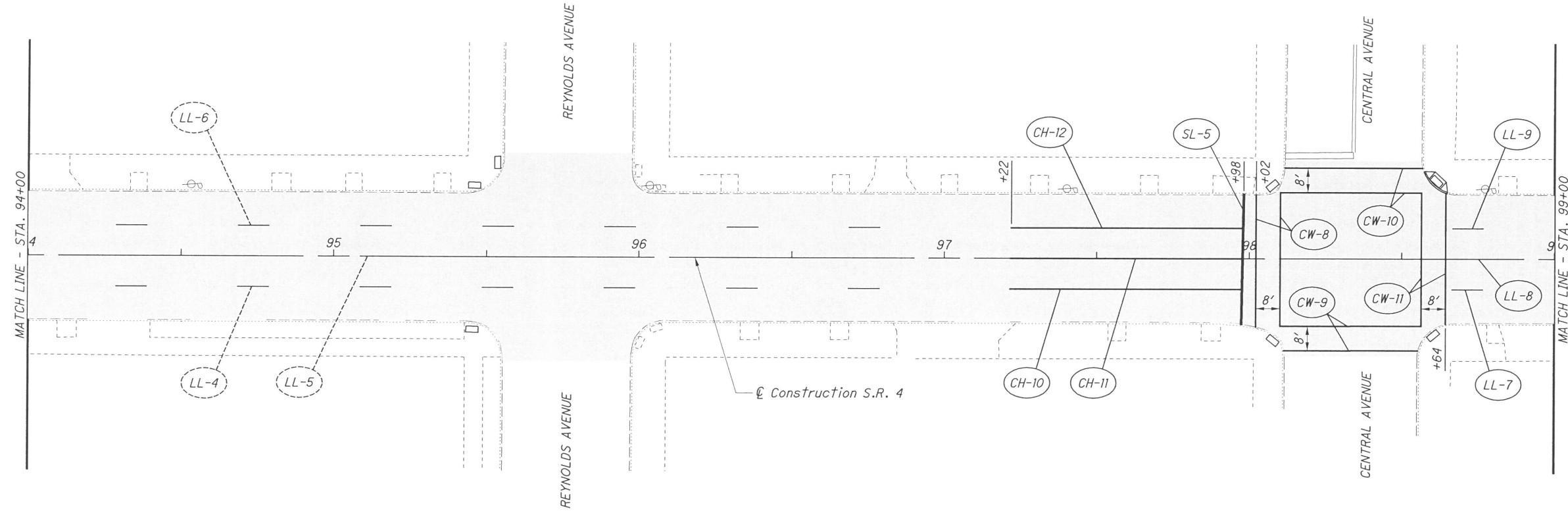
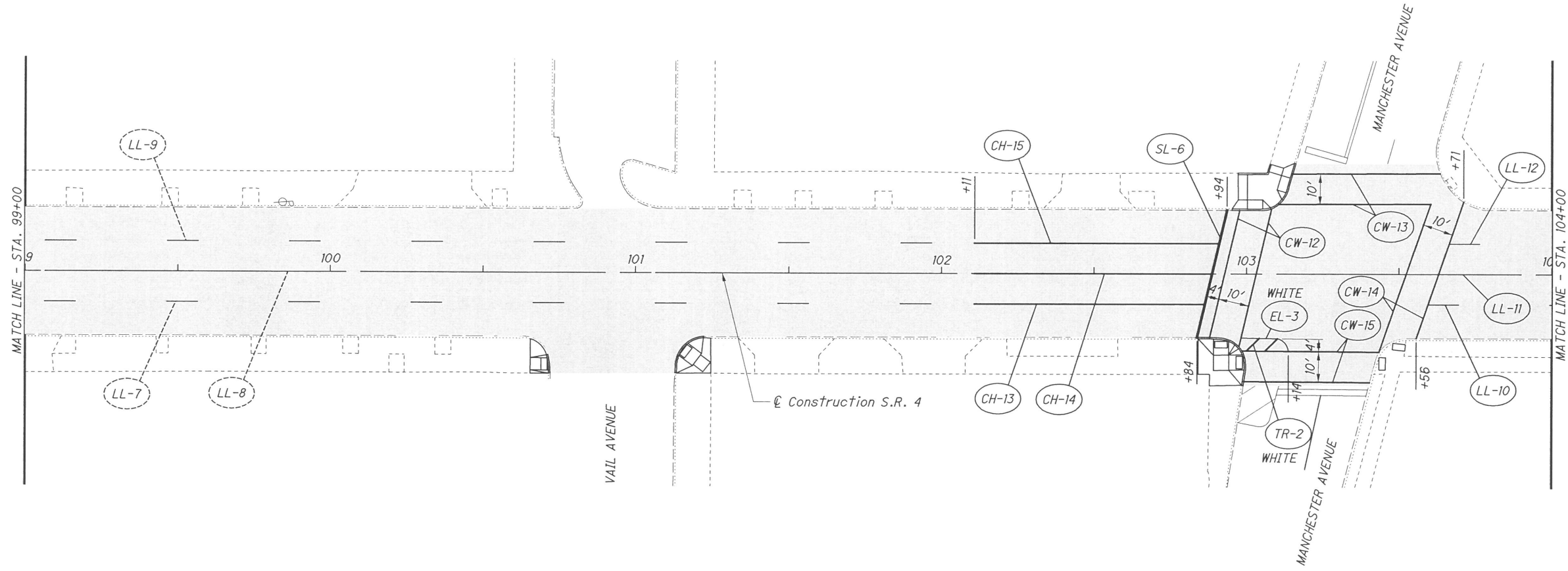

H:\2015\150055\roadway\sheet\99999\TP003.dgn 11/13/2015 10:06:46 AM arichards

NOTE:
* SOUTHBOUND S.R. 4 STATION REFERENCE

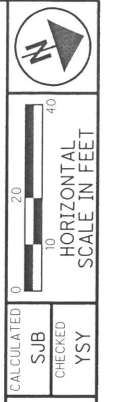
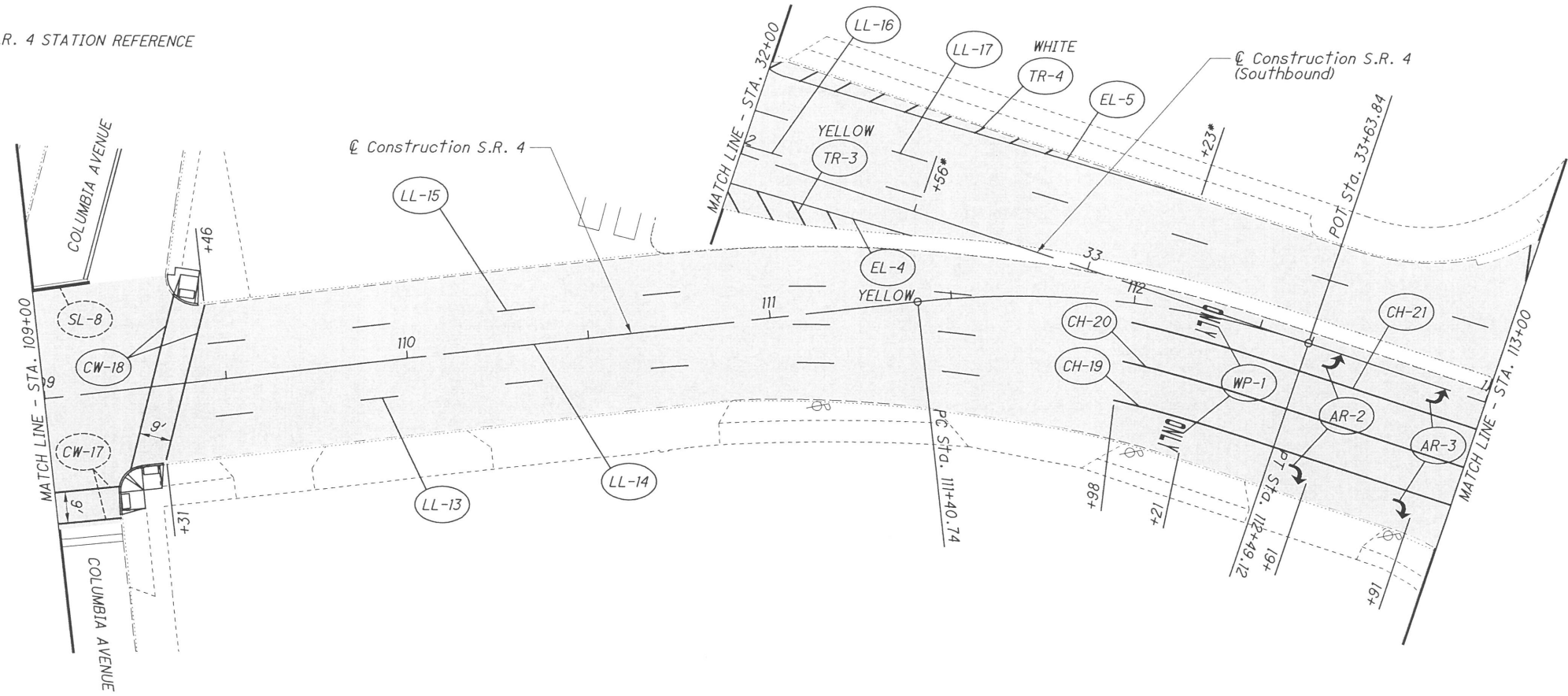
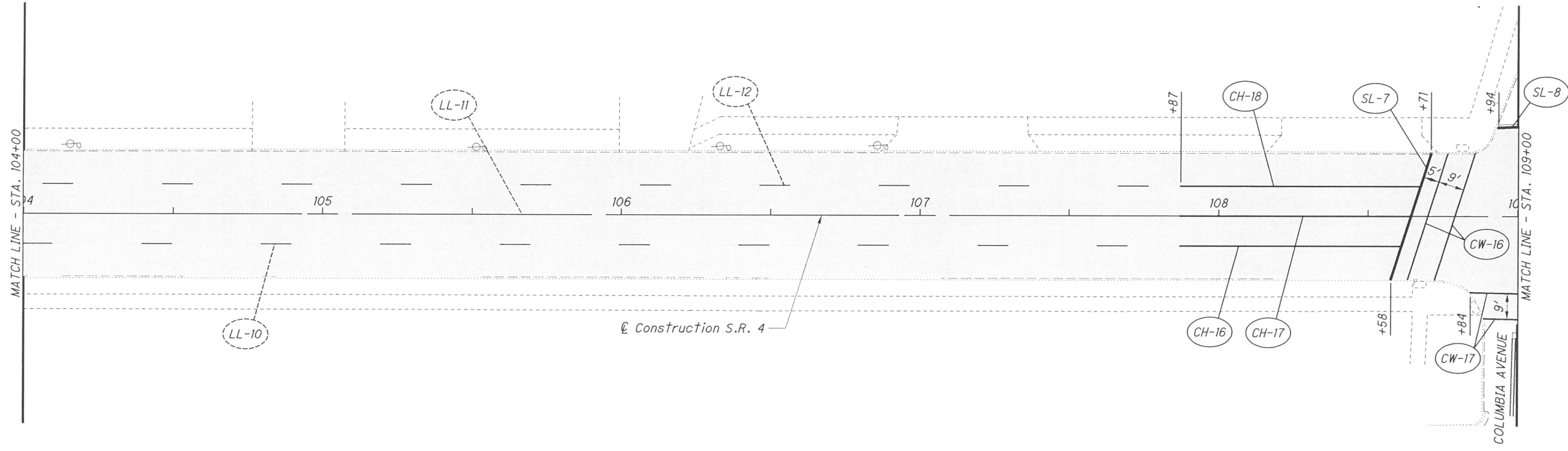

CALCULATED	0
SUB	
CHECKED	
YSY	

PAVEMENT MARKING PLAN
STA. 104+00 - STA. 113+00

BUT-4/4D-60.64/0.00

