

STATE OF OHIO DEPARTMENT OF TRANSPORTATION

CUY-BH-FY2023 MISC.

LOCATION	BRIDGE NO.	SFN	CITY
1	CUY-090-1062	1808249	CITY OF CLEVELAND
2	CUY-090-2910	1809008	CITY OF EUCLID
3	CUY-237-0827	1810332	CITY OF CLEVELAND
4	CUY-252-0434	1810405	CITY OF NORTH OLMSTED
5	CUY-271-1543	1811851	CITY OF HIGHLAND HEIGHTS
6	CUY-480-0446	1814109	CITY OF NORTH OLMSTED
7	CUY-480-0870-ES	1814249	CITY OF CLEVELAND

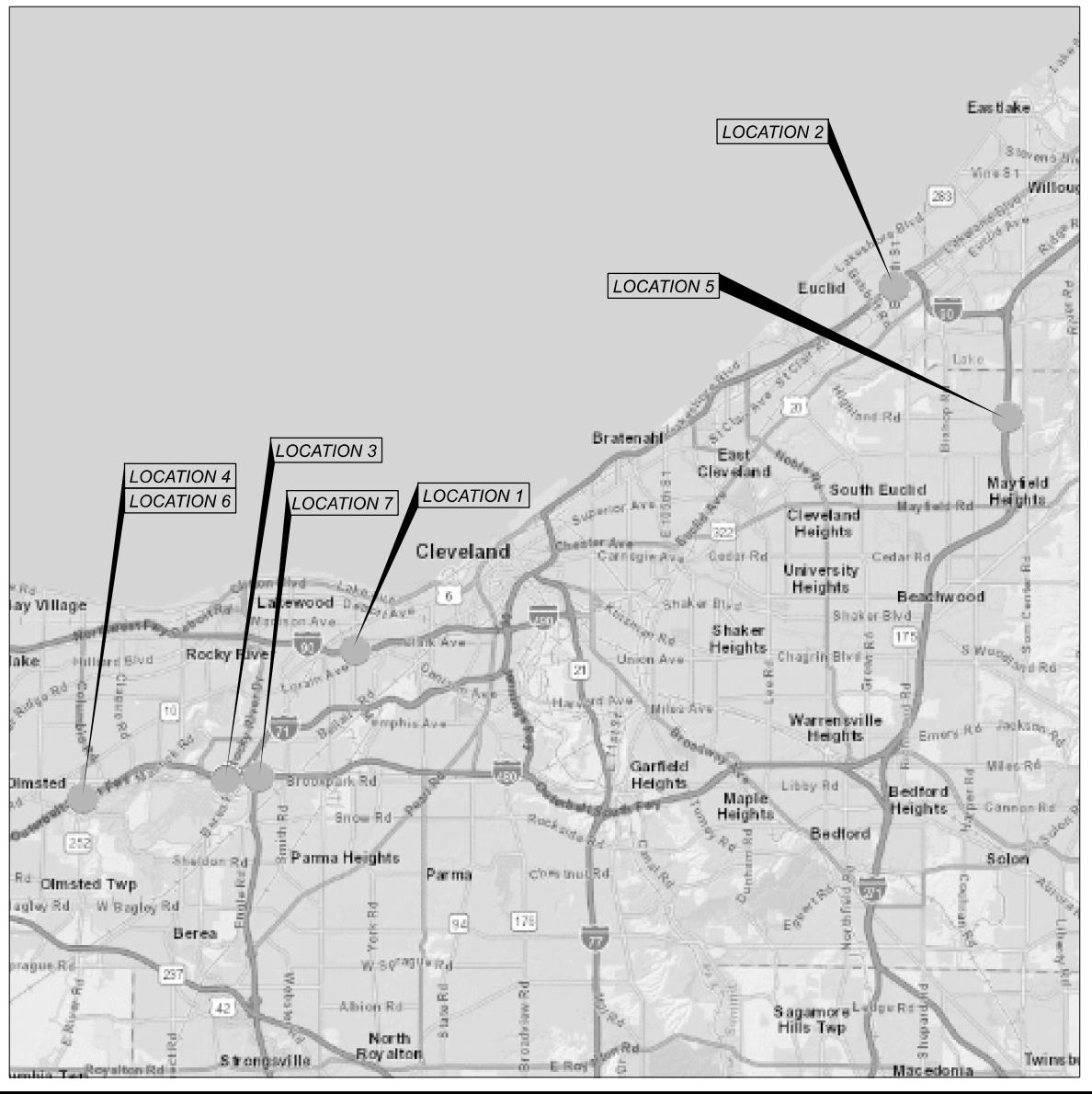

FEDERAL PROJECT NUMBER

FAN E200(055)

RAILROAD INVOLVEMENT

N/A

PROJECT DESCRIPTION

THIS PROJECT CONSISTS OF VARIOUS REPAIRS, INCLUDING ABUTMENT AND PIER PATCHING, PIER FIBER WRAP, CROSSFRAME REPLACEMENT, BEARING REPLACEMENT, APPROACH SLAB REPLACEMENT, PARAPET AND FENCE REPLACEMENT AND OTHER MISCELLANEOUS REPAIRS

EARTH DISTURBED AREAS

THIS IS A MAINTENANCE PROJECT.
PROJECT EARTH DISTURBED AREA: N/A ACRES
ESTIMATED CONTRACTOR EARTH DISTURBED AREA: N/A ACRES
NOTICE OF INTENT EARTH DISTURBED AREA: N/A ACRES

2019 SPECIFICATIONS

THE STANDARD SPECIFICATIONS OF THE STATE OF OHIO, DEPARTMENT OF TRANSPORTATION, INCLUDING SUPPLEMENTAL SPECIFICATIONS LISTED IN THE PLANS AND CHANGES LISTED IN THE PROPOSAL SHALL GOVERN THIS IMPROVEMENT.

I HEREBY APPROVE THESE PLANS AND DECLARE THAT THE MAKING OF THIS IMPROVEMENT WILL NOT REQUIRE THE CLOSING TO TRAFFIC OF THE HIGHWAY EXCEPT AS NOTED ON SHEETS 11-12, AND THAT PROVISIONS FOR THE MAINTENANCE AND SAFETY OF TRAFFIC WILL BE AS SET FORTH ON THE PLANS AND ESTIMATES.

APPROVED _____
DATE _____ DISTRICT DEPUTY DIRECTOR

APPROVED _____
DATE _____ DIRECTOR, DEPARTMENT OF TRANSPORTATION

INDEX OF SHEETS:

TITLE	1
LOCATION MAPS	2-3
GENERAL NOTES	4-5
UTILITY INVOLVEMENT SUMMARY	6
MAINTENANCE OF TRAFFIC	7-29
GENERAL SUMMARY	30-33
STRUCTURE GENERAL NOTES	34-36
STRUCTURE DATA TABLE	37
COMPOSITE FIBER WRAP DETAILS	38
1 - CUY-090-1062	39-53
2 - CUY-090-2910	54-60
3 - CUY-237-0827	61-74
4 - CUY-252-0434	75-89
5 - CUY-271-1543	90-95
6 - CUY-480-0446	96-102
7 - CUY-480-0870-ES	103-110



LOCATION MAP
LATITUDE: 41° 24' 54" N LONGITUDE: 81° 36' 54" W
FOR COORDINATES PER LOCATION SEE SHEETS 2 & 3

UNDERGROUND UTILITIES

Contact Two Working Days Before You Dig



OHIO811, 8-1-1, or 1-800-362-2764
(Non members must be called directly)

ENGINEER'S SEAL:

FOR SHEETS:
13-23, 27-29, 39-53, 61-74

SIGNED: _____
DATE: _____

ENGINEER'S SEAL:

FOR SHEETS:
30-38, 54-60, 75-108

SIGNED: _____
DATE: _____

ENGINEER'S SEAL:

FOR SHEETS:
1-12, 24-26

SIGNED: _____
DATE: _____

STANDARD CONSTRUCTION DRAWINGS

MGS-3.1	1/19/18	BP-2.3	7/18/14
MGS-4.2	7/19/13	HL-20.14	4/17/20
		RM-4.5	7/21/17
MT-95.30	7/19/19		
MT-95.31	7/19/19	AS-1-15	7/17/15
MT-95.32	4/19/19	AS-2-15	1/18/19
MT-97.10	4/19/19		
MT-98.10	1/17/20	BR-2-15	1/21/22
MT-98.20	4/19/19	EXJ-4-87	7/15/22
MT-98.29	1/17/20	GSD-1-19	1/15/21
MT-101.60	1/17/20		
MT-101.70	1/17/20	PCB-91	7/17/20
MT-101.90	7/17/20	RB-1-55	7/19/13
MT-105.10	1/17/20	TVPF-1-18	7/20/18
MT-110.10	7/19/13	VPF-1-90	7/20/18

SUPPLEMENTAL SPECIFICATIONS	SPECIAL PROVISIONS
800-2019	SEE PROPOSAL
821	4/20/12
832	7/15/22
844	4/20/18
848	1/15/21
921	4/20/12

PLAN PREPARED BY:



OSBORN ENGINEERING
1100 Superior Avenue Suite 300
Cleveland, OH 44114
(216) 961-2020 www.osborn-eng.com



CUY-BH-FY2023 MISC.

MODEL: Sheet PAPER SIZE: 17x11 (in.) DATE: 3/27/2023 TIME: 12:57:04 PM USER: mdcruz P:\ODOT\20200855\000 Dist 12 - VAR Bridge Rehab\105909\404-Engineering\Roadway\Sheets\105909_G1001.dgn

TITLE SHEET

DESIGN AGENCY



OSBORN ENGINEERING
1100 Superior Avenue Suite 300
Cleveland, OH 44114
(216) 961-2020 www.osborn-eng.com

DESIGNER
MJD

REVIEWER
JDH 12-13-22

PROJECT ID
105909

SHEET TOTAL
1 110

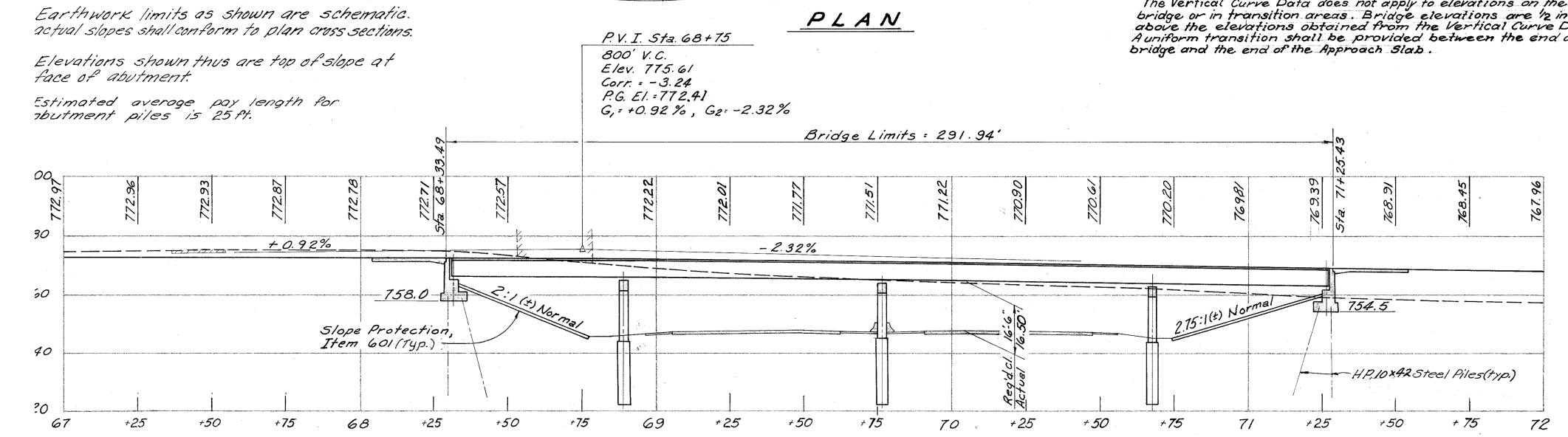
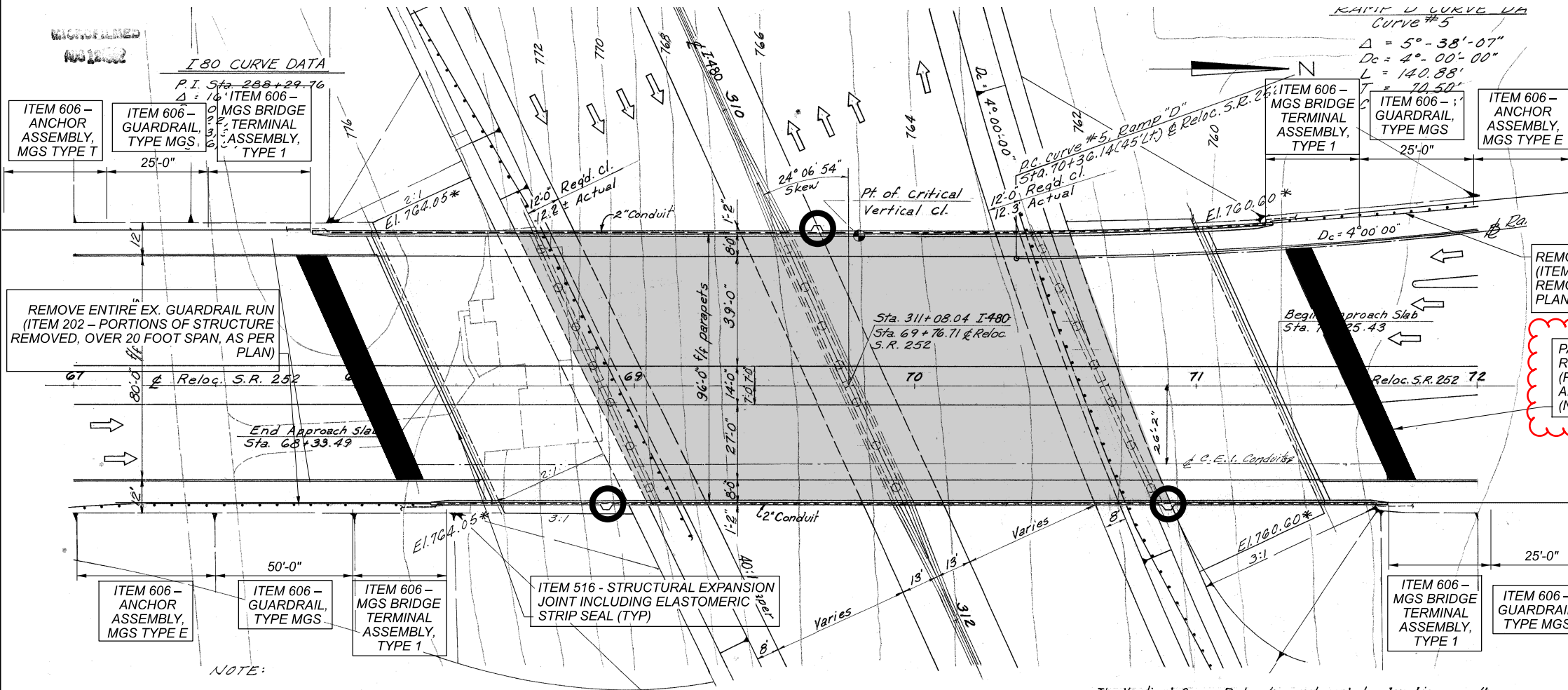

LEGEND:

- INDICATES APPROXIMATE AREAS OF ITEM SPECIAL - STRUCTURES: TIMBER SUBDECK AND ITEM SPECIAL - STRUCTURES: BOTTOM OF DECK SPALL REMOVAL. SEE SHEET 76 FOR TIMBER SUBDECK DETAILS
- ITEM 441 - ASPHALT CONCRETE INTERMEDIATE COURSE, TYPE 2, (448)
- ITEM 625 - REMOVE AND REERECT EXISTING LIGHT POLE, AS PER PLAN

NOTES:

- DETAILS ON THIS SHEET ARE TAKEN FROM EXISTING PLANS AND SHOULD BE USED FOR INFORMATION PURPOSES ONLY.
- PERFORM ONLY THE WORK AS INDICATED IN THE STRUCTURE DATA TABLE SHEET, FRAMED TEXT, AND/OR DESCRIBED IN THE GENERAL NOTES.
- FOR ESTIMATED QUANTITIES SEE SHEET 76
- PRESSURE RELIEF JOINT TO BE PATCHED ACROSS THE FULL ROADWAY WIDTH FOR APPROXIMATELY 3" DEEP AND MATCH ODOT STANDARD DRAWING BP-2.3. FIELD ENGINEER TO MARK AND VERIFY AREAS FOR PATCHING. FINAL CONDITION OF THE PRESSURE RELIEF JOINT SHOULD BE IN NEW CONDITION PROVIDING A SMOOTH RIDING SURFACE.

SFN	1810405
DESIGN AGENCY	OSBORN ENGINEERING
DESIGNER/CHECKER	MJD JDH
REVIEWER	SMK
PROJECT ID	105909
SUBSET	TOTAL
1	15
SHEET	TOTAL
75	110

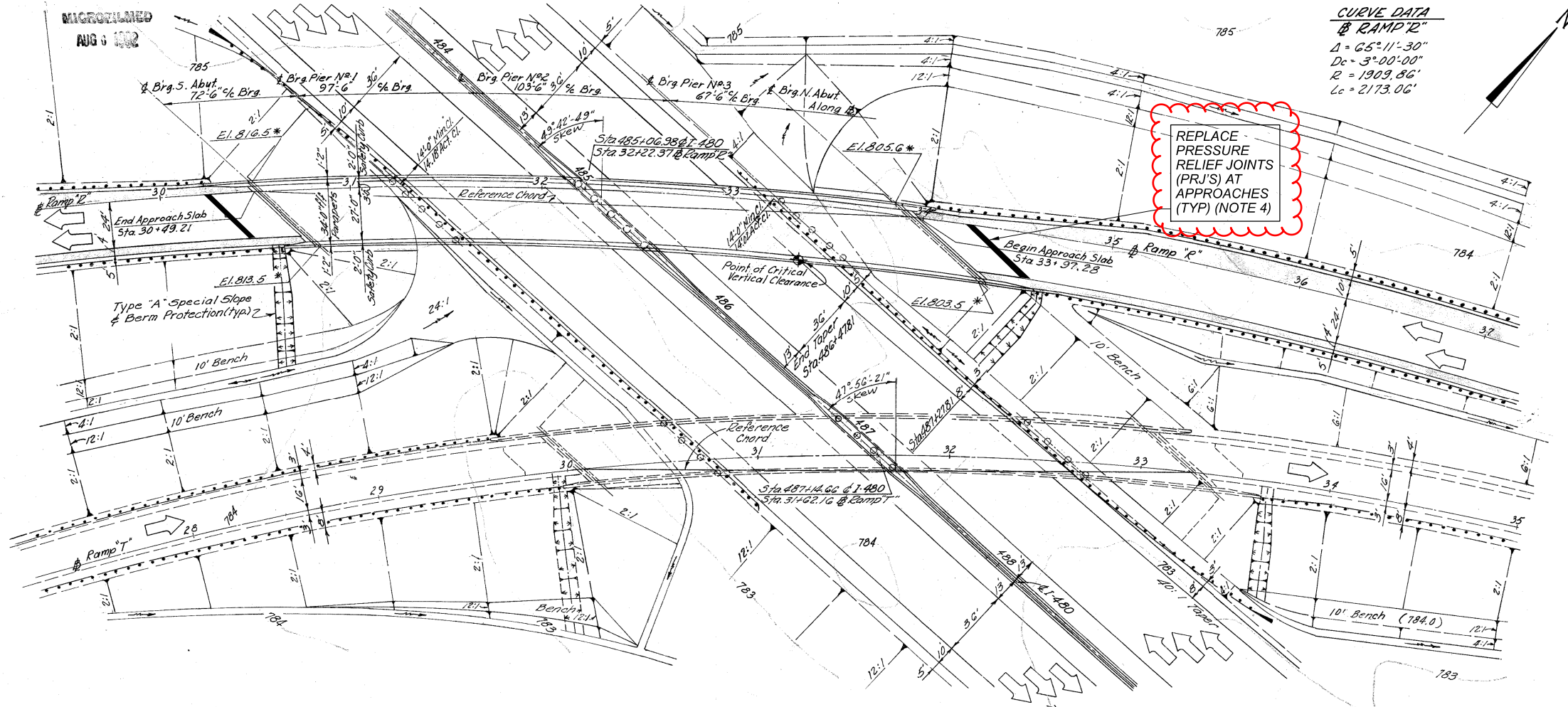

PLAN

VERTICAL CURVE DATA
 @ RAMP "R"
 PVI Sta. 23+75
 1200' V.C.
 Elev. 844.64
 Corr. = 10.50'
 P.G. Elev. 834.14
 $G_1 = +4.00\%$ $G_2 = -3.00\%$

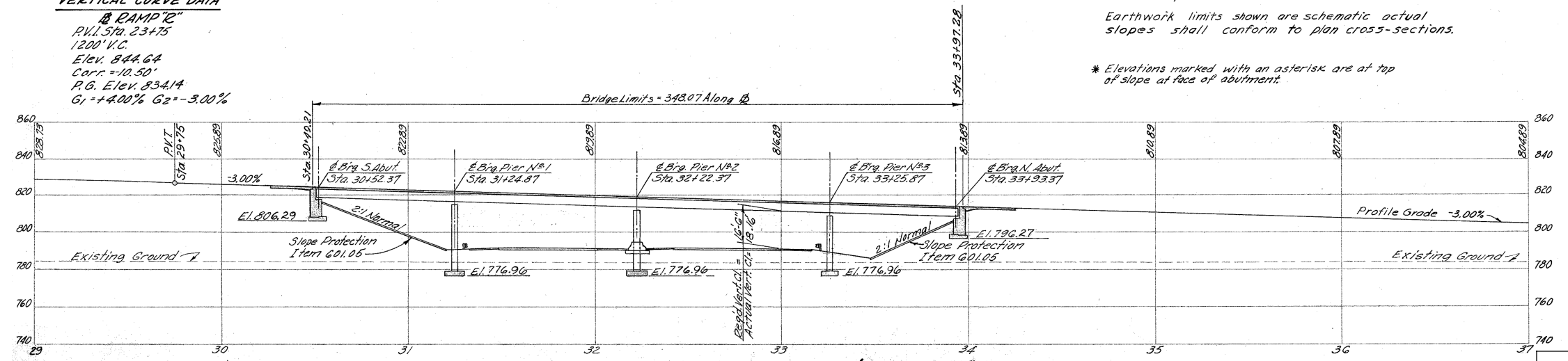

PROFILE ALONG @ RAMP "R"

NOTE:

Reference chord is a line between intersections of @ Ramp "E" and @ Brgs. at abutments, Sta. 30+52.37 & Sta. 33+33.37.
 Earthwork limits shown are schematic actual slopes shall conform to plan cross-sections.
 * Elevations marked with an asterisk are at top of slope at face of abutment.

LEGEND:

ITEM 441 - ASPHALT CONCRETE INTERMEDIATE COURSE, TYPE 2, (448)

NOTES:

- DETAILS ON THIS SHEET ARE TAKEN FROM EXISTING PLANS AND SHOULD BE USED FOR INFORMATION PURPOSES ONLY.
- PERFORM ONLY THE WORK AS INDICATED IN THE STRUCTURE DATA TABLE SHEET, FRAMED TEXT, AND/OR DESCRIBED IN THE GENERAL NOTES.
- FOR ESTIMATED QUANTITIES SEE SHEET 104
- PRESSURE RELIEF JOINT TO BE REPLACED SHALL MATCH ODOT STANDARD DRAWING BP-2.3 AND PROVIDE A NEW, SMOOTH RIDING SURFACE.

GENERAL PLAN - LOCATION 7
 BRIDGE NO. CUY-480-0870-ES
 IR-480 WB RAMP TO SB IR-71 OVER IR-480

SFN 1814249
 DESIGN AGENCY
OSBORN ENGINEERING
 1100 Superior Avenue Suite 300
 Cleveland, OH 44114
 (216) 845-2000 www.osborneng.com
 DESIGNER: MJD
 CHECKER: JDH
 REVIEWER: SMK
 PROJECT ID: 105909
 SUBSET: 1 TOTAL: 8
 SHEET: 103 TOTAL: 110