

F:\17000\17126 - CUY-90-18.22\_Culverts\Microstation Project\92069\_CUY-90-18.22\Design\Roadway\Sheets\92069\_MN002.dgn\_Sheet 9/10/2021 10:57:46 AM p.fingstern

**ITEM 614, MAINTAINING TRAFFIC (LANES OPEN DURING HOLIDAYS OR SPECIAL EVENTS)**

NO WORK SHALL BE PERFORMED AND ALL EXISTING LANES SHALL BE OPEN TO TRAFFIC DURING THE FOLLOWING DESIGNATED HOLIDAYS OR EVENTS:

CHRISTMAS FOURTH OF JULY  
NEW YEARS LABOR DAY  
MEMORIAL DAY THANKSGIVING  
(OTHER HOLIDAY OR EVENT)

THE PERIOD OF TIME THAT THE LANES ARE TO BE OPEN DEPENDS ON THE DAY OF THE WEEK ON WHICH THE HOLIDAY OR EVENT FALLS. THE FOLLOWING SCHEDULE SHALL BE USED TO DETERMINE THIS PERIOD:

DAY OF HOLIDAY TIME ALL LANES  
OR EVENT MUST BE OPEN TO TRAFFIC

SUNDAY 12:00N FRIDAY THROUGH 6:00AM MONDAY  
MONDAY 12:00N FRIDAY THROUGH 6:00AM TUESDAY  
TUESDAY 12:00N MONDAY THROUGH 6:00AM WEDNESDAY  
WEDNESDAY 12:00N TUESDAY THROUGH 6:00AM THURSDAY  
THURSDAY 12:00N WEDNESDAY THROUGH 6:00AM FRIDAY  
THURSDAY (THANKSGIVING ONLY)  
6:00AM WEDNESDAY THROUGH 6:00AM MONDAY  
FRIDAY 12:00N THURSDAY THROUGH 6:00AM MONDAY  
SATURDAY 12:00N FRIDAY THROUGH 6:00AM MONDAY

SHOULD THE CONTRACTOR FAIL TO MEET ANY OF THESE REQUIREMENTS, THE CONTRACTOR SHALL BE ASSESSED A DISINCENTIVE PER THE LANE VALUE CONTRACT (PN 127).

**DRUM REQUIREMENTS**

IN ADDITION TO THE REQUIREMENTS OF THE PLANS, SPECIFICATION AND PROPOSAL, DRUMS FURNISHED BY THE CONTRACTOR SHALL BE NEW AND UNUSED AT THE TIME OF ARRIVAL ON THE PROJECT. ANY DRUMS BROUGHT ON THE PROJECT, WHICH HAVE PREVIOUSLY BEEN USED ELSEWHERE, WILL NOT BE ACCEPTED.

PAYMENT FOR DRUMS SHALL BE INCLUDED IN THE LUMP SUM PRICE BID FOR MAINTAINING TRAFFIC UNLESS SEPARATELY ITEMIZED.

**WORK ZONE MARKINGS AND SIGNS**

THE FOLLOWING ESTIMATED QUANTITIES HAVE BEEN CARRIED TO THE GENERAL SUMMARY FOR USE AT LOCATIONS IDENTIFIED BY THE ENGINEER FOR WORK ZONE PAVEMENT MARKINGS AND SIGNS PER THE REQUIREMENTS OF C&MS 614.04 AND 614.11.

**WINTER WORK LIMITATIONS**

THE USE OF PORTABLE BARRIER FOR LANE AND SHOULDER CLOSURES SHALL NOT BE PERMITTED BETWEEN NOVEMBER 1 AND APRIL 1.

**ITEM 614, REPLACEMENT SIGN**

FLATSHEET SIGNS FURNISHED BY THE CONTRACTOR IN ACCORDANCE WITH THE REQUIREMENTS OF THE PLANS, SPECIFICATIONS AND PROPOSAL WHICH BECOME DAMAGED BY TRAFFIC FOR REASONS BEYOND THE CONTROL OF THE CONTRACTOR SHALL BE REPLACED IN KIND WHEN ORDERED BY THE ENGINEER. REPLACEMENT SIGNS SHALL BE NEW. OTHER MATERIALS MAY BE IN USED, BUT GOOD, CONDITION SUBJECT TO APPROVAL BY THE ENGINEER.

PAYMENT FOR THE NEW SIGNS SHALL BE MADE AT THE CONTRACT PRICE PER EACH FOR ITEM 614, REPLACEMENT SIGN, AND SHALL INCLUDE THE COST OF REMOVING AND DISPOSING OF DAMAGED SIGNS, HARDWARE AND SUPPORTS, AND PROVIDING THE NECESSARY REPLACEMENT HARDWARE, SUPPORTS, ECT.

AN ESTIMATED QUANTITY OF 10 EACH HAS BEEN PROVIDED IN THE GENERAL SUMMARY.

**DUST CONTROL**

THE CONTRACTOR SHALL FURNISH AND APPLY WATER FOR DUST CONTROL AS DIRECTED BY THE ENGINEER. THE FOLLOWING ESTIMATED QUANTITIES HAVE BEEN INCLUDED FOR DUST CONTROL PURPOSES:

ITEM 616, WATER 5 M. GAL.

**ITEM 614, WORK ZONE IMPACT ATTENUATOR FOR 24" WIDE HAZARDS (UNIDIRECTIONAL OR BIDIRECTIONAL)**

THIS ITEM SHALL CONSIST OF FURNISHING AND INSTALLING A NONGATING IMPACT ATTENUATOR. FURNISH AN IMPACT ATTENUATOR FROM THE OFFICE OF ROADWAY ENGINEERING'S APPROVED LIST FOR WORK ZONE IMPACT ATTENUATORS, FROM THE ROADWAY STANDARDS APPROVED PRODUCTS WEB PAGE.

INSTALLATION SHALL BE AT THE LOCATIONS SPECIFIED IN THE PLANS IN ACCORDANCE WITH THE MANUFACTURER'S SPECIFICATIONS.

THE CONTRACTOR SHALL REPAIR OR REPLACE A DAMAGED UNIT WITHIN 24 HOURS OF A DAMAGING IMPACT.

WHEN BIDIRECTIONAL DESIGNS ARE SPECIFIED, THE CONTRACTOR SHALL SUPPLY APPROPRIATE TRANSITIONS.

WHEN GATING IMPACT ATTENUATORS ARE DESIRED, THE CONTRACTOR SHALL SUBMIT DOCUMENTATION TO THE ENGINEER FOR ACCEPTANCE.

THE COST FOR THE ADDITIONAL BARRIER REQUIRED FOR A GATING IMPACT ATTENUATOR SHALL BE INCLUDED IN THE COST OF THE GATING IMPACT ATTENUATOR.

PAYMENT FOR THE ABOVE WORK SHALL BE MADE AT THE UNIT PRICE BID AND SHALL INCLUDE ALL LABOR, TOOLS, EQUIPMENT AND MATERIALS NECESSARY TO CONSTRUCT AND MAINTAIN A COMPLETE AND FUNCTIONAL IMPACT ATTENUATOR SYSTEM, INCLUDING ALL RELATED BACKUPS, TRANSITIONS, LEVELING PADS, HARDWARE AND GRADING, NOT SEPARATELY SPECIFIED, AS REQUIRED BY THE MANUFACTURER.

CALCULATED  
MTG  
CHECKED  
SJP

MAINTENANCE OF TRAFFIC GENERAL NOTES

CUY-90-18.22 / VAR

R:\17000\1726 - CUY-90-18.22\_Culverts\Microstation Project\92069.CUY-90-18.22\Design\Roadway\Sheets\92069\_MP200.dgn\_Sheet 1/19/2021 10:47:09 AM pfingstern

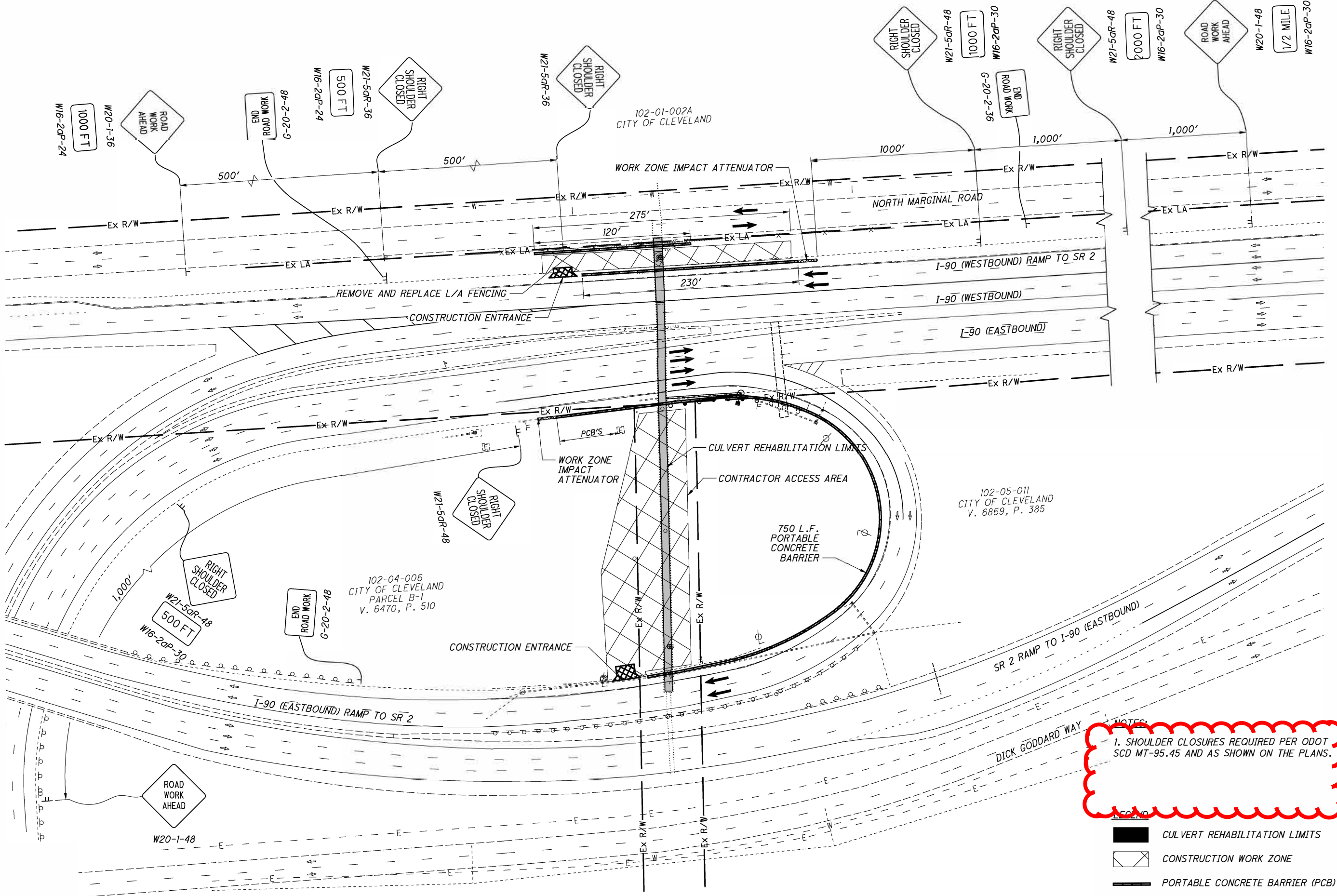

**NOTES:**  
 1. SHOULDER CLOSURES REQUIRED PER ODOT SCD MT-95.45 AND AS SHOWN ON THE PLANS.

- LEGEND:**
- CULVERT REHABILITATION LIMITS
  - CONSTRUCTION WORK ZONE
  - PORTABLE CONCRETE BARRIER (PCB)
  - WORK ZONE ATTENUATOR
  - CONSTRUCTION ENTRANCE
  - CONSTRUCTION SIGNS

CALCULATED  
 MTG  
 CHECKED  
 SJP

0 50 100  
 HORIZONTAL  
 SCALE IN FEET

**CONSTRUCTION ACCESS & MOT PLAN**  
**SITE 2 - CUY-90-1822**





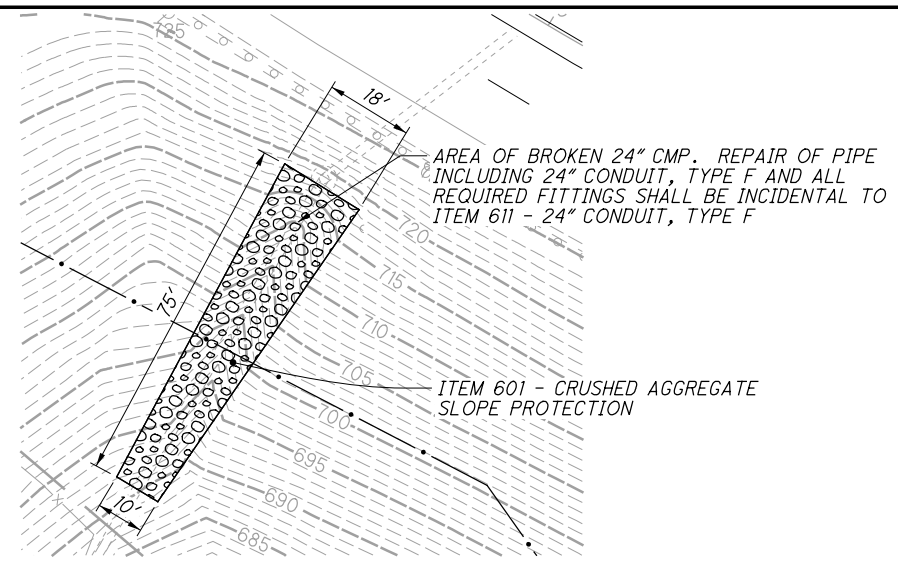
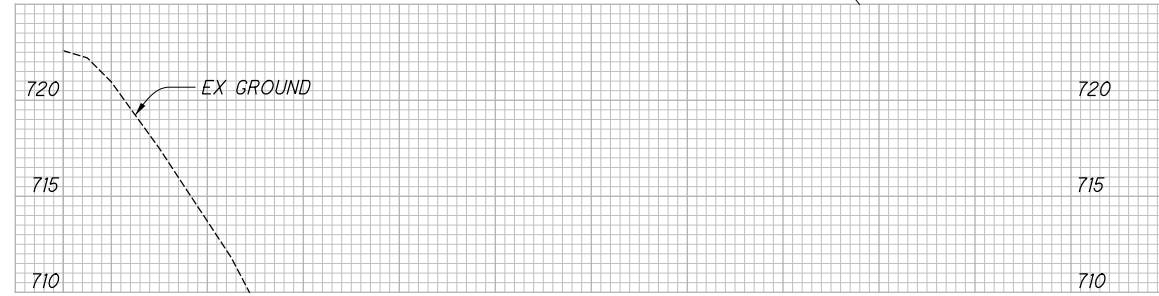
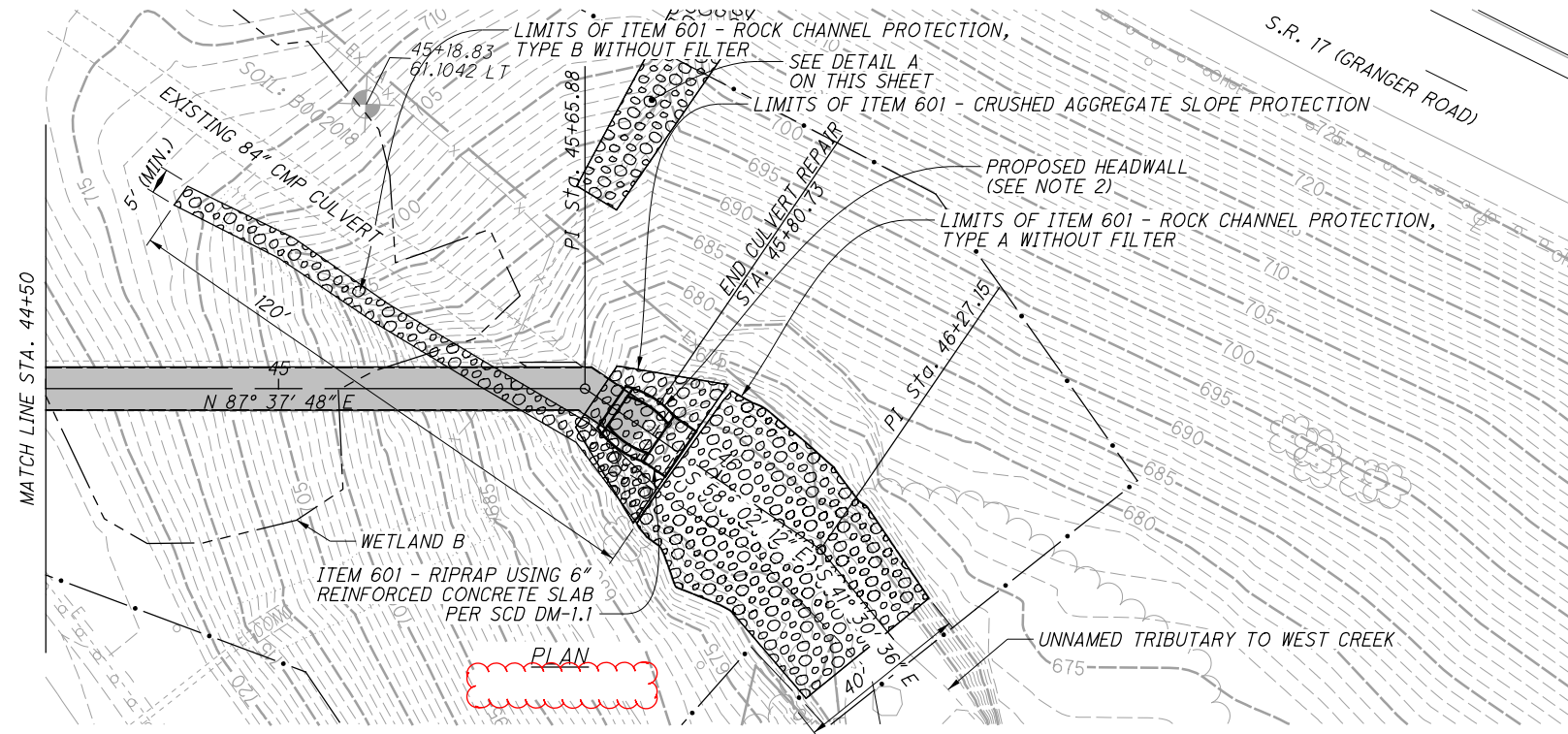

DETAIL A

- NOTES:**
1. SEE CUY-480-1628 SITE PLAN SHEET, SHEET 49, FOR COMPLETE LIMITS OF CONSTRUCTION.
  2. SEE CUY-480-16.28 DETAIL SHEET, SHEET 55, FOR ADDITIONAL OUTLET COLLAR DETAILS.
  3. CONTRACTOR SHALL INSTALL NON-SHRINK HYDRAULIC CEMENT POST GROUTING TO PROVIDE A SMOOTH TRANSITION AROUND THE FULL INTERFACE OF THE EXISTING STRUCTURE AND PROPOSED LINER. TYPICAL AT UPSTREAM AND DOWNSTREAM LINER LIMITS.

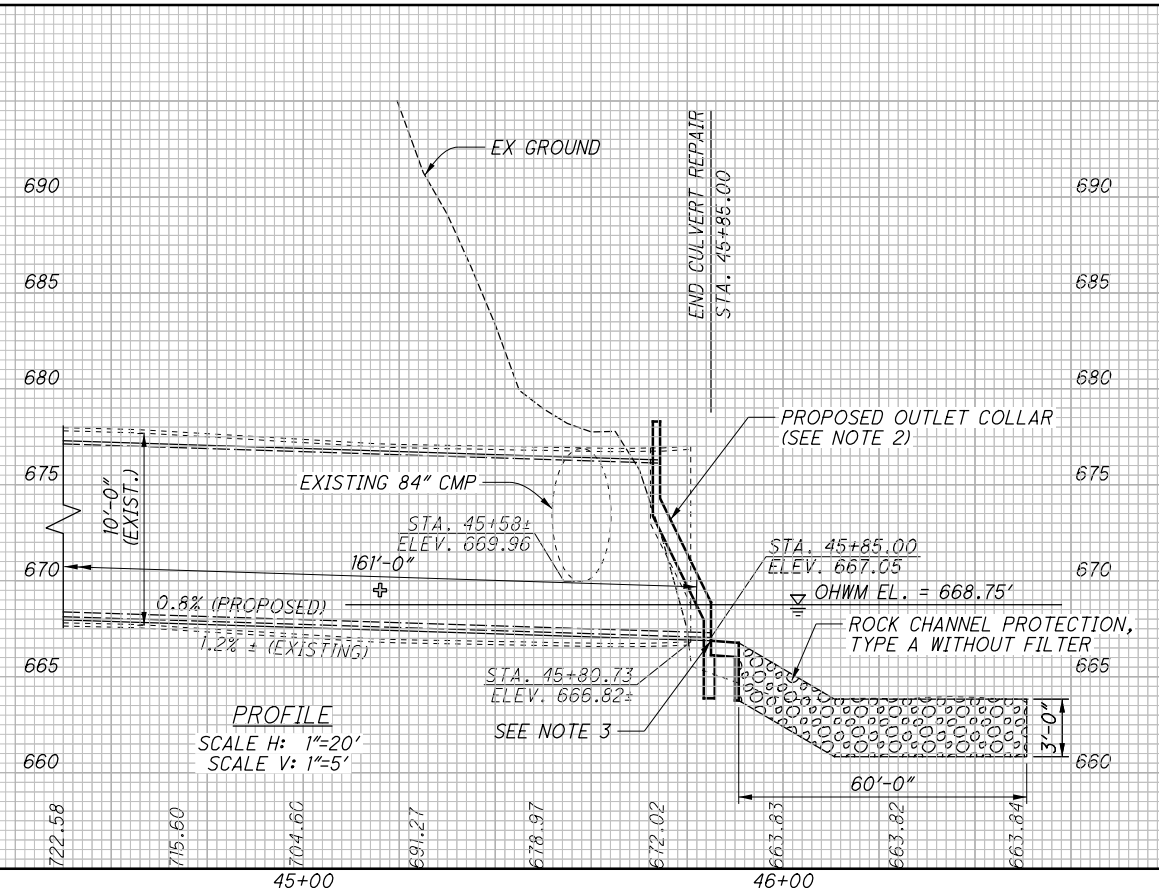

- ⊕ ITEM 837 - LINER PIPE, AS PER PLAN
- ⊕ ITEM 837 - BACKFILL FOR LINER PIPE, AS PER PLAN
- ⊕ ITEM 611 - CONDUIT, FIELD PAVING OF PIPE

CALCULATED  
MTG  
CHECKED  
SJP

0 20 40  
HORIZONTAL  
SCALE IN FEET

**CULVERT PLAN AND PROFILE  
SITE 4 - CUY-480-1628**

**CUY-90-18.22/ VAR**

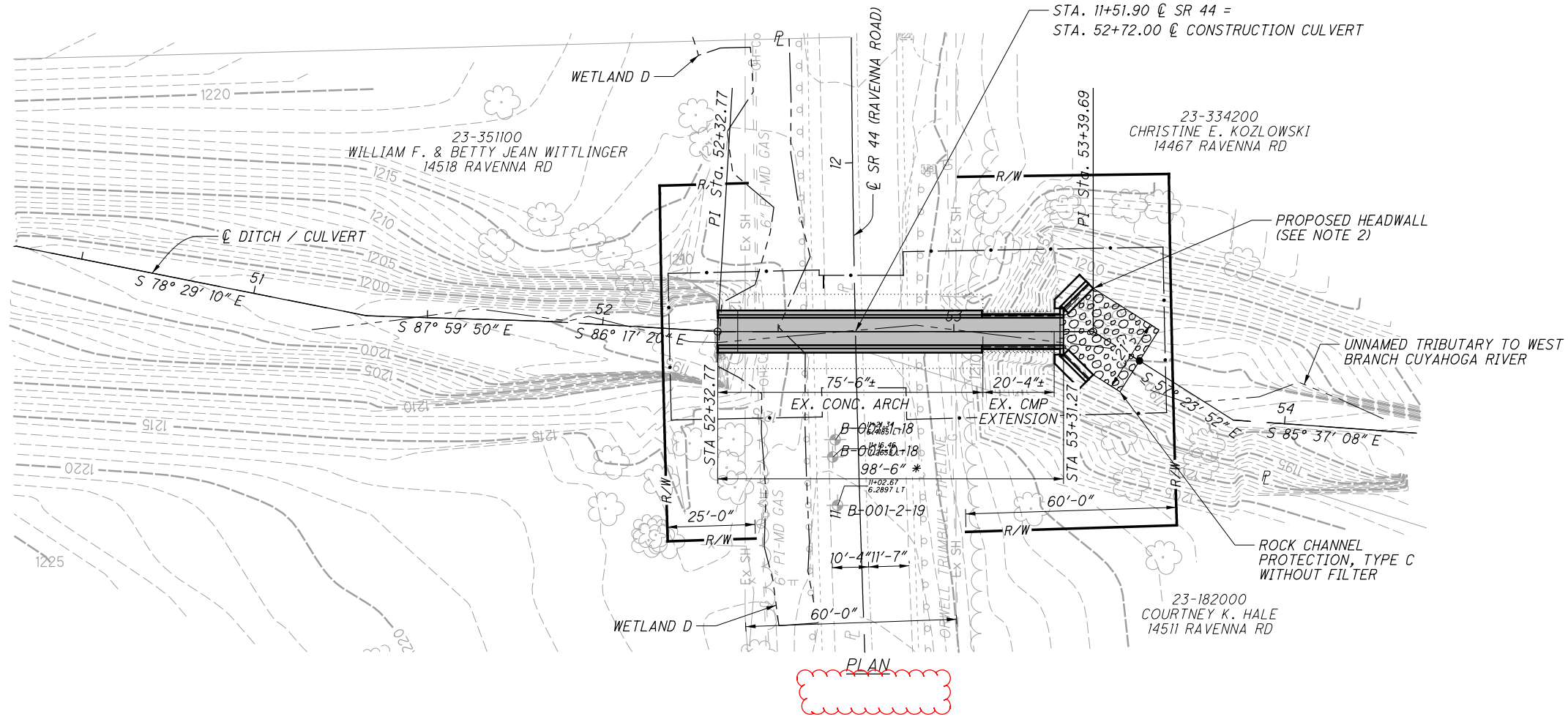

- NOTES:**
- SEE GEA-044-0916 SITE PLAN SHEET, SHEET 56, FOR COMPLETE LIMITS OF CONSTRUCTION.
  - SEE GEA-044-0916 DETAIL SHEET, SHEET 62, FOR ADDITIONAL HEADWALL DETAILS.

