

MATERIALS REQUIRED			
ITEM	QTY.	UNITS	DESCRIPTION
625	491	FT	CONDUIT, 2", 725.05
625	24	FT	CONDUIT, 3", 725.04
625	97	FT	CONDUIT, JACKED OR DRILLED, AS PER PLAN, 3"
625	3	EACH	PULL BOX, 725.08, 18"
625	1	EACH	PULL BOX, 725.08, 24"
625	5	EACH	GROUND ROD, AS PER PLAN
630	5	EACH	SIGN HANGER ASSEMBLY, SPANWIRE
630	25	SF	SIGN, FLAT SHEET, TYPE G
632	11	EACH	VEH. SIGNAL HEAD, (LED), 3 SECTION, 12" LENS, 1-WAY, POLYCARB.
632	2	EACH	VEH. SIGNAL HEAD, (LED), 5 SECTION, 12" LENS, 1-WAY, POLYCARB.
632	1	EACH	LOOP DETECTOR UNIT, DELAY AND EXTENSION TYPE
632	664	FT	LOOP DETECTOR LEAD-IN CABLE, 2/C, NO. 14 AWG
632	700	FT	LOOP DETECTOR WIRE, TYPE E
632	351	FT	MESSENGER WIRE, 7 STRAND, 1/4" DIA. WITH ACCESSORIES, APP
632	351	FT	MESSENGER WIRE, 7 STRAND, 3/8" DIA. WITH ACCESSORIES
632	608	FT	INTERCONNECT CABLE, 6-PAIR, NO. 19 AWG, SOLID, REA (PE-39)
632	890	FT	SIGNAL CABLE, 5 CONDUCTOR, NO. 14 AWG
632	318	FT	SIGNAL CABLE, 7 CONDUCTOR, NO. 14 AWG
632	4	EACH	STRAIN POLE FOUNDATION, AS PER PLAN
632	78	FT	POWER CABLE, 3 CONDUCTOR, NO. 6 AWG
632	1	EACH	POWER SERVICE, AS PER PLAN
632	3	EACH	STRAIN POLE, TYPE TC-81.10, DESIGN 10, 36'
632	1	EACH	STRAIN POLE, TYPE TC-81.10, DESIGN 10, 32'
632	2	EACH	4' STRAIN POLE EXTENSION W/ 30' LUM. ARM
632	3	EACH	VIDEO DETECTION CAMERA
632	1	EACH	VIDEO DETECTION SYSTEM HARDWARE
633	1	EACH	CONTROLLER UNIT, TYPE TS2/A2, WITH CABINET, TYPE TS1
633	2	EACH	CABINET FOUNDATION
633	2	EACH	CONTROLLER WORK PAD, AS PER PLAN
633	1	EACH	UPS 1000W, AS PER PLAN, WITH ENCLOSURE

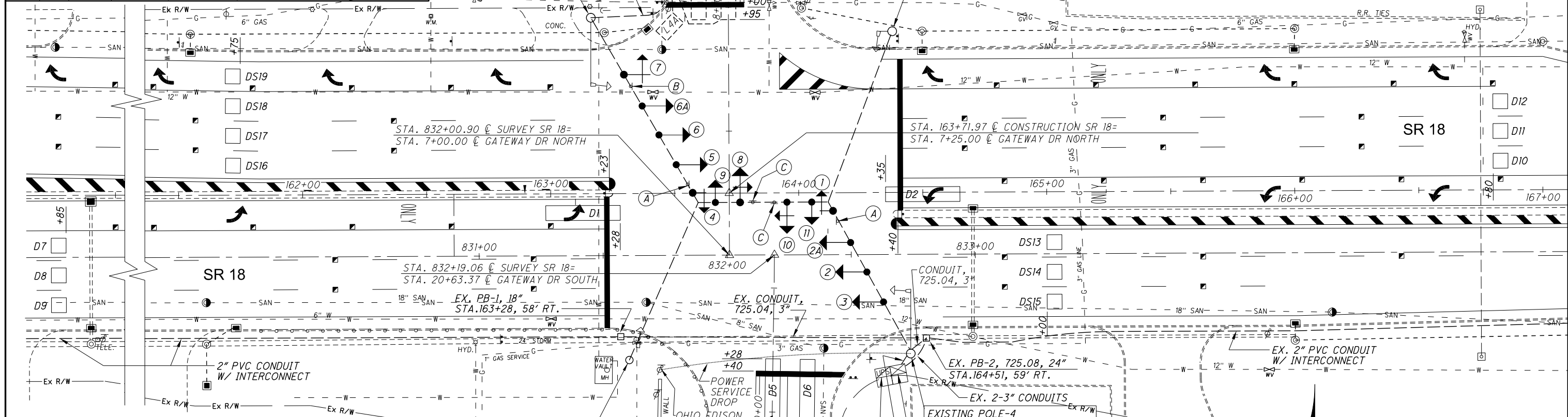
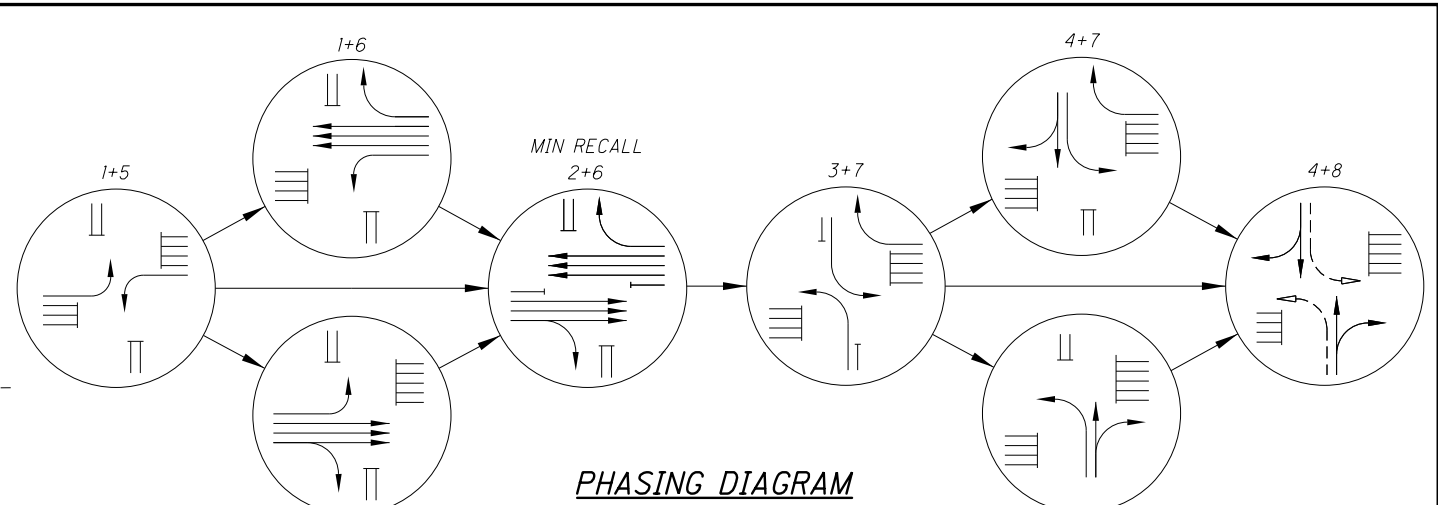
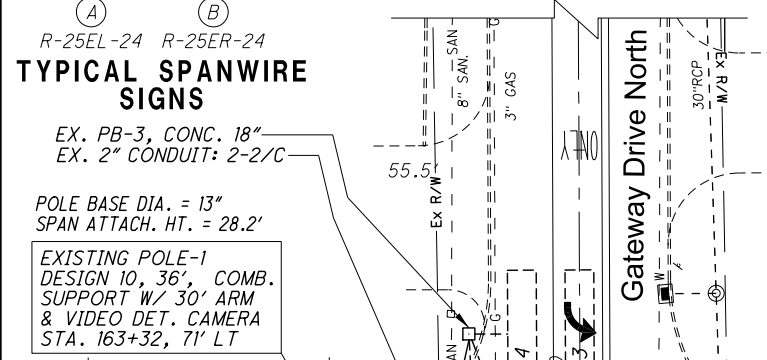
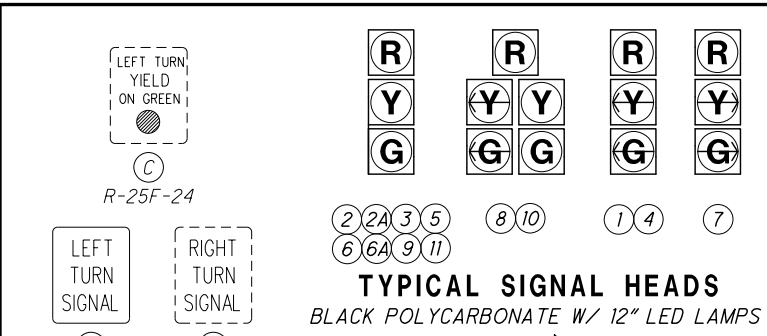

DETECTOR ZONE AND LOOP CHART

DETECTION ZONE	SIZE	MODE	DELAY (SEC.) *	ASSOCIATED PHASE	REMARKS
D1	6' x 30'	PRESENCE		5	
D2	6' x 30'	PRESENCE		1	
L3	6' x 30'	PRESENCE	2	4+7	EXISTING LOOP
L4	6' x 30'	PRESENCE	10	4	EXISTING LOOP
L4A	6' x 10'	PRESENCE	10	4	EXISTING LOOP
D5	6' x 30'	PRESENCE	2	3+8	
D6	6' x 30'	PRESENCE	10	8	
D7,8,9	6' x 6'	PULSE		2	SYSTEM ZONE
D10,11,12	6' x 6'	PULSE		6	SYSTEM ZONE
D13,14,15	6' x 6'	PULSE		6	SYSTEM ZONE
D16,17,18,19	6' x 6'	PULSE		6	SYSTEM ZONE

* INHIBIT DELAY DURING ASSOCIATED PHASE GREEN INTERVAL

EXISTING POLE-2
DESIGN 10, 32',
STA. 163+31.7, 66' RT
POLE BASE DIA. = 13"
SPAN ATTACH. HT. = 26.8'

EXISTING POLE-4
DESIGN 10, 32', COMBINATION
SUPPORT W/ 30' LUM. ARM AND
VIDEO DET. CAMERA
STA. 164+46, 65' RT
POLE BASE DIA. = 13"
SPAN ATTACH. HT. = 27.3'
EX. CONTROLLER, GROUND MOUNTED,
W/ WORKPAD. STA 164+39.7, 71.5' RT
EX. 2" PVC CONDUIT W/ POWER CABLE

FLASHER OPERATION
YELLOW TO SR 18
RED TO GATEWAY DRIVE & SR 18 LT
SIGNAL NO. MED-18-1574S
INSTALLATION DATE 2-27-02
FILE NO. 4442
OSIS NO. 1268



DATE	REVISIONS	DATE INSTALLED
12-18-06	PLAN REDRAWN FOR REBUILD PROJ 508(03)	10/11/04
3-10-08	RELOCATED POLE-2, ADDED HEADS 2A & 6A, NEW LOOPS L3,4,&4A - PER PROJ. 410(06)	5/23/08
9-13-10	PROJ 358(09) - INSTALLED BREAKAWAY TETHER CONNECTIONS	4/1/10
2-1-11	PROJ 332(10) - INSTALLED NEW SIGNAL HEADS AND UPS	3-21-11

OHIO DEPARTMENT OF TRANSPORTATION
ELECTRICAL INSTALLATION
LOCATED AT
SR 18 & GATEWAY DRIVE
Signal No. MED-18-1574S

DISTRICT 3 COUNTY MEDINA DRAWN RJR 12/06 REVIEWED

DESIGN FILE: I:\FIELD\N\ELECTRICAL\SIGNAL\DGN\M18 & Gateway.dgn
WORKSTATION: rronev DATE: 6/1/2011