

Calc. by P.D.M. 10/72  
 Chkd. by C.N. 1/73

FED. RD. DIVISION	STATE	PROJECT
2	OHIO	

81  
103

LOR-2-6.62  
 LOR-90-1.196

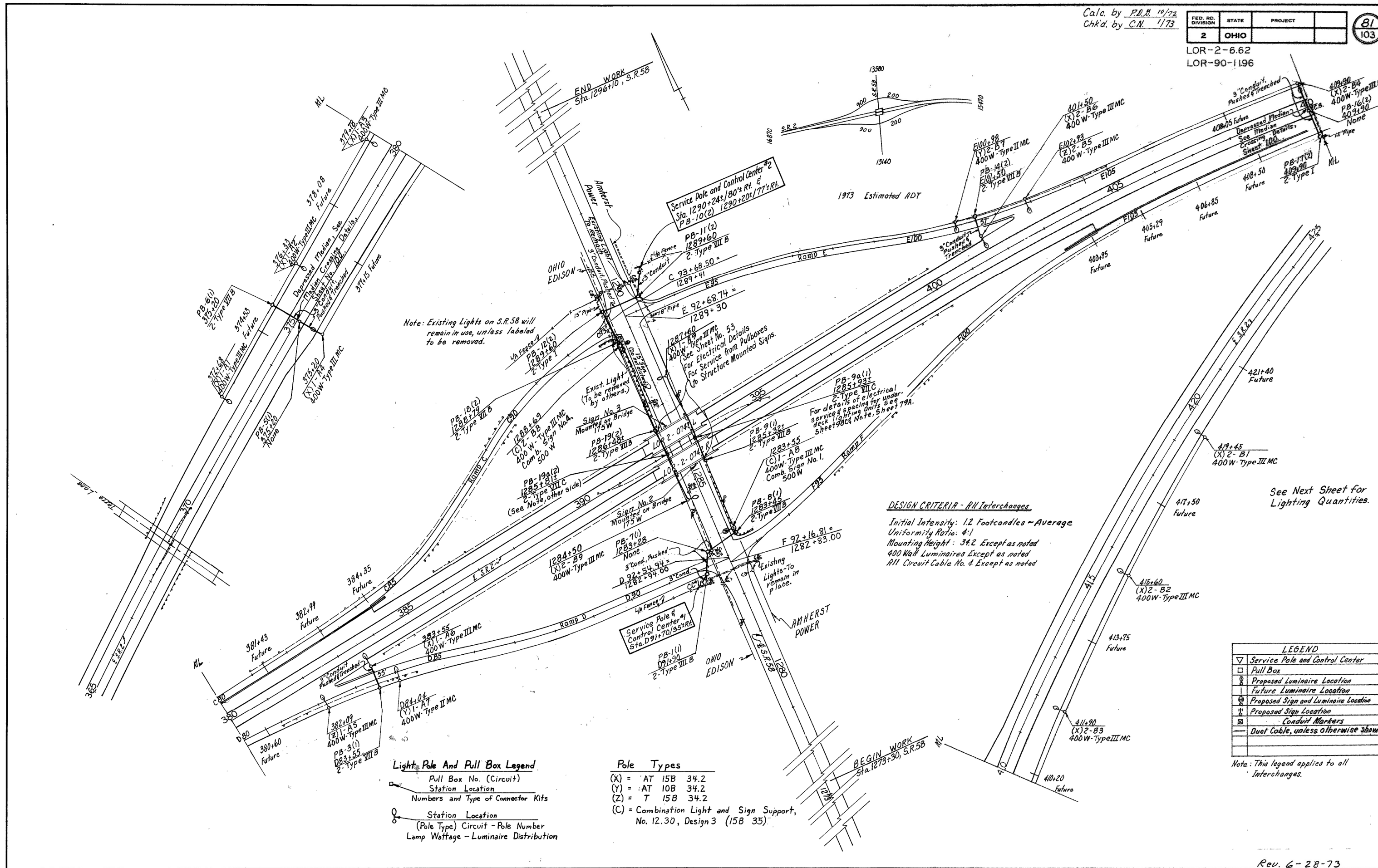

Note: Existing Lights on S.R. 58 will remain in use, unless labeled to be removed.

**DESIGN CRITERIA - All Interchanges**

Initial Intensity: 1.2 Footcandles - Average  
 Uniformity Ratio: 4:1  
 Mounting Height: 34.2 Except as noted  
 400 Watt Luminaires Except as noted  
 All Circuit Cable No. 4 Except as noted

See Next Sheet for Lighting Quantities.

**Light Pole And Pull Box Legend**

- Pull Box No. (Circuit)
- Station Location
- Numbers and Type of Connector Kits
- Station Location (Pole Type) Circuit - Pole Number
- Lamp Wattage - Luminaire Distribution

**Pole Types**

- (X) = AT 15B 34.2
- (Y) = AT 10B 34.2
- (Z) = T 15B 34.2
- (C) = Combination Light and Sign Support, No. 12.30, Design 3 (15B 35)

LEGEND	
▽	Service Pole and Control Center
□	Pull Box
○	Proposed Luminaire Location
○	Future Luminaire Location
○	Proposed Sign and Luminaire Location
○	Proposed Sign Location
○	Conduit Markers
—	Duct Cable, unless otherwise shown

Note: This legend applies to all Interchanges.