

**CURVE DATA U.S.R. 30  
& WEST BOUND LANES**

Δ = 29°54'05" Lt.  
 D = 1'25"  
 T = 1043.15  
 L = 2038.73  
 E = 135.88  
 R = 3906.53  
 P.I. Sta. 871+96.85 - W.B. Lanes  
 P.I. Sta. 871+60.73 - U.S.R. 30

FED. RD. DIST./COUNTY	STATE	PROJECT
2	OHIO	

STA-30-12.47

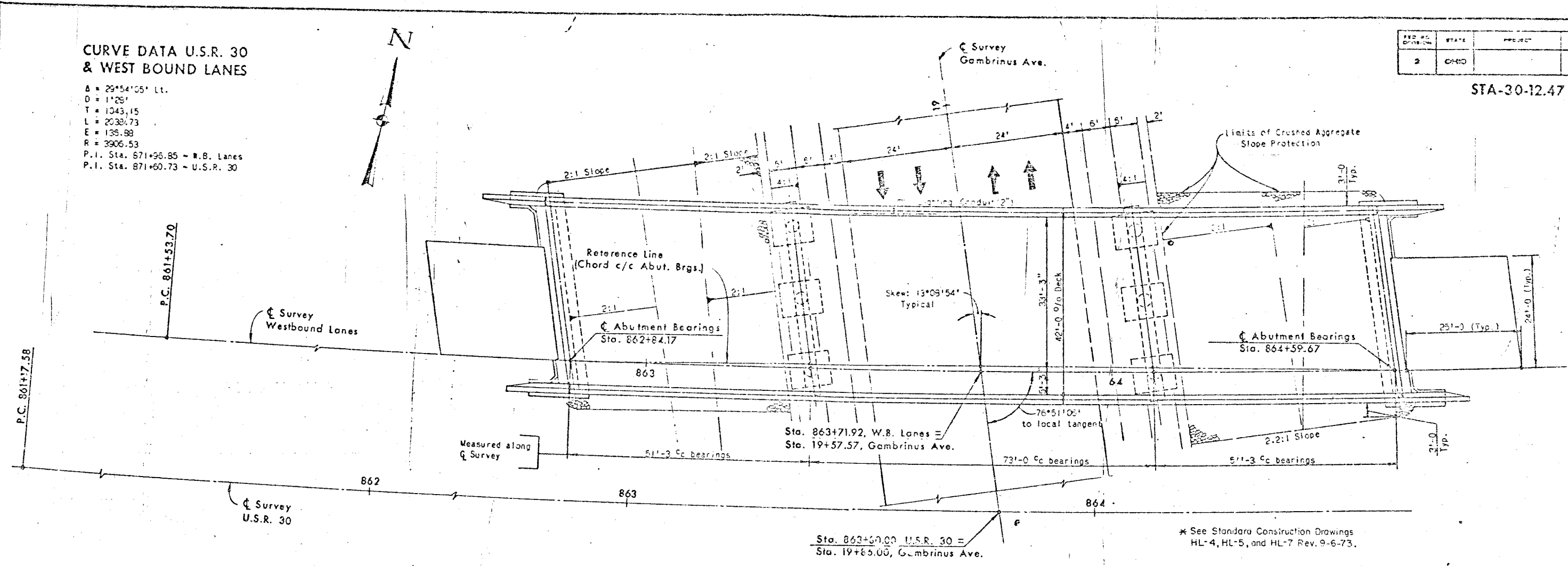

**GENERAL PLAN**

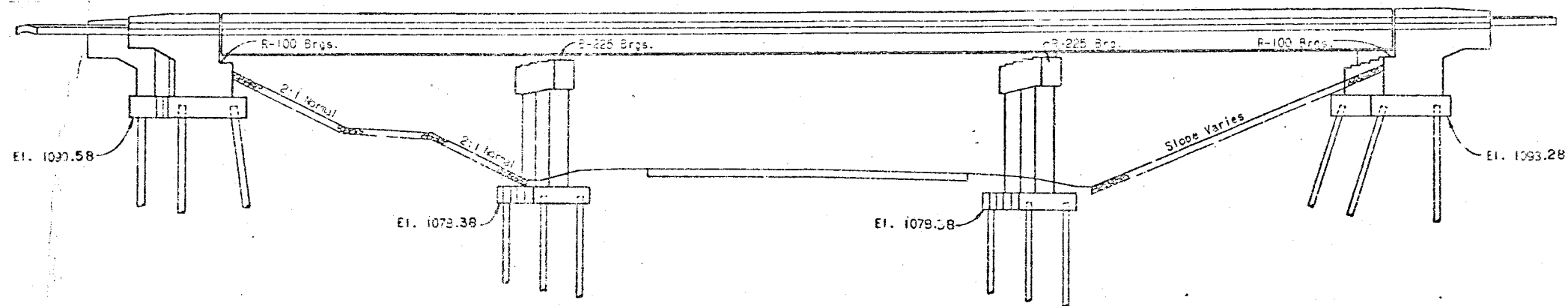

**ELEVATION**

NOTE: All piles 12" cast-in-place reinforced concrete  
 Entire number not shown.

W. E. QUICKSALL AND ASSOCIATES  
 CONSULTING ENGINEERS - INC.

**GENERAL PLAN &  
 BRIDGE NO. STA  
 U.S.R. 30 over RELOCATED**

DATE	BY	CHECKED	APPROVED
wje	wde		bc