

I:\ProjectData\04_Spot_paving\09251_SPFY2020_EAST_Design_Roadway_Sheets\09251_GT001.dgn Sheet 3 3/3/2020 8:40:52 AM r_bisesi

LOCATION 5
MAHONING COUNTY (IR-680)
SLM: 0.25 TO 4.02
LATITUDE: 41°07'21"
LONGITUDE: 80°42'37"

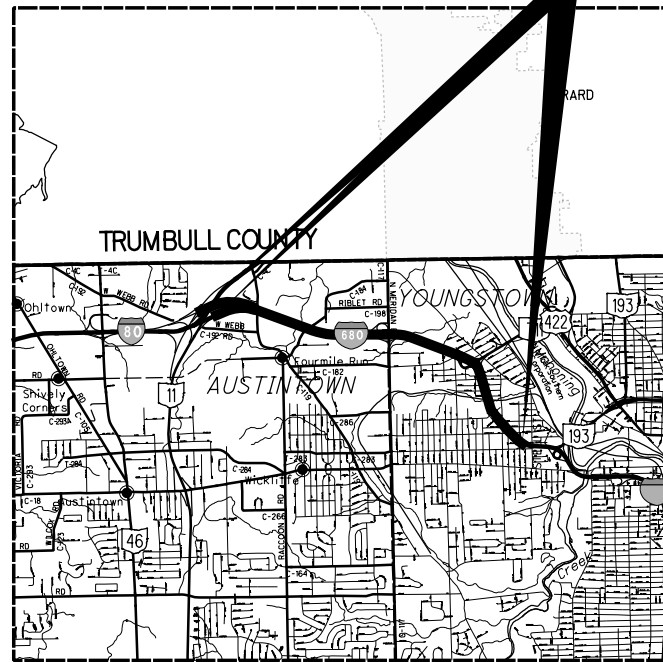

LOCATION 6
MAHONING COUNTY (IR-680)
SLM: 7.05 TO 11.95
LATITUDE: 41°03'25"
LONGITUDE: 80°37'46"

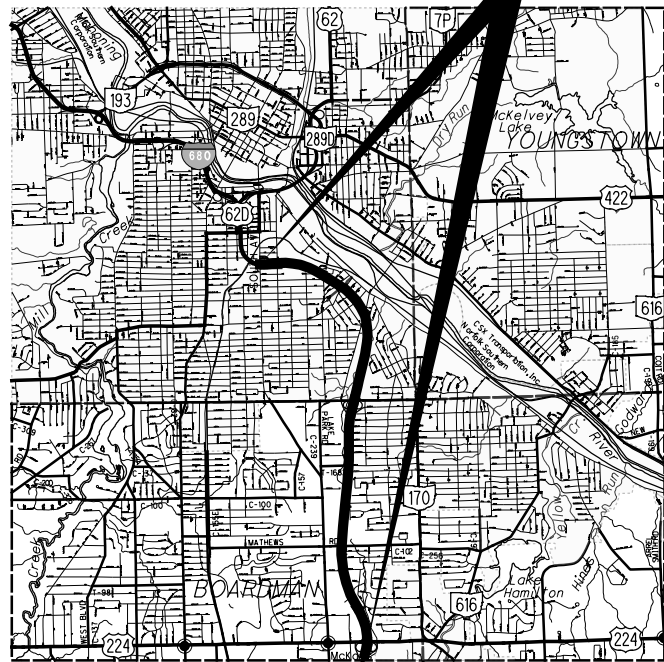

LOCATION 7
MAHONING COUNTY (US-422)
SLM: 7.58 TO 10.14
LATITUDE: 41°05'26"
LONGITUDE: 80°32'37"

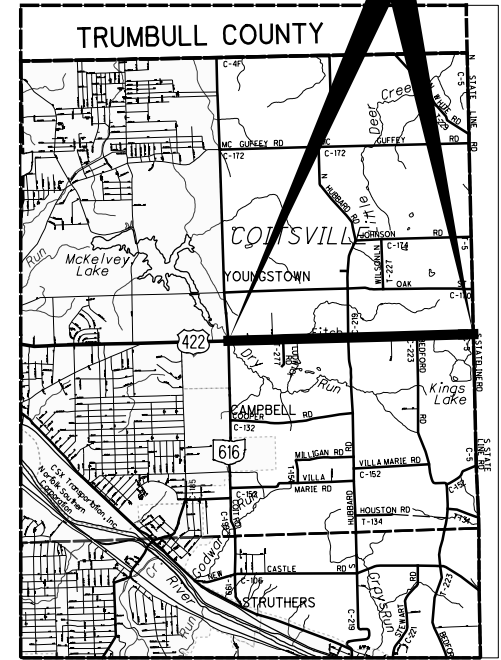

LOCATION 8
MAHONING COUNTY (SR-7)
SLM: 3.45 TO 6.21
LATITUDE: 40°58'06"
LONGITUDE: 80°39'36"

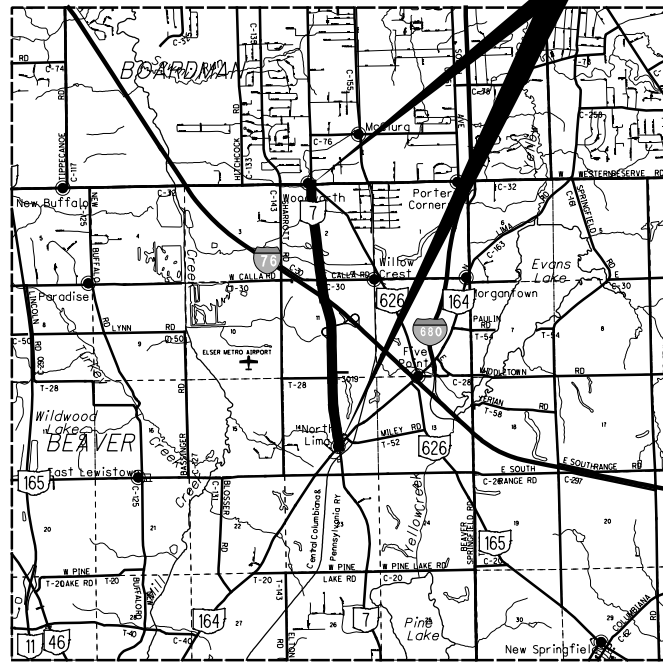

LOCATION 9
TRUMBULL COUNTY (SR-87)
SLM: 2.00 TO 7.00
LATITUDE: 41°27'39"
LONGITUDE: 80°55'02"

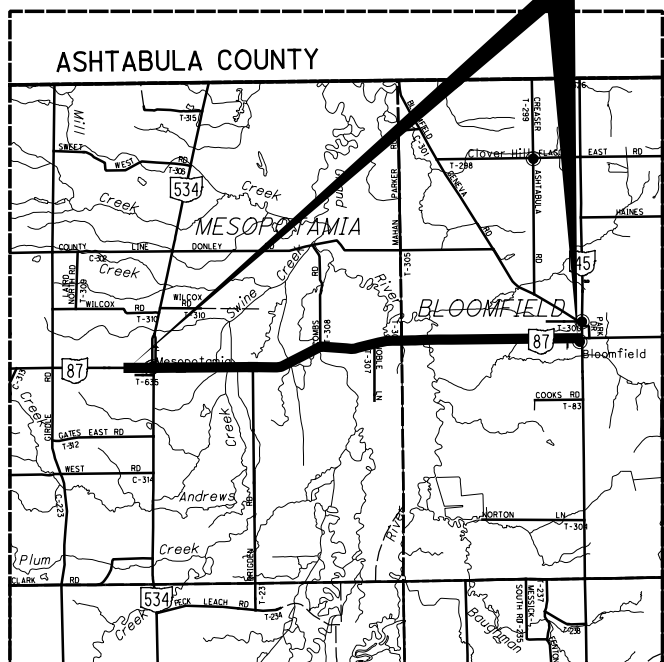

LOCATION 10
TRUMBULL COUNTY (I-80)
SLM: 9.05 TO 12.05
LATITUDE: 41°10'36"
LONGITUDE: 80°33'02"

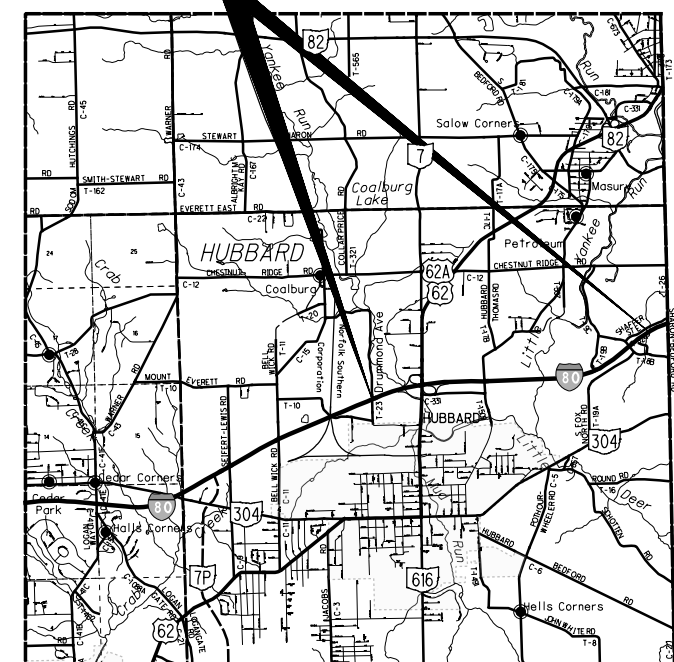

CALCULATED
CMR
CHECKED
RMM

LOCATION MAPS - MAHONING & TRUMBULL COUNTY

D04-SP-FY2020
(EAST)

UTILITIES

THE CONTRACTOR SHALL USE THE FOLLOWING PROCEDURE AT EACH LOCATION WHERE WORK IS PERFORMED, IN ACCORDANCE WITH SECTIONS 105.07 AND 107.16 IN THE CONSTRUCTION AND MATERIALS SPECIFICATIONS.

THE CONTRACTOR SHALL NOTIFY THE PROJECT ENGINEER, THE OHIO UTILITIES PROTECTION SERVICE (OUPS), THE OHIO & GAS PROCEDURES UNDERGROUND PROTECTION SERVICE (OGPUPS), THE OHIO DEPARTMENT OF TRANSPORTATION DISTRICT 4 HEAD-QUARTERS AND ALL NON REGISTERED UTILITY OWNERS AT LEAST TWO (2) WORKING DAYS PRIOR TO COMMENCING CONSTRUCTION IN ALL AREAS.

OUPS 1-800-362-2764 (CONTACT LIMITED BASIS PARTICIPANTS DIRECTLY)
 OGPUPS 1-800-925-0988
 ODOT 330-786-2267 MICHELLE CHANEY

THE LOCATION OF EXISTING UNDERGROUND UTILITIES ARE NOT SHOWN ON THE PLANS, BUT CAN BE OBTAINED FROM THE OWNERS OF THE UTILITIES. THE CONTRACTOR IS RESPONSIBLE FOR ANY DAMAGE TO UTILITIES.

WORK LIMITS

THE WORK LIMITS SHOWN ON THESE PLANS ARE FOR PHYSICAL CONSTRUCTION ONLY. PROVIDE THE INSTALLATION AND OPERATION OF ALL WORK ZONE TRAFFIC CONTROL AND WORK ZONE TRAFFIC CONTROL DEVICES REQUIRED BY THESE PLANS WHETHER INSIDE OR OUTSIDE THESE WORK LIMITS.

ITEM 251 - PARTIAL DEPTH PAVEMENT REPAIR (441)

A QUANTITY OF THIS ITEM SHALL BE PROVIDED FOR USE AS DIRECTED BY THE ENGINEER. THE ITEM SHALL CONSIST OF REPAIRING EXISTING LOCATIONS EXHIBITING SURFACE DETERIORATION AND PLACING ITEM 441 ASPHALT CONCRETE SURFACE COURSE, TYPE 1, (448), PG64-22. IT IS NOT THE INTENT TO REPAIR EVERY DETERIORATED AREA WITHIN THE PROJECT. THE ENGINEER SHALL DETERMINE WHICH AREAS ARE TO BE REPAIRED. PAYMENT SHALL BE BASED ON THE ACTUAL NUMBER OF SQUARE YARDS OF PAVEMENT REPAIR. THE FOLLOWING ESTIMATED QUANTITY HAS BEEN CARRIED TO THE GENERAL SUMMARY:

251, PARTIAL DEPTH PAVEMENT REPAIR (441), 12,560 SQ. YD.

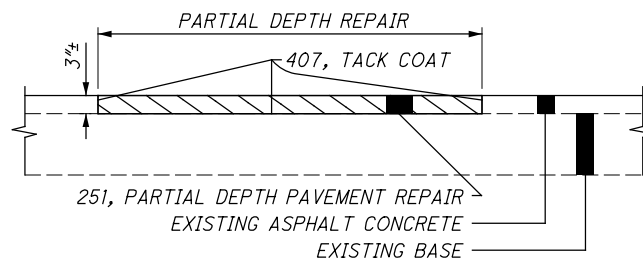

BREAKDOWN OF TOTAL BY LOCATION

LOCATION 1
 ATB-322: SR-7 TO PENNSYLVANIA STATE LINE
 251, PARTIAL DEPTH PAVEMENT REPAIR (441), 3,000 SQ. YD.

LOCATION 2
 ATB-11: ASHTABULA COUNTY LINE TO 0.6 MILE N. OF US-322
 251, PARTIAL DEPTH PAVEMENT REPAIR (441), 1,310 SQ. YD.

LOCATION 3
 ATB-11: ON RAMP FROM SR-46 TO OFF RAMP TO IR-90
 251, PARTIAL DEPTH PAVEMENT REPAIR (441), 350 SQ. YD.

LOCATION 4
 ATB-167: WEST OF SR-11 TO PIERPONT TOWNSHIP LINE
 251, PARTIAL DEPTH PAVEMENT REPAIR (441), 1,000 SQ. YD.

LOCATION 5
 MAH-680: SR-11 TO MILE POST 4
 251, PARTIAL DEPTH PAVEMENT REPAIR (441), 1,600 SQ. YD.

LOCATION 6
 MAH-680: SOUTH AVENUE TO US-224
 251, PARTIAL DEPTH PAVEMENT REPAIR (441), 1,200 SQ. YD.

LOCATION 8
 MAH-7: SR-164 TO WESTERN RESERVE RD.
 251, PARTIAL DEPTH PAVEMENT REPAIR (441), 200 SQ. YD.

LOCATION 9
 TRU-87: SR-534 TO SR-45
 251, PARTIAL DEPTH PAVEMENT REPAIR (441), 2,700 SQ. YD.

LOCATION 10 [DRUMMOND AVE TO OH/PA LINE]
 TRU-80: MM 234 TO MM 237 (SLM 9.05 TO 12.05)
 251, PARTIAL DEPTH PAVEMENT REPAIR (441), 1,200 SQ. YD.

PAVEMENT MARKINGS

THE FOLLOWING QUANTITIES HAVE BEEN PROVIDED TO BE USED AS DIRECTED BY THE PROJECT ENGINEER TO MATCH EXISTING PAVEMENT MARKINGS.

THE UNIT BID PRICES ON THESE PAY ITEMS WILL NOT BE ADJUSTED AS PER CMS 104.02.D.

ITEM 642 - EDGE LINE, 6", TYPE 1	3 MILES
ITEM 642 - LANE LINE, 6", TYPE 1	1 MILE
ITEM 642 - STOP LINE, TYPE 1	50 FT
ITEM 642 - CHANNELIZING LINE, 8", TYPE 1	100 FT
ITEM 642 - CENTER LINE, TYPE 1	2 MILES

LOCATION 7 - MAH-422 (FROM SR 616 TO PA LINE)

THE EXISTING GUTTER ON MAH-422 FROM SLM 7.58 TO SLM 10.14 SHALL BE REPAIRED. IT IS NOT THE INTENT TO REPAIR EVERY DETERIORATED SECTION WITHIN THE PROJECT LIMITS. THE ENGINEER SHALL DETERMINE WHICH AREAS ARE TO BE REPAIRED. THE FOLLOWING QUANTITIES SHALL BE USED TO REPAIR THE EXISTING GUTTER.

ITEM 202, CURB & GUTTER REMOVED, AS PER PLAN, 1,000 FT
 ITEM 452, 6" NON-REINFORCED CONCRETE PAVEMENT, CLASS QC 1P, AS PER PLAN, 862 SY
 ITEM 659, SEEDING AND MULCHING, AS PER PLAN, 223 SY

ITEM 452 - 6" NON-REINFORCED CONCRETE PAVEMENT, CLASS QC 1P, AS PER PLAN

THIS ITEM SHALL BE USED TO REPAIR THE EXISTING CONCRETE GUTTER ON US-422 IN MAHONING COUNTY. THE PAVEMENT SHALL BE PLACED AS SHOWN IN THE DETAIL BELOW.

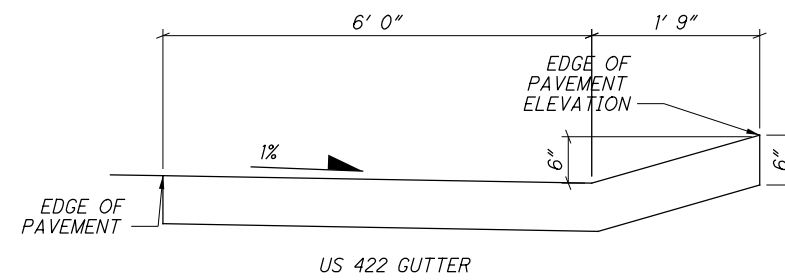

ITEM 621 - RAISED PAVEMENT MARKER REMOVAL

THE FOLLOWING ESTIMATED QUANTITIES HAVE BEEN PROVIDED AND SHALL BE USED AS DIRECTED BY THE ENGINEER FOR THE REMOVAL AND DISPOSAL OF EXISTING RAISED PAVEMENT MARKERS THAT ARE WITHIN THE LIMITS OF THE PAVEMENT REPAIRS AS NEEDED.

ALL EQUIPMENT, MATERIALS, AND LABOR REQUIRED TO PERFORM THIS WORK SHALL BE INCLUDED UNDER THE CONTRACT BID PRICE QUANTITY THAT WILL BE CARRIED TO THE GENERAL SUMMARY:

621, RAISED PAVEMENT MARKER REMOVED, 10 EACH

RAIL CROSSING

THE CONTRACTOR SHALL STAY OUT OF THE RAIL RIGHT OF WAY.

**ITEM 611 - CATCH BASIN ADJUSTED TO GRADE
 ITEM 611 - MANHOLE ADJUSTED TO GRADE**

THE FOLLOWING QUANTITY HAS BEEN CARRIED TO THE GENERAL SUMMARY AND IS TO BE USED AS DIRECTED BY THE ENGINEER TO ADJUST EXISTING CATCH BASINS TO GRADE.

611, CATCH BASIN ADJUSTED TO GRADE, 5 EACH
 611, MANHOLE ADJUSTED TO GRADE, 5 EACH

I:\Project+Data\04\Spot_paving\09251_SPFY2020_EAST\Design\Roadway\Sheets\09251_GN001.dgn Sheet 3/3/2020 8:44:51AM rbisesi

CALCULATED
 CMR
 CHECKED
 RMM

GENERAL NOTES

**D04-SP-FY2020
 (EAST)**