

MICROFILMED
JUL 22 1968
GROUND PHOTO LAB

STATE OF OHIO
DEPARTMENT OF HIGHWAYS

MAH-170-(5.94)(6.79)

SPRINGFIELD TOWNSHIP
MAHONING COUNTY

MICROFILMED
JUL 22 1968
GROUND PHOTO LAB

FED. RD. DIVISION	STATE	PROJECT
2	OHIO	STATE

Design Designation	
Current A.D.T.	(1964) 4020
Design Year A.D.T.	(1984) 7035
D.H.V.	915
D. (directional distribution)	67%
T. (per cent B+C trucks)	10%
V. (design speed)	60 M.P.H.

1965 SPECIFICATIONS
The Standard Specifications of the State of Ohio Department of Highways, Including Changes and Supplemental Specifications listed in the proposal shall govern this improvement.
The Right-of-Way for this improvement will be provided by the State of Ohio.
I hereby approve these plans and declare that the making of this improvement will require the closing to traffic of the highway except as noted on sheet 3, and that detours will be provided as indicated on the plans.

CONVENTIONAL SIGNS

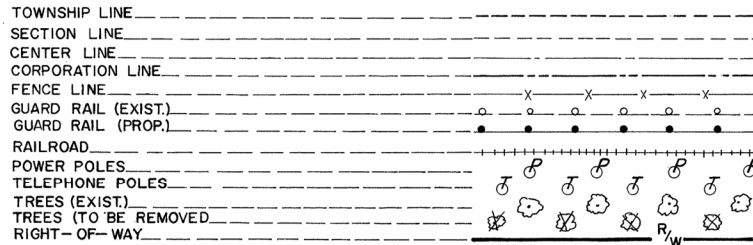

INDEX of SHEETS

TITLE SHEET	1
TYPICAL SECTIONS	2
GENERAL NOTES & CALCULATIONS	3
RECAPITULATION & GENERAL SUMMARY	4
PLAN & PROFILE	5-12
CROSS SECTIONS	6-8, 13-14
STRUCTURE 20' AND UNDER	9-15
CHANNEL CROSS SECTIONS	10-11, 16-17
RIGHT-OF-WAY	18-19

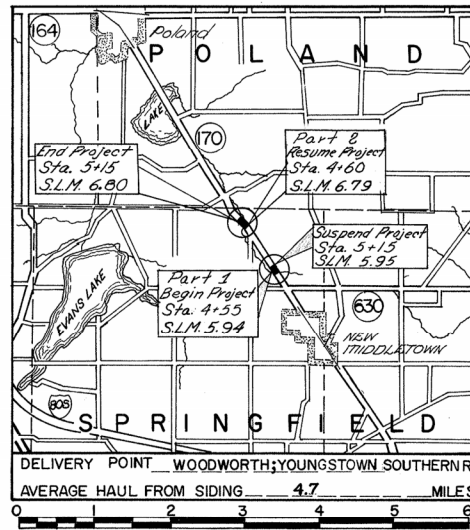

LOCATION MAP

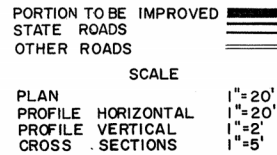

LINE DATA

PART 1 (Begin Project)	Sta. 4+55
(Suspend Project)	Sta. 5+15
PART 2 (Resume Project)	Sta. 4+60
(End Project)	Sta. 5+15
Net Length of Project 115 L.F. or 0.021 Miles	
PART 1 (Begin Work)	Sta. 2+50
(Suspend Work)	Sta. 6+70
PART 2 (Resume Work)	Sta. 3+30
(End Work)	Sta. 6+90
Net Length of Work 780 L.F. or 0.147 Miles	

Approved _____
Date 5-23-66 _____ Division Deputy Director
Approved _____
Date 8-17-66 _____ Engineer of Bridges
Approved _____
Date 8-17-66 _____ Engineer of Location and Design
Approved _____
Date 8-17-66 _____ Deputy Director of Design & Construction
Approved _____
Date 8-25-66 _____ Deputy Director of Right-of-Way
Approved _____
Date 8-25-66 _____ Deputy Director of Planning and Programming
Approved _____
Date _____ _____ First Assistant Director
Approved _____
Date 8-25-66 _____ Director of Highways

MICROFILMED
JUL 22 1968

GROUND PHOTO LAB

STANDARD DRAWINGS				SUPPLEMENTAL SPECIFICATIONS	
BP-5	6-1-65	MC-4	6-1-65	1001	3-2-66
GR-1	6-1-65	BP-3	6-1-65		
GR-2A	9-1-65	BP-4	6-1-65		
SP-53	6-30-61	Z-1	6-1-65		
MC-1	6-1-65	BP-6	6-1-65		
MC-3	5-1-66	GR-6	6-1-65		

MICROFILMED
JUL 22 1968
GROUND PHOTO LAB

File No	MAHONING COUNTY	MAH-170-(5.94)(6.79)
Date of Letting	_____ 196 _____	
Contract No	_____	

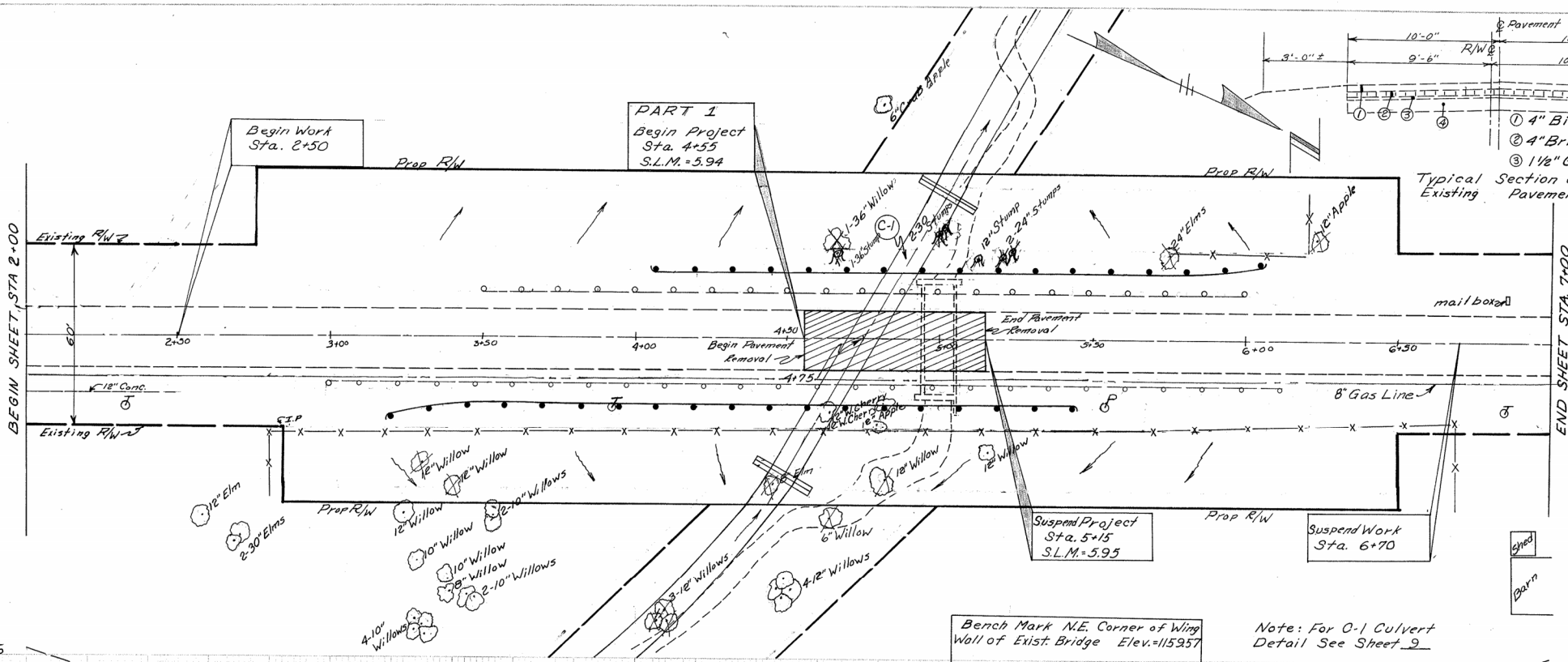

PAVEMENT					
Station	S	305	402	404	407
	I	9	1 3/4	1 1/2	
	D	Part. Cem. conc. base			Tack Coat Gal
From	To	E	S.Y.	C.Y.	C.Y.
4+55	5+15	Q	133	6.5	4.7
Total			133	7	5

Removal Quantities 202				
Station	S	Existing Pavement Removed + Disposed of	Existing Structure Removed	
	I	Sq. Yds.	Lump	
From	To	E		
4+55	5+15	133		
5+00			Lump	
Total		133	Lump	

Guard Rail 606				
Station	S	Guard Rail Rebuilt		
	I	L.F.		
From	To	E		
4+05	6+05	200		
3+20	5+45	225		
Total		425		

Removal Quantities 202				
Station	S	Guard Rail Removed for Re-use		
	I	L.F.		
From	To	E		
3+00	6+25	312.5		
3+50	6+00	250.0		
Total		562.5	*	

* 137.5 lin. ft. to be rebuilt at Culvert site on Part 2, see Sheet 12

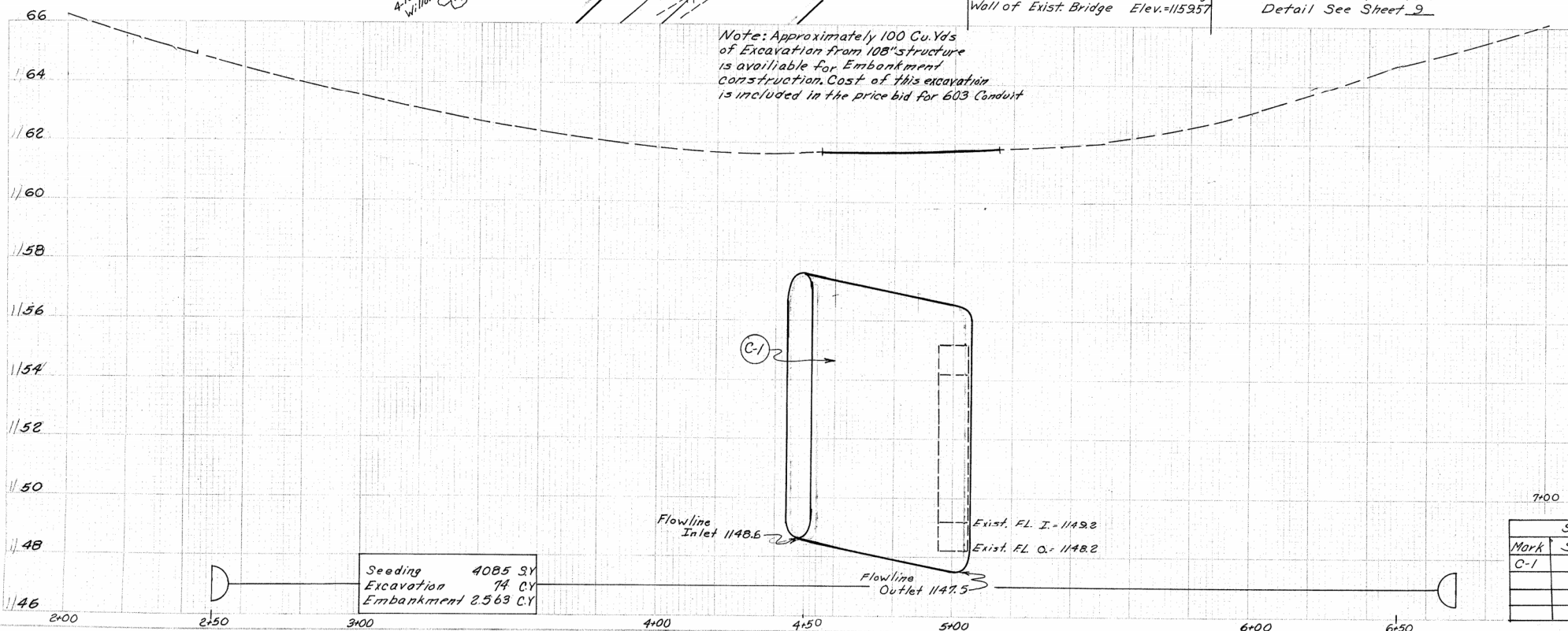

Structure 20' Span and Under				
Mark	Station	Type	Size	Sheet No.
C-1	4+75	Type A Conduit	108" x 110" Long	9
		- 707.03-10-B Gage		
		With Class B Bedding		

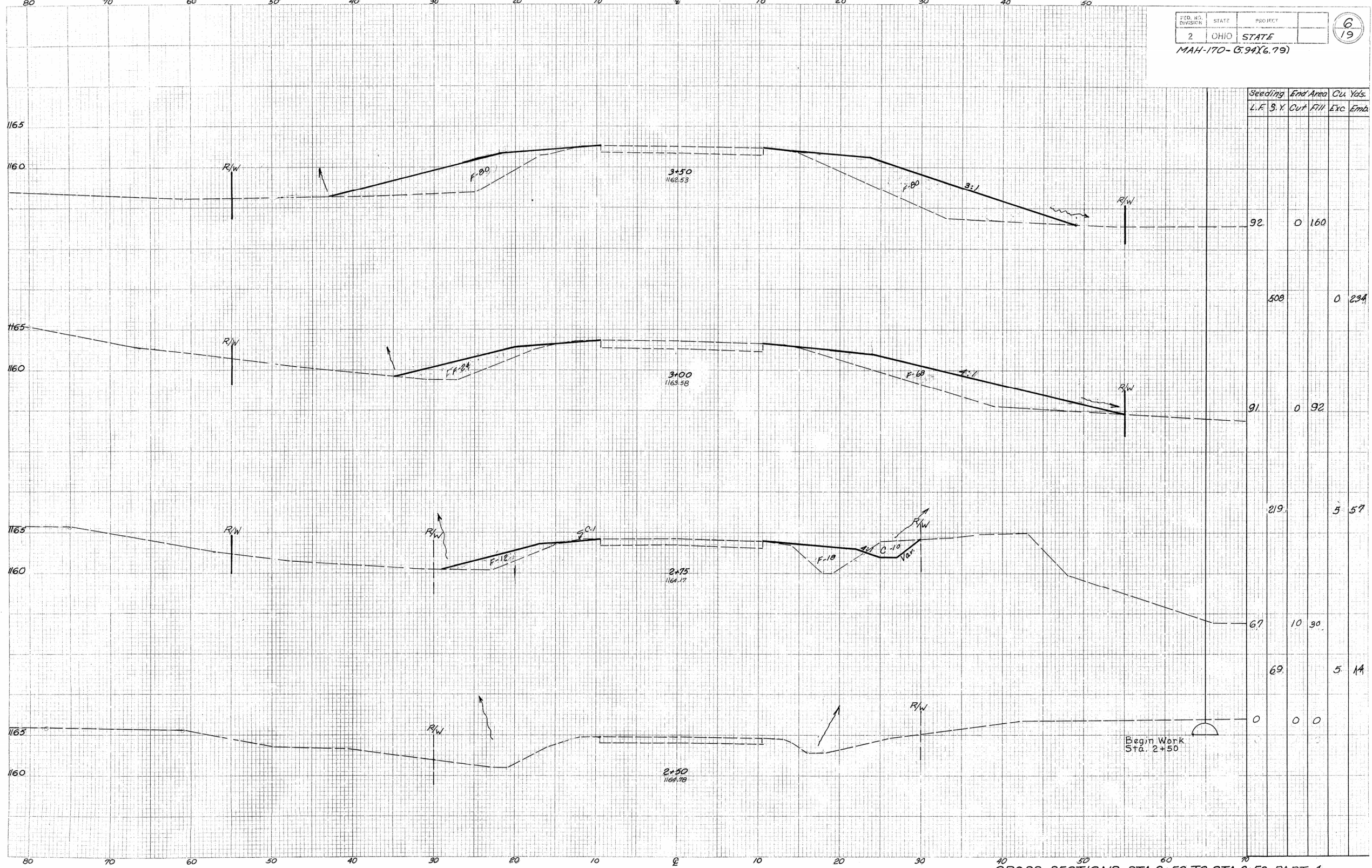

L.F.	Seedling		End Area		Cu. Yds.	
	S. Y.	Cut	Fill	Exc.	Emb.	
92	0	160				
508	0	234				
91	0	92				
219	5	57				
67	10	30				
69	5	14				
0	0	0				

CROSS SECTIONS STA 2+50 TO STA 3+50 PART 1

MAH-170-(5.9A)(6.79)

Suspend Pavement Removal
Sta. 5+15

Seeding	Emb. Area	Cu. Yds.
L.F.	S.Y.	Cut
	Fill	Exc.
		Emb.

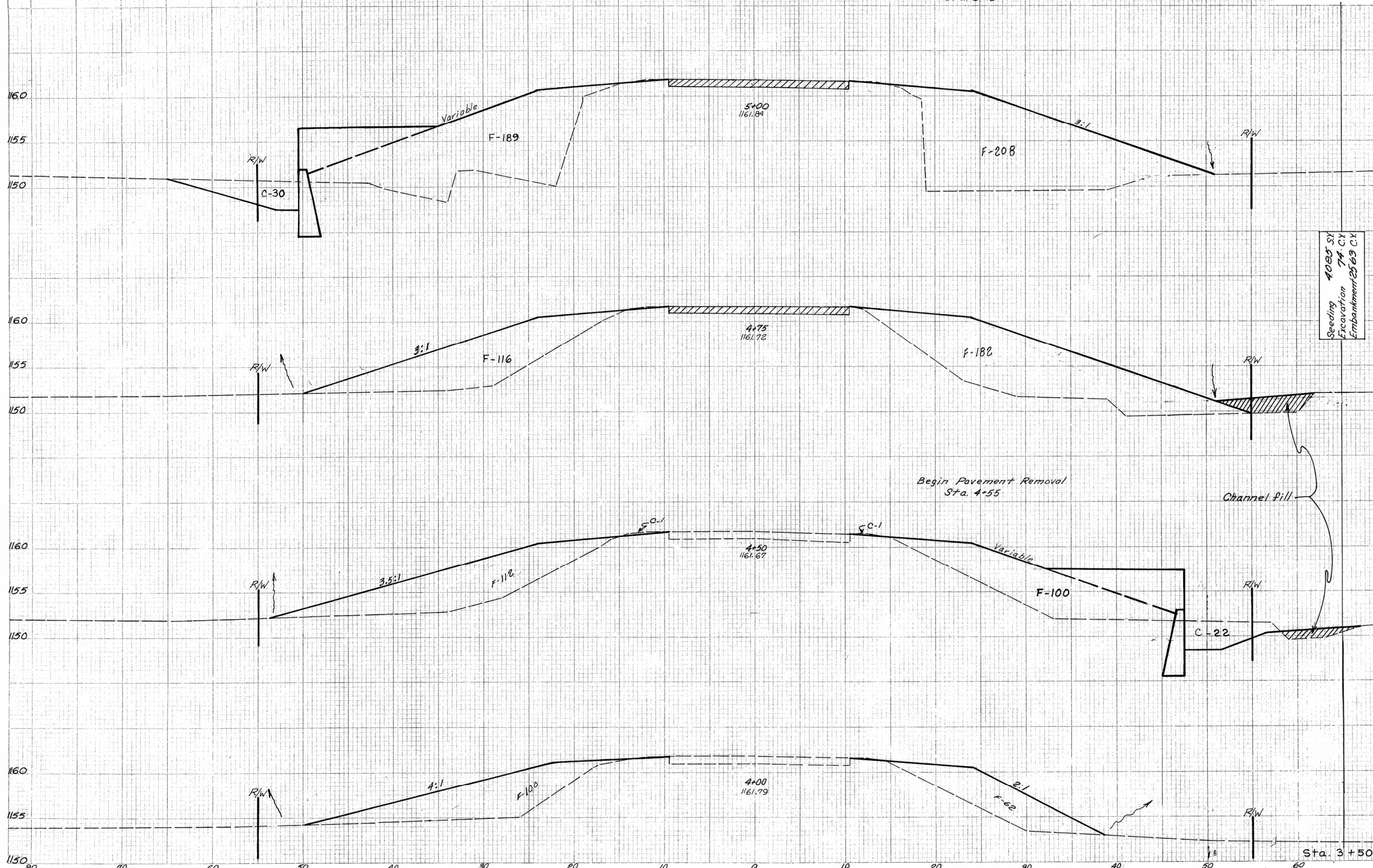

Seeding 4095 SY
Excavation 74 CY
Embankment 2263 CY

		102	30	337
		106	0	298
		109	24	212
		92	0	162
		92	0	160
		543	22	347
		288	14	322
		289	11	236

CROSS SECTIONS STA. 4+00 TO STA 5+00 PART 1

STRUCTURE N° C-1

MAH - 170-0594

Sta. 4+75

SCALE 1"=20'

FED. RD. DIVISION	STATE	PROJECT	TYPE FUNDS
2	OHIO	STATE	

9
19

MAH-170-(5.94)(6.79)

Existing Structure Data
 Type: Concrete slab on concrete abutments
 Roadway Width: 28'-8"
 Span: 10'-1"

Proposed Structure Data
 Drainage Area: 620 Acres Q₂₅ = 320 cfs HW = 6.4'
 Type A Conduit Corrugated Metal Pipe

70703 Gage 10-B V = 9.6 for C.M.P.
 Size 108" x 110' Long Skew 30° L.F.

Work Required
 Remove existing structure and replace with one 9'-0" round x 110' long sectional C.M.P. South of existing structure. Shape channel of inlet and outlet as shown on plans and cross sections. Existing channel shall be filled and blended with the surrounding terrain. Cost of filling old channel will be paid for as Embankment Item 203. The above work to be performed at the direction of the Engineer.

Estimated Quantities
 203 Excavation not including Embankment Construction 240 CX
 608 Concrete Masonry 17 CX
 603 108" Conduit Type A 707.03 Gage (10-B) 110 L.F.
 with Class B Bedding 872.5X
 659 Seeding and Mulching 872.5X
 Square Ends
 Corrugated metal pipe shall not be cut parallel to the finished embankment as shown in Standard Drawing SP-53.

SECTIONAL PLATE PIPE CULVERT
 END WALL DETAILS
 SP-53
 No Scale

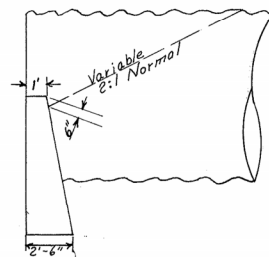
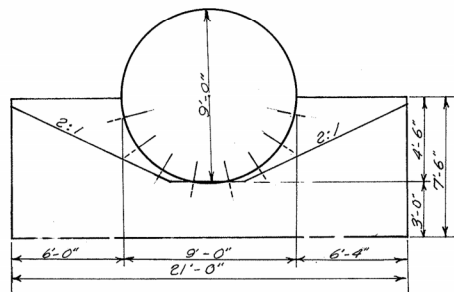

PART 1
 Begin Project
 Sta. 4+55
 SLM = 5.94

Suspend Project
 Sta. 5+15
 SLM = 5.95

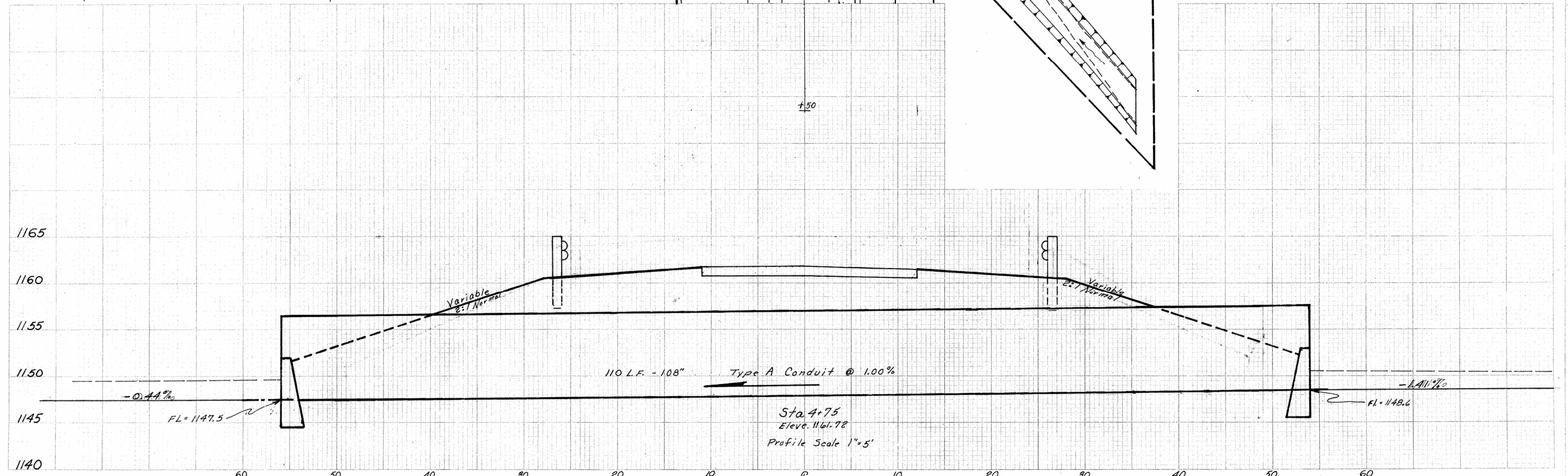
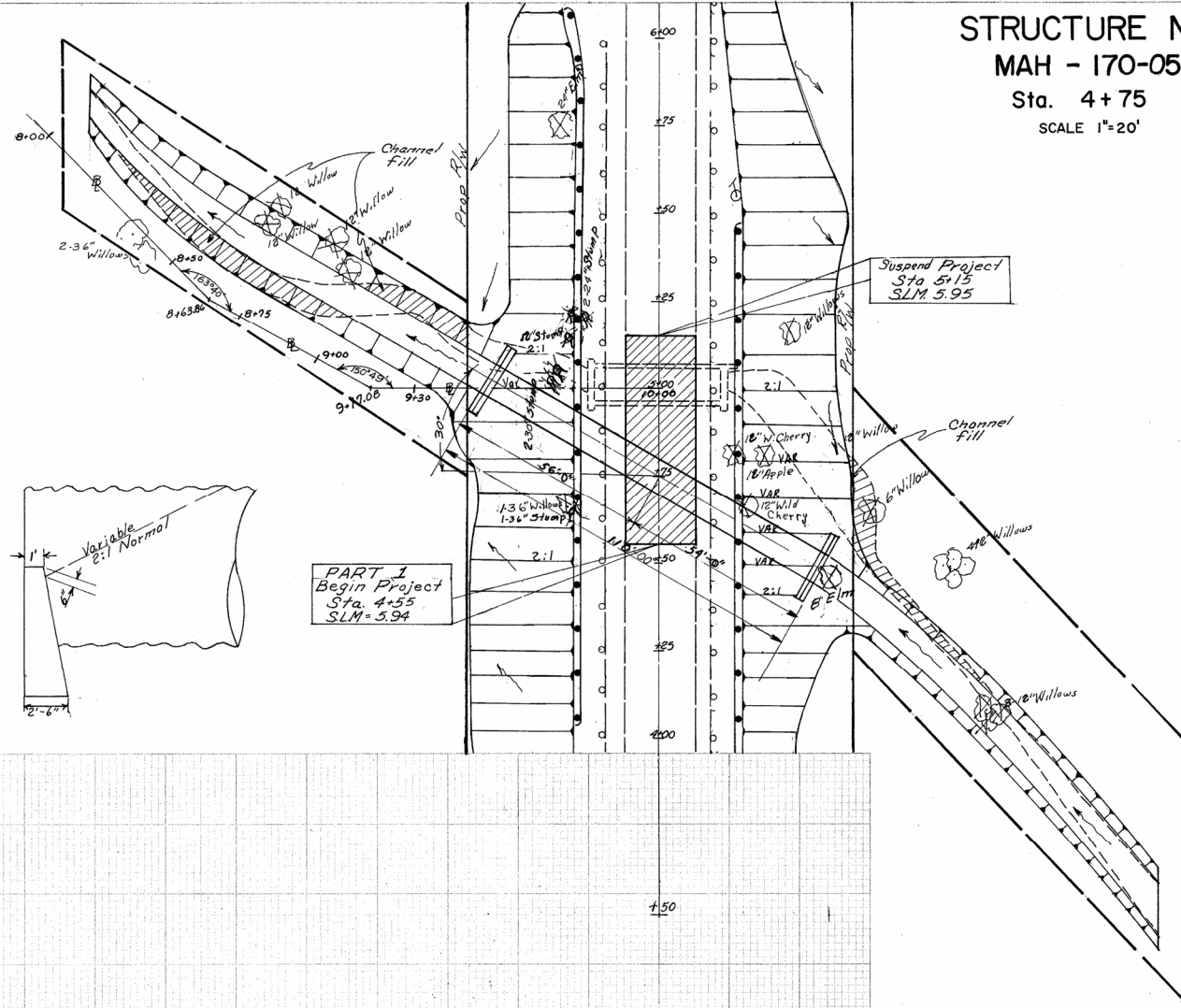

CULVERT DETAIL C-1 PART 1